

Site Name C4GW1		Date of Field Work September 29, 2016
Party Chief Giammarco/Hudson	Field Book Name/Number MISC FB 6Z	Page Number(s) 37
Site Benchmark Name C4GW1 2016	Benchmark Elevation (NAVD88) 9.57 ft	Datum Offset to NGVD29 + 1.57
Reference Elevation (NAVD 88) 8.05 ft		Existing Tag Elevation (Datum) 9.69 ft (Hand Written NGVD 29)
Latitude 25° 46' 18.10"		Longitude 80° 26' 55.17"

Notes:
Corpscon v6.0.1 Offset = + 1.57'; Field Offset = +1.64'

Photographs

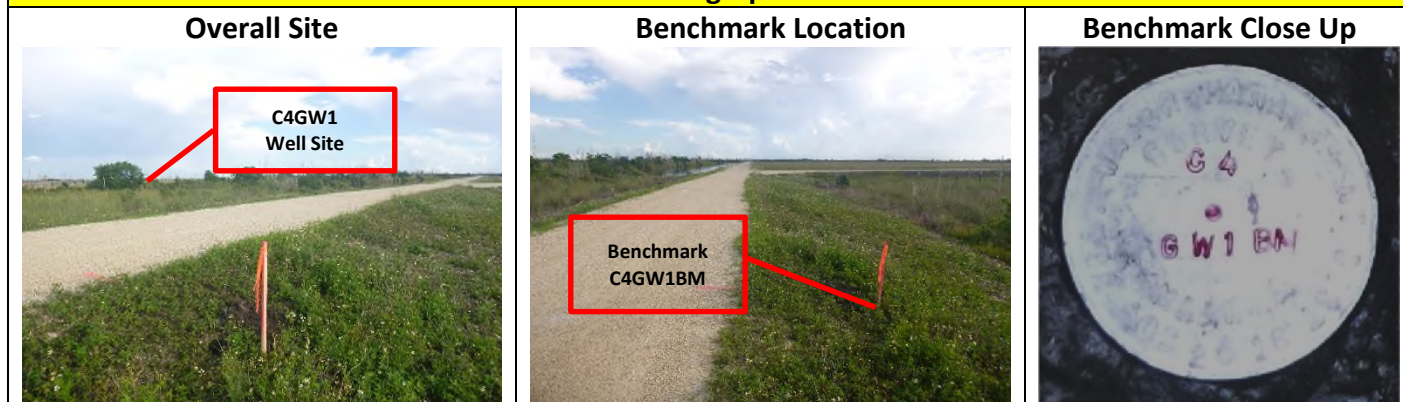

Staff Gauge (Front View) N/A	Staff Gauge (Side View) N/A
--	---------------------------------------

VDUP GW WELL ANGL
SET BENCH FOR RECORDER ELEV
FILE NAME ANSEL

PT #1

ELEV
5.121

ADJ
ELEV
-

#9

~~5.995~~
5.035

5.03

#17

5.122

5.121

-

DL 3065.77

DF 3084.08

ISM
ANGL

5.55

~~11.55~~
10.56

ELEV

~~6.00~~
5.03

5.995

MARK ON
RECORDER

3.00

~~8.55~~

7.58

3.03

~~11.58~~
10.61

5.58

~~6.00~~

5.03

ANGL

A GIAMMARCO
R HUDSON

NAVD 88

TRIMBLE DINI

BAR CODED ROD

COMMENT

FD STAINLESS STEEL ROD IN P.VIC. COLLAR AT NORTHWEST CORNER OF
FENCE FOR WELL "BM LPG2"

ANGL FD S.F.W. MID ALUMN CAP SET IN PIPE 15' 1/2" SOUTH
WELL

B.M. LPG2 ELEV Call 5.121

MARK ON MONITOR WELL

CZGW1
TRANSFER ELEVATION
FROM CZGW SITE

B.M.	+	HI	-	ELEV
CZRW POL	5.10	10.89		5.793
			4.57	6.32
			4.56	6.33
CZRW POL		5.10		5.79

Alan,
I know you took pictures of both wells but Amelia can't tell which is the east well and which is the west well. Can you advise?

Amelia Rodriguez-Alers comments

A. Giammarco
R. HUDSON

NAVID 88
ZEISS NI²
25' ROD

FD ALUMN CAP IN CONC. STAMPED CZRW POL 1994

W. WELL MARK ON P.V.C. STUB

E. WELL MARK ON P.V.C. STUB

REFERENCE
DETAIL OF WELLS

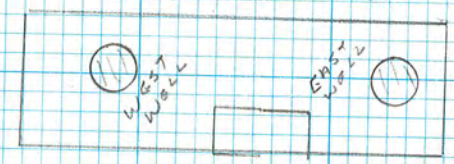

□ B.M.
CZRW POL
1994

SEC 4 TWP 54 RNG 39

C4GW1
 ESTABLISH VERTICAL
 CONTROL IN NAVD 88
 FILENAME C4GW1

PT # 1 ELEV 10.18 ADJ ELEV -

9 9.577 9.57

17 10.185 10.18 -

BM C4GW1 HT - ELEV 9.58

REF MARK

C4GW1

Alan,

You're not showing the elevation for the Reference elevation on GW Well C4GW1. Also, it appears that you took a turn from "BM C4GW1" to the reference elevation, but that's not clear because these field notes are incomplete. This page should also indicate that the digital level was used.

You've written an elevation on the attached picture; it's either 4.69 or 9.69, I can't tell which. Someone needs to certify these are right. Please advise...

Amelia Rodriguez-Alers comments

NAVD 88

A. CiAMMARO
 R. HUDSON

COMMENT
 FD ALUMN DISK IN CONC. STAMPED S 380

SET POURED IN PLACE CONC. MON 4/1/4" INCH GALVANIZED PIPE
 ALONG WITH S.F.W.M.D ALUMN. DISK STAMPED C4GW1 B.M.
 2016

S 380

SEE ABOVE

REF. MARK ON WELL SITE C4GW1

40 Misc FB 6Z 8/17/16

SEC 4 TWP 54 R21 39

C4 GW1 WELL
BENCH REFERENCE

Alan,

Describe in your notes that the Latitude and Longitude (shown to the right) for the BM were obtained by a hand held GPS unit over the set BM. Without looking at the pictures (which weren't available) we would not know that.

The notes have to stand on their own....

Amelia Rodriguez-Alers comments

Misc FB 6Z 8/17/16

A GRAMMARCO
R HUDSON

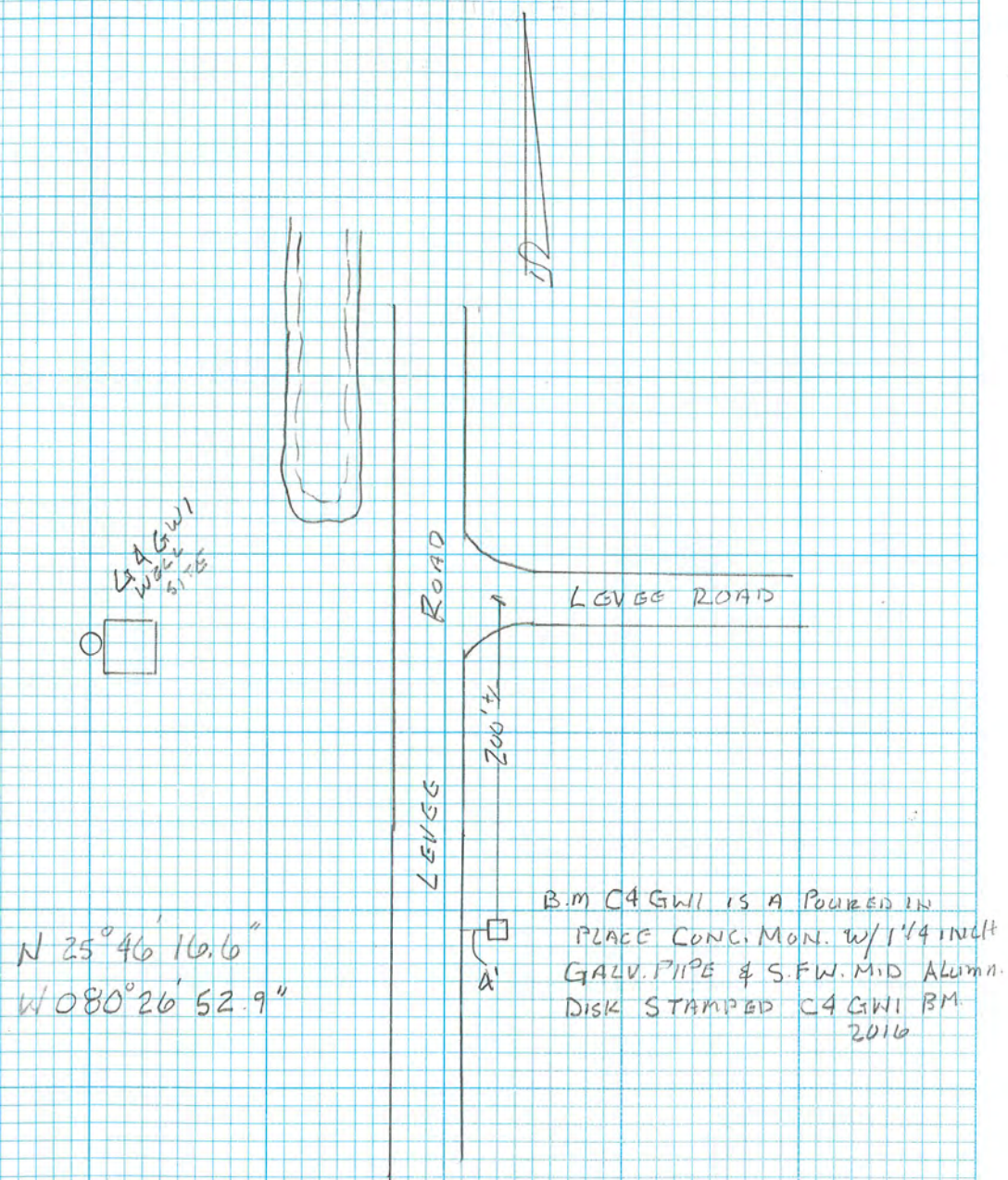





SOUTH FLORIDA WATER MANAGEMENT DISTRICT

Rev. 1/16

DESIGNATION: C4GW1		PROJECT: C4GW1 Well	
ESTABLISHED BY: SOUTH FLORIDA WATER MANAGEMENT DISTRICT		SURVEYOR: GIAMMARCO	
RECOVERED BY:		DATE: 8/17/16	
GEOGRAPHIC POSITION			
SECTION 4	TOWNSHIP 54 SOUTH	RANGE 39 EAST	
COUNTY: MIAMI-DADE	NAME OF QUADRANGLE: HIALEAH SW GEOGRAPHIC INDEX OF QUAD: 1504		
HORIZONTAL DATUM: 1927 (1983) Other (circle one) ZONE (E) or W			
VERTICAL DATUM: MSL 1929 (1988) Other (circle one)			
VERTICAL ACCURACY: 1 2 (3)			
STATE PLANE COORDINATE	N (Y) =	E (X) =	NAVD 88 EL. 9.574 NGVD 29 EL. 11.139
CORPSCON 6.0.1 CONVERSION FACTOR (NAVD88 TO NGVD29): +1.565			
LATITUDE: 25 46' 16.6"		LONGITUDE: 80 26' 52.9"	
RECOVERY DATA			
Stamping: BM C4GW1 2016			
To Reach: From the intersection of United States Highway 41 (US 41) and the Florida's Turnpike in Miami-Dade County Florida; go West on US 41 for 5.72 miles to a bridge on the right spanning South Florida Water Management District's (SFWMD's) Canal 4; Proceed North across the bridge to a levee road; Go East on the levee road (SFWMD gate key required) for 1.83 miles to the junction of a North\South levee; Turn left and proceed North on said levee for 0.7 of a mile to the junction of an East\West levee and station location. The station is located 200 feet South of the centerline of the East\West levee and 4.0 feet East of the East top of slope of the North\South levee and recessed 0.4 of a foot below ground level. The station is a SFWMD aluminum cap in a 1-¼ inch iron pipe set in a poured-in-place concrete mass.			
NOTABLE LAND MARKS: C4GW1 Well and the Levee roads.			
NGS SOURCE BENCHMARK: S380 (DH9622)			
FIELD BOOK MISC 6Z PAGE 39			

PICTURES

Overall Site



Looking Northwesternly

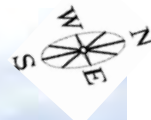



SOUTH FLORIDA WATER MANAGEMENT DISTRICT

Rev. 1/16

SKETCH

Field Book Misc 6Z page 40

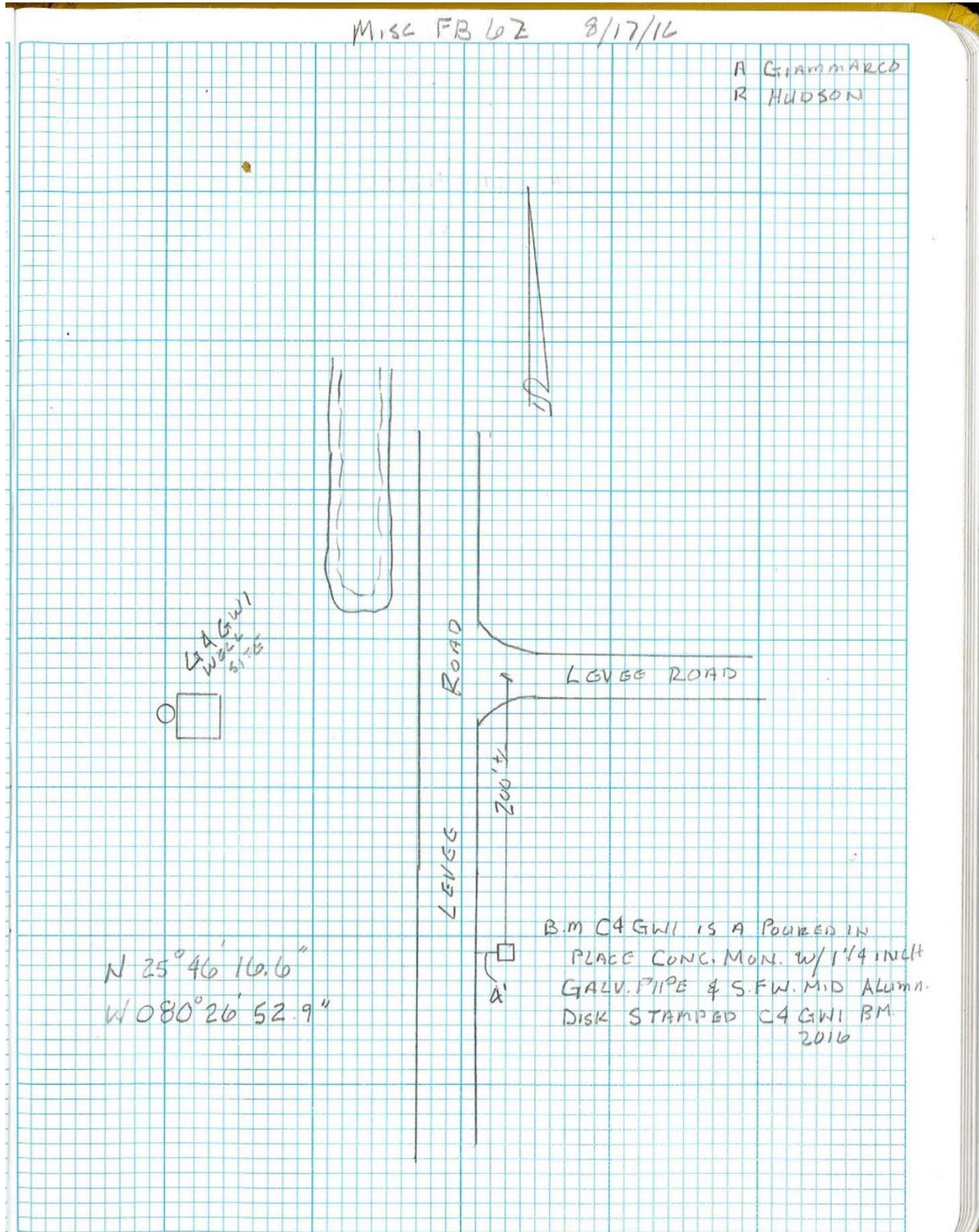

Not to Scale



SOUTH FLORIDA WATER MANAGEMENT DISTRICT

Rev. 1/16



General Location Map (taken from Google Earth) not to scale

The NGS Data Sheet

See file [dsdata.txt](#) for more information about the datasheet.

```

PROGRAM = datasheet95, VERSION = 8.7
1      National Geodetic Survey,  Retrieval Date = JUNE 17, 2015
DH9622 *****
DH9622 DESIGNATION - S 380
DH9622 PID - DH9622
DH9622 STATE/COUNTY- FL/MIAMI-DADE
DH9622 COUNTRY - US
DH9622 USGS QUAD - HIALEAH SW (1988)
DH9622
DH9622 *CURRENT SURVEY CONTROL
DH9622
DH9622 * NAD 83(1986) POSITION- 25 45 40. (N) 080 26 53. (W) SCALED
DH9622 * NAVD 88 ORTHO HEIGHT - 3.103 (meters) 10.18 (feet) ADJUSTED
DH9622
DH9622 GEOID HEIGHT - -24.79 (meters) GEOID12B
DH9622 DYNAMIC HEIGHT - 3.098 (meters) 10.16 (feet) COMP
DH9622 MODELED GRAVITY - 979,032.3 (mgal) NAVD 88
DH9622
DH9622 VERT ORDER - FIRST CLASS II
DH9622
DH9622.The horizontal coordinates were scaled from a topographic map and have
DH9622.an estimated accuracy of +/- 6 seconds.
DH9622.
DH9622.The orthometric height was determined by differential leveling and
DH9622.adjusted by the NATIONAL GEODETIC SURVEY
DH9622.in July 2006.
DH9622
DH9622.Photographs are available for this station.
DH9622
DH9622.The dynamic height is computed by dividing the NAVD 88
DH9622.geopotential number by the normal gravity value computed on the
DH9622.Geodetic Reference System of 1980 (GRS 80) ellipsoid at 45
DH9622.degrees latitude (g = 980.6199 gals.).
DH9622
DH9622.The modeled gravity was interpolated from observed gravity values.
DH9622
DH9622; North East Units Estimated Accuracy
DH9622;SPC FL E - 158,270. 255,370. MT (+/- 180 meters Scaled)
DH9622
DH9622 SUPERSEDED SURVEY CONTROL
DH9622
DH9622.No superseded survey control is available for this station.
DH9622
DH9622_U.S. NATIONAL GRID SPATIAL ADDRESS: 17RNJ553493(NAD 83)
DH9622
DH9622_MARKER: DD = SURVEY DISK
DH9622_SETTING: 34 = SET IN THE FOOTINGS OF SMALL/MEDIUM STRUCTURES
DH9622_SP_SET: CONCRETE BASE
DH9622_STAMPING: SFWMD S-380
DH9622_MARK LOGO: SFLWMD
DH9622_MAGNETIC: N = NO MAGNETIC MATERIAL

```

DH9622_STABILITY: C = MAY HOLD, BUT OF TYPE COMMONLY SUBJECT TO
 DH9622+STABILITY: SURFACE MOTION
 DH9622_SATELLITE: THE SITE LOCATION WAS REPORTED AS SUITABLE FOR
 DH9622+SATELLITE: SATELLITE OBSERVATIONS - March 15, 2005

DH9622

DH9622	HISTORY	- Date	Condition	Report By
DH9622	HISTORY	- UNK	MONUMENTED	SFLWMD
DH9622	HISTORY	- 20050315	GOOD	FLDEP
DH9622	HISTORY	- 20090722	GOOD	DCPW

DH9622

DH9622 STATION DESCRIPTION

DH9622

DH9622'DESCRIBED BY FL DEPT OF ENV PRO 2005 (JLM)

DH9622'THE MARK IS ABOUT 8.0 MI SOUTHWEST OF HIALEAH, 4.2 MI WEST OF
 DH9622'SWEETWATER, IN SECTION 4, TOWNSHIP 54 SOUTH, RANGE 39 EAST.

DH9622'

DH9622'TO REACH THE MARK FROM THE JUNCTION OF STATE HIGHWAY 997 (KROME
 DH9622'AVENUE, SW 177 AVENUE) AND U.S. HIGHWAY 41 (TAMIAMI TRAIL, SW 8TH ST)
 DH9622'ABOUT 10.0 MI SOUTHWEST OF HIALEAH, GO EAST ON U.S. HIGHWAY 41
 DH9622'(TAMIAMI TRAIL, SW 8TH ST) FOR 0.25 MI TO THE JUNCTION OF A PAVED ROAD
 DH9622'ON THE LEFT, TURN LEFT ON THE PAVED ROAD AND GO NORTH PASSING OVER
 DH9622'CANAL C-4 FOR ABOUT 100.0 FT TO THE JUNCTION OF A LEVEE ROAD ON THE
 DH9622'RIGHT, TURN RIGHT ON THE LEVEE ROAD AND GO EAST FOR 1.75 MI TO
 DH9622'Structure S-380 AND THE MARK ON THE RIGHT, 0.05 MI WEST OF A ROAD
 DH9622'LEADING NORTH, SET IN THE TOP OF A CONCRETE BASE FOR AN ALUMINUM LIGHT
 DH9622'POLE ON THE NORTH SIDE, ABOUT 2.0 FT ABOVE THE LEVEL OF THE LEVEE
 DH9622'ROAD.

DH9622'

DH9622'LOCATED 38.0 FT WEST OF THE APPROXIMATE CENTERLINE OF A DOUBLE
 DH9622'CHAINLINK GATE AND A BERM ROAD SPANNING THE CANNAL, 17.0 FT SOUTH OF
 DH9622'THE APPROXIMATE CENTERLINE OF THE LEVEE ROAD, 11.3 FT SOUTHEAST OF
 DH9622'THE NORTHEAST CORNER OF A 6-FOOT TALL CHAINLINK FENCE ENCLOSING A
 DH9622'CONCRETE WALKWAY AND 0.6 FT NORTH OF THE LIGHT POLE.

DH9622

DH9622 STATION RECOVERY (2009)

DH9622

DH9622'RECOVERY NOTE BY DOUGLAS COUNTY PUBLIC WORKS 2009 (LER)

DH9622'RECOVERED IN GOOD CONDITION.

*** retrieval complete.

Elapsed Time = 00:00:01

The NGS Data Sheet

See file [dsdata.txt](#) for more information about the datasheet.

```

PROGRAM = datasheet95, VERSION = 8.7
1      National Geodetic Survey,  Retrieval Date = JUNE 17, 2015
DH9606 *****
DH9606 DESIGNATION - S 380A
DH9606 PID - DH9606
DH9606 STATE/COUNTY- FL/MIAMI-DADE
DH9606 COUNTRY - US
DH9606 USGS QUAD - HIALEAH SW (1988)
DH9606
DH9606 *CURRENT SURVEY CONTROL
DH9606
DH9606 * NAD 83(1986) POSITION- 25 45 40. (N) 080 26 51. (W) SCALED
DH9606 * NAVD 88 ORTHO HEIGHT - 1.867 (meters) 6.13 (feet) ADJUSTED
DH9606
DH9606 GEOID HEIGHT - -24.79 (meters) GEOID12B
DH9606 DYNAMIC HEIGHT - 1.864 (meters) 6.12 (feet) COMP
DH9606 MODELED GRAVITY - 979,032.3 (mgal) NAVD 88
DH9606
DH9606 VERT ORDER - FIRST CLASS II
DH9606
DH9606.The horizontal coordinates were scaled from a topographic map and have
DH9606.an estimated accuracy of +/- 6 seconds.
DH9606.
DH9606.The orthometric height was determined by differential leveling and
DH9606.adjusted by the NATIONAL GEODETIC SURVEY
DH9606.in July 2006.
DH9606
DH9606.The dynamic height is computed by dividing the NAVD 88
DH9606.geopotential number by the normal gravity value computed on the
DH9606.Geodetic Reference System of 1980 (GRS 80) ellipsoid at 45
DH9606.degrees latitude (g = 980.6199 gals.).
DH9606
DH9606.The modeled gravity was interpolated from observed gravity values.
DH9606
DH9606; North East Units Estimated Accuracy
DH9606;SPC FL E - 158,270. 255,420. MT (+/- 180 meters Scaled)
DH9606
DH9606 SUPERSEDED SURVEY CONTROL
DH9606
DH9606.No superseded survey control is available for this station.
DH9606
DH9606_U.S. NATIONAL GRID SPATIAL ADDRESS: 17RNJ554493(NAD 83)
DH9606
DH9606_MARKER: DD = SURVEY DISK
DH9606_SETTING: 34 = SET IN THE FOOTINGS OF SMALL/MEDIUM STRUCTURES
DH9606_SP_SET: WATER STRUCTURE ABUTMENT
DH9606_STAMPING: SFWMD S-380A
DH9606_MARK LOGO: SFLWMD
DH9606_MAGNETIC: N = NO MAGNETIC MATERIAL
DH9606_STABILITY: C = MAY HOLD, BUT OF TYPE COMMONLY SUBJECT TO
DH9606+STABILITY: SURFACE MOTION

```

DH9606_SATELLITE: THE SITE LOCATION WAS REPORTED AS SUITABLE FOR
DH9606+SATELLITE: SATELLITE OBSERVATIONS - March 17, 2005

DH9606

DH9606	HISTORY	- Date	Condition	Report By
DH9606	HISTORY	- UNK	MONUMENTED	SFLWMD
DH9606	HISTORY	- 20050317	GOOD	FLDEP
DH9606	HISTORY	- 20090722	GOOD	DCPW

DH9606

DH9606

STATION DESCRIPTION

DH9606

DH9606'DESCRIBED BY FL DEPT OF ENV PRO 2005 (JLM)

DH9606'THE MARK IS ABOUT 8.0 MI SOUTHWEST OF HIALEAH, 4.2 MI WEST OF
DH9606'SWEETWATER, IN SECTION 4, TOWNSHIP 54 SOUTH, RANGE 39 EAST.

DH9606'

DH9606'TO REACH THE MARK FROM THE JUNCTION OF STATE HIGHWAY 997 (KROME
DH9606'AVENUE, SW 177 AVENUE) AND U.S. HIGHWAY 41 (TAMIAMI TRAIL, SW 8TH ST)
DH9606'ABOUT 10.0 MI SOUTHWEST OF HIALEAH, GO EAST ON U.S. HIGHWAY 41
DH9606'(TAMIAMI TRAIL, SW 8TH ST) FOR 0.25 MI TO THE JUNCTION OF A PAVED ROAD
DH9606'ON THE LEFT, TURN LEFT ON THE PAVED ROAD AND GO NORTH PASSING OVER
DH9606'CANNAL C-4 FOR ABOUT 100.0 FT TO THE JUNCTION OF A LEVEE ROAD ON THE
DH9606'RIGHT, TURN RIGHT ON THE LEVEE ROAD AND GO EAST FOR 1.85 MI TO
DH9606'Structure S-38A AND THE MARK ON THE RIGHT, 0.05 MI EAST OF A ROAD
DH9606'LEADING NORTH, SET IN THE TOP OF A CONCRETE BASE FOR STRUCTURE S-380A,
DH9606'ABOUT 0.6 FT BELOW THE LEVEL OF THE LEVEE ROAD.

DH9606'

DH9606'LOCATED 19.0 FT SOUTH OF THE APPROXIMATE CENTERLINE OF THE LEVEE ROAD,
DH9606'1.0 FT NORTH OF THE NORTHWEST CORNER OF A 6-FOOT TALL CHAINLINK FENCE
DH9606'AND 0.5 FT WEST OF THE WEST SIDE OF A CONCRETE WALKWAY FOR THE
DH9606'Structure.

DH9606

DH9606

STATION RECOVERY (2009)

DH9606

DH9606'RECOVERY NOTE BY DOUGLAS COUNTY PUBLIC WORKS 2009 (LER)

DH9606'RECOVERED IN GOOD CONDITION.

*** retrieval complete.

Elapsed Time = 00:00:03

Project Information		Coordinate System	
Name:		Name:	Default
Size:		Datum:	WGS 1984
Modified:	2/15/2012 8:48:57 AM (UTC:-7)	Zone:	Default
Time zone:	Mountain Standard Time	Geoid:	
Reference number:		Vertical datum:	
Description:			

Level Report

Imported file: [C4GW1.DAT](#)
Instrument: DiNi
Standard error per kilometer of double leveling: 0.00230 ft
Standard error per turn/station setup: 0.00000 ft
Creation option: Delta elevations
Description usage: Feature codes

Run - 1 Raw Observations

Raw Misclosure: 0.00600 ft
 Σ BS Distances: 3762.510 ft
 Σ FS Distances: 3761.060 ft
Run Length: 7523.570 ft
Reduction: Adjusted Values

Create	Point ID	BS	IS	FS	Δ Elevation	Raw Elevation	Correction	Adj. Elevation	Type	Distance	Description
<input checked="" type="checkbox"/>	1	<input checked="" type="checkbox"/> 6.35700 ft			0.00000 ft	10.180 ft	0.00000 ft	10.180 ft	Benchmark	217.450 ft	S380 3
<input type="checkbox"/>	2			<input checked="" type="checkbox"/> 5.49900 ft	0.85800 ft	11.038 ft	-0.00031 ft	11.038 ft	Computed	216.800 ft	3
	2	<input checked="" type="checkbox"/> 5.33600 ft								256.890 ft	3
<input type="checkbox"/>	3			<input checked="" type="checkbox"/> 5.25600 ft	0.08000 ft	11.118 ft	-0.00073 ft	11.117 ft	Computed	253.380 ft	3
	3	<input checked="" type="checkbox"/> 5.00800 ft								255.840 ft	3
<input type="checkbox"/>	4			<input checked="" type="checkbox"/> 4.84500 ft	0.16300 ft	11.281 ft	-0.00116 ft	11.280 ft	Computed	256.530 ft	3
	4	<input checked="" type="checkbox"/> 5.04000 ft								260.920 ft	3
<input type="checkbox"/>	5			<input checked="" type="checkbox"/> 4.81900 ft	0.22100 ft	11.502 ft	-0.00160 ft	11.500 ft	Computed	255.020 ft	3
	5	<input checked="" type="checkbox"/> 5.29400 ft								258.100 ft	3
<input type="checkbox"/>	6					11.395 ft	-0.00204 ft	11.393 ft	Computed		3



			✓ 5.40100 ft	-0.10700 ft						262.630 ft	
	6	✓ 5.11500 ft								255.380 ft	3
<input type="checkbox"/>	7		✓ 5.31300 ft	-0.19800 ft	11.197 ft	-0.00248 ft	11.195 ft	Computed		261.020 ft	3
	7	✓ 5.55900 ft								262.170 ft	3
<input type="checkbox"/>	8		✓ 5.75500 ft	-0.19600 ft	11.001 ft	-0.00291 ft	10.998 ft	Computed		255.900 ft	3
	8	✓ 5.13100 ft								120.110 ft	3
<input type="checkbox"/>	9		✓ 6.55500 ft	-1.42400 ft	9.577 ft	-0.00301 ft	9.574 ft	Computed		116.540 ft	BM 3
	9	✓ 6.61300 ft								116.270 ft	BM 3
<input type="checkbox"/>	10		✓ 5.18900 ft	1.42400 ft	11.001 ft	-0.00310 ft	10.998 ft	Computed		120.080 ft	3
	10	✓ 5.85900 ft								254.130 ft	3
<input type="checkbox"/>	11		✓ 5.66100 ft	0.19800 ft	11.199 ft	-0.00353 ft	11.195 ft	Computed		262.340 ft	3
	11	✓ 5.10700 ft								260.860 ft	3
<input type="checkbox"/>	12		✓ 4.90800 ft	0.19900 ft	11.398 ft	-0.00396 ft	11.394 ft	Computed		251.570 ft	3
	12	✓ 5.36600 ft								262.140 ft	3
<input type="checkbox"/>	13		✓ 5.25900 ft	0.10700 ft	11.505 ft	-0.00440 ft	11.501 ft	Computed		256.730 ft	3
	13	✓ 4.79500 ft								254.100 ft	3
<input type="checkbox"/>	14		✓ 5.01500 ft	-0.22000 ft	11.285 ft	-0.00483 ft	11.280 ft	Computed		260.960 ft	3
	14	✓ 5.07000 ft								257.150 ft	3
<input type="checkbox"/>	15		✓ 5.23200 ft	-0.16200 ft	11.123 ft	-0.00526 ft	11.118 ft	Computed		256.000 ft	3
	15	✓ 5.28700 ft								253.480 ft	3
<input type="checkbox"/>	16		✓ 5.36600 ft	-0.07900 ft	11.044 ft	-0.00569 ft	11.038 ft	Computed		256.890 ft	3
	16	✓ 5.46300 ft								217.520 ft	3
✓	17		✓ 6.32100 ft	-0.85800 ft	10.186 ft	-0.00600 ft	10.180 ft	Benchmark		218.670 ft	S380 3

Run - 1 (N1) Reduced Observations

Observation	Status		Correction		Setups	Length			
-------------	--------	--	------------	--	--------	--------	--	--	--

		Raw Δ Elevation		Final Δ Elevation			Σ BS Readings	Σ FS Readings	Std. Error
 1-17 (E1)	Enabled	0.00600 ft	-0.00600 ft	0.00000 ft	16	7523.570 ft	86.40000 ft	86.39400 ft	0.05000 ft

Run - 1 (N1) Reduced Coordinates

Point ID	Status	Elevation
 1	Enabled	10.18000 ft
 17	Enabled	10.18000 ft

Date: 8/18/2016 8:20:50 AM	Project:	Trimble Business Center
----------------------------	----------	-------------------------

Office

Project

29 March 2017

INPUT

Geographic, flhp gn - Florida HPGN
Vertical - NAVD88, U.S. Feet

OUTPUT

State Plane, flhp gn - Florida HPGN
0901 - Florida East, U.S. Feet
Vertical - NGVD29 (Custom), U.S. Feet

C4GW1

1/1

Latitude: 25 46 16.6
Longitude: 80 26 52.9
Elevation/Z: 0

Northing/Y: 522941.919
Easting/X: 837813.450
Elevation/Z: 1.565
Convergence: 0 14 23.97281
Scale Factor: 0.999979013
Combined Factor: 0.999982819

Remark:

Corpscon v6.0.1, U.S. Army Corps of Engineers

REGISTRATION WORKSHEET - C4GW1 Addendum

Site Name: **C4GW1** Today's Date: **1/31/2017** Type Recorder: **CR-10**
 Activity: **Addendum** Effective Date: _____ Start Date of Data : _____
 Customer: **Garnett Ritchie** Division: **SCADA Maintenan** Agency: **SFWMD** Proj Activity Code: _____
 Project Manager: **Amelia Rodriguez-Alers** Division: **Survey & Mapping** Agency: **SFWMD** Contract #: _____
 Project name: **VDUP** Legal Mandate: _____

Short Common Name / Description: _____

Proj. Mgr. Notes: Addendum Added to Update Surveying Data for NAVD 88 Ref. Elev. Add offset = +1.57' to convert to NGVD 29.

Site Directions: Take Turnpike Extension (821) and exit W on Tamiami Trail (US 41). Drive W on Tamiami Trail (US 41) to 137 Ave and take left on 137 Ave for about 30 ft to cross the C4 canal - there is a small bridge there. Take left just after passing the bridge and drive W on the levi which is parallel to C4 and Tamiami Trail (US 41) to the structure S 380. On the way to S380 you will pass one "T" levi and get to a second "T" levi just before S380. At this second levi "T"

Site Address (if any): _____

Transportation: **Std Vehicle** Lock type or combination: **Master Master** # _____

Recorder Location/Purpose: **Stand-Alone Recorder (Non-Flow Site)** Structure Type: _____

Array ID Configuration table attached **YES**

SURVEY INFORMATION

B.M. Elevation: **9.57 ft** Date: **8/17/2016** Stamp: **C4 GW1 BM**
 Agency: **SFWMD** Type: **ALUM** Datum: **NAVD88**

Benchmark Location/Description: FROM THE INTERSECTION OF US 41 AND THE FLORIDA TURNPIKE IN DADE COUNTY FL; GO WEST ON US 41 FOR 5.72 MILES TO A BRIDGE ON THE RIGHT SPANNING THE C4 CANAL. PROCEED NORTH ACROSS BRIDGE TO THE C4 LEVEE ROAD. GO EAST ON LEVEE ROAD (SFWMD GATE KEY REQUIRED) FOR 1.83 MILES TO THE JUNCTION OF A NORTH\ SOUTH LEVEE. TURN LEFT AND PROCEED NORTH ON SAID LEVEE FOR 0.7 MILE TO THE JUNCTION OF AN EAST WEST LEVEE AND STATION LOCATION.

COMMUNICATIONS INFORMATION

Communications System: **Loggernet** Loggernet Server: **LOG2** Loggernet IP Address: **141.232.41.20**

Tower: **S12-TW** Communication Type: **R.F. (V.H.F. Radio)** R.F. Code/Modem Address: **170** R.F. Access Point: _____

Phone Number: _____

RTU Address: _____ Gateways: _____

WELL INFORMATION

Sensor	Customer Ref	Ref Elev	Elev Date	Top of Well	Bottom of Well	Ground/ Land Elev	Depth of Well	Lat	Long	X-Coord	Y-Coord	Sec	Twn	Rng	Qu	Basin	Cty
GW1	C4GW1	8.05 ft	8/17/2016	8.05ft	-7.15 ft		15.2	25 46 18.104	80 26 55.169	837605.395	523092.894	4	54	39	HIALE	C-4	Miami-Dade

Sensor	Sensor Location	Ground Water Sensor Location
GW1	Top of well	

ADDITIONAL GIS INFORMATION

Item/Parameter	Description/Notes	Lat	Long	X-Coord	Y-Coord	Sec	Twn	Rng	Qu	Basin	Cty
CR-10		25 46 18.165	80 26 55.169	837605.369	523099.052	4	54	39	HIALE	C-4	Miami-Dade