

Cooper City R.O.

**Class I Injection Facility No. 81**

# Well Completion Report

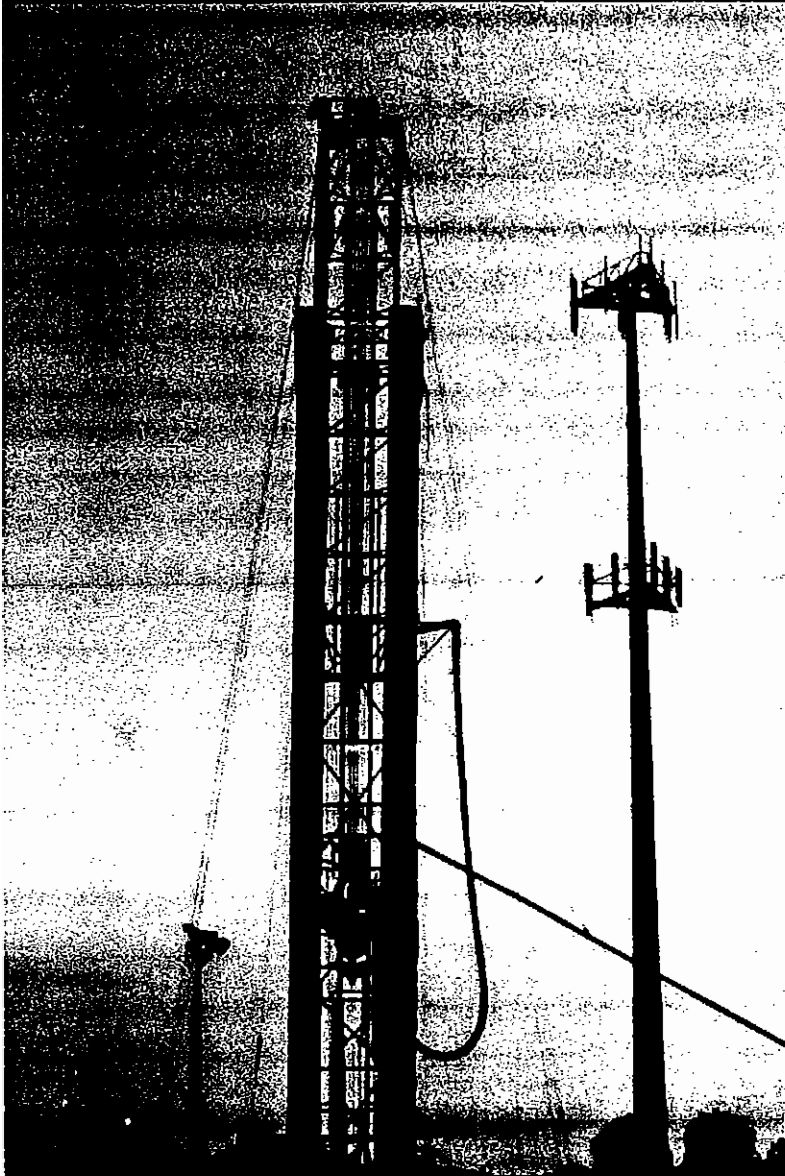

## Injection Well No. 1 Construction Completion Report Water/Wastewater Treatment Plant

November 2001

**HAZEN AND SAWYER**  
Environmental Engineers & Scientists



THE CITY OF **COOPER CITY**  
Someplace Special

City of Cooper City Utility Department

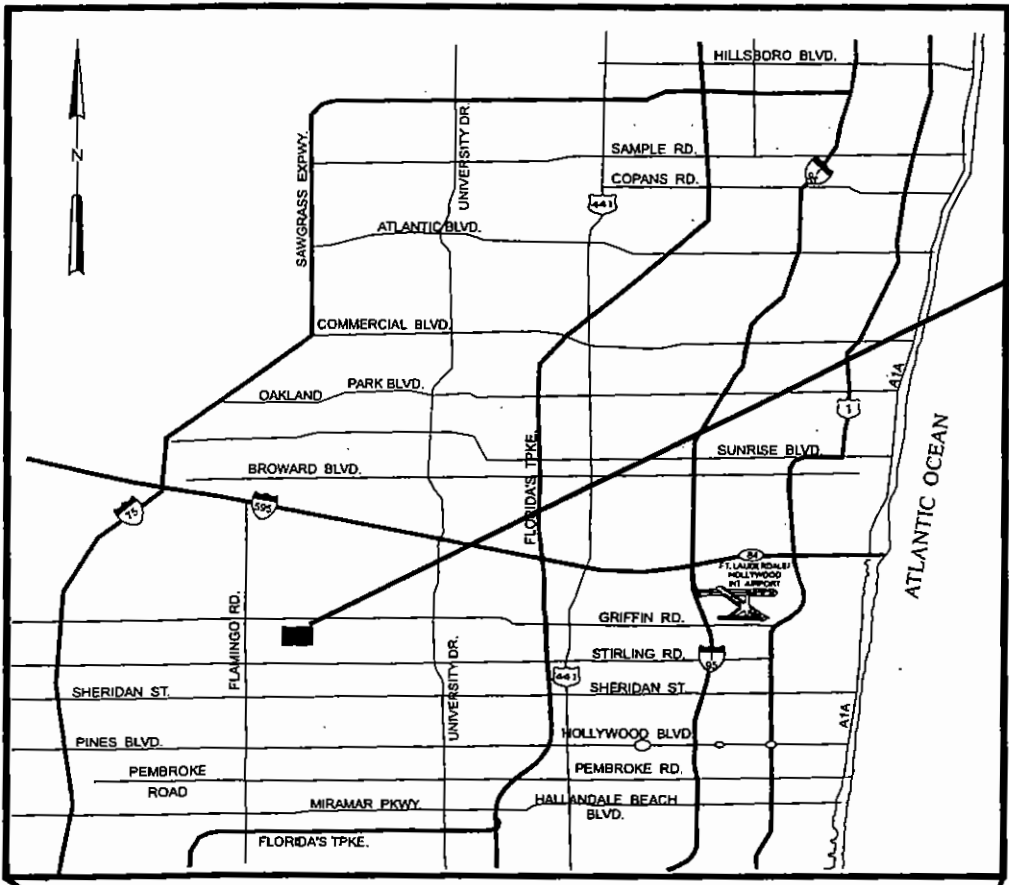

**PROJECT SITE**

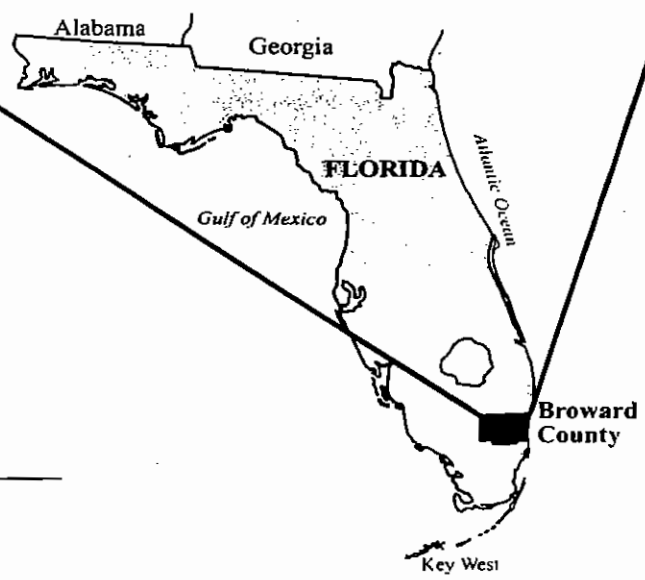

11-21-01

*Albert Muniz*  
 ALBERT MUNIZ, P.E.  
 Registration No. 35587

*James A. Wheatley* 11-21-01  
 JAMES A. WHEATLEY, P.G.  
 Registration No. 530

**HAZEN AND SAWYER**  
 Environmental Engineers & Scientists



CONCENTRATE DISPOSAL SYSTEM  
 COOPER CITY WTP/WWTP

**LOCATION MAP**

**FIGURE**

**1**



THE COORDINATES SHOWN HEREON WERE BASED ON GPS RTK OBSERVATIONS TO "CHARLIE" CONTROL STATION.

DESIGNATION - CHARLIE  
 PID - AD5766  
 STATE/COUNTY - FL/BROWARD  
 USGS QUAD - COOPER CITY (1983)  
 NAD 83/90 GEOGRAPHIC COORDINATE - N 26°03'51.56148" W 080°17'51.30968"  
 NAD 83/90 STATE PLANE COORDINATE - FLORIDA EAST ZONE  
 NORTHING: 628,693.14 (FT)  
 EASTING: 886,752.46 (FT)

CONTROL STATION  
 "CHARLIE"

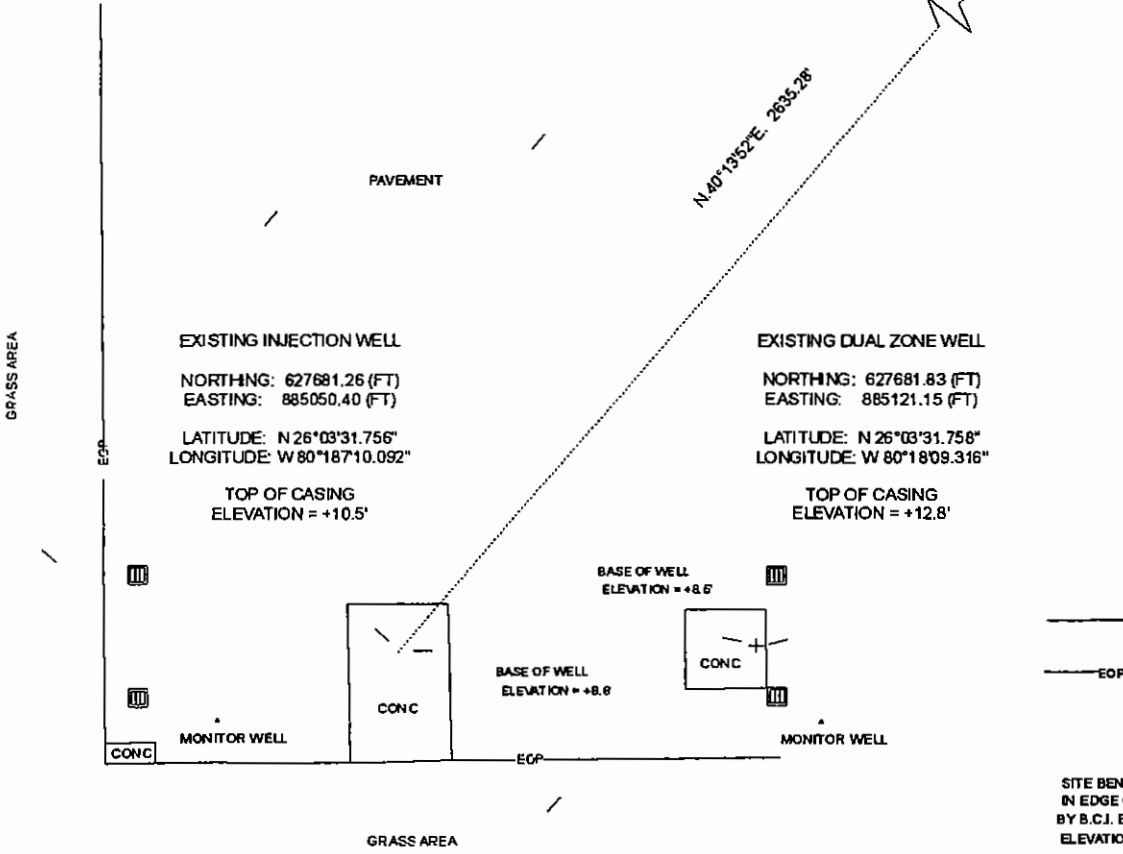

— EOP —  
 — EOP —

SITE BENCHMARK: CHISELED \* □  
 IN EDGE OF CURB ESTABLISHED  
 BY B.C.I. ENGINEERS & SCIENTISTS  
 ELEVATION = +12.17'

LEGEND:  
 CONC = CONCRETE  
 EOP = EDGE OF PAVEMENT  
 □ = CATCH BASIN

**SURVEY PLAT**  
 EXISTING WELL  
 AT THE WATER TREATMENT FACILITY  
 LOCATED IN COOPER CITY,  
 BROWARD COUNTY, FLORIDA

NOTES:  
 THIS PLAT PREPARED AS A SPECIFIC PURPOSE SURVEY FOR THE PURPOSE OF LOCATING AN EXISTING WELL AT THE COOPER CITY WATER TREATMENT FACILITY IN STATE PLANE COORDINATES.

BEARINGS AND COORDINATES SHOWN HEREON ARE STATE PLANE FOR THE FLORIDA EAST ZONE NAD 83/1990 ADJUSTMENT AND BASED ON GPS RTK OBSERVATIONS TO CONTROL STATION "CHARLIE".

ELEVATIONS SHOWN HEREON ARE BASED ON THE NATIONAL GEODETIC VERTICAL DATUM OF 1929 (NGVD 29), FROM TIEC TO CONTROL STATION "CHARLIE" ELEVATION = +8.95'.

UNDERGROUND IMPROVEMENTS, UTILITIES AND/OR FOUNDATIONS WERE NOT LOCATED UNLESS OTHERWISE SHOWN OR NOTED.

DATE OF LAST FIELD WORK: 9-13-2001



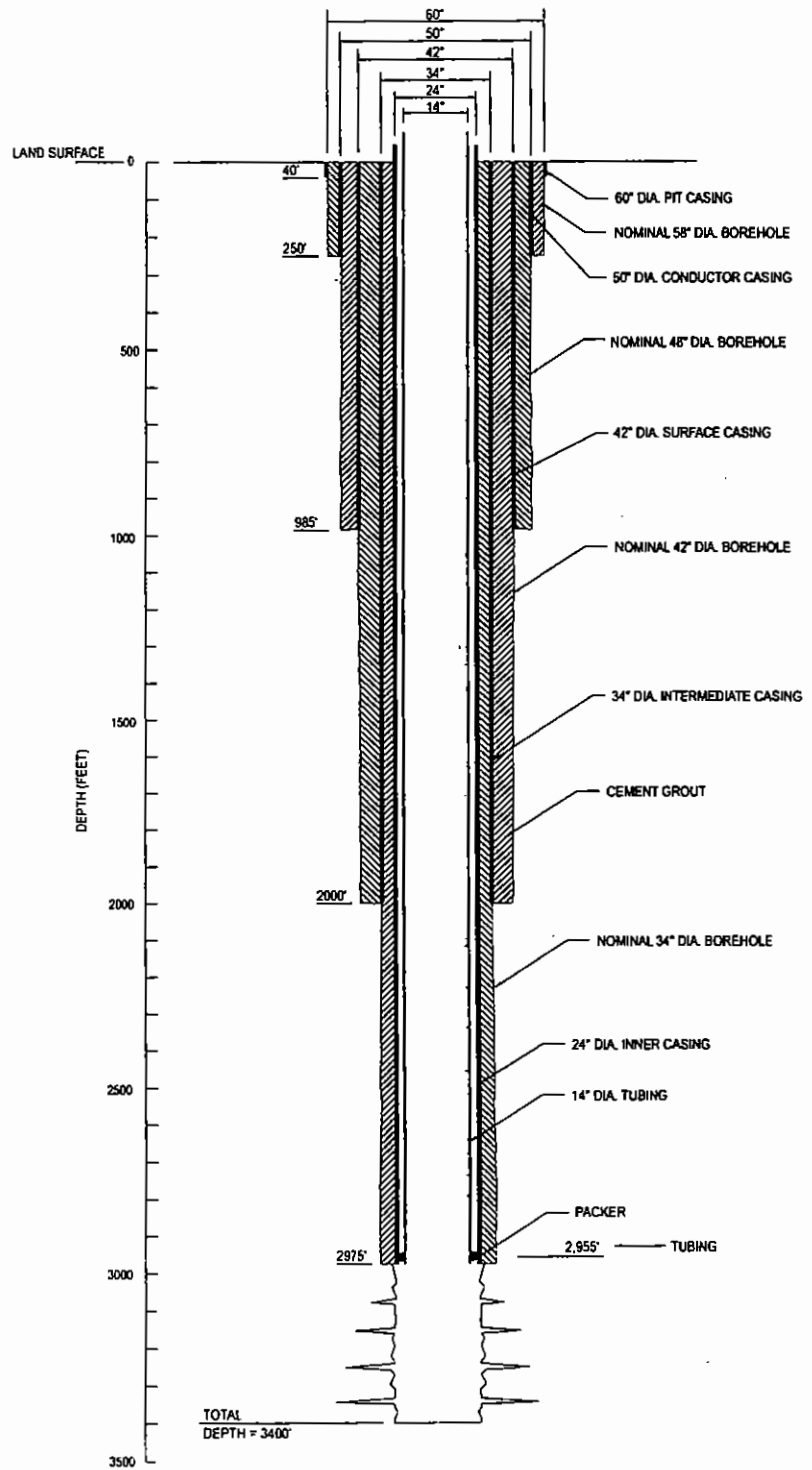

INJECTION WELL DIAGRAM  
N.T.S.

11-21-01  
*Albert Muniz*  
 ALBERT MUNIZ, P.E.  
 Registration No. 35587

*James A. Wheatley* 11-21-01  
 JAMES A. WHEATLEY, P.G.  
 Registration No. 530



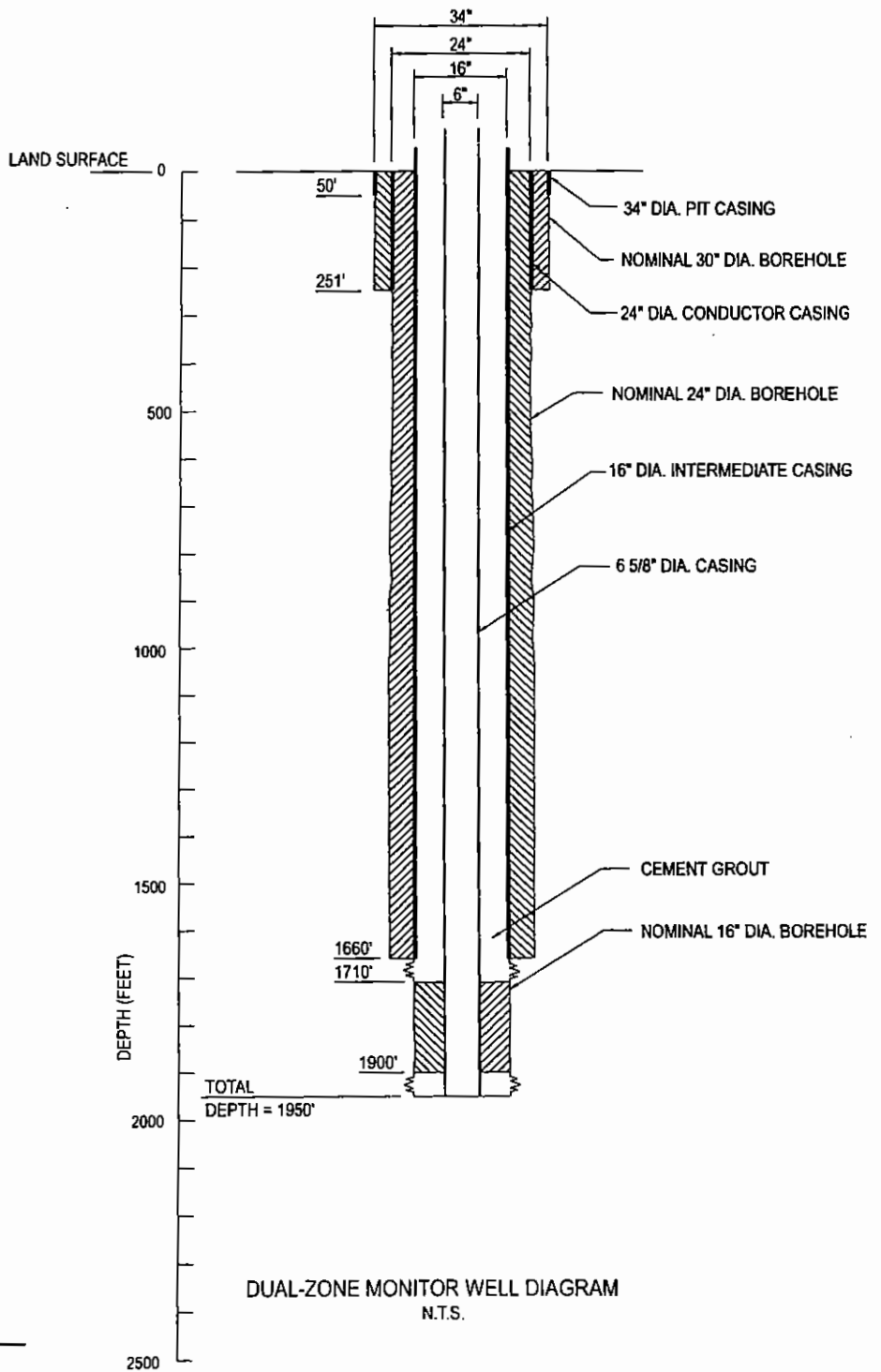

11-21-01

*Albert Muniz*  
 ALBERT MUNIZ, P.E.  
 Registration No. 35587

*James A. Wheatley* 11-21-01  
 JAMES A. WHEATLEY, P.G.  
 Registration No. 530

