

Page 1 of 5

DEPARTMENT OF THE INTERIOR
GEOLOGICAL SURVEY

WATER RESOURCES BRANCH

261058

WELL SCHEDULE

Date 7-19, 19 50 Field No. H.E-3

Record by CBS & KLW Office No. _____

Source of data PERS. OBS.

1. Location: State FLA. County HENDRY

Map see reverse of page 3 & 5

NE SW $\frac{1}{4}$ SE $\frac{1}{4}$ sec. 12 T 48 $\frac{N}{S}$ R 33 $\frac{E}{W}$

2. Owner: USGS Address _____

Tenant _____ Address _____

Driller USGS Address _____

3. Topography FLAT PINE LAND

4. Elevation _____ ft. above
_____ ft. below

5. Type: Dug, drilled, driven, bored, jetted 7-19-50

6. Depth: Rept. about 10 ft. Meas. _____ ft.

7. Casing: Diam. 6 in., to _____ in., Type _____

Depth 8.2 l.s. ft., Finish rock fill up to -5.3 l.s.

8. Chief Aquifer FINE SAND 112 NRSD From _____ ft. to _____ ft.

Others _____

9. Water level 4.79 ft. rept. 7-21 19 50 above TOP OF
meas. _____ below _____

FLANGE* (see reverse) which is 2.5 ft. above
_____ below surface

10. Pump: Type _____ Capacity _____ G. M.

Power: Kind _____ Horsepower _____

11. Yield: Flow _____ G. M., Pump _____ G. M., Meas., Rept. Est. _____

Drawdown _____ ft. after _____ hours pumping _____ G. M.

12. Use: Dom., Stock, PS., RR., Ind., Irr., Obs.

Adequacy, permanence _____

13. Quality _____ Temp _____ °F.

Taste, odor, color _____ Sample Yes
_____ No

Unfit for _____

14. Remarks: (Log, Analyses, etc.) black sandy loam 0-2 1/2

NEW WELL REPLACING OLD (over)
12-76 MP: 21.622'
12-19 MP: 21.6'
shelf yellow sandy clay 2 1/2-3
yellow marl 3-5
vetan silty, sandy sand 5-8

261903 of 053101

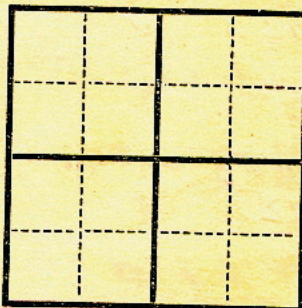

Measuring Point

HE 3 reported in 1949 WL Report as G138

OLD HE 3 (well schedule 1-15-42) = A Destroyed

HE 3 as of 5-18-43 = B Destroyed

NEW HE 3 as of 7-19-50 = C 7-18-50

	<u>A</u>	<u>B</u>	<u>C</u>
MP =	top of casing	metal angle 0.51' above 8" flange	top of 6" flange 0.09' above top of casing
MP. above l.s.	2.5'	2.5'	2.5'

landsurface datum same for all 3 wells

REF POINT, 1.06' below top flange of Well B
∴ MP of B = 1.57 + Ref Point

Well C = top of casing 1.48' above Ref point (RM #1)

Well C, MP, top of flange = 1.57' above ref point
= 1.58' " " " " by M-E-S
" " " " " " " " 11/10/48

See reverse of page 5 for
other Ref. marks.

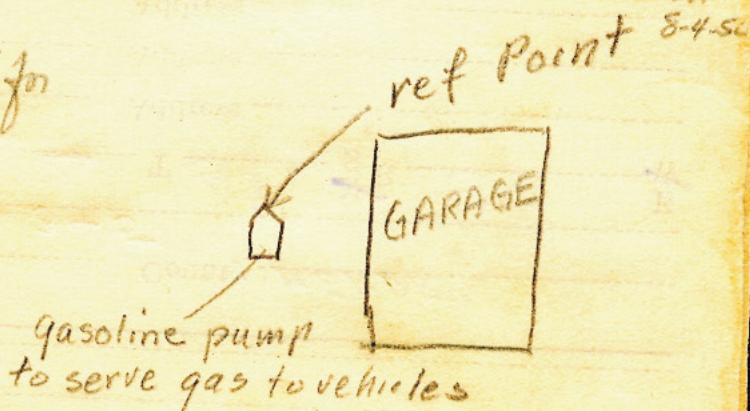

NOTE REF POINT = \square in concrete
pump island

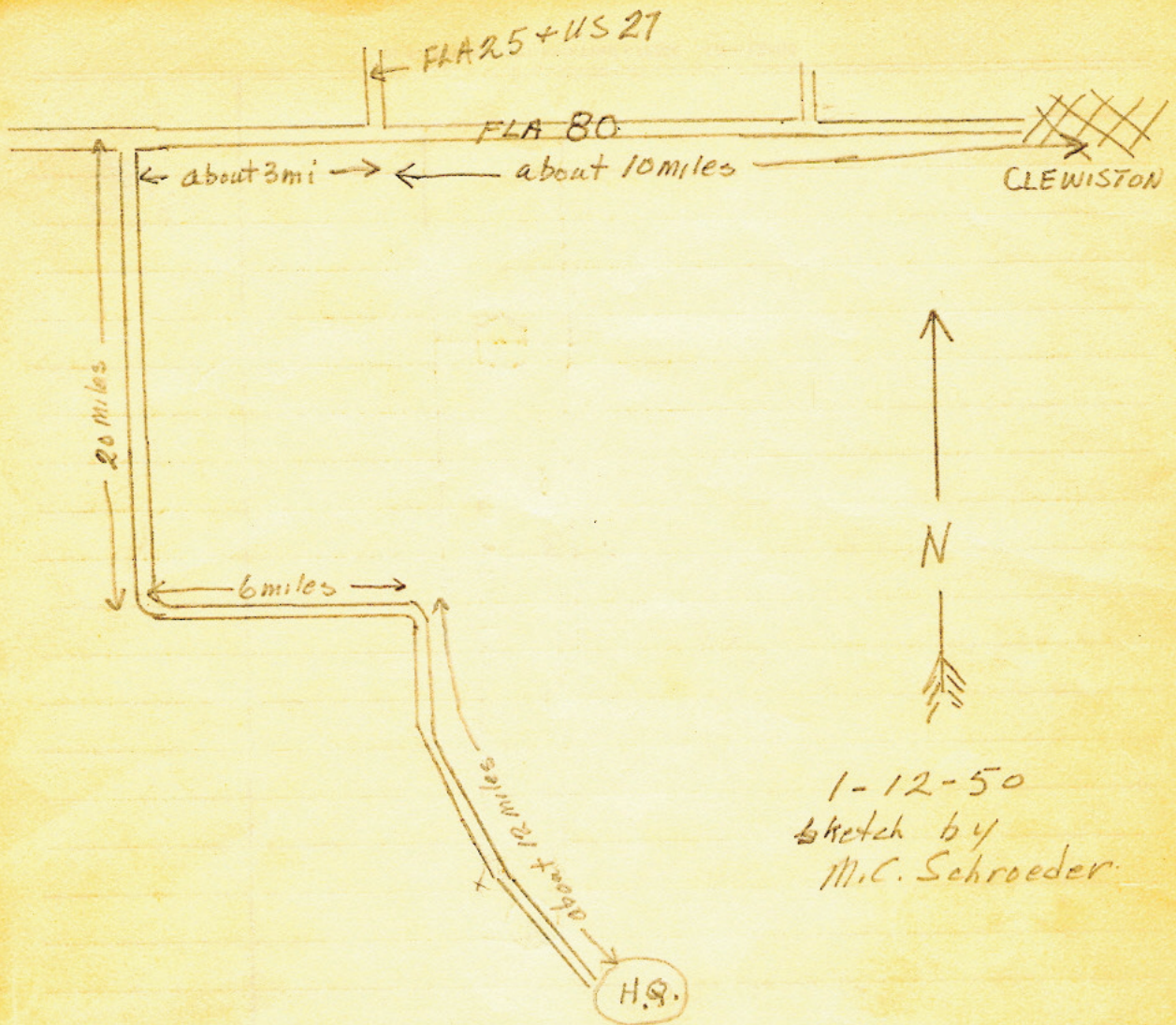

1-12-50
 sketch by
 M.C. Schroeder.

Head quarters of
 Big Cypress INDIAN Res.

see back of
 page 5

H-3

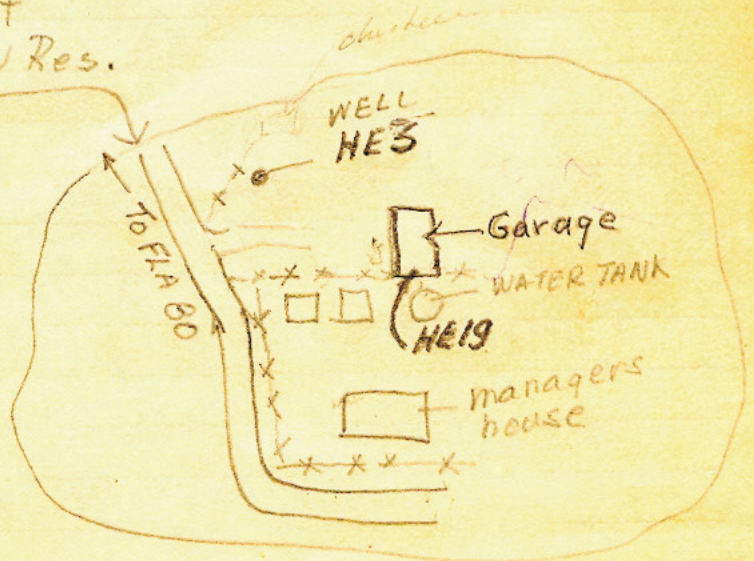

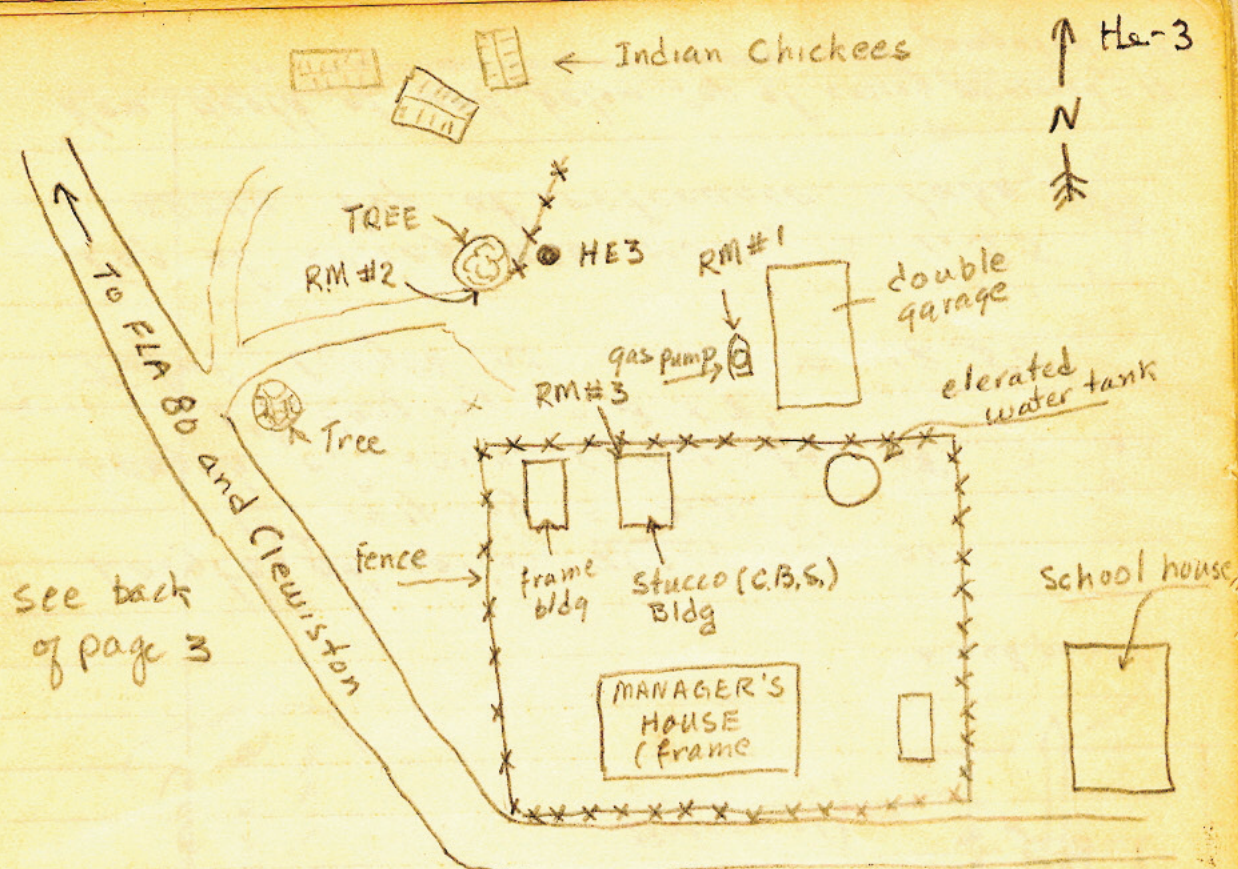

8-4-50 NDH & MCS

- RM#1 chiseled \square on concrete gasoline service pump island, which is 1.58' below top of flange of well
- RM#2 concrete nail above copper nail in south side of tree about 1.8' above h.s. and 25' S.W. of well = 0.44' below top of flange on well casing
- RM#3 \square cut in concrete foundation of C.B.S. bldg (N.W. corner) 75-100' south of well = 1.60' below top of flange on well casing

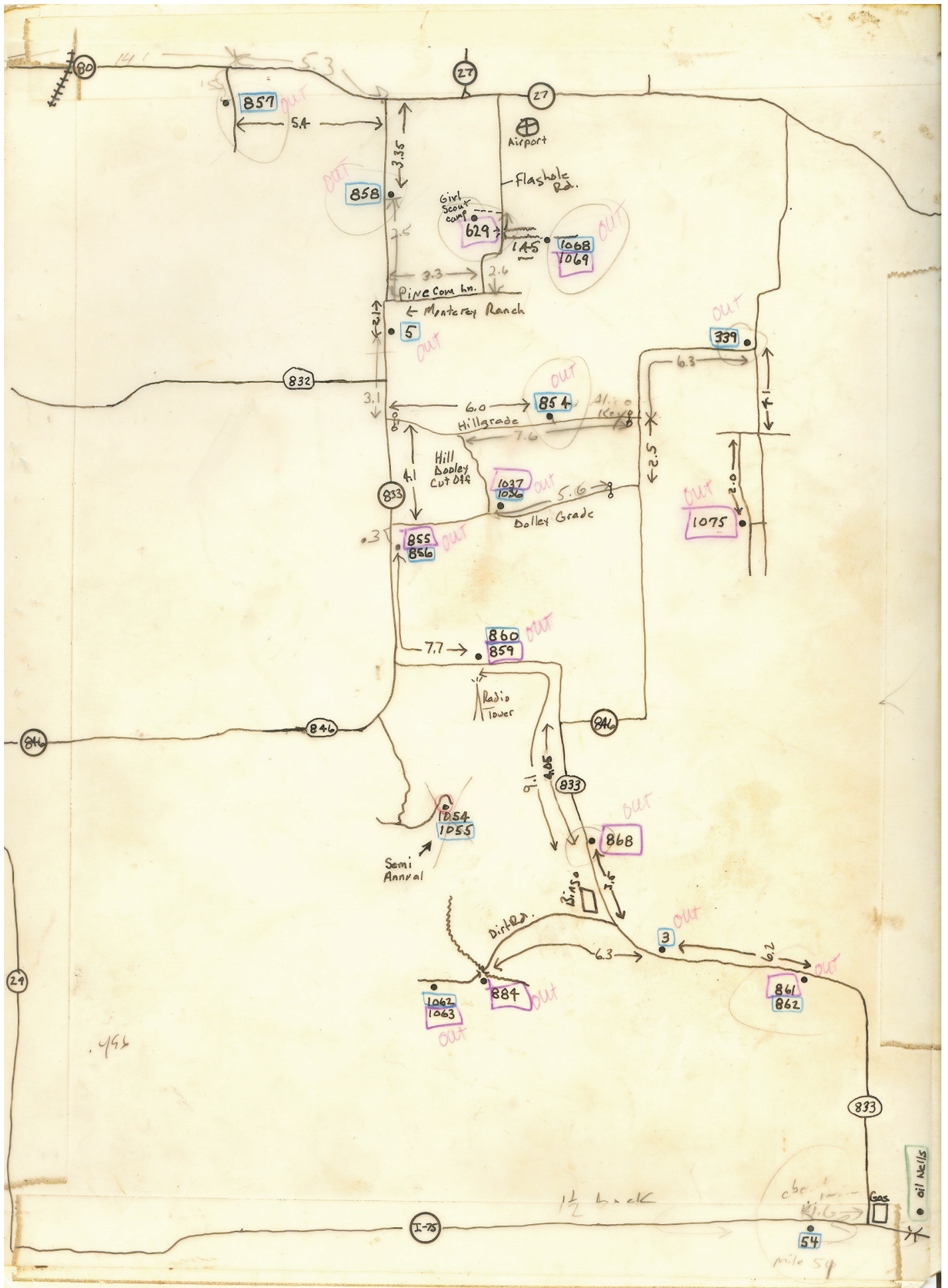

DEPARTMENT OF THE INTERIOR
GEOLOGICAL SURVEY
WATER RESOURCES DIVISION

WELL SCHEDULE

Date 11-1, 1976 Field No. He-629
Record by Thomas O'Donnell & Henry Lopez Office No. _____
Source of data Test Drilling Field Recon

1. Location: State Florida County Hendry
Map LA BELLE NE (11)
NE 1/4 NW 1/4 NE 1/4 sec. 6 T 44 N R 33 E
2. Owner: Girl Scouts Address _____
Tenant _____ Address Flag hole Rd
Driller Crumb Address Clewiston
3. Topography COASTAL PLAIN
4. Elevation 20 ft. above MSL
5. Type: Dug, drilled, driven, bored, jetted 2 1975
6. Depth: Rept. _____ ft. Meas. 144 ft.
7. Casing: Diam. 2 in., to _____ in., Type Steel
Depth 133 ft., Finish open hole
8. Chief Aquifer Tamiami 122 mmm From _____ ft. to _____ ft.

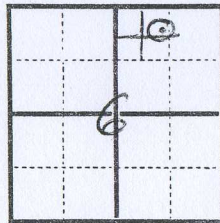

- Others _____
9. Water level 1.9 ft. rept. 11-1, 1976 above meas. below
LSD which is 20 ft. above below MSL surface
10. Pump: Type _____ Capacity _____ G. M.
Power: Kind _____ Horsepower _____
11. Yield: Flow _____ G. M., Pump _____ G. M., Meas., Rept. Est. _____
Drawdown _____ ft. after _____ hours pumping _____ G. M.
12. Use: Dom., Stock, PS., RR., Ind., Irr., Obs. unused
Adequacy, permanence _____
13. Quality _____ Temp. _____ °F.
Taste, odor, color _____ Sample Yes _____ No _____
Unfit for _____

14. Remarks: (Log, Analyses, etc.) periodic water level measurements
beginning 9-77

Test hole 60 50'
4" PVC casing to 15'
open hole to 2'
264137
2810407A
10-7-76

S-27

Fingholp Rd

0.1 MI

0.175 MI

← Girl Scout CAMP

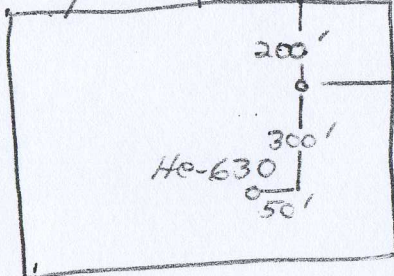

200'

He-629

300'

He-630

50'