

COMMENTS

207

B.M. OKS-90 - 1 1/4" GALV. I. PIPE W/ S.F.W. M.D. DSK PG-13

GRND @ WELL # OKS-90D02 (PIPE IS 1.1' ABOVE GRND LEVEL)

WELL # OKS-90D02 TOP AND INSIDE OF 2" P.V.C. WELL ELEV. IS AN "X" MARK PAINTED RED. NOTE WELL BROKE OFF CUT BEING ELEV. IN WEST MOST WELL.

U.S. HWY 441

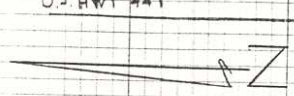

WELL # OKS-90D01 TOP AND INSIDE OF 2" P.V.C. WELL ELEV. IS AN "X" MARK PAINTED RED. WELL IS 2.1' ABOVE THE LEVEL OF THE GRND.

WELL # OKS-90D01 TOP AND INSIDE OF 2" P.V.C. WELL ELEV. IS AN "X" MARK PAINTED RED. WELL IS 1.9' ABOVE THE LEVEL OF THE GRND. EAST MOST WELL.

WELL # OKS-90S01 TOP AND INSIDE OF 2" P.V.C. WELL ELEV. IS AN "X" MARK PAINTED RED. WELL IS 3.5' ABOVE THE LEVEL OF THE GRND. WEST MOST WELL.

B.M. OKS-90 F0-13 AND PG-15

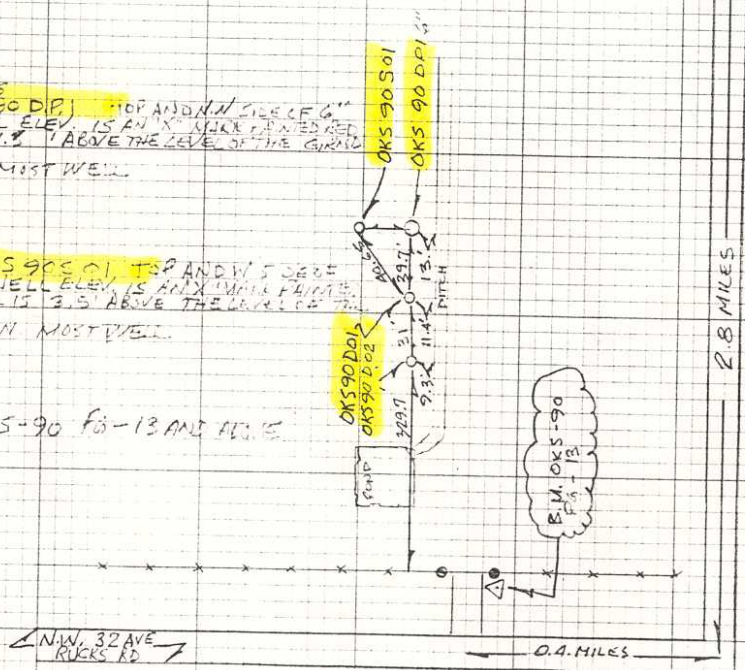

S.R. 68

90