

**Location of Palm Beach County Saltwater Monitor Well Network - Phase I**



## Palm Beach County Saltwater Monitor Well Construction Specifications

Well Name	Site Name	Approx. Latitude	Approx. Longitude	Total Depth Feet b/s	Screen Feet b/s	Elevation Top of Casing (NGVD 1929)
PB-1768	Lake Worth School	263734	800312	257	200	13.79
PB-1769	Lantana-A.G. Holy	263522	800330	337	105	17.76
PB-1770	Hypoluxo-Miner Rd	263328	800323	257	200	14.64
PB-1771	Boyton Bch-Sea Crest	262952	800354	277	90	14.88
PB-1772	Delray- Miller Park	262557	800433	260	95	17.20
PB-1773	Boca Raton- Sand Park	262354	800440	257	200	8.88

## PALM BEACH COUNTY SALTFRONT - PHASE I

## Wells Elevations (MP's) and Location

Well	Elevation (TOC)*	Lat/Long
PBC - 1	13.79	26° 37' 34" 80° 03' 12"
PBC - 2	17.76	26° 35' 22" 80° 03' 30"
PBC - 3	14.64	26° 33' 28" 80° 03' 23"
PBC - 4	14.88	26° 29' 52" 80° 3' 54"
PBC - 5	17.20	26° 25' 57" 80° 04' 33"
PBC - 6	8.88	26° 23' 54" 80° 04' 40"

- in feet above NGVD of 1929

# USGS Well PB-1768

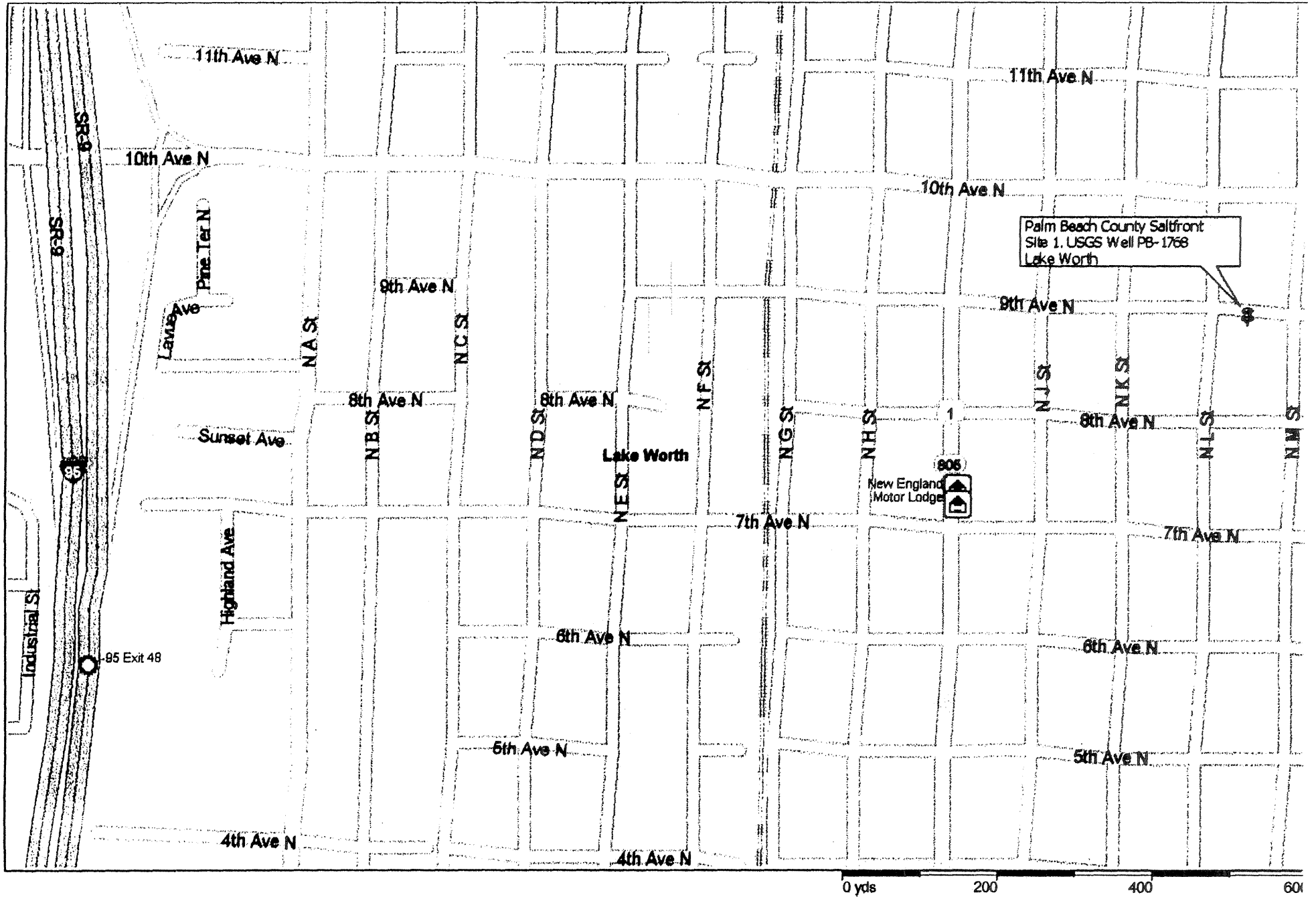



Apartments

Apartments

"L" Street

9th Avenue

Water Main

Retention Pond

Well Location

Fence

North Grade Elementary School

"M" Street

Baseball Field

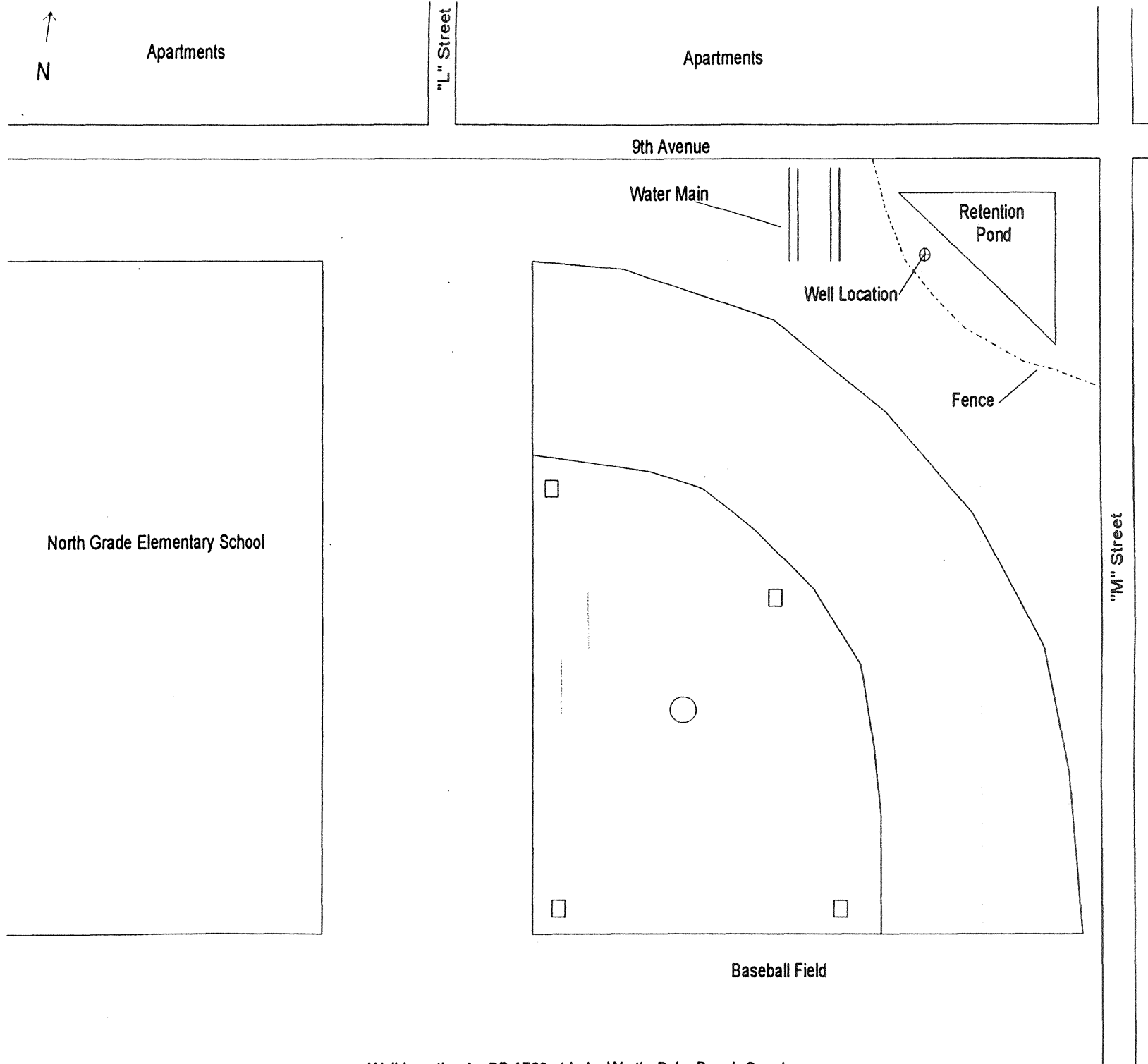



N



Open Field

Fence

Well Location



Sign  
"AG Holley  
Hospital"

Entrance Road

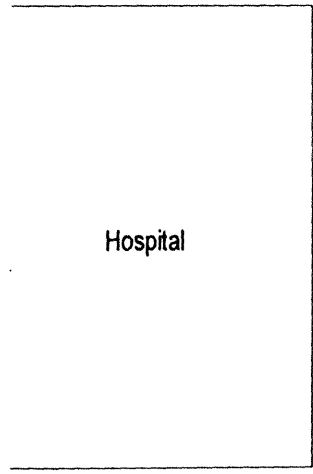

Hospital

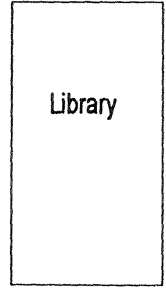

Library

8th Street

Lantana Road

Well Location for PB-1769 at Lantana, Palm Beach County







Dead End

Vacant Lot

Loomis Street

Well Location

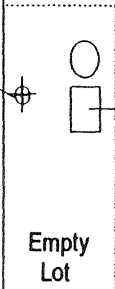

Old Pump House and Water Tank

FEC Railroad

US 1

Miner Road

Well Location for PB-1770 at Hypoluxo, Palm Beach County

# USGS Well PB-1771

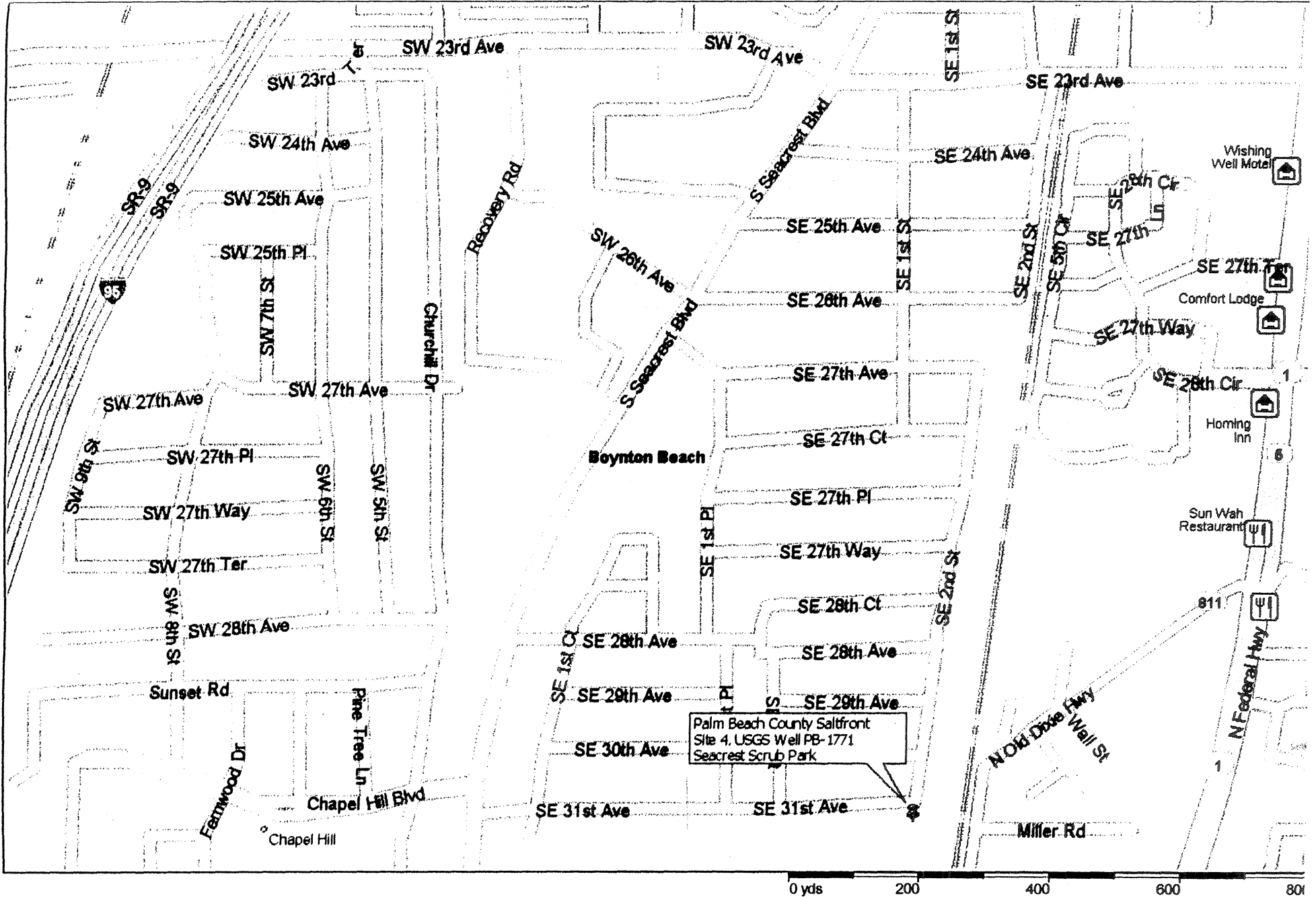

N ↑

Seacrest Blvd

SE 31st Avenue

2nd Street

Fence

Gate

Dirt Road

Well Location

Seacrest Scrub  
Natural Area  
County Park

FEC Railroad

Well Location for PB-1771 at Boynton Beach, Palm Beach County

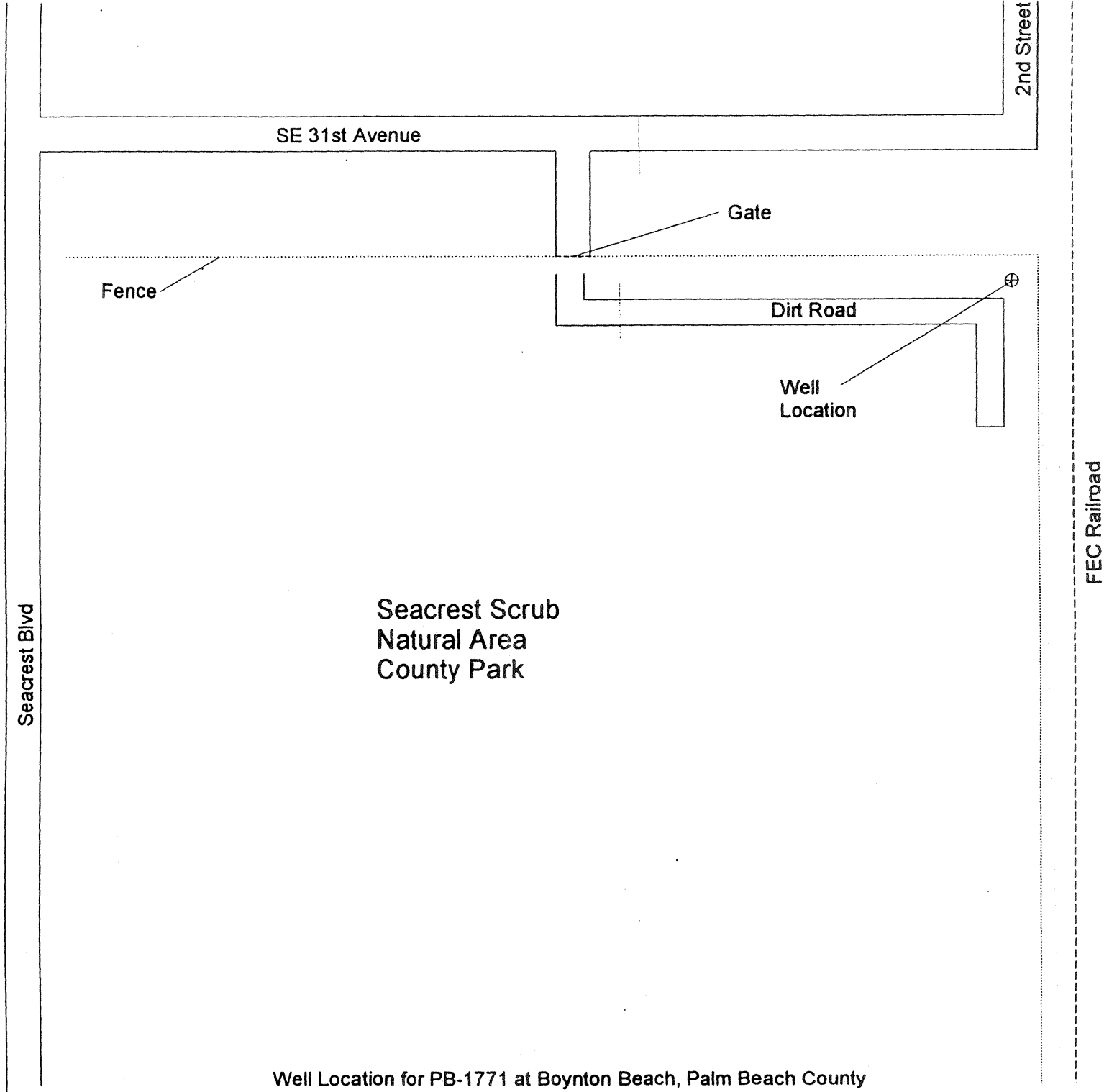

# USGS Well PB-1772

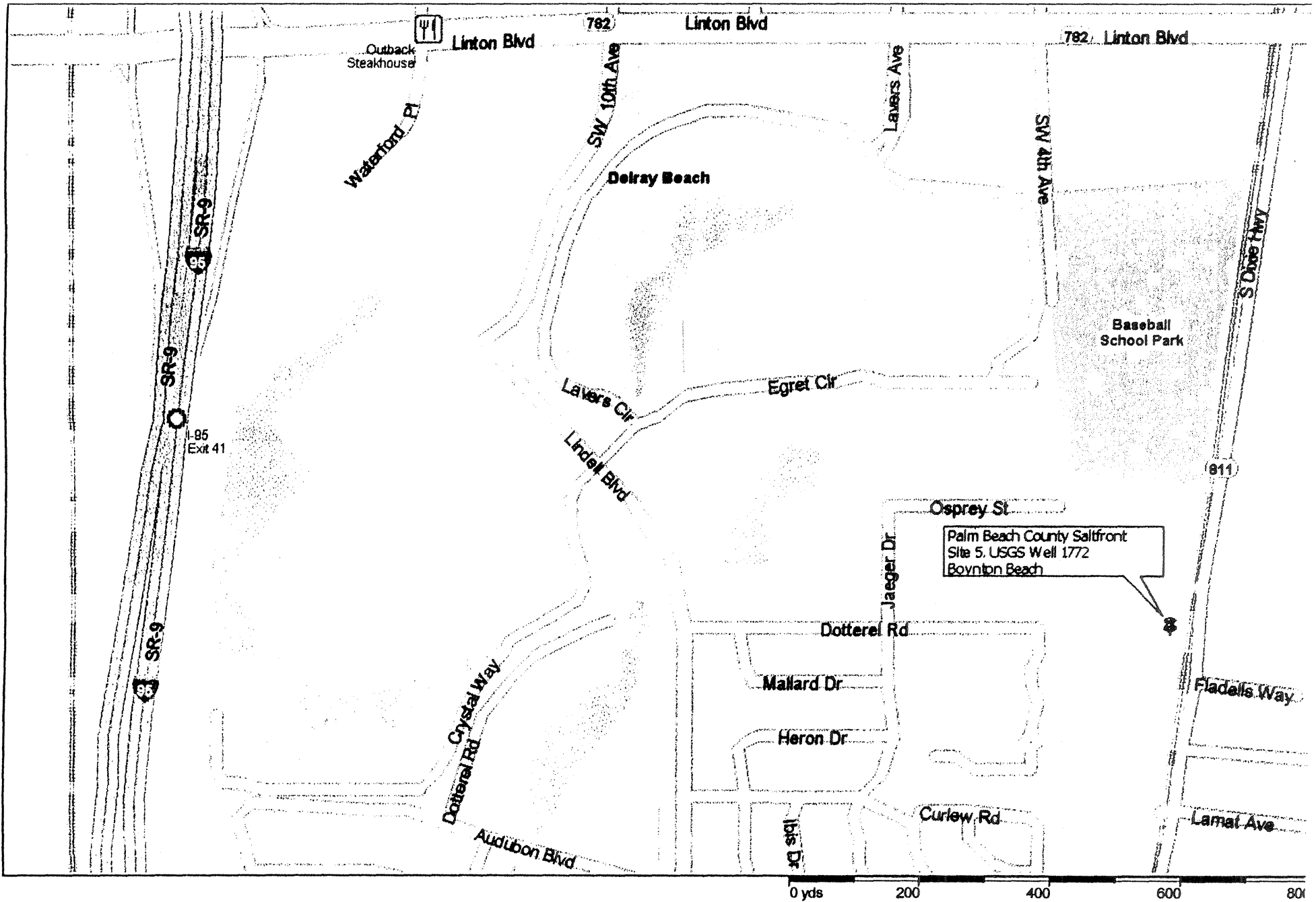

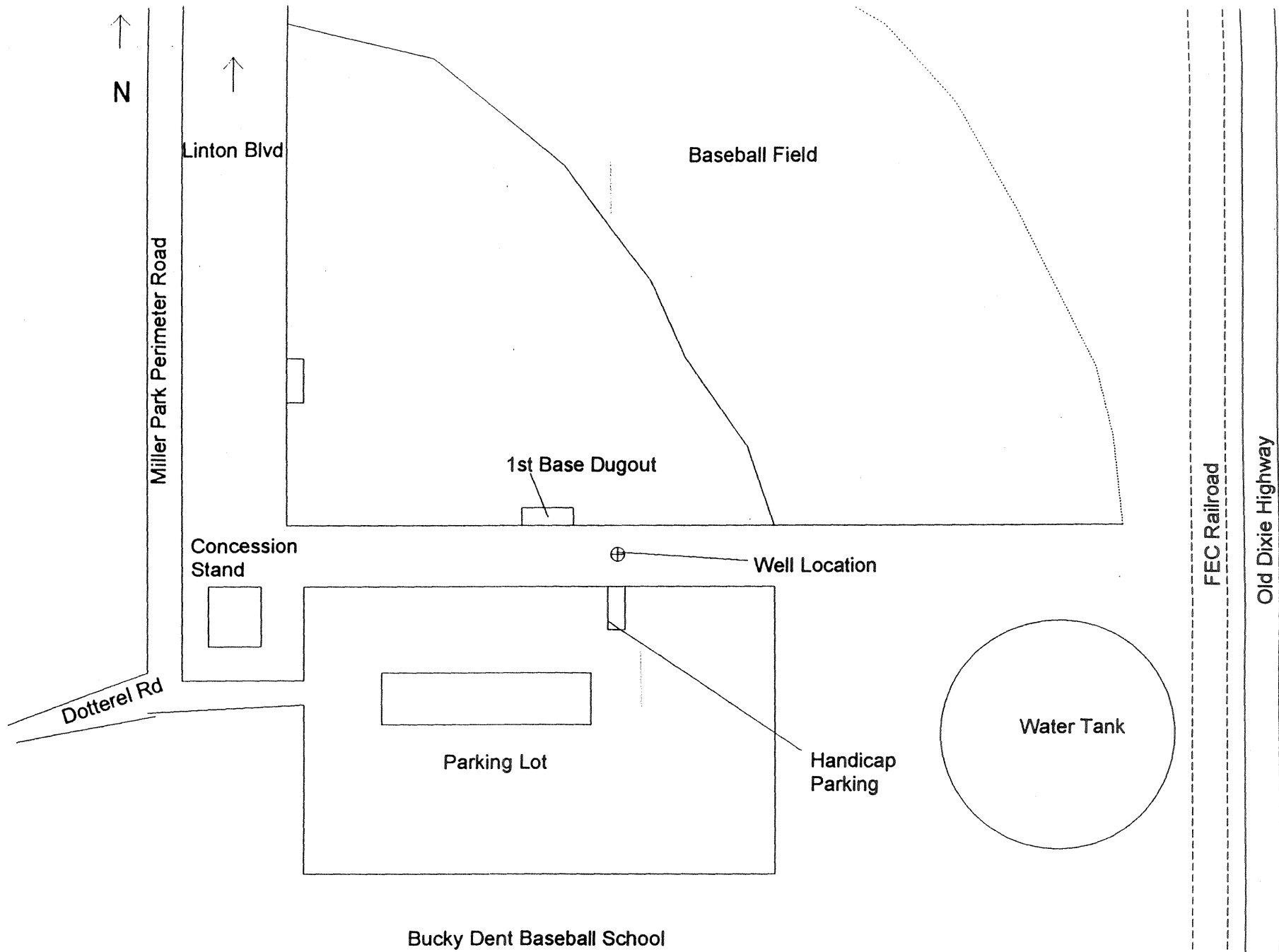

Well Location for PB-1772 at Delray Beach, Palm Beach County

# USGS Well PB-1773

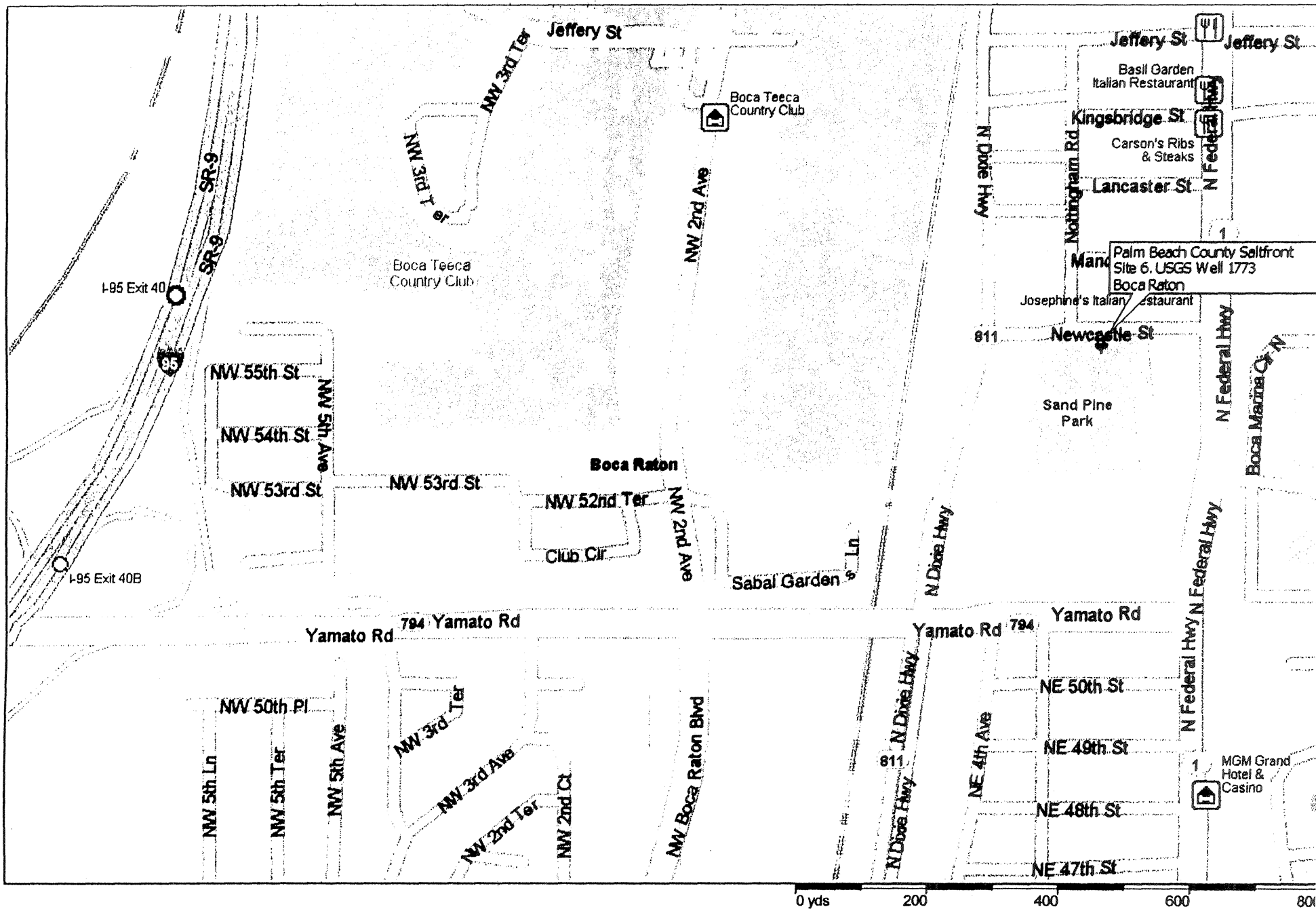

↑  
N

Nottingham Road

New Castle Street

20 ft



← Power Lines →

Open Space Right of Way

Sidewalk

Well Location ⊕

Green Space

Police Sub Station

Parking

Sand Pine Park

Not to Scale

US-1 →

Yamato Road

