



IN REPLY REFER TO:

South Florida Water Management District

John R. Maloy, Executive Director
John R. Wodraska, Deputy Executive Director

Post Office Box V 3301 Gun Club Road
West Palm Beach, Florida 33402
Telephone (305) 686-8800
Florida WATS Line 1-800-432-2045

February 28, 1984

Mr. T. H. Melton
Department of Transportation
Riverbend Estates Road
LaBelle, FL

Dear Mr. Melton:

Enclosed please find the amended and signed permits for the wells that the South Florida Water Management District drilled during January and February of this year. The stated changes have been approved by Irene Quincey and Mike Ridder of the SFWMD's and DOT's legal departments, respectively.

These wells were installed on DOT right-of-ways, and will be pumped and/or monitored during a series of investigative pump tests.

Attached to each permit are maps of the approximate location of each well along with the following information:

- 1) approximate well locations measured from the center of adjacent roads;
- 2) approximate location of FPL power lines;
- 3) approximate location of buried United Telephone lines;
- 4) adjacent property owners; and
- 5) other distinguishing landmarks.

Once this project is completed, the Sears Road well (RTA-6) will be plugged with cement. The other two sites (RTA-5 and RTA-8) will be monitored throughout the year until further notice. Thank you for your cooperation.

Sincerely,

Tim S. Sharp, Hydrogeologist
Groundwater Division
Resource Planning Division

TSS:hm
Enclosures

cc: Scott Burns
United Telephone
Florida Power & Light, Ft. Myers

Robert L. Clark, Jr.
Chairman - Fort Lauderdale

Stanley W. Hole
Vice Chairman-Naples

J. Neil Gallagher
St. Cloud

Nathaniel P. Reed
Hobe Sound

Kathleen Shea Abrams
Miami Shores

John F. Flanigan
North Palm Beach

Timer E. Powers
Indiantown

William E. Sadowski
Miami

Kent Price
Okeechobee



March 20, 1984

RE: Section 05090
SR 29

- South Florida Water Management District
- Mr. Tim S. Sharp
- P.O. Box V
- West Palm Beach, Florida 33402

Dear Sir:

Please find enclosed all four copies of your permit 05-02-84 which is being returned for the following reasons:

- Unathorized signature
- Corporate seal not affixed
- Show other utilities on typical section and/or plan view
- Quality of drawing not acceptable
- Drawing lacks pertinent information
- Drawing does not show acceptable physical ties
- Permit not complete on page _____
- Drawing does not show north arrow
- Drawing does not show roadway section number
- Drawing does not show state road number
- Drawing does not show rights-of-way widths
- Drawing does not show offset distance from centerline
- OTHER
 - 1.) Permit must have Corporate Seal Affixed.
 - 2.) Submit four (4) copies of sketches using the attached plan & typical drawing.
 - 3.) Show detail and location of proposed wells. Permit & sketch conflict with offset distances from centerline.
 - 4.) Show distance from proposed wells to Jct. SR 78.
 - 5.) See permit copy in red.
 - 6.) See Plan & Typical drawing.
 - 7.) Need four (4) copies of Permit with original signatures and Corporate Seal affixed along with four (4) copies of sketch.

Should you desire to contact our office regarding this permit, please ask for
T.H. Melton 675-1737

Yours very truly,

T. H. MELTON
ASST. MAINTENANCE ENGINEER

STATE OF FLORIDA DEPARTMENT OF TRANSPORTATION

PERMIT

DATE 02/24/84
 SUBJECT: Section NE NE; 20 T45 R29 State Road 29 PERMIT NO. _____
 PERMITTEE South Florida Water Management District County Hendry

Requesting permission from the State of Florida Department of Transportation, hereinafter called the Department, to

construct, operate and maintain three groundwater monitoring wells RTA-5
 from MP Station _____ to MP Station _____

1. Proposed work is within the corporate limits of a municipality. Yes () No (X)
 Name of municipality _____
2. Applicant declares that prior to submitting this application he has ascertained the location of all existing utilities, both aerial and underground.
 A letter of notification and plan of improvement was mailed on 02/27/84 to the following utilities/municipalities.
United Telephone; Florida Power and Light

3. Is Interstate or Toll Road right-of-way involved? Yes () No (X)
4. It is expressly stipulated that this permit is a license for permissive use only and that the placing of facilities upon public property pursuant to this permit shall not operate to create or vest any property right in said holder.
5. Whenever necessary for the construction, repair, improvement, maintenance, safe and efficient operation, alteration or relocation of all, or any portion of said highway as determined by the Director of the Division of Road Operations any or all facilities and appurtenances authorized hereunder, shall be immediately removed from said highway, reset or relocated thereon as required by the Director of the Division of Road Operations and at the expense of the permittee.
6. The construction and maintenance of such facility shall not interfere with the property and rights of a prior permittee.
7. It is understood and agreed that the rights and privileges herein set out are granted only to the extent of the State's right, title and interest in the land to be entered upon and used by the holder, and the holder will, at all times, assume all risk of and indemnify, defend, and save harmless the State of Florida and Department from and against any and all loss, damage, cost or expense arising in any manner on account of the exercise or attempted exercises by said holder of the aforesaid rights and privileges. During construction, all safety regulations of the Department shall be observed and the holder must take measures, including placing and display of safety devices, and may be necessary in order to safely conduct the public through the project area in accordance with the Department's Manual on Traffic Controls and Safe Practices for street and highway construction, maintenance and utility operation.
8. In case of noncompliance with the Department's requirements this permit is void and the facility will have to be brought into compliance or removed from the R/W at no cost to the Department.
9. All work shall meet Department standards and be performed under the supervision of _____ Maintenance or Resident Engineer, located at _____, Florida.
10. All materials and equipment shall be subject to inspection by the Maintenance or Resident Engineer.
11. The office of the Maintenance or Resident Engineer named in paragraph nine (9) shall be notified twenty-four (24) hours in advance before starting work and immediately upon completion.
12. All Department property shall be restored to its original condition as far as practical, in keeping with Department specifications, and in a manner satisfactory to the Department.
13. The attached sketch and special provisions covering details of this installation shall be made a part of this permit.
14. The permittee shall commence actual construction in good faith within sixty (60) days from the date of said permit approval and shall be completed within 60 days.
15. Special conditions: Well sites are located 50 feet from the center line on the west side of SR 29.

16. Special instructions: Wells will be marked and located to prevent maintenance crews from damaging wells.

*to the extent permitted by Florida law,
 Submitted by: South Florida Water Management District

Tim Sharp Hydrogeologist
 Signature and Title

Place
 Corporate
 Seal

Roadway construction is proposed or underway Yes () No ()

Recommended for approval _____
 Maintenance Engineer

Approved by: _____
 District Engineer

Attested _____

Date _____

Date _____

STATE OF FLORIDA DEPARTMENT OF TRANSPORTATION

PERMIT

DATE 02/24/84
SUBJECT: Section SW SW; 16 T44 R29 State Road 29 PERMIT NO. Hendry
PERMITTEE South Florida Water Management District County

Requesting permission from the State of Florida Department of Transportation, hereinafter called the Department, to

construct, operate and maintain one six-inch diameter monitoring well RTA-6
from MP Station to MP Station

- 1. Proposed work is within the corporate limits of a municipality. Yes () No (X)
Name of municipality
2. Applicant declares that prior to submitting this application he has ascertained the location of all existing utilities, both aerial and underground.
A letter of notification and plan of improvement was mailed on 02/27/84 to the following utilities/municipalities.
United Telephone; Florida Power and Light
3. Is Interstate or Toll Road right-of-way involved? Yes () No (X)
4. It is expressly stipulated that this permit is a license for permissive use only and that the placing of facilities upon public property pursuant to this permit shall not operate to create or vest any property right in said holder.
5. Whenever necessary for the construction, repair, improvement, maintenance, safe and efficient operation, alteration or relocation of all, or any portion of said highway as determined by the Director of the Division of Road Operations any or all facilities and appurtenances authorized hereunder, shall be immediately removed from said highway, reset or relocated thereon as required by the Director of the Division of Road Operations and at the expense of the permittee.
6. The construction and maintenance of such facility shall not interfere with the property and rights of a prior permittee.
7. It is understood and agreed that the rights and privileges herein set out are granted only to the extent of the State's right, title and interest in the land to be entered upon and used by the holder, and the holder will, at all times, assume all risk of and indemnify, defend, and save harmless the State of Florida and Department from and against any and all loss, damage, cost or expense arising in any manner on account of the exercise or attempted exercises by said holder of the aforesaid rights and privileges. During construction, all safety regulations of the Department shall be observed and the holder must take measures, including placing and display of safety devices, and may be necessary in order to safely conduct the public through the project area in accordance with the Department's Manual on Traffic Controls and Safe Practices for street and highway construction, maintenance and utility operation.
8. In case of noncompliance with the Department's requirements this permit is void and the facility will have to be brought into compliance or removed from the R/W at no cost to the Department.
9. All work shall meet Department standards and be performed under the supervision of Maintenance or Resident Engineer, located at , Florida.
10. All materials and equipment shall be subject to inspection by the Maintenance or Resident Engineer.
11. The office of the Maintenance or Resident Engineer named in paragraph nine (9) shall be notified twenty-four (24) hours in advance before starting work and immediately upon completion.
12. All Department property shall be restored to its original condition as far as practical, in keeping with Department specifications, and in a manner satisfactory to the Department.
13. The attached sketch and special provisions covering details of this installation shall be made a part of this permit.
14. The permittee shall commence actual construction in good faith within sixty (60) days from the date of said permit approval and shall be completed within 60 days.
15. Special conditions: Well is to be plugged with cement and cut off three feet below land surface by April 14, 1984.
16. Special instructions: Well will be marked and located to prevent maintenance crews from damaging the well.

*to the extent permitted by Florida law,
Submitted by: South Florida Water Management District

Signature and Title: Tim S. Sharp, Hydrogeologist

Place Corporate Seal

Roadway construction is proposed or underway Yes () No ()
Recommended for approval Maintenance Engineer
Approved by: District Engineer

Attested
Date
Date

STATE OF FLORIDA DEPARTMENT OF TRANSPORTATION

PERMIT

DATE 02/24/84

SUBJECT: Section 35090 State Road 29 County Glades PERMIT NO. 05-02-84

PERMITTEE South Florida Water Management District **MAILING ADDRESS**

Requesting permission from the State of Florida Department of Transportation, hereinafter called the Department, to

construct, operate and maintain three groundwater monitoring wells RTA-8
 from MP Station _____ to MP Station _____

1. Proposed work is within the corporate limits of a municipality. Yes () No (X)
 Name of municipality _____

2. Applicant declares that prior to submitting this application he has ascertained the location of all existing utilities, both aerial and underground.
 A letter of notification and plan of improvement was mailed on 02/27/84 to the following utilities/municipalities.
United Telephone

3. Is Interstate or Toll Road right-of-way involved? Yes () No (X)

4. It is expressly stipulated that this permit is a license for permissive use only and that the placing of facilities upon public property pursuant to this permit shall not operate to create or vest any property right in said holder.

5. Whenever necessary for the construction, repair, improvement, maintenance, safe and efficient operation, alteration or relocation of all, or any portion of said highway as determined by the Director of the Division of Road Operations any or all facilities and appurtenances authorized hereunder, shall be immediately removed from said highway, reset or relocated thereon as required by the Director of the Division of Road Operations and at the expense of the permittee.

6. The construction and maintenance of such facility shall not interfere with the property and rights of a prior permittee.
 7. It is understood and agreed that the rights and privileges herein set out are granted only to the extent of the State's right, title and interest in the land to be entered upon and used by the holder, and the holder will, at all times, assume all risk of and indemnify, defend, and save harmless the State of Florida and Department from and against any and all loss, damage, cost or expense arising in any manner on account of the exercise or attempted exercises by said holder of the aforesaid rights and privileges. During construction, all safety regulations of the Department shall be observed and the holder must take measures, including placing and display of safety devices, and may be necessary in order to safely conduct the public through the project area in accordance with the Department's Manual on Traffic Controls and Safe Practices for street and highway construction, maintenance and utility operation.

8. In case of noncompliance with the Department's requirements this permit is void and the facility will have to be brought into compliance or removed from the R/W at no cost to the Department.

9. All work shall meet Department standards and be performed under the supervision of D.M. HEFLIN Maintenance or Resident Engineer, located at FT. MYERS, Florida.

10. All materials and equipment shall be subject to inspection by the Maintenance or Resident Engineer.

11. The office of the Maintenance or Resident Engineer named in paragraph nine (9) shall be notified twenty-four (24) hours in advance before starting work and immediately upon completion.

12. All Department property shall be restored to its original condition as far as practical, in keeping with Department specifications, and in a manner satisfactory to the Department.

13. The attached sketch and special provisions covering details of this installation shall be made a part of this permit.

14. The permittee shall commence actual construction in good faith within sixty (60) days from the date of said permit approval and shall be completed within 60 days.

15. Special conditions: ~~Well sites will be located approximately five (5) feet inside the outer edge of the right of way.. (70 feet from the center line)~~
LEAVE BLANK

16. Special instructions: Wells will be marked and located to prevent maintenance crews from damaging wells.

*to the extent permitted by Florida law,
 Submitted by: South Florida Water management District

Permittee
Tim S. Sharp Hydrogeologist
 Signature and Title
J.R. Wodraska

Place
 Corporate
 Seal

John R. Wodraska, Deputy Exec. Dir.
 Roadway construction is proposed or underway Yes () No ()

Attested

Recommended for approval _____
 Maintenance Engineer

Date

Approved by: _____
 District Engineer

Date

UNITED TELEPHONE COMPANY OF FLORIDA

DRWN. BY: BAR

LOC. CODE:

AUTH. NO.: 2443 3915

ENGR. BY:

DESCRIPTION: DOT PERMIT

APPD. BY:

DATE:

R.M. PAGE:

EQ. USE:

J.P.A.:

T.C.A.:

T.Z.:

C.O.:

I-S

SHEET

OF

S.L.D. M.P. 17.053
END JOB

SAMPLE

SEE ATTACHMENT

All activities in accordance with this permit shall adhere to the Department's Manual and Safe Practices for street and highway construction, maintenance, and utility operations.

TO LAKE PART

CR. 721 INTERSECTION

5000' TO

EXISTING UTF CA

PROPOSED UTF CABLE

20'

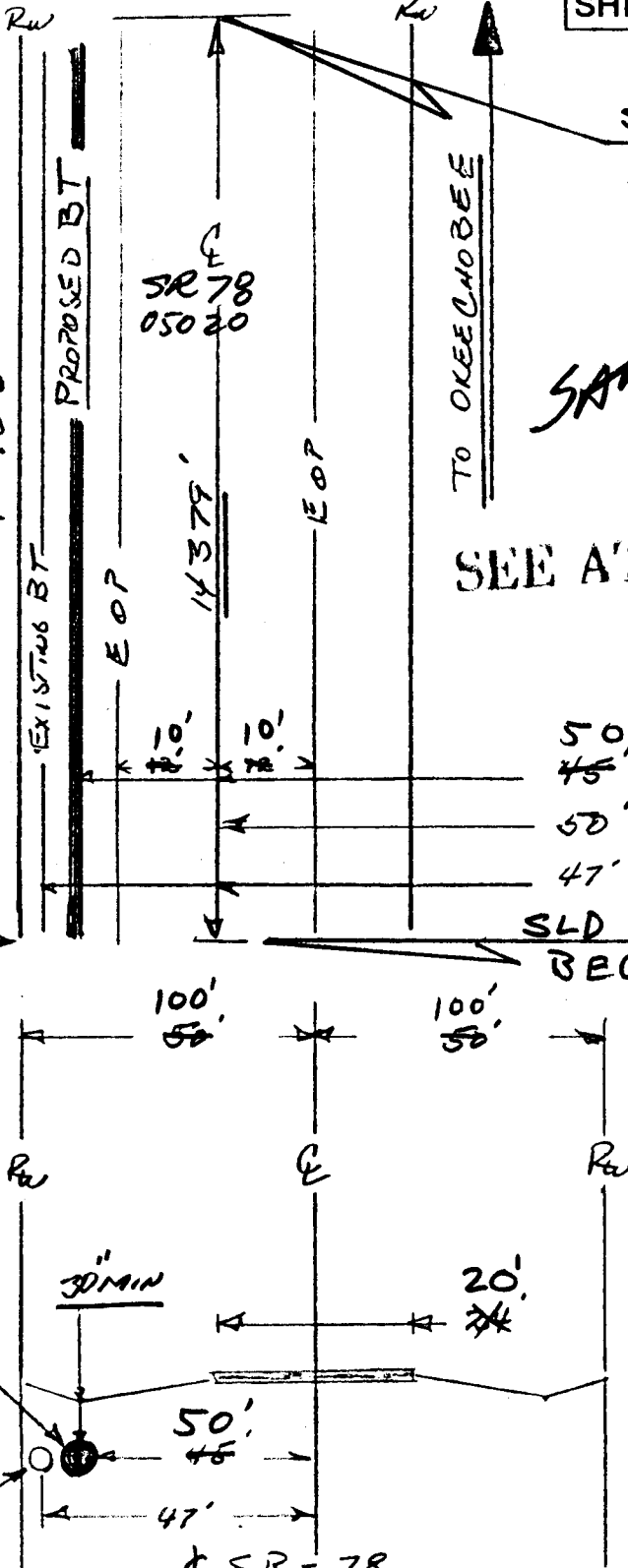

SLD M.P. 14.330
BEG. JOB

GLADES CO

PROPOSED
UTF BURIED
CABLE

SR-78
LOOKING NORTH

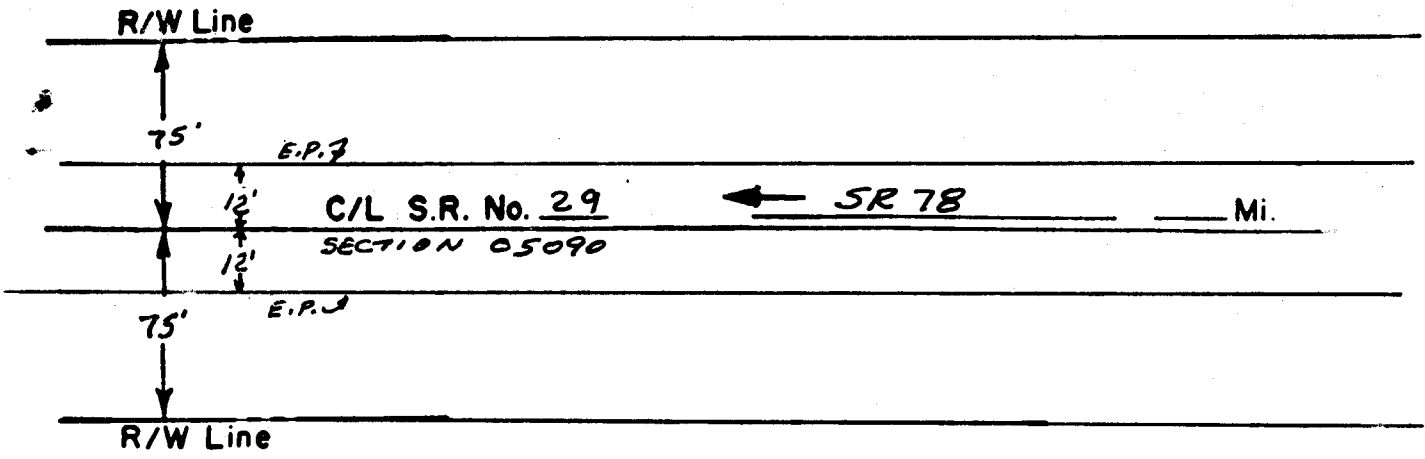

PLAN SKETCH OF INSTALLATION
(not to scale)

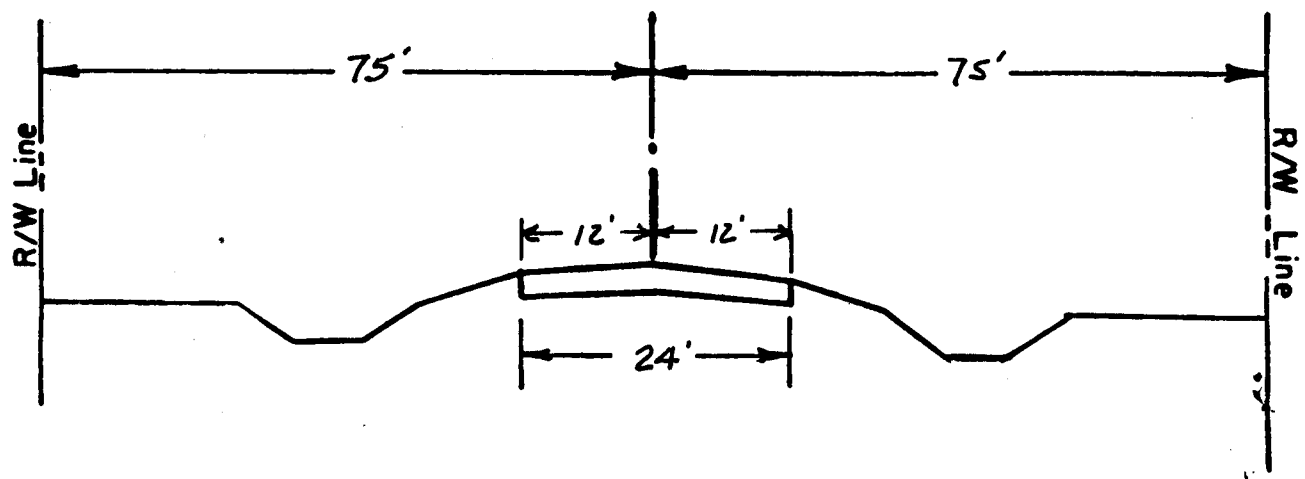

TYPICAL RURAL CROSS SECTION
(not to scale)
LOOKING NORTHEAST

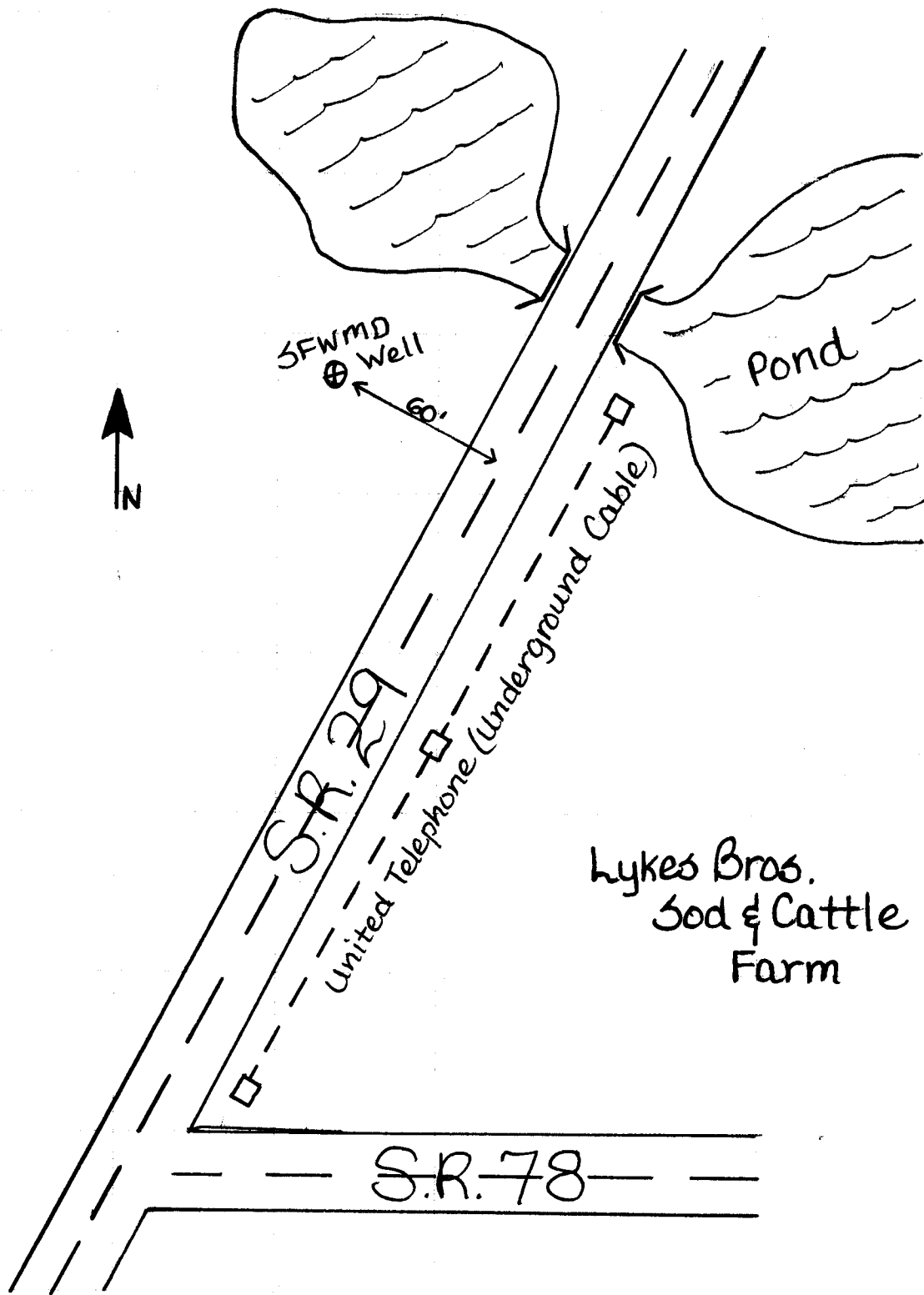

Location Site RTA-8

Location Site RTA-5

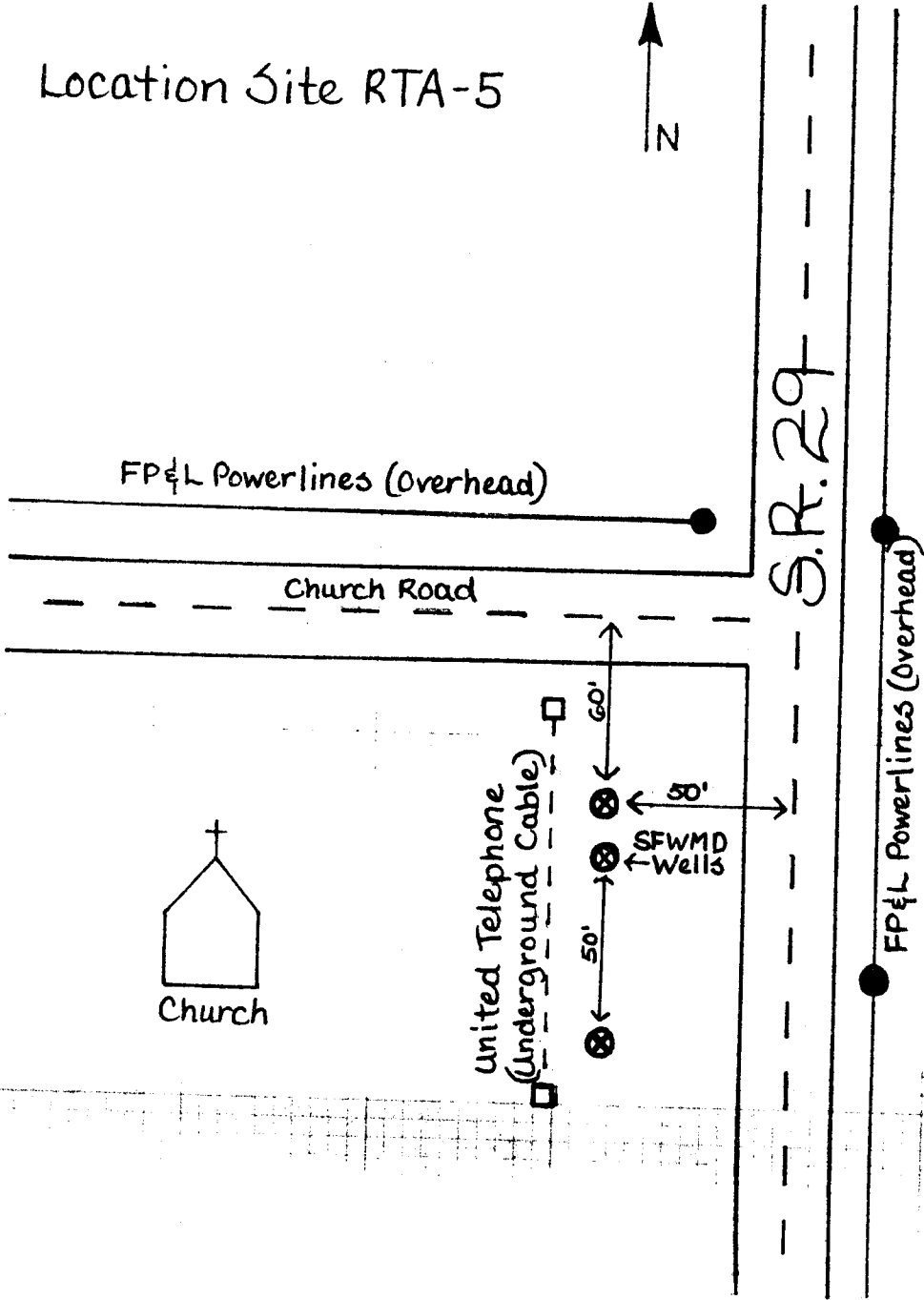

Location Site RTA-6



United Telephone (Underground Cable)
FP&L Powerlines (Overhead)

S.R. 29

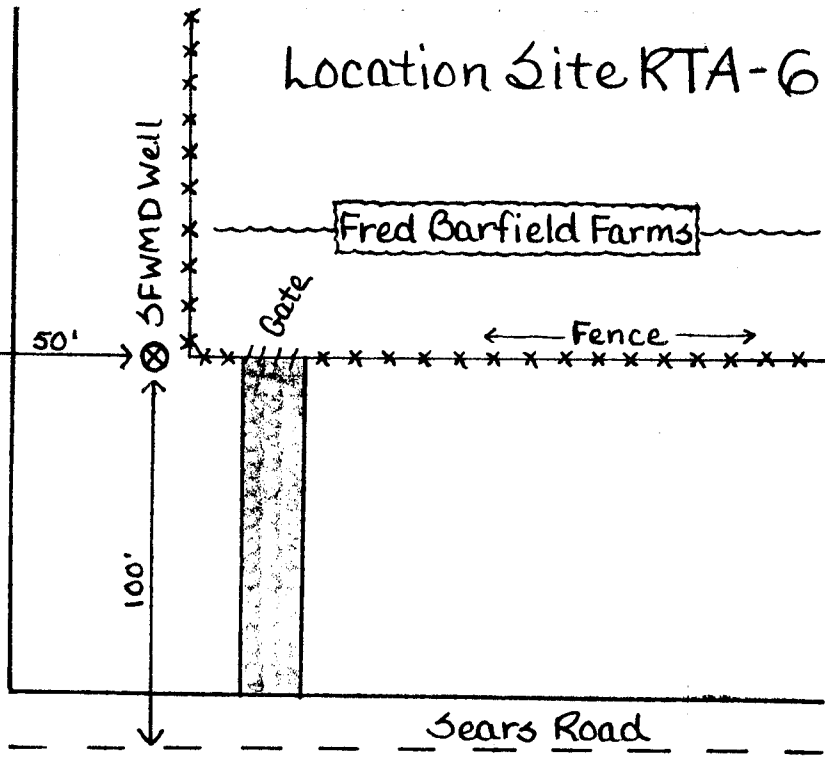

USGS
Monitoring Wells

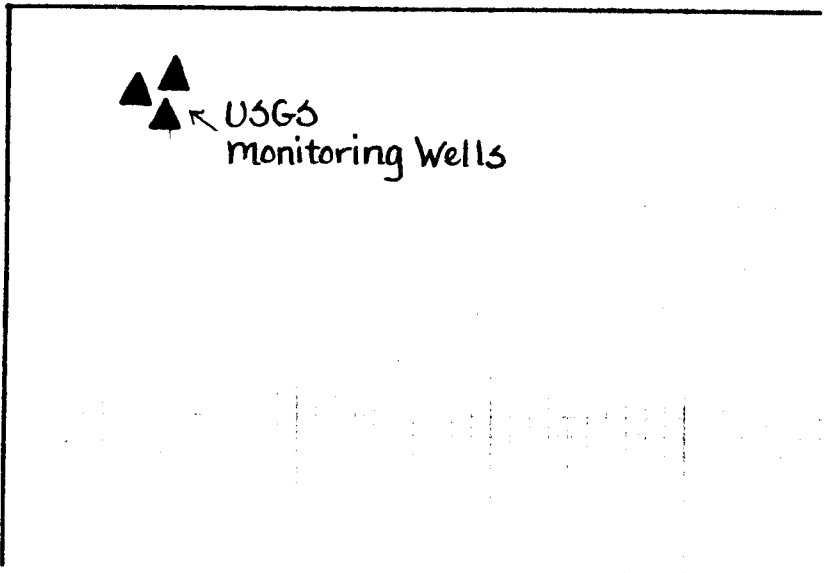

RTA-17

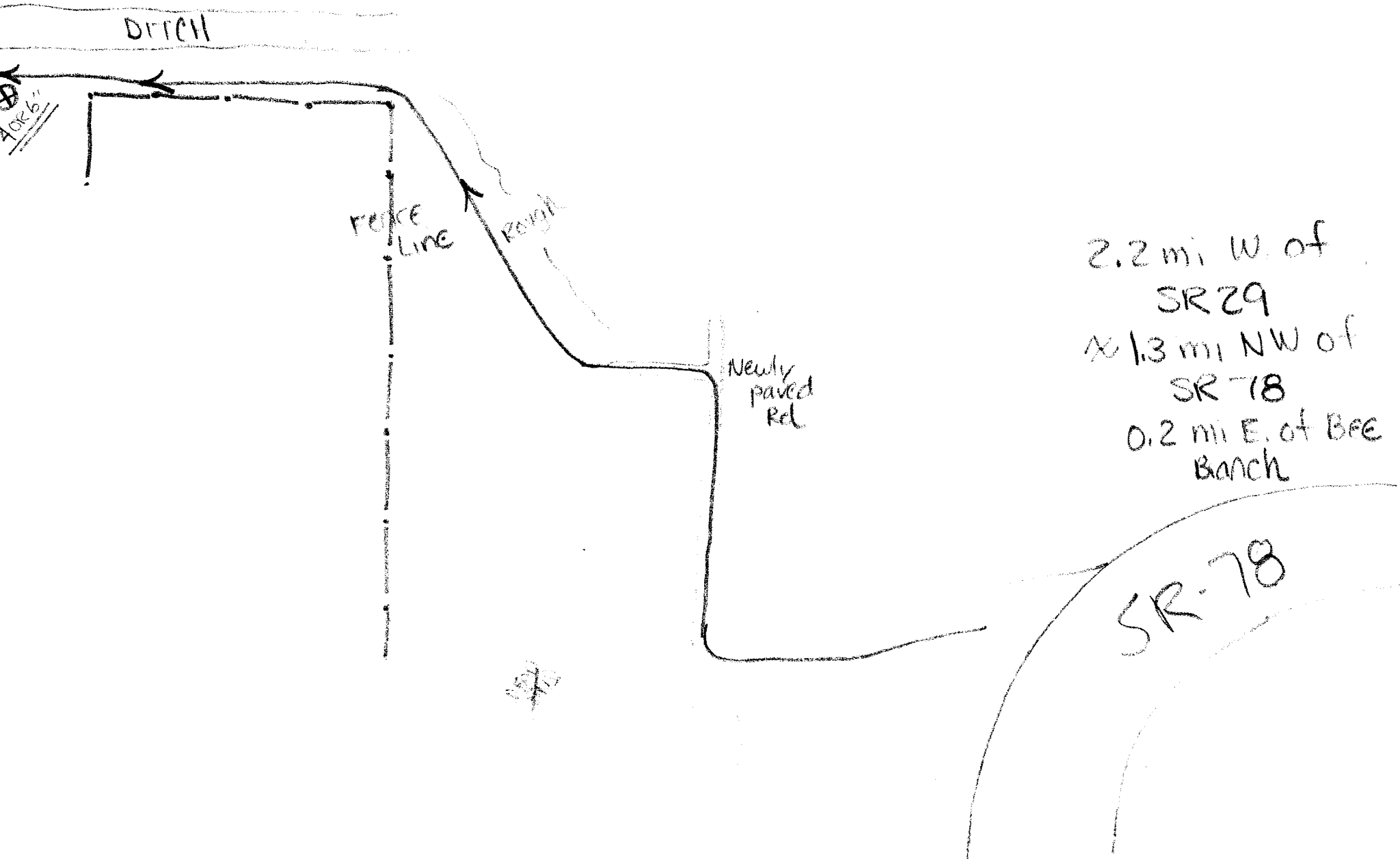

2.2 mi W. of
SR 29
~1.3 mi NW of
SR 78
0.2 mi E. of BEE
Branch

SR-78

CARROL JONES

RTA-18

675-2763

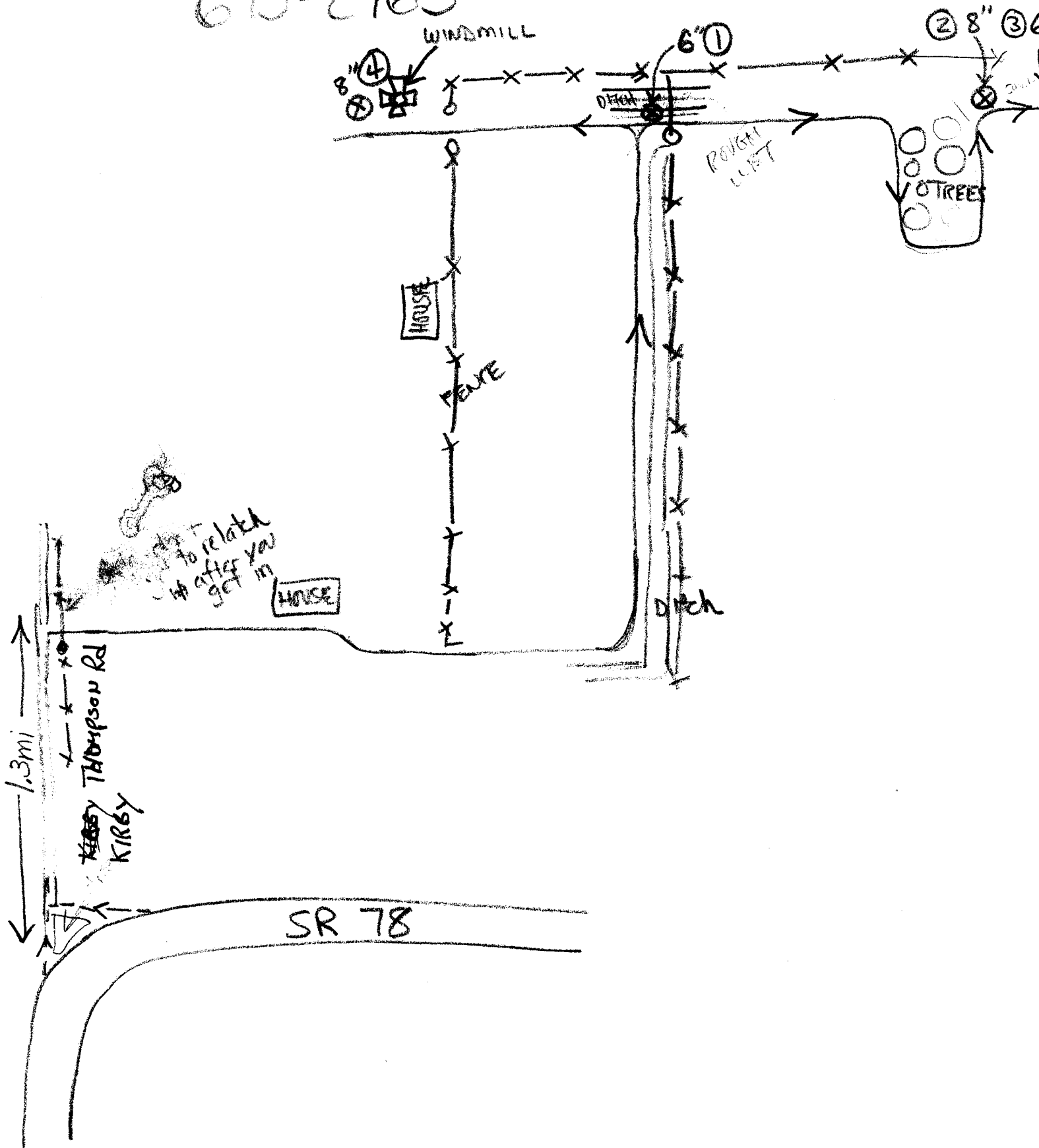

CHARLES COFFMAN
995-0042

RTA-19

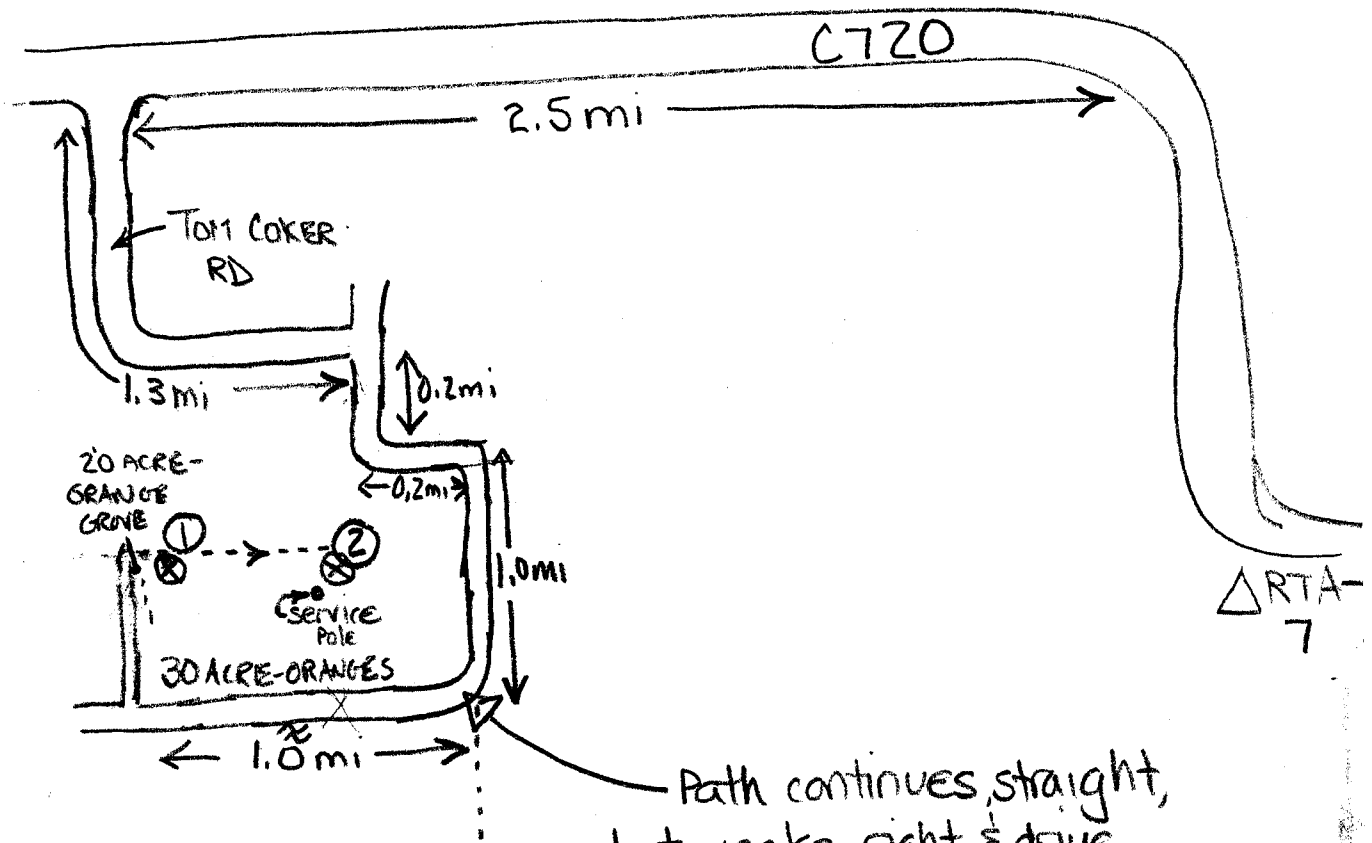

Path continues straight, but make right & drive about a mile (very wet & rough) & when you reach 30 acre orange grove make next right - follow path to 20 acre orange grove - gate on right (East) DEAD ENDS
(Gate is only wired shut. please rewire when you leave)

right
Apparently first well is there, after you get through the gate. Next well is further East underneath a power line service pool - this well has a bucket over it



REPLY TO:
P.O. Box 188
Laughlintown, PA
15655

14 June 1985

Mr. Tim S. Sharp, Hydrogeologist
Groundwater Division
Resource Planning Department
South Florida Water Management District
Post Office Box V
West Palm Beach, Florida 33402

Dear Mr. Sharp:

Mr. Gary Reeves of Johnson Engineering, Inc. has informed of your interest in conducting certain hydrologic work on our property in conjunction with the Hendry County RTA study.

While we would like to fully cooperate with the District in gaining needed information concerning water resource use and conservation, we have several concerns which must be addressed prior to approving your request.

Number one of course is the question of public access to the site specific information generated on our property. With all the litigious people around in this world, we prefer to keep our resource information confidential. We have nothing to hide, but neither do we intend to advertise information which some gadfly might use against us for who knows what reason! For this reason, we would have to be assured that site-specific data generated on our property would be kept confidential and only used in the form of regional averages, or for internal evaluative use.

The area of interest, namely Township 42, Range 27, seems overly expansive, given your study's focus and objectives. We would agree to provide access to only the eastern 1/2 of the subject Charlotte County township.

Security and safety are other concerns: This is one of the most isolated areas of our ranch -- the "road" system is not defined except in the minds of several of our employees. Getting lost or at a minimum permanently stuck are two very real problems which can and do occur. Also, this is an area where we continually have poaching/rustling incursions and we are reluctant to issue gate keys to non-employees. Another concern is maintaining the integrity of our many cattle herds and prevent their mixing by leaving gates open, etc. All of the foregoing implies that the

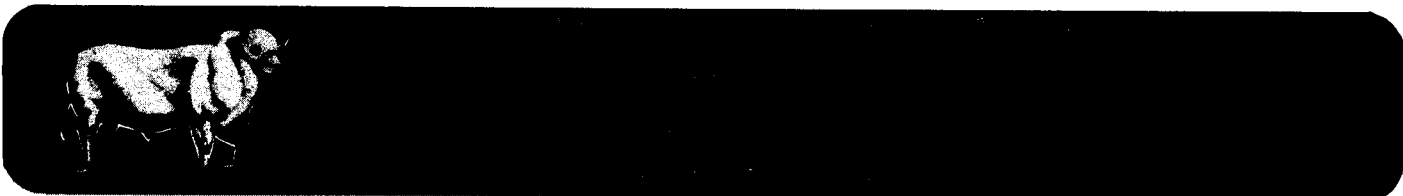

proposed work would have to be conducted in the presence of one of our security people. We are cattle ranchers and we don't have "excess" personnel available for such tasks. We would need to be apprised of the specific time period and time requirements to conduct your investigation before we would be able to determine if the request is reasonable in light of our workload and staffing.

I hope you don't construe the foregoing as being evasive -- this certainly is not our intent. Please respond to the above "Reply to" address.

Sincerely,

BABCOCK FLORIDA COMPANY

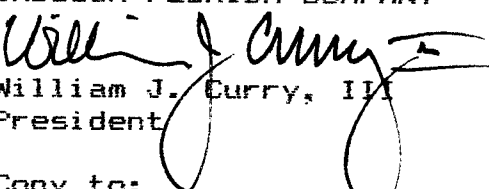
William J. Curry, III
President

Copy to:

F. Bayard Toussaint, General Manager
Gary F. Reeves, Johnson Engineering, Inc.