

WD Exp. (24)
April 1966

Well No. 254123N0801032.1

WELL SCHEDULE

U.S. DEPT. OF THE INTERIOR

GEOLOGICAL SURVEY

WATER RESOURCES DIVISION

MASTER CARD

Record by H. F. Voegtlin Source of data Records Date 4-29-69 Map 24000 Key Biscayne

State Florida County Dade Section 13

Latitude: 25° 41' 23" N Longitude: 80° 10' 32" W Sequential number: 1

Local well number: 224 Other number:

Local use: 55542506 Owner of name: E. H. Underwood

Owner of name: E. H. Underwood Address: 14 Harbor Pt.

Ownership: County, Fed Gov't, Citty, Corp or Co. Private State Agency, Water Dist P

Use of Air cond, Sealing, Comm, Devator, Power, Piro, Dom, Irr, Med, Ind, P S, Rec, Water: 2

Use of well: Anoda, Drain, Seismic, Heat Res, Obs, Oil-gas, Recharge, Test, Unused, Withdraw, Waste, Destroyed Q

DATA AVAILABLE: Well data freq. W/L meas.: Intermittently Field aquifer char.

Hyd. lab. data:

Qual. water data: Type: Chloride

Freq. sampling: Intermittently Pumpage inventory: yes no period:

Aperture cards:

Log data:

WELL-DESCRIPTION CARD

NAME AS ON MASTER CARD Depth well: 957 ft Meas. 957 accuracy 6

Depth cased: ft Casing Type: steel Diam. 6 in

Finish: porous gravel w. concrete, (perl.), (screen), (sally), end, (horiz. open perf.), (screen), (ed. pt.), (shored), other X

Method: all bored, cable, dug, hyd jetted, air reverse trenching, driven, drive wash, other 4

Drilled: 7-1951 9-51 Pump intake setting: ft

Driller: Knight + King Miami, Fla.

Log: (type): air, purser, cent. jet, (cent.) (turb.) none, piston, jet, submerg, turb, other Deep Shallow 40

Power: not LP (type): diesel, elec, gas, gasoline, hand, gas, wind, H.P. Trans. or meter no.

Descrip. MP Top of 4" Tec 1.55 ft above LSD. Alt. MP 5.55

Alt. LSD: 4.0 Accuracy: 4 (source) Topo Map C.T.S. 3

Water Level: 32.0 ft above MP; Ft above LSD: 3.4 Accuracy: Pressure Gauge 4

Date meas: 8-2-1951 8-51 Yield: 150 gpm Method determined 0

Drawdown: ft Accuracy: Pumping period: hrs

QUALITY OF WATER DATA: Iron ppm Surface Chloride ppm Hard. ppm

Sp. Conduct K x 10⁶ Temp. Date sampled

Taste, color, etc.

Check Casing

Well No. 254123N0801032.1

Latitude-Longitude 25.41.23-80.10.32

HYDROGEOLOGIC CARD

NAME AS ON MASTER CARD Physiographic Province: Coastal Plain Section: Florida

Subsection: Object Evergl 1.0.B Subbasin: Object Evergl 7

Topo of well site: (D) depression, stream channel, dunes, (E) flat, hilltop, sink, swamp, (F) offshore, pediment, hillside, terrace, undulating, valley flat F

MAJOR AQUIFER: Tertiary, Eocene T.E Floridan 1.F

Lithology: Limestone 0.4 Origin: Marine 6 Aquifer Thickness: ft

Length of well open to: ft Depth to top of: ft

MINOR AQUIFER: system series aquifer, formation, group Aquifer Thickness: ft

Lithology: Origin: Depth to top of: ft

Intervals Screened:

Depth to consolidated rock: ft Source of data:

Depth to basement: ft Source of data:

Surficial material: Infiltration characteristics:

Coefficient of Storage: sp4/ft Coefficient of Storage:

Permeability: sp4/ft Spec cap: spm/ft; Number of geologic cards:

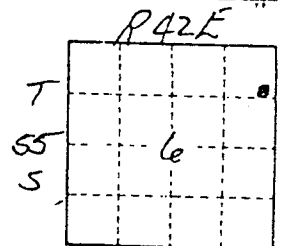

Well No. 254123N0801032.1

5993

IN BACK OF HOUSE



Please see
\$993 Test Key Biscayne
Joachim (361) 361-3727
wrong number

Well is no longer in Back
But is outside By Road
in Ficus Hedge Island N side
of property

8993

2540

20120 08010310-1

30.7

33.0

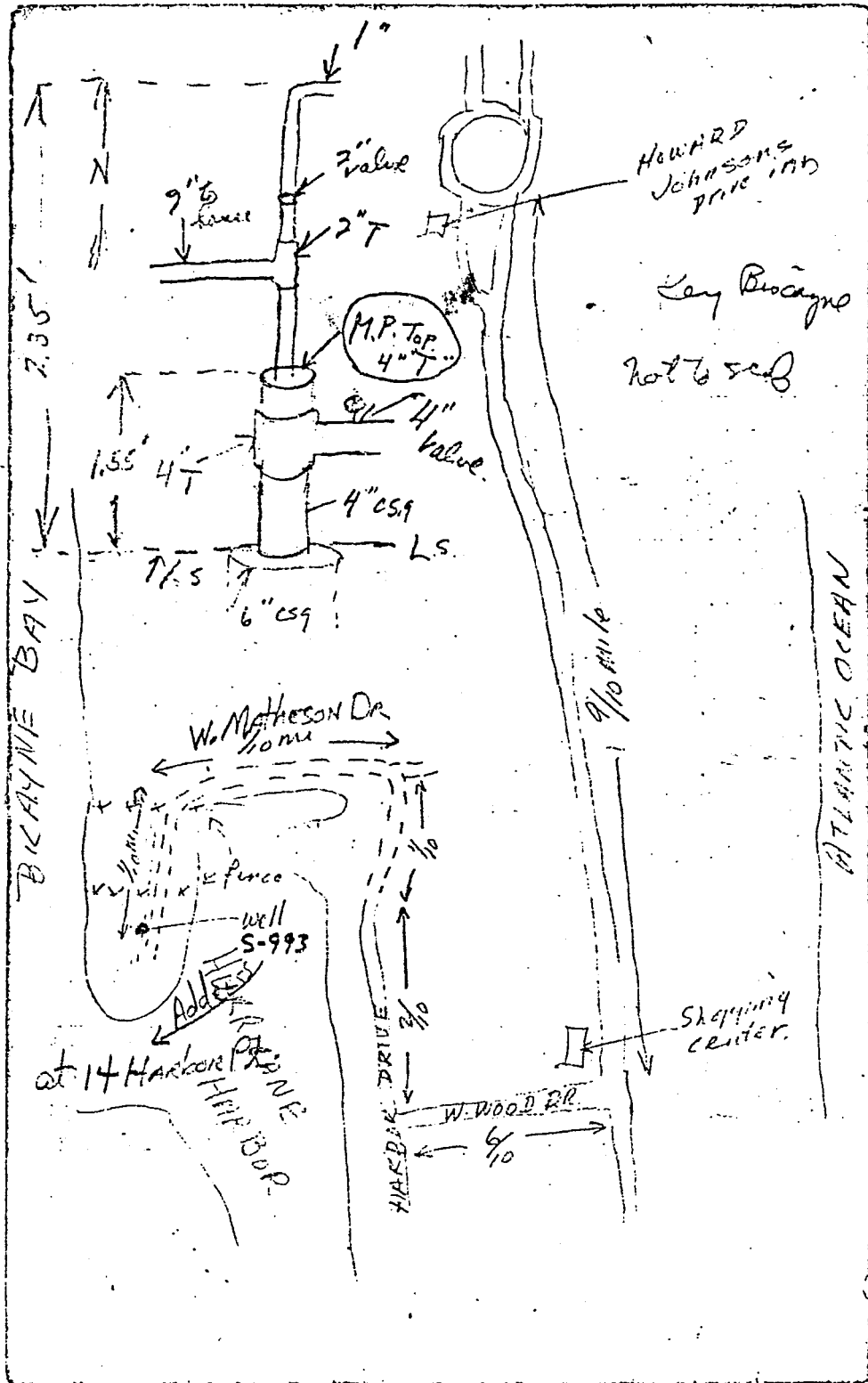

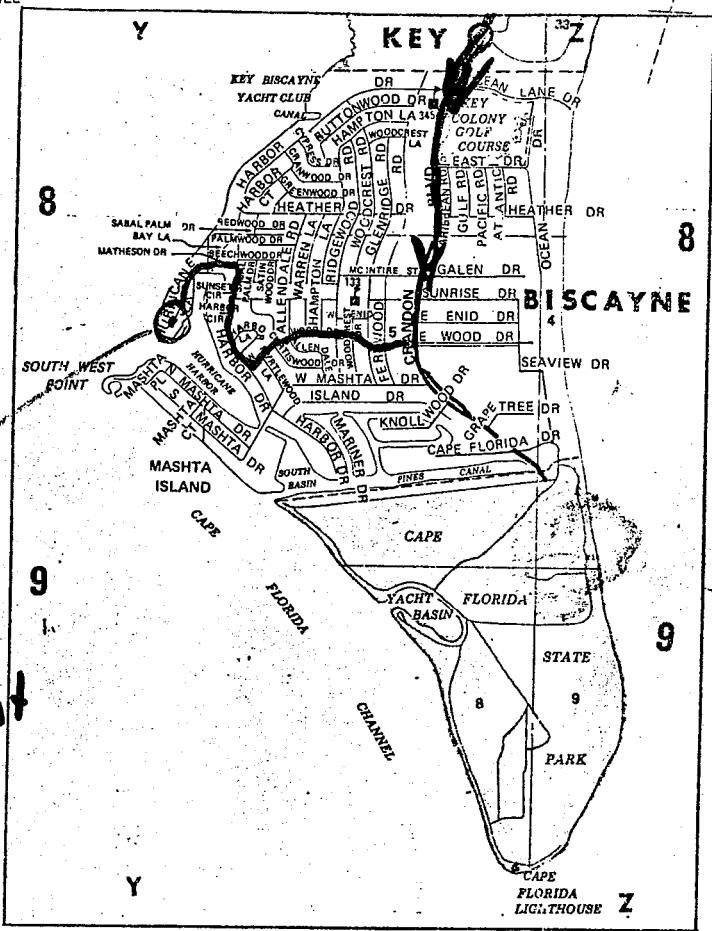
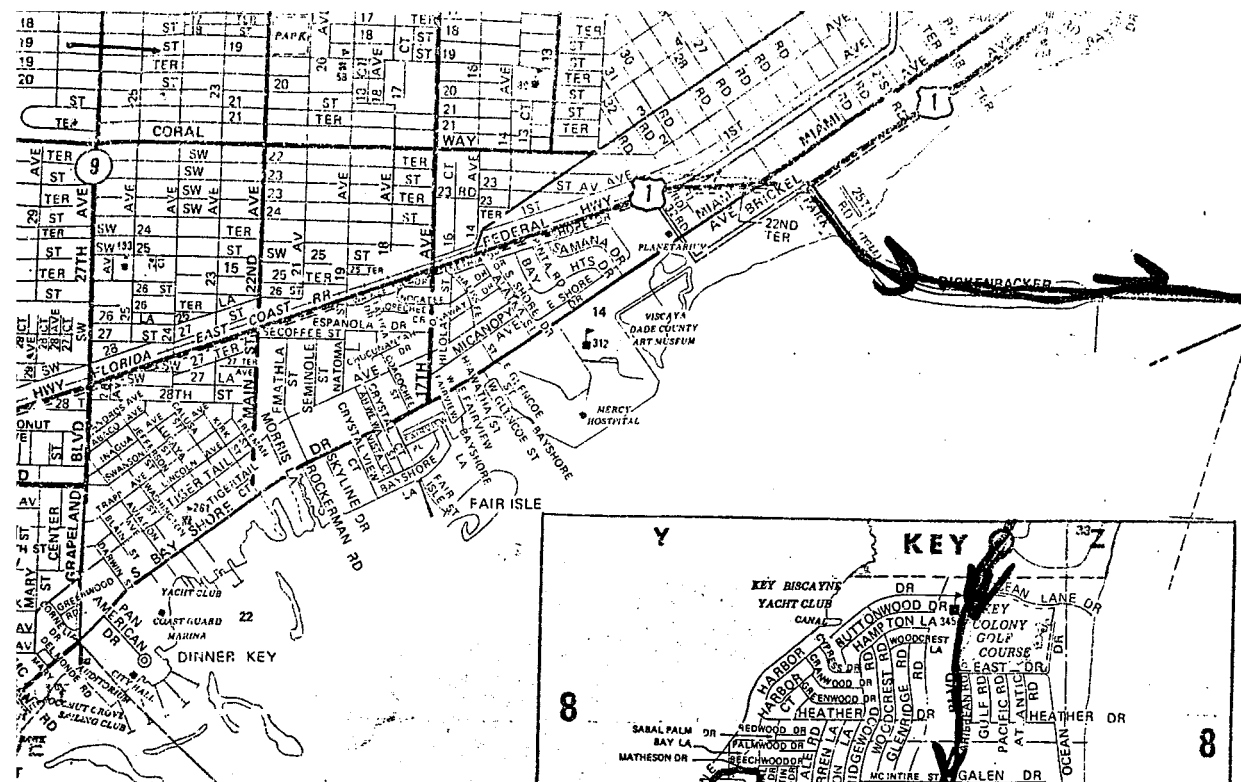

S-993

At residence
14 Harbor Point

FLORIDA

- including:
- COCONUT GROVE
 - CORAL GABLES
 - FLORIDA CITY
 - GOULDS
 - HOMESTEAD
 - KENDALL
 - KEY BISCAYNE
 - PERRINE
 - SOUTH MIAMI

also:
Road and Sectional Map of
DADE COUNTY

UNDERWOOD PROPERTY
14 on (White house Point)
Key Biscayne
in Back of House

