

(#1)

Well Number 310 API # 09-015-10004 County Charlotte
 Well Name Gulf Oil #1 Stevens Estate
 Location 227.5' East & 65.5' South of Center of the NWSE Sec. 24, T42S R24E

Elevation G. L. 26.4' D. F. 44' K. B. 45' T. D. 12,459'
 Date Commenced 11/20/63 Date Completed 1/2/64

man Ben there.

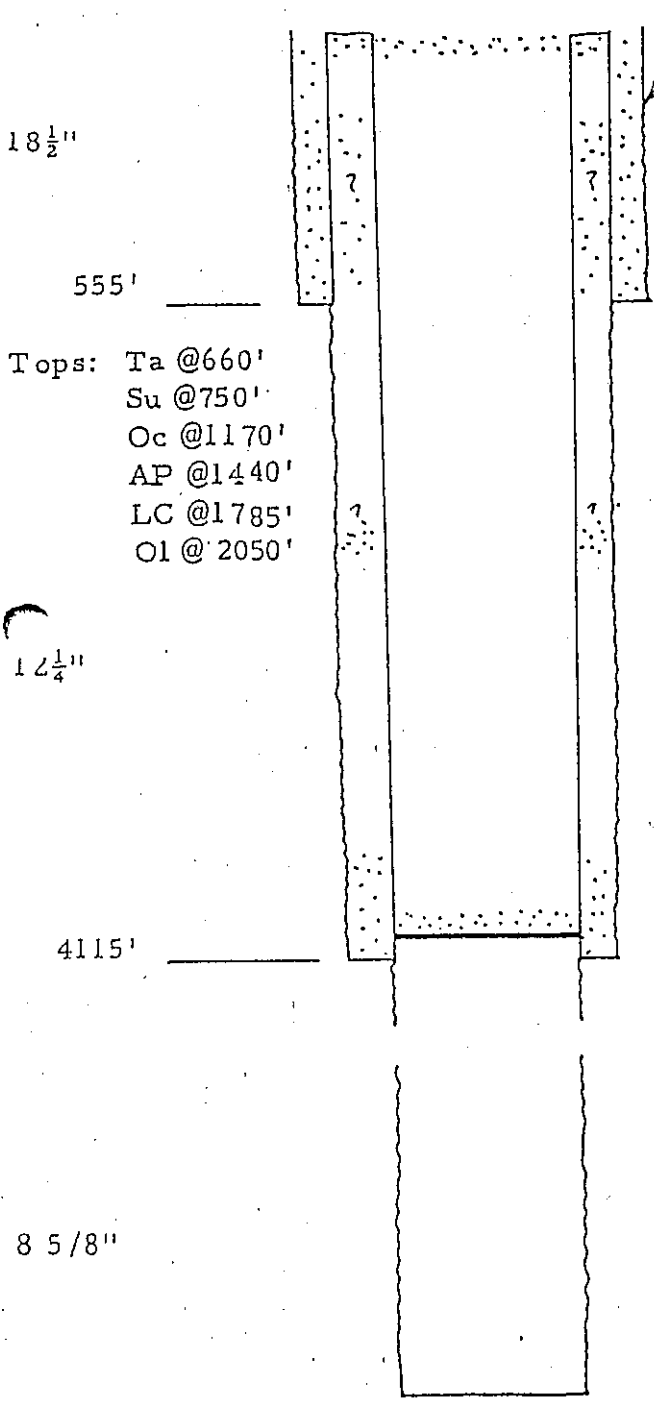

Drove 30' of 24" csg.

Set 16" csg @555' w/200 sx Fla. Portland cmt.

- Tops: Ta @660'
 Su @750'
 Oc @1170'
 AP @1440'
 LC @1785'
 OI @2050'

Set 9 5/8" csg @4115' w/300 sx Fla. Portland cmt. Also pumped 50 sx Fla. Portland cmt thru DV tool @1773'.

Plug job quoted verbatim:

"Used Halliburton to pump 42 bbls gelled water followed by 12 sx of Fla. Portland mixed w/6 sx of Halliburton Calseal & followed by 22 sx of Fla. Portland cmt w/2% salt in mixing water. Pumped mixture into 16" x 9 5/8" annulus & closed to allow to set. Set 9 5/8" bridge plug @4003'. Tested w/500 psi & 10,000 # weight. Placed 20 sx cmt plug on top of bridge plug. Orange peeled 16" csg to 9 5/8" csg. Cut 9 5/8" csg hangar shoe loose. Cut csg housing loose from 16" csg. Finished cementing 16"x9 5/8" annulus w/11 sx of cmt. Filled top 5' of 9 5/8" csg w/neat cmt. Bull plugged 2" collar welded in 16" csg. Welded steel plate on top of 9 5/8" csg w/1/2" bleeder valve in place. Did not pull casing. Left 546' of 16" H40 SS casing (set @555') and 4097.20' of 40# J-55 9/58" (set @4115') in hole."

TD, 12,459'

**FRED C. BABCOCK-
CECIL M. WEBB
WILDLIFE MANAGEMENT
AREA**
(65,770 acres)
Charlotte County

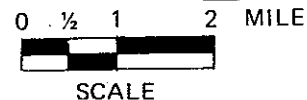
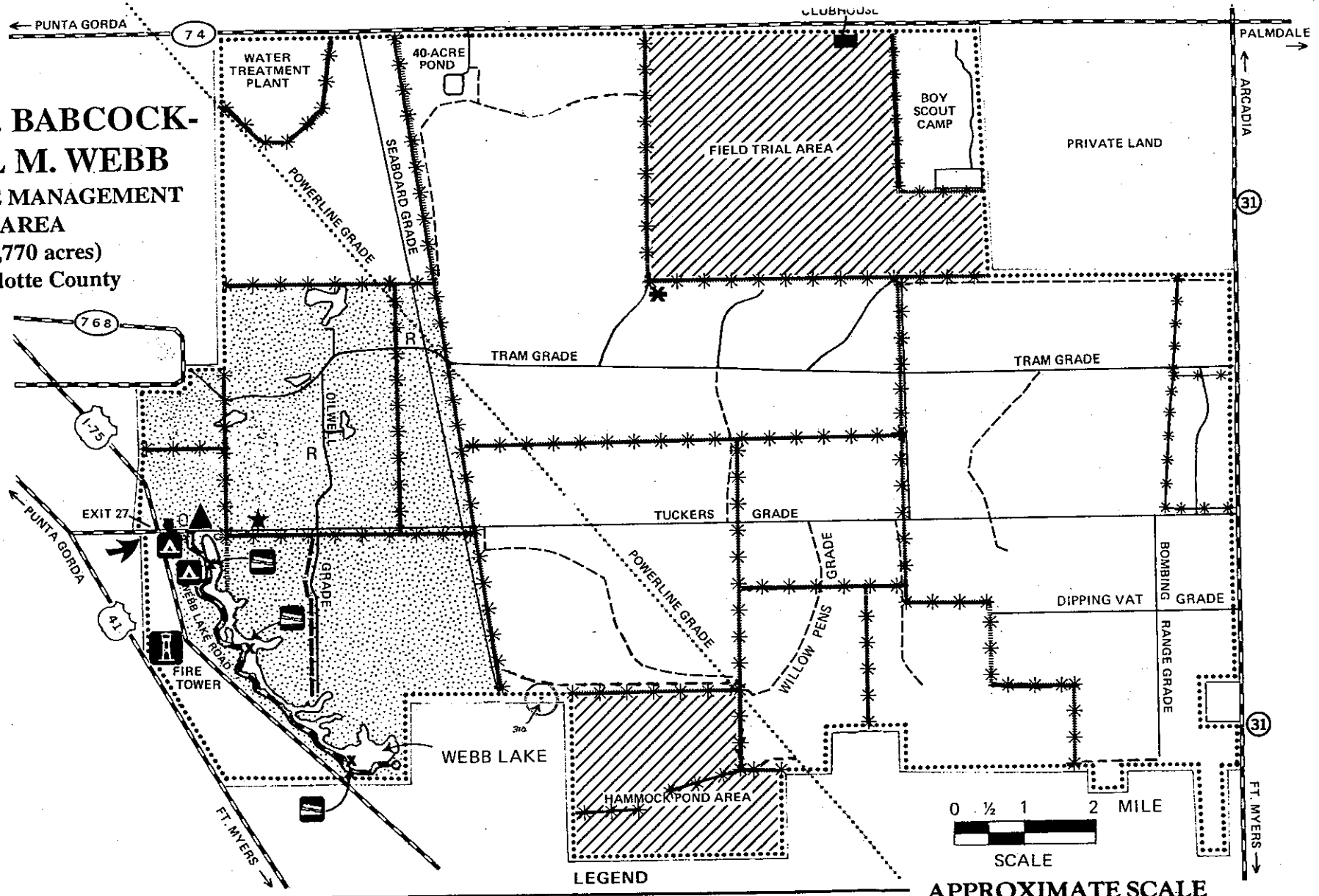

APPROXIMATE SCALE

- LEGEND**
- R- RC WOODPECKER
 - ← ENTRANCE
 - MANAGEMENT AREA BOUNDARY
 - == PAVED ROAD
 - ELEVATED ROAD
 - - - UNIMPROVED ROAD
 - ▲ CAMP SITE
 - ▲ CHECK STATION
 - /// WALK-IN AREA
 - RECREATION AREA
 - ⦿ FISH PONDS
 - POWER LINE
 - *** FENCE
 - X BOAT RAMP/PARKING
 - ★ SHOOTING RANGE
 - ✱ ONLY GATE OPEN DURING FIELD TRIAL QUAIL HUNT
 - 🕒 FIRE TOWER

Printed on recycled paper.

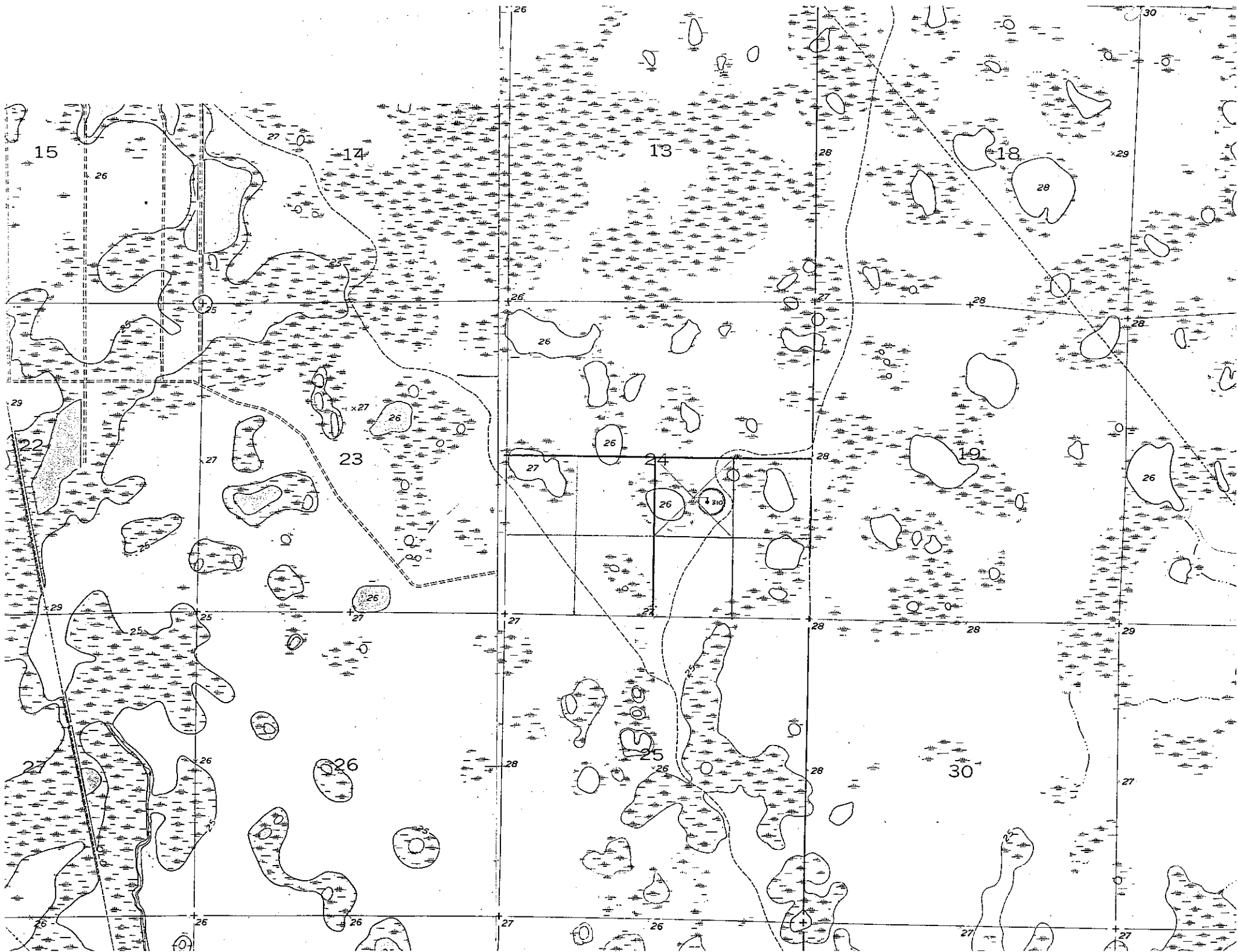

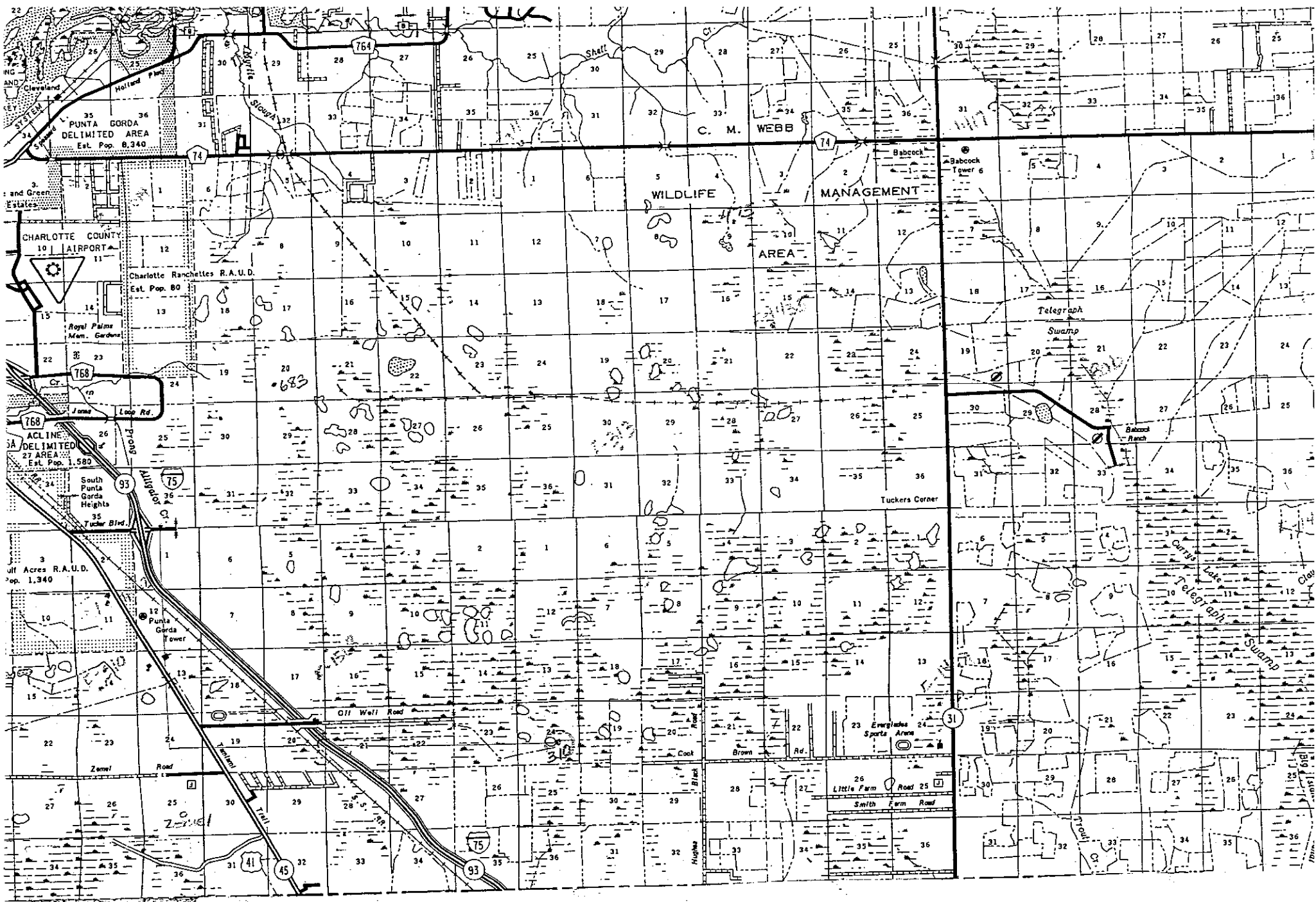

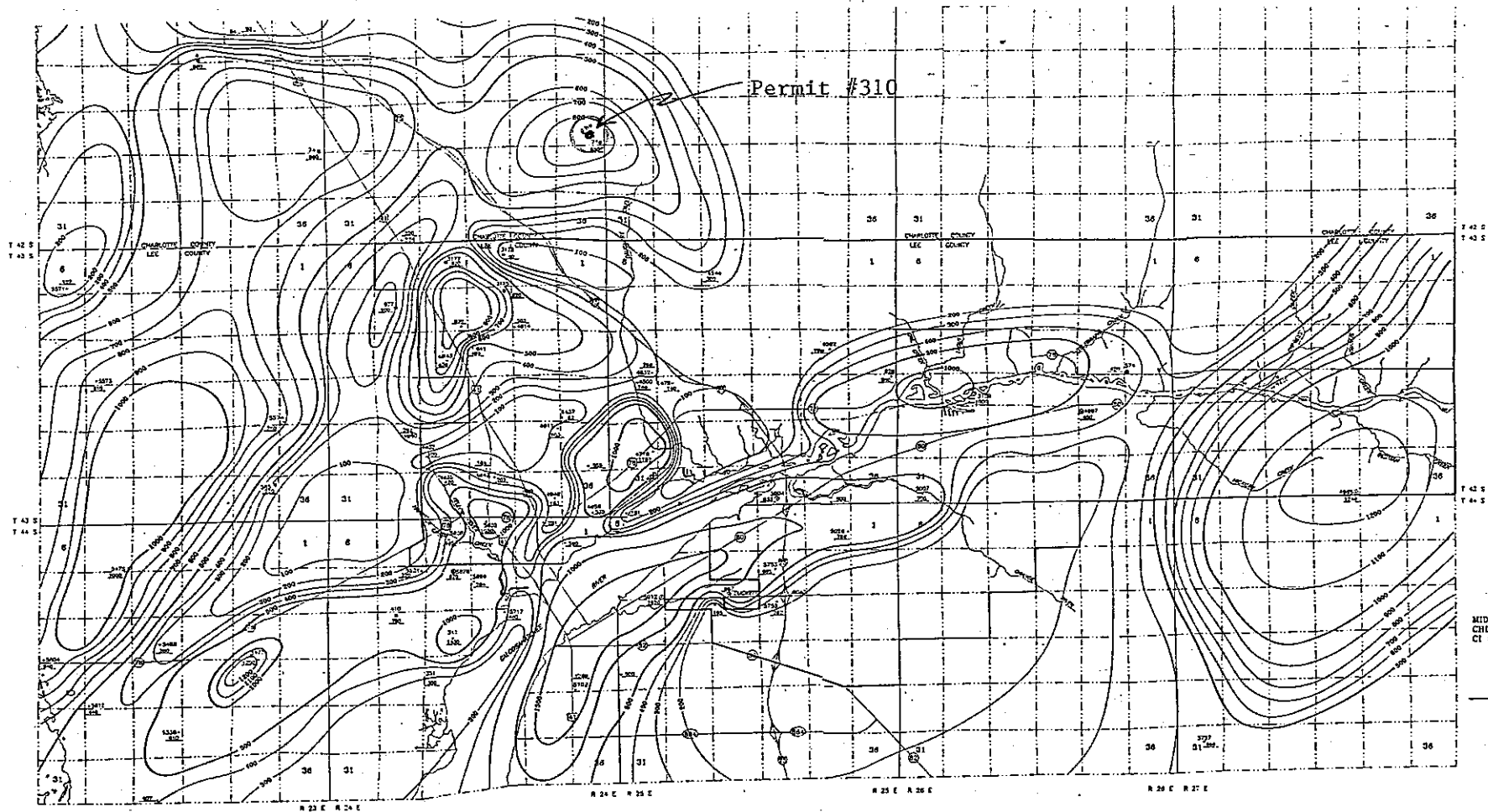

ViroGroup

PLATE 20
MID-HAWTHORN AQUIFER DISSOLVED
CHLORIDE CONCENTRATION MAP.
CI = 100'

Legend
- - - NORTH LEE COUNTY SERVICE AREA

013084E20C 6/28/92

Probable Chloride Plume in the Mid-Hawthorn Aquifer
Related to the Inadequately Plugged P#310

10-21-99

#310
WATER SAMPLES

3:50 PM

SPL 1:

oval-shaped pond surrounded by 2'-hi dike
< close to a 2'-dia palm tree >

< 50 ppm Cl⁻

3:53 PM

SPL 2:

Pond at/area near artesian well

1000 ppm Cl⁻

3:56 PM

SPL 3:

8' diameter x 1'-deep cellar (?)

350 ppm Cl⁻

- 5" x 5" x 5'-long timber embedded in ground
- 3 stakes around the 8' perimeter
- 2 3/8" OD steel flowline (11 to ground)
- ~ 2' diameter cap ± 1' B.G.L.

(cap seemed like it was made from wood or mesquite. had finger holes in it)

- no dead grass/plants in utr (~ 5" deep) in cellar
- dead murres in cellar water.

Well Number 310 API # 09-015-10004 County Charlotte

Well Name Gulf Oil #1 Stevens Estate

Location 227.5' East & 65.5' South of Center of the NWSE Sec. 24, T42S R24E

Elevation G. L. 26.4' D. F. 44' K. B. 45' T. D. 12,459'

Date Commenced 11/20/63 Date Completed 1/2/64

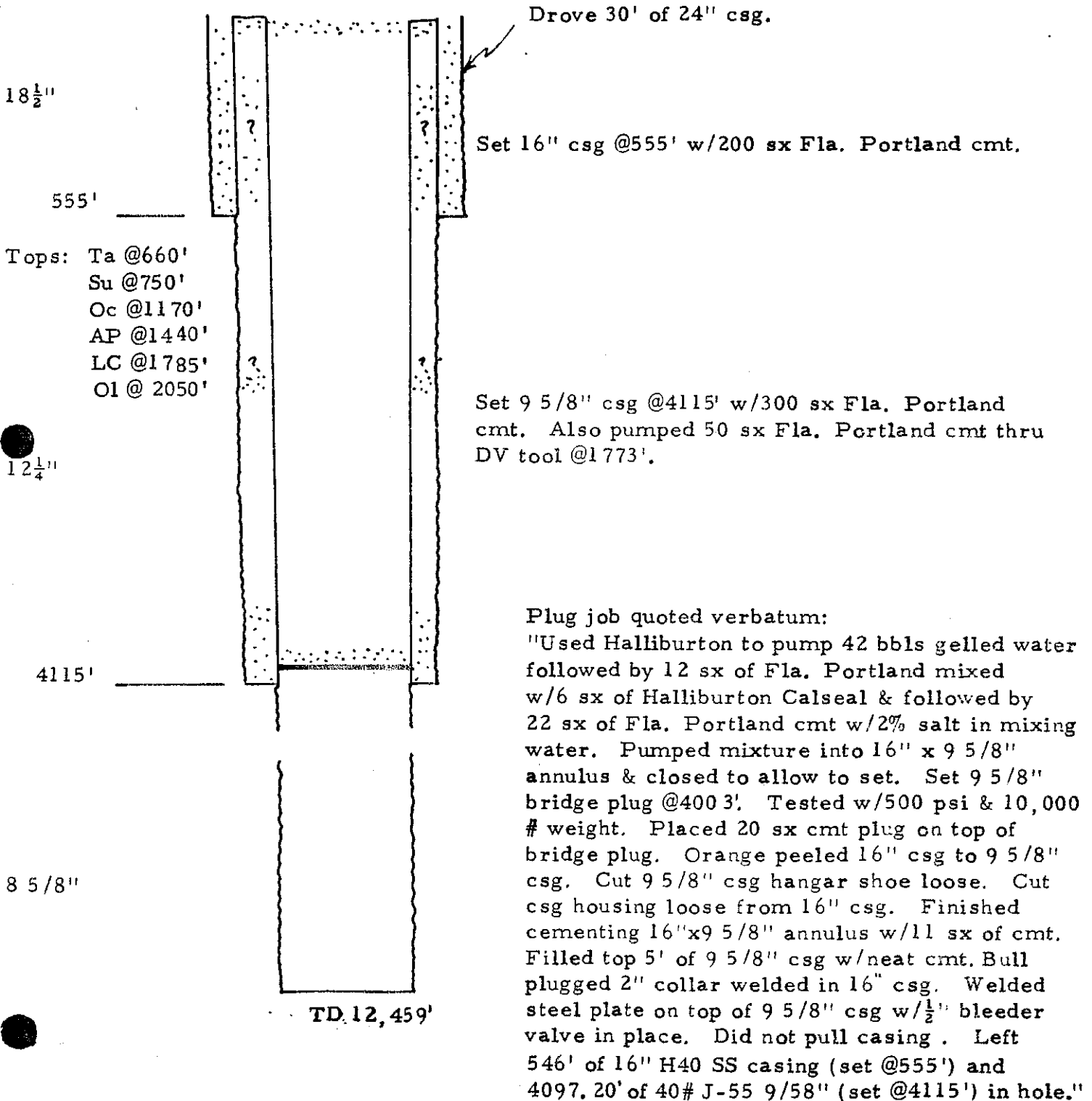

Permit No. 310 API 09-015-10004 County Charlotte Florida
Company Gulf Oil Fee #1 Stevens Estate

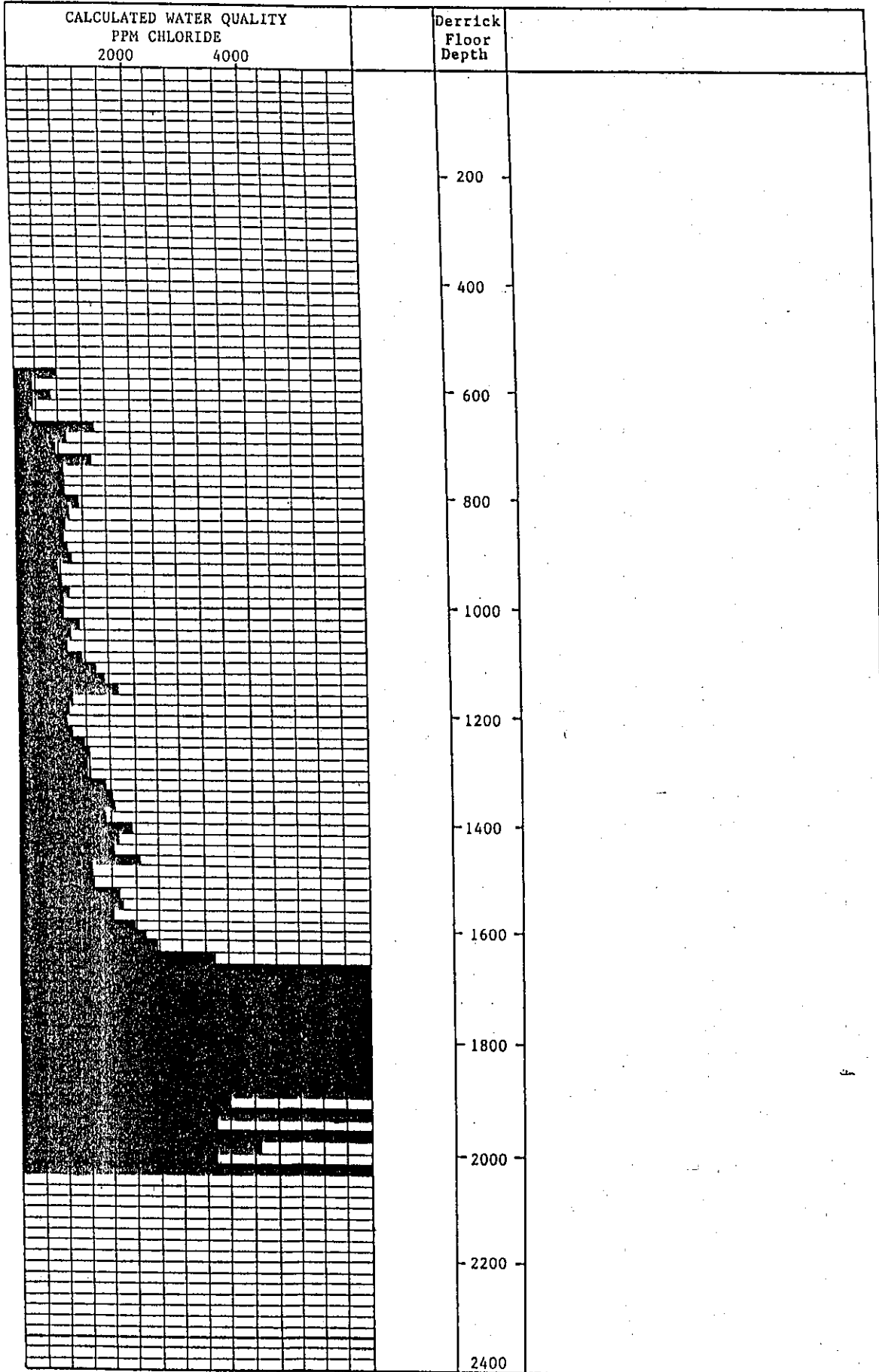

WATER QUALITY FROM THIEF SAMPLES				LITH	LOST CIRC. ZONES	2310 CSG+ CMT	DEPTH BELOW D. F.	Comments on 2310 USW Protection
PPM TDS		+ PPM Cl						
2000		4000						
							0'	
							200'	
							400'	
							600'	
							800'	Approximately 1000' of unprotect USWs. WQ is between 2000-2500 ppm TDS for most of this interval.
							1000'	
							1200'	
							1400'	
							1600'	
							1800'	← FW/SW contact @ 1615' burst
							2000'	50 sk spaced in annulus. True DV tool, most likely not there, so USWs are open to saline aquifers. Flow regime is upward.
							2200'	
							2400'	