



# SOUTH FLORIDA WATER MANAGEMENT DISTRICT

Rev. 1/16

USGS Station Name: <b>Not Applicable</b>	SCADA RTU Station Name: <b>Not Applicable</b>	DB Hydro Station Name: <b>MOSSPK_D MOSSPK_S</b>	DB Hydro Site Name: <b>MOSSPK</b>	Agency: <b>WMD</b>
---	--	--	--------------------------------------	-----------------------

Party Chief: <b>RODRIGUEZ/EBANKS</b>	Field Book: <b>NONE</b>	Page	Date of Field Work: <b>25-aug-14</b>	Prepared by: <b>H. Ehmke 21-jul-20</b>
---	-------------------------	------	--------------------------------------	--

### BENCHMARK DATA

Site Benchmark: <b>MOSSPK</b>	Site Benchmark El. <b>67.49 NAVD88 68.53 NGVD29</b>	NGS Source Benchmark: <b>R575 (DG6177)</b>	NGS Source Benchmark El.: <b>66.293 (20.206m) NAVD88</b>	<b>+1.056 Corpscon 6.0.1 Conversion Factor (NAVD88 to NGVD29)</b> <b>+1.04 - Historical Conversion Factor</b>
----------------------------------	--	---	---	--

### SITE SPECIFIC DATA

GW1 Reference Elevations: <b>71.584 NAVD88 (Survey)</b> <b>72.64 NGVD29 (Corpscon)</b> <b>72.64 NGVD29 (Historical)</b>	GW2 Reference Elevations: <b>71.234 NAVD88 (Survey)</b> <b>72.29 NGVD29 (Corpscon)</b> <b>72.29 NGVD29 (Historical)</b>	Existing Brass Tag Elevation (Datum):NGVD29 GW1 - <b>72.64 (09-25-07 WOOLPERT)</b> GW2 - <b>72.29 (09-25-07 WOOLPERT)</b>	Calibration Port Elevation(s) (NAVD88): <b>Not Applicable</b>
--	--	---	--

Ground Elevation (NAVD88): <b>Not Taken</b>	Pad Elevation (NAVD88): <b>Not Applicable</b>
---	---

### GEOGRAPHIC DATA

Section <b>23</b>	Township <b>24 South</b>	Range <b>31 East</b>	
Benchmark	Latitude: <b>28°22'42.725"</b>	Longitude: <b>81°11'28.531"</b>	Source: <b>OPUS</b>
	State Plane Coordinates	Northing (Y) =	Easting (X) =

Notes:

- NAVD88** – North American Vertical Datum of 1988
- NGS** – National Geodetic Survey
- NGVD29**- National Geodetic Vertical Datum of 1929
- Corpscon 6.0.1** - A U.S. Army Corps of Engineers Engineering Research and Development Center Topographic Engineering Center Alexandria, Virginia Windows-based program to convert coordinates and elevations between datum's using vertcon05.txt and vertcon05.05 files supplied by the U.S. Army Corps of Engineers South Atlantic Division, Jacksonville FL.
- Historical Conversion Factor** – The difference between the NAVD88 value derived from the National Geodetic Survey Source benchmark and the value used at the time of the survey.
- OPUS** – Online Positioning User Service

### PICTURES

Aerial Overall Site





# SOUTH FLORIDA WATER MANAGEMENT DISTRICT

Rev. 1/16

Overall Well Site



Looking Northerly (oblique not to scale) (25-sep-07)

GW1 Well Head

Reference Point  
El. 71.584 NAVD88



Oblique not to scale (16-oct-17)

Old NGVD29 Brass Tag Close-up (*removed*)



New NAVD88 Brass Tag Close-up (*added*)





# SOUTH FLORIDA WATER MANAGEMENT DISTRICT

Rev. 1/16

GW2 Well Head

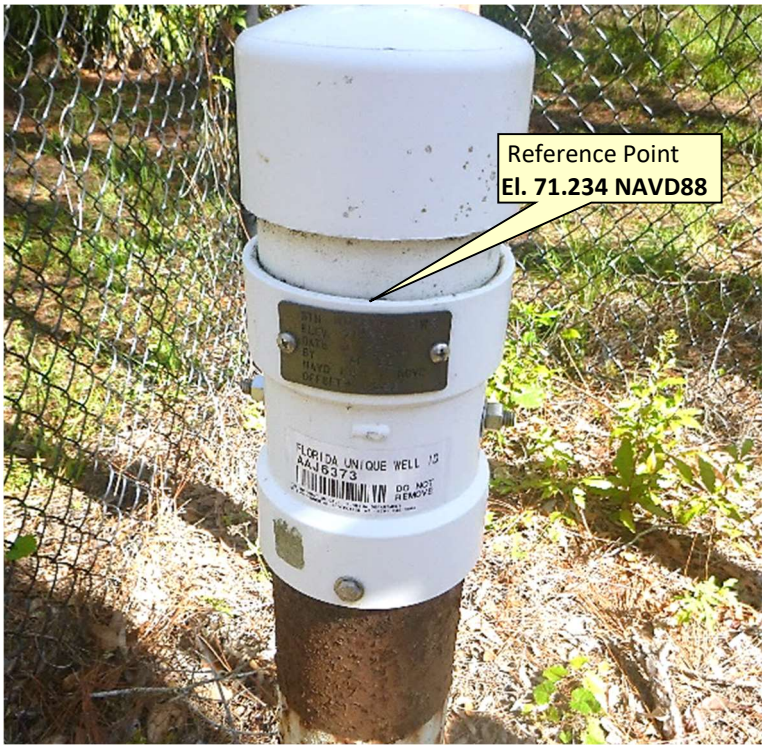

Oblique not to scale (16-oct-17)

Old NGVD29 Brass Tag Close-up (*removed*)



New NAVD88 Brass Tag Close-up (*added*)

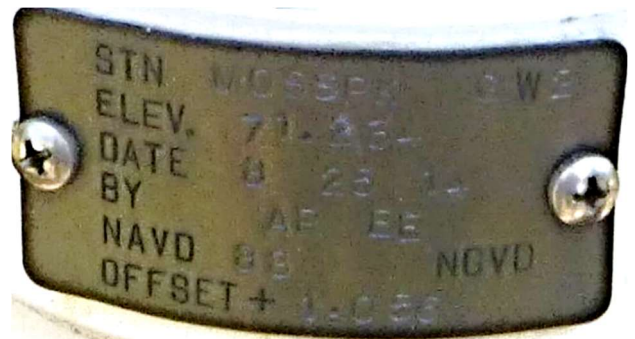

**Site Information**

9 Site	MOSSPK
Common Name	MOSS PARK,2 USGS WELLS; SHALLOW FLORIDAN WELL PAIRINGS PROJ
Location	WPB,TURNPIKE NORTH TO SR528,EAST TO SR15(NARCOOSEE RD),SOUTH 2.5MI TO MOSS PARK RD,FOLLOW 2 MI TO JUNCTION W/WEWAHOOTEE RD,VEER RIGHT, STAY ON MOSS PARK , FOLLOW BEND EAST, ENTER PARK AND FOLLOW ROAD TO WELL SITE
Site Notes	USGS NAMES 82211104 AND 82211103; SHALLOW FLORIDAN WELL PAIRINGS PROJECT
Contact	DAVID BUTLER/DOUG WILKINS

**Station Information for Site MOSSPK**

Station	Description	Latitude	Longitude	Xcoord	Ycoord	County	Basin	Section	Town	Range
MOSSPK_D	USGS WELL MOSS PARK DEEP	282242.02	811127.225	594782.949	1470304.767	ORA	L HART	23	24	31

Site Name	Sensor			
<b>MOSSPK</b>	<b>GW1</b>			

<b>Latitude</b> 28° 22' 42.7"	<b>Longitude</b> 81° 11' 28.5"	<b>Northing</b> 1470369	<b>Easting</b> 594673	
<b>Section</b> 23	<b>Township</b> 24	<b>Range</b> 31	<b>County</b> Orange	<b>Quad</b> Narcoossee NW

**Benchmark Information:**

<b>Name</b> MOSSPK	<b>Existing / Set</b> Set	<b>NAVD88</b> 67.49	<b>NGVD29</b> 68.53	<i>+1.04</i>
-----------------------	------------------------------	------------------------	------------------------	--------------

**Reference Point Information:**

<b>Stamped Elevation (NGVD29)</b> 72.64	<b>Stamped Date</b> 9-25-07	<b>By Firm</b> Woolpert, Inc.
--	--------------------------------	----------------------------------

Note: Reference point at top of PVC pipe as marked.

**Staff Gauge Information:**

<b>Water Elevation (NGVD29)</b> NA	<b>Gauge Reading</b> NA	<b>Time of Reading</b> NA	<b>Date of Reading</b> NA
---------------------------------------	----------------------------	------------------------------	------------------------------

**To Reach Description:** (as described)

From the Turnpike & SR 528, go East on 528 to SR 15 (Narcoossee Rd), then go south on SR 15 for 2.5 miles to Moss Park Rd. Follow Moss Pk Rd for 2 miles to Wewahootee Rd, Veer to the right and stay on Moss Pk Rd and follow the bend going East to the entrance of Park. Take dirt road going west then south for approximately 0.28 miles to reach the site. Site is about 15' east of dirt road.

**Sensor Well Area:**



**Tag Close-up:**



*Corpscom +1.056  
diff = 0.016*

*72.64  
1.056  
-----  
✓ 71.584 (NAVD 88)  
Corpscom*

**Bench Mark:**



**Bench Mark:**



**Bench Mark:**



Site Name		Sensor		
MOSSPK		GW2		

<b>Latitude</b> 28° 22' 42.7"	<b>Longitude</b> 81° 11' 28.5"	<b>Northing</b> 1470369	<b>Easting</b> 594673	
<b>Section</b> 23	<b>Township</b> 24	<b>Range</b> 31	<b>County</b> Orange	<b>Quad</b> Narcoossee NW

**Benchmark Information:**

<b>Name</b> MOSSPK	<b>Existing / Set</b> Set	<b>NAVD88</b> 67.49	<b>NGVD29</b> 68.53
-----------------------	------------------------------	------------------------	------------------------

**Reference Point Information:**

<b>Stamped Elevation (NGVD29)</b> 72.29	<b>Stamped Date</b> 9-25-07	<b>By Firm</b> Woolpert, Inc.
--	--------------------------------	----------------------------------

Note: Reference point at top of PVC pipe as marked.

**Staff Gauge Information:**

<b>Water Elevation (NGVD29)</b> NA	<b>Gauge Reading</b> NA	<b>Time of Reading</b> NA	<b>Date of Reading</b> NA
---------------------------------------	----------------------------	------------------------------	------------------------------

**To Reach Description:** (as described)

From the Turnpike & SR 528, go East on 528 to SR 15 (Narcoossee Rd), then go south on SR 15 for 2.5 miles to Moss Park Rd. Follow Moss Pk Rd for 2 miles to Wewahootee Rd, Veer to the right and stay on Moss Pk Rd and follow the bend going East to the entrance of Park. Take dirt road going west then south for approximately 0.28 miles to reach the site. Site is about 15' east of dirt road.

**Sensor Well Area:**



**Tag Close-up:**



72.29  
1.056  
 ✓ 71.234 (NAVD 88)  
 corpsc.com

**Bench Mark:**



**Bench Mark:**



**Bench Mark:**





## Survey Data Entry and Retrieval Application (SDERA) Print Output

## Control Point Search Results

Derived Data - Denoted By:  
\*\*

Designation	MOSSPK	Record State	ACCEPTED
NGS PID			
Project Name	V.D.U.P.	Date Entered/Updated	06/27/2009
Updated By	ATLAS DATA LOAD	Status	
Party Chief		Type	H/V
Monument Set By	WOOLPERT INC	Date Established	01/01/2007
County	ORANGE	Section	23
Township	24	Range	31
Quadrangle	NARCOOSSEE NW	Offset (29 to 88)	
NGS Source BM		CCR Link	
Ctrl Pt Source(s)			

<u>Horizontal</u>	<u>NAD 1927</u>	<u>NAD 1983</u>	<u>Vertical</u>	<u>NGVD 1929</u>	<u>NAVD 1988</u>
Latitude		28 22 42.7	Class		
Longitude		81 11 28.5	Order	3	
Northing(Y)		1470369.0	Elevation	68.53	67.49
Easting(X)		594673.0	Measurement Unit	Feet	Feet
Class					
Order					
NAD83 Adj Year					

## Field Book

WO104

## Field Book Pages

27

## Stamping

MOSSPK 2007

## How to Reach

## Description

9/12/2007 WOOLPERT-CESTNICK FB WO104 PAGE 27  
 TO REACH FROM THE TUNPIKE AND STATE ROAD 528, GO EAST ON STATE ROAD 528 TO COUNTY ROAD 15 (NARCOOSSEE ROAD), THEN GO SOUTH ON COUNTY ROAD 15 FOR 2.5 MILES TO MOSS PARK ROAD. FOLLOW MOSS PARK ROAD FOR 2 MILES TO WEWAHOOTEE ROAD, VEER TO THE RIGHT AND STAY ON MOSS PARK ROAD AND FOLLOW THE BEND GOING EAST TO THE ENTRANCE OF THE PARK. TAKE DIRT ROAD GOING WEST THEN SOUTH FOR APPROXIMATELY 0.28 MILES TO REACH THE BENCH MARK. BENCH MARK IS +/- 25 FEET NOIRTH OF WELL. ABOUT 15 FEET EAST OF DIRT ROAD. THE BENCH MARK IS A SFWMD ALUMINUM DISC ON AN 8 INCH DIAMETER AND 40 INCH

## DEEP CONCRETE MONUMENT INCASED BY A PVC PIPE.

**DISCLAIMER:**

The South Florida Water Management District (hereinafter referred to as the DISTRICT ) shall not be held liable for improper or incorrect use of the data, information, apparatus, products, processes or materials described and/or contained herein. These data, information, apparatus, products, processes, materials and related graphics are not legal documents and are not intended to be used as such. The user hereby recognizes that the information, data, apparatus, products, processes and materials are dynamic and may change over time without notice. However, the DISTRICT makes no commitment to update the information, data, apparatus, products, processes or materials contained herein.



# Office

## Project

23 June 2014

### INPUT

Geographic, NAD83  
Vertical - NAVD88, U.S. Feet

### OUTPUT

Geographic, NAD83  
Vertical - NGVD29 (Custom), U.S. Feet

---

**mospk**

1/1

**Latitude:** 28 22 42.7  
**Longitude:** 081 11 28.5  
**Elevation/Z:** 0

**Latitude:** 28.378527778  
**Longitude:** 81.191250000  
**Elevation/Z:** 1.056

---

Remark:

# Office

## Project

18 October 2017

### INPUT

State Plane, flhpgn - Florida HPGN  
0901 - Florida East, U.S. Feet  
Vertical - NAVD88, U.S. Feet

### OUTPUT

Geographic, flhpgn - Florida HPGN  
Vertical - NGVD29 (Custom), U.S. Feet

---

## MOSSPK

1/1

**Northing/Y:** 1470376.138619  
**Easting/X:** 594666.364054  
**Elevation/Z:** 0  
**Convergence:** -0 05 27.25619  
**Scale Factor:** 0.999945512  
**Combined Factor:** 0.999949909

**Latitude:** 28 22 42.72454  
**Longitude:** 81 11 28.53132  
**Elevation/Z:** 1.056

---

Remark:

Corpscon v6.0.1, U.S. Army Corps of Engineers

# REGISTRATION WORKSHEET - MOSSPK Addendum

Site Name: **MOSSPK** Today's Date: **10/22/2014** Type Recorder: **CR-10**  
 Activity: **Addendum** Effective Date: **10/22/2014** Start Date of Data :  
 Customer: **Garnett Ritchie** Bus. Area: **SCADA Maintenance** Agency: **SFWMD** Internal Order:  
 Project Manager: **Jim Vincent** Bus. Area: **SCADA Maintenance** Agency: **SFWMD** Fund:  
 Contract #:  
 Project Name: **VDUP** Legal Mandate:

Short Common Name / Description:

Proj. Mgr. Notes: Addendum Added for Calibration to NAVD88 Surveyed Data. To convert to NGVD 29 add + 1.056

Site Directions:

Site Address (if any):

Transportation: Lock type or combination: #

Recorder Location/Purpose: **Stand-Alone Recorder (Non-Flow Site)** Structure Type:

Array ID Configuration table attached **NO**

### SURVEY INFORMATION

B.M. Elevation: **67.490** Date: **9/25/2007** Stamp: **MOSSPK**  
 Agency: **SFWMD** Type: **ALUM** Datum: **NAVD 88**

Benchmark Location/ Description: From the Turnpike & SR 528, go east on 528 to SR 15 (Narcoossee RD), then go south on SR 15 for 2.5 miles to Moss Park RD. Follow Moss PK RD for 2 miles to Wewahootee RD, veer to the right and stay on Moss PK RD and follow the bend going east to the entrance of Park. Take dirt road going west then south for approximately 0.28 miles to reach the site. Site is about 15 ft east of dirt road.

### COMMUNICATIONS INFORMATION

Communications System: Loggernet Server: Loggernet IP Address:  
 Tower: Communication Type: R.F. Code/Modem Address: R.F. Access Point:  
 Phone Number:  
 RTU Address: Gateways:

### WELL INFORMATION

Sensor	Customer Ref	Ref Elev	Elev Date	Top of Well	Bottom of Well	Ground Elev	Benchmark Elev	Benchmark Datum	Ref Elevation Location
GW1		71.584	8/25/2014				67.49	NAVD 88	Reference point at top of PVC pipe as marked.
GW2		71.234	8/25/2014				67.49	NAVD 88	Reference point at top of PVC pipe as marked.

Sensor	GW Land Elevation	Depth of Well	Meas Pt Above BM	Type of Well	GW Sensor location									
GW1														
GW2														

### ADDITIONAL GPS INFORMATION

Item/Parm	Lat	Long	X-Coord	Y-Coord	Sec	Township	Range	Quad	Basin	County	Description
GW1	28 22 42.65	81 11 28.46	594673	1470369	23	24	31	Narcoossee NW		Orange	
GW2	28 22 42.65	81 11 28.46	594673	1470369	23	24	31	Narcoossee NW		Orange	



# SOUTH FLORIDA WATER MANAGEMENT DISTRICT

Rev. 1/16

DESIGNATION: <b>MOSSPK</b>	PROJECT: <b>MOSSPK Well</b>
ESTABLISHED BY: <b>WOOLPERT INC.</b>	SURVEYOR: <b>Strickland</b>
RECOVERED BY: <b>SOUTH FLORIDA WATER MANAGEMENT DISTRICT</b>	DATE: <b>16-oct-17</b>

## GEOGRAPHIC POSITION

SECTION <b>23</b>	TOWNSHIP <b>24 SOUTH</b>	RANGE <b>31 EAST</b>
COUNTY: <b>Orange</b>	NAME OF QUADRANGLE: <b>Narcoossee NW</b> GEOGRAPHIC INDEX OF QUAD: <b>3610</b>	
HORIZONTAL DATUM: 1927 <b>(1983)</b> Other _____ (circle one) ZONE <b>(E)</b> or W		
VERTICAL DATUM: MSL 1929 <b>(1988)</b> Other _____ (circle one)		
VERTICAL ACCURACY: 1 2 <b>(3)</b>		
STATE PLANE COORDINATE	(N) Y= <b>1470376.14</b>	(E) X= <b>594666.36</b>
		NAVD 88 EL. <b>67.49</b> NGVD 29 EL. <b>68.53</b>
CORPSCON 6.0.1 CONVERSION FACTOR (NAVD88 TO NGVD29): <b>+ 1.056</b>		
LATITUDE: <b>28°22'42.725"</b>		LONGITUDE: <b>81°11'28.531"</b>

## RECOVERY DATA

Stamping: <b>MOSSPK 2007</b>
To Reach: From the intersection of State Road 417 Exit 23, and Moss Park Road, go Easterly and Southeasterly along Moss Park Road, 3.6 miles to a bridge over South Florida Water Management District Canal 29; continue Southeasterly, 260 feet to the registration office for Moss Park, Orange County Parks and Recreation; continue Southeasterly, 140 feet to a road on the right; turn right and go Southwesterly, 950 feet to another shell rock road; turn left and go southerly 310 feet to MOSSPK well site on the left and station location. The station is 28 feet east of the east edge of the shell rock road and 20 feet north of GW1 well. The station is a South Florida Water Management District aluminum disk in an 8-inch diameter concrete monument incased in PVC pipe and stamped "MOSSPK 2007."
NGS SOURCE BENCHMARK: <b>R575 (DG6177) El. 66.293 (20.206m)</b>
FIELD BOOK <b>Misc 7E PAGE 20</b>

## PICTURES

Overall Site



Benchmark "MOSSPK"  
Latitude: **28°22'42.725"**  
Longitude: **81°11'28.531"**  
El. **67.49 NAVD88**

Not to scale Google Earth product)



# SOUTH FLORIDA WATER MANAGEMENT DISTRICT

Rev. 1/16

## SKETCH (Field Book Misc 7E page 20)

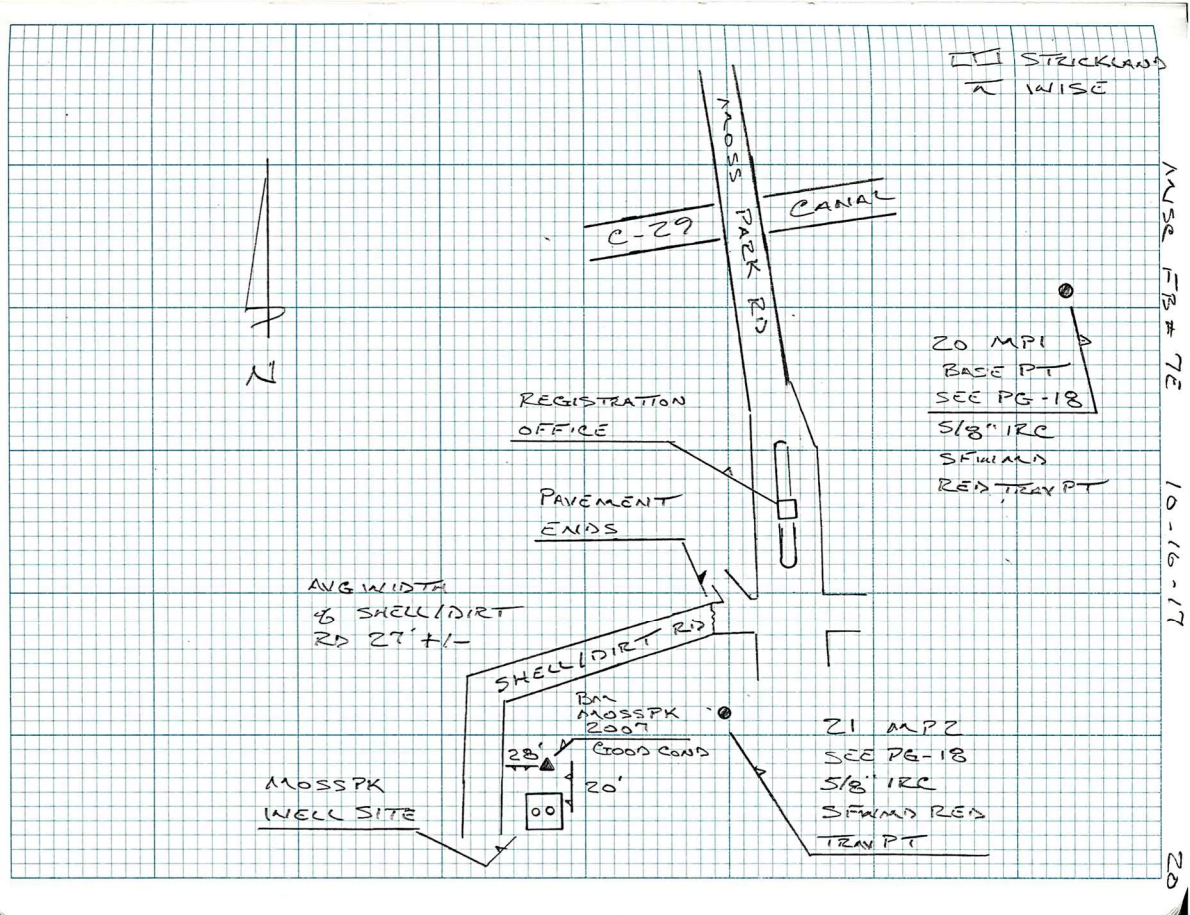

Looking Southerly oblique not to scale (16-oct-17)