







<b>Site Name</b> WR11 GW1		<b>Date of Field Work</b> July 15, 2015
<b>Party Chief</b> Strickland/Clanton	<b>Field Book Name/Number</b> MISC FB # 6X	<b>Page Number</b> 31
<b>Site Benchmark Name</b> WR11 2007	<b>Benchmark Elevation (NAVD88)</b> 67.59ft	<b>Datum Offset to NGVD29</b> + 1.08
<b>Reference Elevation (NAVD 88)</b> 70.92ft		<b>Existing Tag Elevation (Datum)</b> 71.97ft (NGVD 29)
<b>Notes:</b> Ground elevation = 64.80ft (NAVD 88). Corpscon v6.0.1 offset = +1.08, Field offset = +1.05		

Photographs:

<p><b>Overall Site</b></p> 	<p><b>Benchmark Close Up</b></p> 	<p><b>Benchmark Location</b></p> 
<p><b>Brass Tag Close Up</b></p>	<p><b>Brass Tag + Reference Mark</b></p> 	<p><b>Staff Gauge</b></p> 

<b>Site Name</b> WR11 STG		<b>Date of Field Work</b> July 15, 2015
<b>Party Chief</b> Strickland/Clanton	<b>Field Book Name/Number</b> MISC FB # 6X	<b>Page Number</b> 31
<b>Site Benchmark Name</b> WR11 2007	<b>Benchmark Elevation (NAVD88)</b> 67.59ft	<b>Datum Offset to NGVD29</b> + 1.08
<b>Reference Elevation (NAVD 88)</b> 70.67ft		<b>Existing Tag Elevation (Datum)</b> 71735ft (NGVD 29)
<b>Notes:</b> Ground elevation = 64.80ft (NAVD 88). Corpscon v6.0.1 offset = +1.08, Field offset = +1.065		

Photographs:

<p>Overall Site</p> 	<p>Benchmark Close Up</p> 	<p>Benchmark Location</p> 
<p>Brass Tag Close Up</p>  <p><b>Tag not changed</b></p>	<p>Brass Tag + Reference Mark</p> 	<p>Staff Gauge</p> 



Calibrated  
to  
NAVD 88  
SFWMD  
+1.08 TD NGVD29

68  
67  
66  
65  
64  
63  
62  
61  
60  
59  
58  
57  
56  
55  
54  
53  
52  
51  
50  
49  
48  
47  
46  
45  
44  
43  
42  
41  
40  
39  
38  
37  
36  
35  
34  
33  
32  
31  
30  
29  
28  
27  
26  
25  
24  
23  
22  
21  
20  
19  
18  
17  
16  
15  
14  
13  
12  
11  
10  
9  
8  
7  
6  
5  
4  
3  
2  
1  
0  
68.0  
67.0  
66.0  
65.0  
64.0  
63.0  
62.0  
61.0  
60.0  
59.0  
58.0  
57.0  
56.0  
55.0  
54.0  
53.0  
52.0  
51.0  
50.0  
49.0  
48.0  
47.0  
46.0  
45.0  
44.0  
43.0  
42.0  
41.0  
40.0  
39.0  
38.0  
37.0  
36.0  
35.0  
34.0  
33.0  
32.0  
31.0  
30.0  
29.0  
28.0  
27.0  
26.0  
25.0  
24.0  
23.0  
22.0  
21.0  
20.0  
19.0  
18.0  
17.0  
16.0  
15.0  
14.0  
13.0  
12.0  
11.0  
10.0  
9.0  
8.0  
7.0  
6.0  
5.0  
4.0  
3.0  
2.0  
1.0  
0

68  
67  
66  
65  
64  
63  
62  
61  
60  
59  
58  
57  
56  
55  
54  
53  
52  
51  
50  
49  
48  
47  
46  
45  
44  
43  
42  
41  
40  
39  
38  
37  
36  
35  
34  
33  
32  
31  
30  
29  
28  
27  
26  
25  
24  
23  
22  
21  
20  
19  
18  
17  
16  
15  
14  
13  
12  
11  
10  
9  
8  
7  
6  
5  
4  
3  
2  
1  
0  
68.0  
67.0  
66.0  
65.0  
64.0  
63.0  
62.0  
61.0  
60.0  
59.0  
58.0  
57.0  
56.0  
55.0  
54.0  
53.0  
52.0  
51.0  
50.0  
49.0  
48.0  
47.0  
46.0  
45.0  
44.0  
43.0  
42.0  
41.0  
40.0  
39.0  
38.0  
37.0  
36.0  
35.0  
34.0  
33.0  
32.0  
31.0  
30.0  
29.0  
28.0  
27.0  
26.0  
25.0  
24.0  
23.0  
22.0  
21.0  
20.0  
19.0  
18.0  
17.0  
16.0  
15.0  
14.0  
13.0  
12.0  
11.0  
10.0  
9.0  
8.0  
7.0  
6.0  
5.0  
4.0  
3.0  
2.0  
1.0  
0  
68.0  
67.0  
66.0  
65.0  
64.0  
63.0  
62.0  
61.0  
60.0  
59.0  
58.0  
57.0  
56.0  
55.0  
54.0  
53.0  
52.0  
51.0  
50.0  
49.0  
48.0  
47.0  
46.0  
45.0  
44.0  
43.0  
42.0  
41.0  
40.0  
39.0  
38.0  
37.0  
36.0  
35.0  
34.0  
33.0  
32.0  
31.0  
30.0  
29.0  
28.0  
27.0  
26.0  
25.0  
24.0  
23.0  
22.0  
21.0  
20.0  
19.0  
18.0  
17.0  
16.0  
15.0  
14.0  
13.0  
12.0  
11.0  
10.0  
9.0  
8.0  
7.0  
6.0  
5.0  
4.0  
3.0  
2.0  
1.0  
0

Calibrated  
to  
NAVD 88  
SFWM D

+1.08 TO NGVD29

68

67

66

65

64





INDUSTRIES  
WTS-COM

ELEV. 71.97  
DATE 12

11160  
100E

100E 3000 9/2004

Warning:  
Risk of fire, explosion, or burns.  
Do not disassemble or incinerate.  
Do not heat above 60°C.



WR 11 W  
ELEV. 0.696 NAVD88  
DATE 7-23-12  
BY C.S.D.G.  
OFFSET +1.08

WR 11 W  
ELEV. 71.735  
X DATE 5-14-08  
BY JS AH  
NAVD NGVD 29

7  
4  
5  
6  
7





**SURVEY MARKER**

SOUTH FLORIDA WATER MANAGEMENT DISTRICT

**PLEASE**

DO NOT DISTURB

21.4



FLA. WATER SURVEY MANAGEMENT DISTRICT  
WR11  
2007  
MARKER

SEC	3	TWP	28	RGE	29
ESTABLISH NAVS 88 ELEV @ INR 11					
STA	+	HI	-	ELEV	BM ELEV
BM					67.59
	4.41	72.00			
	2.36				
2" PVC			1.08	70.92	
3" PVC			1.33	70.67	
GRND			7.2	64.80	
TPoin			5.58	66.42	
BM			4.41	67.59	67.59
			2.36		

T. STRICKLAND  
& CLANTON

## COMMENTS

BM WR 11 2007 SFWALD ALUM CAP IN 6" PVC  
GOOD COND

GWL 2" PVC PIPE "V" NOTCH NW SIDE

SWI  ATOP of PLYWOOD PLATFORM 8" PVC WELL

GROUND @ SITE

Top of WATER STAFF GA READS 66.43

BM WR 11 2007

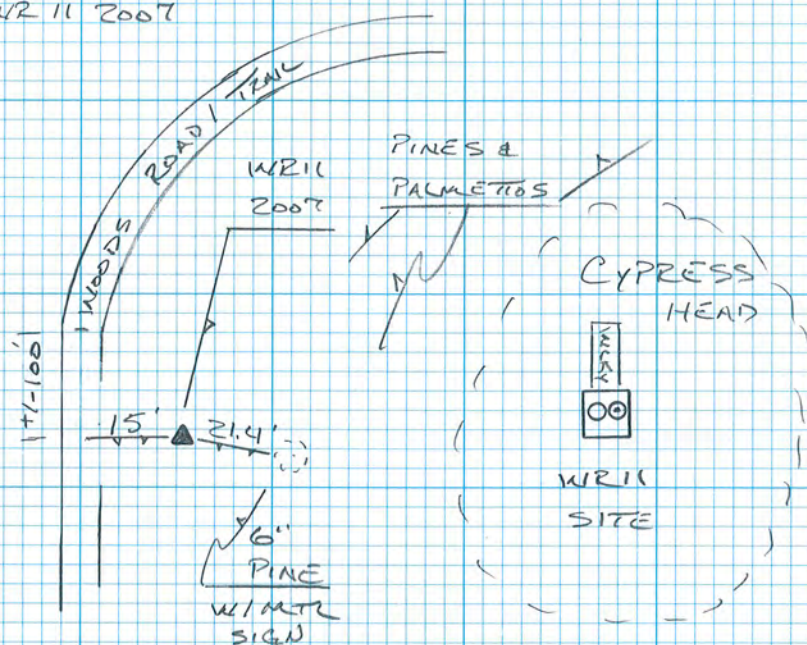



## Survey Data Entry and Retrieval Application (SDERA) Print Output

### Control Point Search Results

Derived Data - Denoted By: \*\*

Designation	WR112007	Record State	ACCEPTED
NGS PID		Date Entered/Updated	06/27/2009
Project Name	WR11 WELL SITE	Status	
Updated By	ATLAS DATA LOAD	Type	H/V
Party Chief		Date Established	01/01/2007
Monument Set By	WOOLPERT INC	Section	3
County	OSCEOLA	Range	29
Township	28	Offset (29 to 88)	
Quadrangle	LAKE HATCHINEHA	CCR Link	
NGS Source BM			
Ctrl Pt Source(s)			

<u>Horizontal</u>	<u>NAD 1927</u>	<u>NAD 1983</u>	<u>Vertical</u>	<u>NGVD 1929</u>	<u>NAVD 1988</u>
Latitude		28 05 03.6	Class		
Longitude		81 24 24.0	Order	3	3
Northing(Y)		1363587.0	Elevation	68.66	67.59
Easting(X)		525045.0	Measurement Unit	Feet	Feet
Class					
Order					
NAD83 Adj Year					

### Field Book

WO104-

### Field Book Pages

### Stamping

WR11 2007

### How to Reach

### Description

12/19/2007 CESTNICK, WOOLPERT, INC. CONTRACTOR S FB WO104 NO PAGE INDICATED TO REACH FROM THE INTERSECTION OF US 423 AND US 192 IN KISSIMMEE, FLORIDA; TRAVEL SOUTH ON NORTH JOHN YOUNG PARKWAY FOR 3.51 MILES TO PLEASANT HILL ROAD. TURN LEFT (SOUTH) ON PLEASANT HILL ROAD AND TRAVEL 8.6 MILES TO SCRUB JAY TRAIL. TURN LEFT (EAST) ONTO SCRUB JAY TRAIL (ENTRANCE TO DISNEY WILDERNESS PRESERVE, GATE ACCESS REQUIRED) TRAVEL ALONG SCRUB JAY TRAIL 1.4 MILES TO UNNAMED DIRT ROAD ON RIGHT. TURN ONTO DIRT ROAD (WEST) AND TRAVEL DIRT ROAD 0.70 OF A MILE TO ANOTHER UNNAMED DIRT ROAD AND TURN LEFT (SOUTH). TRAVEL DIRT ROAD FOR 3.1 MILES TO OFF ROAD TRAIL ON LEFT (EAST). TURN LEFT ON TRAIL AND FOLLOW TRAIL FOR 0.40 OF A MILE. BENCH MARK



FOR  
WELL IS ON RIGHT SIDE (SOUTH) OF TRAIL +/- 10 FT.

**DISCLAIMER:**

The South Florida Water Management District (hereinafter referred to as the DISTRICT ) shall not be held liable for improper or incorrect use of the data, information, apparatus, products, processes or materials described and/or contained herein. These data, information, apparatus, products, processes, materials and related graphics are not legal documents and are not intended to be used as such. The user hereby recognizes that the information, data, apparatus, products, processes and materials are dynamic and may change over time without notice. However, the DISTRICT makes no commitment to update the information, data, apparatus, products, processes or materials contained herein.