



SOUTH FLORIDA WATER MANAGEMENT DISTRICT

Rev. 1/16

U.S.G.S. Station Name: G-1260	U.S.G.S. Station Number: 261903080065601	Agency: SFWMD	Date of Field Work: 09/27/19
Party Chief: T. AVERY	Field Book: SFWMD #2	Page(s): 1-3	Report Prepared by: DEWBERRY

SITE SPECIFIC DATA

Site Benchmark: G-1260	Benchmark Elevation(s) (NAVD88): 10.89 feet	Corpscon 6.0.1 Conversion Factor (NAVD88 to NGVD29) + 1.56 feet	
Well Reference Elevation (NAVD88): 10.64'		Ground Elevation (NAVD88): 9.6'	Pad Elevation (NAVD88): N/A

GEOGRAPHIC DATA

Section 1	Township 48 SOUTH	Range 42 EAST
Well Latitude: 26°19'04.48"N	Well Longitude: 80°06'55.17"W	Location Source: AVERAGED FPRN & TRIMBLE VRSNOW RTK
State Plane Coordinates:	Northing (Y) = 722232'	Easting (X) = 945959'

Notes: NAVD88 – North American Vertical Datum of 1988; NGVD29- National Geodetic Vertical Datum of 1929; Corpscon 6.0.1 - A U.S. Army Corps of Engineers Engineering Research and Development Center Topographic Engineering Center Alexandria, Virginia Windows-based program to convert coordinates and elevations between datum's using vertcon05.txt and vertcon05.05 files supplied by the U.S. Army Corps of Engineers South Atlantic Division, Jacksonville Fl.

PICTURES

Well Site
Latitude: 26°19'04.5"
Longitude: 80°06'55.2"

Benchmark "G-1260"
Latitude: 26°19'04.5"
Longitude: 80°06'55.0"
NAVD88 EL = 10.89 FEET

Not to scale (GoogleEarth product)



SOUTH FLORIDA WATER MANAGEMENT DISTRICT

Rev. 1/16

Well Site and Well Head (Continued on next page)

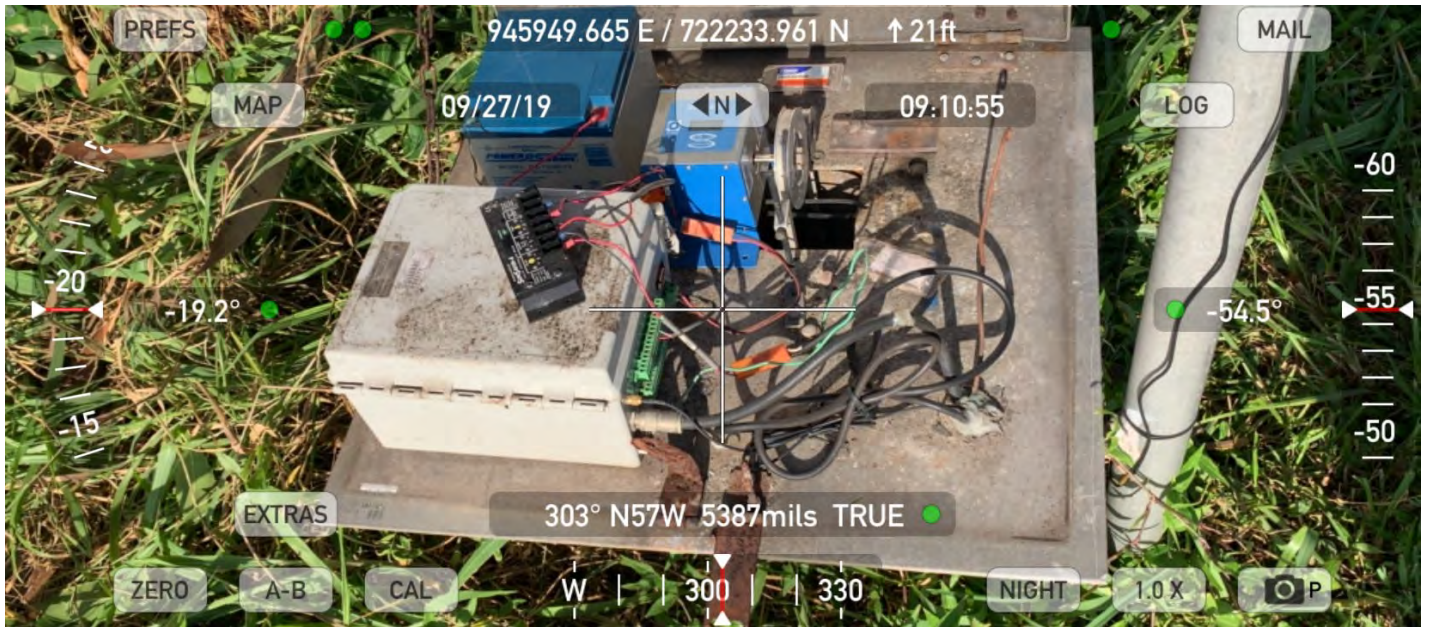



SOUTH FLORIDA WATER MANAGEMENT DISTRICT

Rev. 1/16

Well Site and Well Head (Continued)



Well: 6" Metal pipe under enclosure
Reference Point: North corner of hole
in base of well enclosure

Reference Point El. =
10.64 feet NAVD88

Distance to water =
-6.60 feet from reference point
(09/27/19 at 9:25 AM)





SOUTH FLORIDA WATER MANAGEMENT DISTRICT

Rev. 1/16

New Aluminum Tag





SOUTH FLORIDA WATER MANAGEMENT DISTRICT

Rev. 1/16

USGS RMs



RM 3 – Nail in concrete utility slab



Latitude: 26° 19' 04.7"

Longitude: 80° 06' 54.4"

NAVD88 EL = 12.63 FEET

RM 2 – Nail in concrete sidewalk



Latitude: 26° 19' 04.8"

Longitude: 80° 06' 54.6"

NAVD88 EL = 12.57 FEET

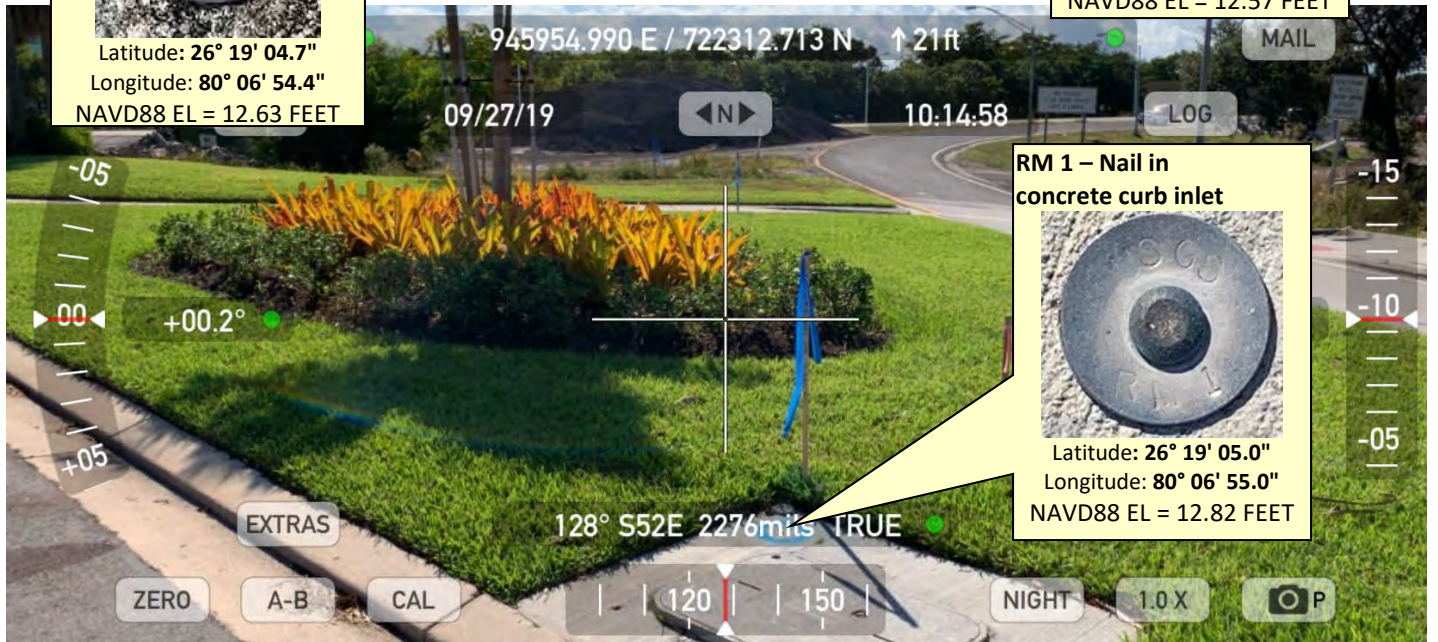

RM 1 – Nail in concrete curb inlet



Latitude: 26° 19' 05.0"

Longitude: 80° 06' 55.0"

NAVD88 EL = 12.82 FEET



SOUTH FLORIDA WATER MANAGEMENT DISTRICT

Rev. 1/16

Site Benchmark



Site BM: G1260



Latitude: 26°19'04.5"
Longitude: 80°06'55.0"
"NAVD88 EL = 10.89 FEET





SOUTH FLORIDA WATER MANAGEMENT DISTRICT

Rev. 1/16

Source Benchmarks



NGS Benchmark "010" (DO2649)



Latitude: 26°17'03.9"
Longitude: 80°06'39.5"
NAVD88 EL = 15.16 FEET



NGS Benchmark "E 235"(AD2629)



Latitude: 26°19'05.6"
Longitude: 80°06'05.0"
NAVD88 EL = 13.67 FEET



South Florida Water Management District Benchmark Datasheet

Designation: G-1260 Project Name: USGS Ph 2, BROWARD Type: V State Plane Zone: FL East
 Stamping: G1260 2019 Field Book Name: W203/W212 Field Book Page: 69-70/58
 Established By: DEWBERRY / WHIDDEN Recovered By: N/A Recovery Date: N/A
 Surveyor: WILLIAM D. DONLEY Established Date: 09/17/19 & 09/15/19 Status: New

GEOGRAPHIC POSITION INFORMATION

Section: 1 Township: 48 SOUTH Range: 42 EAST
 County: BROWARD Quadrangle: BOCARATON NGS Source BM(s): E 235
 NAD83 Adj. Year: 2011 Vertical Datum: NAVD1988 Horizontal Datum: NAD1983 NGS PID(s): AD2629
 NAVD88 Elevation (feet): 10.89 NGVD29 Elevation (feet): 12.45 2022 Elevation: N/A NGS NAVD88 Elev (ft): 13.67
 NAVD88 Class: N/A NGVD29 Class: N/A Other Elevation: N/A NGS NAVD88 Elev (m): 4.168
 NAVD88 Order: 3 NGVD29 Order: N/A Other Elevation Type: N/A NGS 2022 Elev (ft): N/A

CORPSCON 6.0.1 CONVERSION FACTOR (NAVD88 TO NGVD29): (A U.S. Army Corps of Engineers Engineering Research and Development Center Topographic Engineering Center Alexandria, Virginia Windows-based program to convert coordinates and elevations between datum's using vertcon05.txt and vertcon05.05 files supplied by the U.S. Army Corps of Engineers South Atlantic Division, Jacksonville FL.)

Vertical Datum Offset: + 1.56 Actual NGS Elevation or ngvd29.txt file: N/A OPUS Ortho Height: N/A
 Northing (Y) (feet): 722233.5 Easting (X) (feet): 945974.7 Source of Latitude & Longitude: AVERAGED FPRN & TRIMBLE VRSNOW RTK
 Latitude: 26 19 4.5 Longitude: 80 6 54.99
 DD" MM' SS" DD" MM' SS"
 Latitude (Decimal Degrees): 26.317917 Longitude (Decimal Degrees): -80.115275

RECOVERY DATA

How to Reach: **1. FROM N MILITARY TRAIL, HEAD EAST ON FL-810/W HILLSBORO BLVD FOR 0.7 MI**
2. MERGE INTO FAR RIGHT TURN LANE FOR THE ON-RAMP FOR I-95 NORTH, CONTINUE 515 FEET TO THE MARK ON THE RIGHT, LOCATED JUST BEFORE THE PEDESTRIAN CROSSWALK.

Description/Notes: **2" ALUMINUM SFWMD DISK SET IN CONCRETE BASE OF PEDESTRIAN CROSSING SIGN**

Notable Landmarks:

Other Source Benchmarks: **NGS "010" (DO2649)**

PICTURES

Aerial View of Overall Site



NOT TO SCALE. AERIAL FROM GOOGLE EARTH.

PICTURES

Site Sketch

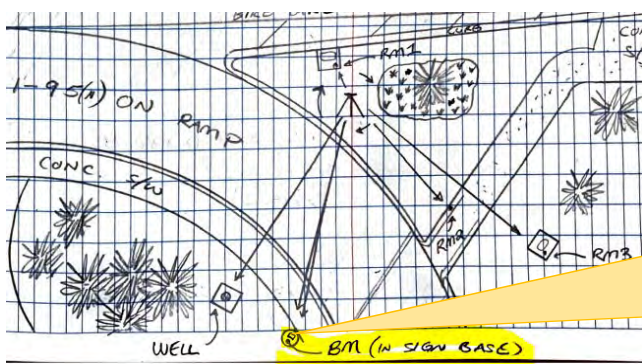



"010" Benchmark Datasheet (1 of 2)

The NGS Data Sheet

See file [dsdata.pdf](#) for more information about the datasheet.

```

PROGRAM = datasheet95, VERSION = 8.12.5.4
1      National Geodetic Survey;  Retrieval Date = NOVEMBER 15, 2019
DO2649 *****
DO2649 DESIGNATION - 010
DO2649 PID - DO2649
DO2649 STATE/COUNTY- FL/BROWARD
DO2649 COUNTRY - US
DO2649 USGS QUAD - BOCA RATON (1983)
DO2649
DO2649 *CURRENT SURVEY CONTROL
DO2649
DO2649* NAD 83(1986) POSITION- 26 17 03. (N) 080 06 39. (W) SCALED
DO2649* NAVD 88 ORTHO HEIGHT - 4.621 (meters) 15.16 (feet) ADJUSTED
DO2649
DO2649 GEOID HEIGHT - -25.855 (meters) GEOID18
DO2649 DYNAMIC HEIGHT - 4.614 (meters) 15.14 (feet) COMP
DO2649 MODELED GRAVITY - 979,075.7 (mgal) NAVD 88
DO2649
DO2649 VERT ORDER - SECOND CLASS II
DO2649
DO2649.The horizontal coordinates were scaled from a map and have
DO2649.an estimated accuracy of +/- 6 seconds.
DO2649.
DO2649.The orthometric height was determined by differential leveling and
DO2649.adjusted by the NATIONAL GEODETIC SURVEY
DO2649.in December 2012.
DO2649
DO2649.Significant digits in the geoid height do not necessarily reflect accuracy.
DO2649.GEOID18 height accuracy estimate available here.
DO2649
DO2649.Click here to see if photographs exist for this station.
DO2649
DO2649.The dynamic height is computed by dividing the NAVD 88
DO2649.geopotential number by the normal gravity value computed on the
DO2649.Geodetic Reference System of 1980 (GRS 80) ellipsoid at 45
DO2649.degrees latitude (g = 980.6199 gals.).
DO2649
DO2649.The modeled gravity was interpolated from observed gravity values.
DO2649
DO2649; North East Units Estimated Accuracy
DO2649;SPC FL E - 216,400. 288,800. MT (+/- 180 meters Scaled)
DO2649
DO2649_U.S. NATIONAL GRID SPATIAL ADDRESS: 17RNK887074(NAD 83)
DO2649
DO2649 SUPERSEDED SURVEY CONTROL
DO2649
DO2649.No superseded survey control is available for this station.
DO2649
DO2649_MARKER: DB = BENCH MARK DISK
DO2649_SETTING: 7 = SET IN TOP OF CONCRETE MONUMENT
DO2649_STAMPING: 010 2011

```



SOUTH FLORIDA WATER MANAGEMENT DISTRICT

Rev. 1/16

"010" Benchmark Datasheet (2 of 2)

DO2649_MARK LOGO: FL2570
DO2649_PROJECTION: RECESSED 5 CENTIMETERS
DO2649_MAGNETIC: R = STEEL ROD IMBEDDED IN MONUMENT
DO2649_STABILITY: C = MAY HOLD, BUT OF TYPE COMMONLY SUBJECT TO
DO2649+STABILITY: SURFACE MOTION
DO2649_SATELLITE: THE SITE LOCATION WAS REPORTED AS SUITABLE FOR
DO2649+SATELLITE: SATELLITE OBSERVATIONS - December 22, 2011

DO2649	HISTORY	- Date	Condition	Report By
DO2649	HISTORY	- 20111222	MONUMENTED	STONER

DO2649
DO2649 STATION DESCRIPTION

DO2649'DESCRIBED BY STONER AND ASSOCIATES INC 2011 (DWS)
DO2649'THE MARK IS ABOUT 6.0 MI (9.7 KM) EAST-SOUTHEAST OF WEST DIXIE BEND,
DO2649'5.4 MI (8.7 KM) SOUTH-SOUTHWEST OF BOCA RATON, 3.3 MI (5.4 KM)
DO2649'NORTH-NORTHEAST OF POMPANO BEACH, IN SECTION 13, TOWNSHIP 48 SOUTH,
DO2649'RANGE 42 EAST. OWNERSHIP IS THE FLORIDA DEPARTMENT OF TRANSPORTATION.
DO2649'TO REACH THE MARK FROM THE INTERSECTION OF WEST ATLANTIC BOULEVARD AND
DO2649'NORTH DIXIE HIGHWAY IN POMPANO BEACH, GO NORTH ON NORTH DIXIE HIGHWAY
DO2649'FOR 3.8 MI (6.1 KM) TO THE MARK ON THE RIGHT, SET IN THE TOP OF A
DO2649'10-INCH (25 CM) ROUND CONCRETE MONUMENT RECESSED 0.2 FT (6 CM) BELOW
DO2649'THE LEVEL OF THE GROUND AND LEVEL WITH NORTH DIXIE HIGHWAY.

DO2649'
DO2649'LOCATED 235.0 FT (71.6 M) SOUTH OF THE INTERSECTION OF NORTH DIXIE
DO2649'HIGHWAY AND NORTHEAST 43RD COURT, 50.0 FT (15.2 M) EAST OF THE
DO2649'CENTERLINE OF NORTH DIXIE HIGHWAY, 36.7 FT (11.2 M) WEST OF THE WEST
DO2649'RAIL OF THE RAIL ROAD, 13.2 FT (4.0 M) SOUTHWEST OF A 6-INCH (15 CM)
DO2649'BLACK OLIVE TREE, 12.0 FT (3.7 M) EAST OF THE EAST EDGE OF A 2.0 FT
DO2649'(0.6 M) WIDE CURB AND GUTTER AND 1.3 FT (0.4 M) WEST OF A CARSONITE
DO2649'WITNESS POST.

DO2649'
DO2649'NOTE REBAR ROD IS IMBEDDED IN THE MONUMENT.

*** retrieval complete.
Elapsed Time = 00:00:02



"E 235" Benchmark Datasheet (1 of 4)

The NGS Data Sheet

See file [dsdata.pdf](#) for more information about the datasheet.

PROGRAM = datasheet95, VERSION = 8.12.5.2
1 National Geodetic Survey, Retrieval Date = MAY 20, 2019
AD2629 *****
AD2629 DESIGNATION - E 235
AD2629 PID - AD2629
AD2629 STATE/COUNTY- FL/BROWARD
AD2629 COUNTRY - US
AD2629 USGS QUAD - BOCA RATON (1983)
AD2629
AD2629 *CURRENT SURVEY CONTROL
AD2629
AD2629* NAD 83(2011) POSITION- 26 19 05.55152(N) 080 06 05.04537(W) ADJUSTED
AD2629* NAD 83(2011) ELLIP HT- -21.730 (meters) (06/27/12) ADJUSTED
AD2629* NAD 83(2011) EPOCH - 2010.00
AD2629* [NAVD 88](#) ORTHO HEIGHT - 4.168 (meters) 13.67 (feet) ADJUSTED
AD2629
AD2629 GEOID HEIGHT - -25.897 (meters) GEOID12B
AD2629 NAD 83(2011) X - 983,427.367 (meters) COMP
AD2629 NAD 83(2011) Y - -5,635,598.646 (meters) COMP
AD2629 NAD 83(2011) Z - 2,810,695.757 (meters) COMP
AD2629 LAPLACE CORR - -3.78 (seconds) DEFLEC12B
AD2629 DYNAMIC HEIGHT - 4.161 (meters) 13.65 (feet) COMP
AD2629 MODELED GRAVITY - 979,078.7 (mgal) NAVD 88
AD2629 OBS GRAVITY - 979,077.4 (mgal) GRAV_OBS
AD2629
AD2629 VERT ORDER - FIRST CLASS II
AD2629
AD2629 Network accuracy estimates per FGDC Geospatial Positioning Accuracy
AD2629 Standards:
AD2629 FGDC (95% conf, cm) Standard deviation (cm) CorrNE
AD2629 Horiz Ellip SD_N SD_E SD_h (unitless)
AD2629 -----
AD2629 NETWORK 0.82 1.55 0.34 0.33 0.79 -0.08755831
AD2629 -----
AD2629 Click [here](#) for local accuracies and other accuracy information.
AD2629
AD2629
AD2629.The horizontal coordinates were established by GPS observations
AD2629.and adjusted by the National Geodetic Survey in June 2012.
AD2629
AD2629.NAD 83(2011) refers to NAD 83 coordinates where the reference frame has
AD2629.been affixed to the stable North American tectonic plate. See
AD2629.[NA2011](#) for more information.
AD2629
AD2629.The horizontal coordinates are valid at the epoch date displayed above
AD2629.which is a decimal equivalence of Year/Month/Day.
AD2629
AD2629.The orthometric height was determined by differential leveling and
AD2629.adjusted by the NATIONAL GEODETIC SURVEY
AD2629.in May 2002.
AD2629
AD2629.WARNING-Repeat measurements at this control monument indicate possible
AD2629.vertical movement.
AD2629
AD2629.Significant digits in the geoid height do not necessarily reflect accuracy.
AD2629.GEOID12B height accuracy estimate available [here](#).



SOUTH FLORIDA WATER MANAGEMENT DISTRICT

Rev. 1/16

"E 235" Benchmark Datasheet (2 of 4)

AD2629
 AD2629.The X, Y, and Z were computed from the position and the ellipsoidal ht.
 AD2629
 AD2629.The Laplace correction was computed from DEFLEC12B derived deflections.
 AD2629
 AD2629.The ellipsoidal height was determined by GPS observations
 AD2629.and is referenced to NAD 83.
 AD2629
 AD2629.The dynamic height is computed by dividing the NAVD 88
 AD2629.geopotential number by the normal gravity value computed on the
 AD2629.Geodetic Reference System of 1980 (GRS 80) ellipsoid at 45
 AD2629.degrees latitude (g = 980.6199 gals.).
 AD2629
 AD2629.The modeled gravity was interpolated from observed gravity values.
 AD2629
 AD2629.The observed gravity was obtained from relative gravimeter ties
 AD2629.to the IGSN71 gravity network.
 AD2629
 AD2629. The following values were computed from the NAD 83(2011) position.
 AD2629

AD2629;	North	East	Units	Scale Factor	Converg.
AD2629;SPC FL E	- 220,179.202	289,718.839	MT	1.00004052	+0 23 54.3
AD2629;SPC FL E	- 722,371.27	950,519.22	sFT	1.00004052	+0 23 54.3
AD2629;UTM 17	- 2,911,236.059	589,688.227	MT	0.99969931	+0 23 54.3

AD2629!	- Elev Factor	x	Scale Factor	=	Combined Factor
AD2629!SPC FL E	- 1.00000341	x	1.00004052	=	1.00004393
AD2629!UTM 17	- 1.00000341	x	0.99969931	=	0.99970272

 AD2629_U.S. NATIONAL GRID SPATIAL ADDRESS: 17RNK8968811236(NAD 83)
 AD2629
 AD2629 SUPERSEDED SURVEY CONTROL
 AD2629

AD2629	NAD 83(2007)-	26 19 05.55172(N)	080 06 05.04606(W)	AD(2002.00)	0
AD2629	ELLIP H (02/10/07)	-21.717 (m)		GP(2002.00)	
AD2629	NAD 83(1999)-	26 19 05.55176(N)	080 06 05.04605(W)	AD()	1
AD2629	ELLIP H (12/12/02)	-21.710 (m)		GP()	3 1
AD2629	NAVD 88	4.17 (m)	13.7 (f)	LEVELING	3
AD2629	NAVD 88 (06/15/91)	4.162 (m)	13.65 (f)	SUPERSEDED	1 2
AD2629	NGVD 29 (??/??/92)	4.643 (m)	15.23 (f)	SUPERSEDED	1 2
AD2629	NGVD 29 (09/01/92)	4.643 (m)	15.23 (f)	ADJUSTED	1 2

 AD2629.Superseded values are not recommended for survey control.
 AD2629
 AD2629.NGS no longer adjusts projects to the NAD 27 or NGVD 29 datums.
 AD2629.See file [dsdata.pdf](#) to determine how the superseded data were derived.
 AD2629
 AD2629_MARKER: DB = BENCH MARK DISK
 AD2629_SETTING: 46 = COPPER-CLAD STEEL ROD W/O SLEEVE (10 FT.+)
 AD2629_STAMPING: E 235 1965
 AD2629_MARK LOGO: CGS
 AD2629_PROJECTION: FLUSH
 AD2629_MAGNETIC: M = MARKER EQUIPPED WITH BAR MAGNET
 AD2629_STABILITY: B = PROBABLY HOLD POSITION/ELEVATION WELL
 AD2629_SATELLITE: THE SITE LOCATION WAS REPORTED AS SUITABLE FOR
 AD2629+SATELLITE: SATELLITE OBSERVATIONS - January 14, 2008
 AD2629_ROD/PIPE-DEPTH: 13.1 meters
 AD2629

AD2629	HISTORY	- Date	Condition	Report By
AD2629	HISTORY	- 1965	MONUMENTED	CGS
AD2629	HISTORY	- 1973	GOOD	NGS
AD2629	HISTORY	- 1981	GOOD	FLDNR
AD2629	HISTORY	- 1982	GOOD	USPSQD
AD2629	HISTORY	- 1985	GOOD	USPSQD
AD2629	HISTORY	- 1987	GOOD	USPSQD



SOUTH FLORIDA WATER MANAGEMENT DISTRICT

Rev. 1/16

"E 235" Benchmark Datasheet (3 of 4)

AD2629	HISTORY	- 1989	GOOD	USPSQD
AD2629	HISTORY	- 1989	GOOD	USPSQD
AD2629	HISTORY	- 1990	GOOD	USPSQD
AD2629	HISTORY	- 19910102	GOOD	NGS
AD2629	HISTORY	- 19910615	GOOD	USPSQD
AD2629	HISTORY	- 20011020	GOOD	USPSQD
AD2629	HISTORY	- 20020521	GOOD	MAPTEC
AD2629	HISTORY	- 20080114	GOOD	MAPTEC
AD2629	HISTORY	- 20110124	POOR	FLDT
AD2629	HISTORY	- 20120925	GOOD	AMEC

AD2629

STATION DESCRIPTION

AD2629

AD2629'DESCRIBED BY COAST AND GEODETIC SURVEY 1965

AD2629'1.9 MI S FROM BOCA RATON.

AD2629'ABOUT 1.9 MILES SOUTH ALONG THE FLORIDA EAST COAST RAILWAY FROM
AD2629'THE STATION AT BOCA RATON, AT DEERFIELD BEACH, 107.5 FEET SOUTH
AD2629'OF THE SOUTH CURB OF EAST HILLSBORO BLVD, IN SECTION 6, R 42 E,
AD2629'T 48 S, 29.5 FEET WEST OF THE WEST RAIL OF THE SOUTHBOUND TRACK,
AD2629'1.7 FEET WEST OF MILEPOST 327, 1.9 FEET NORTH OF A VERTICAL RAIL
AD2629'IN GROUND WHICH PROJECTS 4 FEET ABOVE THE GROUND, 2.0 FEET SOUTH
AD2629'OF ANOTHER VERTICAL RAIL WHICH PROJECTS 4 FEET ABOVE GROUND, 43
AD2629'FEET EAST OF THE CENTER LINE OF THE OLD DIXIE HIGHWAY, 1.5 FEET
AD2629'EAST OF A METAL WITNESS POST, ABOUT LEVEL WITH THE TOP OF RAIL,
AD2629'AND IS A DISK SET ON THE TOP OF A COPPER COATED STEEL ROD WHICH
AD2629'PROJECTS 1 INCH ABOVE THE LEVEL OF THE GROUND AND PROTECTED BY
AD2629'A 4 INCH IRON PIPE WHICH PROJECTS ONE INCH. THE ROD WAS DRIVEN
AD2629'TO REFUSAL AT A DEPTH OF 43 FEET.

AD2629

STATION RECOVERY (1973)

AD2629

AD2629'RECOVERY NOTE BY NATIONAL GEODETIC SURVEY 1973

AD2629'RECOVERED IN GOOD CONDITION.

AD2629

STATION RECOVERY (1981)

AD2629

AD2629'RECOVERY NOTE BY FL DEPT OF NAT RES 1981

AD2629'RECOVERED IN GOOD CONDITION.

AD2629

STATION RECOVERY (1982)

AD2629

AD2629'RECOVERY NOTE BY US POWER SQUADRON 1982

AD2629'CHANGE DESC:LOCATION SHOULD READ 'SECTION 6, R 43' NOT R 42.

AD2629

STATION RECOVERY (1985)

AD2629

AD2629'RECOVERY NOTE BY US POWER SQUADRON 1985

AD2629'RECOVERED IN GOOD CONDITION.

AD2629

STATION RECOVERY (1987)

AD2629

AD2629'RECOVERY NOTE BY US POWER SQUADRON 1987 (JHH)

AD2629'RECOVERED IN GOOD CONDITION.

AD2629

STATION RECOVERY (1989)

AD2629

AD2629'RECOVERY NOTE BY US POWER SQUADRON 1989 (JHF)

AD2629'RECOVERED IN GOOD CONDITION.

AD2629

STATION RECOVERY (1989)

AD2629

AD2629'RECOVERY NOTE BY US POWER SQUADRON 1989 (JHH)

AD2629'RECOVERED IN GOOD CONDITION.

AD2629

STATION RECOVERY (1990)

AD2629



SOUTH FLORIDA WATER MANAGEMENT DISTRICT

Rev. 1/16

"E 235" Benchmark Datasheet (4 of 4)

AD2629
AD2629'RECOVERY NOTE BY US POWER SQUADRON 1990 (JHH)
AD2629'RECOVERED IN GOOD CONDITION.
AD2629
AD2629 STATION RECOVERY (1991)
AD2629
AD2629'RECOVERY NOTE BY NATIONAL GEODETIC SURVEY 1991
AD2629'IN DEERFIELD BEACH, AT THE INTERSECTION OF DIXIE HIGHWAY AND
AD2629'HILLSBORO BOULEVARD, 34.8 M (114.2 FT) SOUTH OF THE CENTER OF THE
AD2629'EASTBOUND LANES OF THE BOULEVARD, 30.7 M (100.7 FT) SOUTH OF A
AD2629'UTILITY LIGHT POLE, 14.3 M (46.9 FT) EAST OF AND LEVEL WITH THE
AD2629'HIGHWAY CENTER, 12.8 M (42.0 FT) WEST OF THE NEAR RAIL OF THE FLORIDA
AD2629'EAST COAST RAILROAD, 9.0 M (29.5 FT) WEST OF RAILROAD MILE POST 327,
AD2629'NEAR THE CENTER OF 2 VERTICAL RAILS, AND 0.3 M (1.0 FT) WEST OF A
AD2629'WITNESS POST. NOTE--THE DISK IS ENCASED IN A 4-INCH IRON PIPE THAT
AD2629'IS FLUSH WITH THE GROUND SURFACE.
AD2629
AD2629 STATION RECOVERY (1991)
AD2629
AD2629'RECOVERY NOTE BY US POWER SQUADRON 1991 (RCW)
AD2629'RECOVERED IN GOOD CONDITION.
AD2629
AD2629 STATION RECOVERY (2001)
AD2629
AD2629'RECOVERY NOTE BY US POWER SQUADRON 2001 (RWL)
AD2629'RECOVERED IN GOOD CONDITION.
AD2629
AD2629 STATION RECOVERY (2002)
AD2629
AD2629'RECOVERY NOTE BY MAPTECH INCORPORATED 2002 (CDP)
AD2629'RECOVERED AS DESCRIBED.
AD2629'
AD2629
AD2629 STATION RECOVERY (2008)
AD2629
AD2629'RECOVERY NOTE BY MAPTECH INCORPORATED 2008 (CN)
AD2629'RECOVERED AS DESCRIBED
AD2629
AD2629 STATION RECOVERY (2011)
AD2629
AD2629'RECOVERY NOTE BY FLORIDA DEPARTMENT OF TRANSPORTATION 2011 (PED)
AD2629'MARK RECOVERED IN POOR CONDITION.
AD2629
AD2629 STATION RECOVERY (2012)
AD2629
AD2629'RECOVERY NOTE BY AMEC EARTH & ENVIRONMENTAL 2012 (RLE)
AD2629'RECOVERED IN GOOD CONDITION.

*** retrieval complete.
Elapsed Time = 00:00:05



SOUTH FLORIDA WATER MANAGEMENT DISTRICT

Rev. 1/16

Dewberry Field Notes (1 of 3)

SPECTRA SP20 S F W M D 02/27/19
 Rover S/N: 1165 USGS WELLS & BMs
 TRIMBLE NETWORK Job # 50099949
 HI: G.567 WELL SITE G.1260

TASK: ESTABLISH HORIZONTAL LOCATIONS ON WELL MONITORING POINT & REFERENCE MONUMENTATION

PT#	(N) COR	(E) COR	(E) COR	PT#	DESCRIPTION
S/O	S	0.083	-0.041	5048	CHK-IN BTA @ G.1260
* LOCATED PT #'S 12066-12069					
S/O	S	0.034	-0.043	5049	CHK-OUT BTA @ G.1260

PT#	DESCRIPTION
12066	MNDF "USGS RM-1"
12067	MNDF "USGS RM-2"
12068	MNDF "USGS RM-3"
12069	MPC @ N CORNER OF HOLE IN BASE OF WELL ENCLOSURE

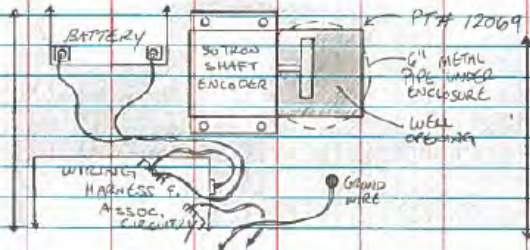

TASK: MEASURE & RECORD DISTANCE TO WATERLINE FROM MONITORING POINT

MEASUREMENT: 6.60, AS MEASURED FROM PT # 12069

TIME: 9:25 AM

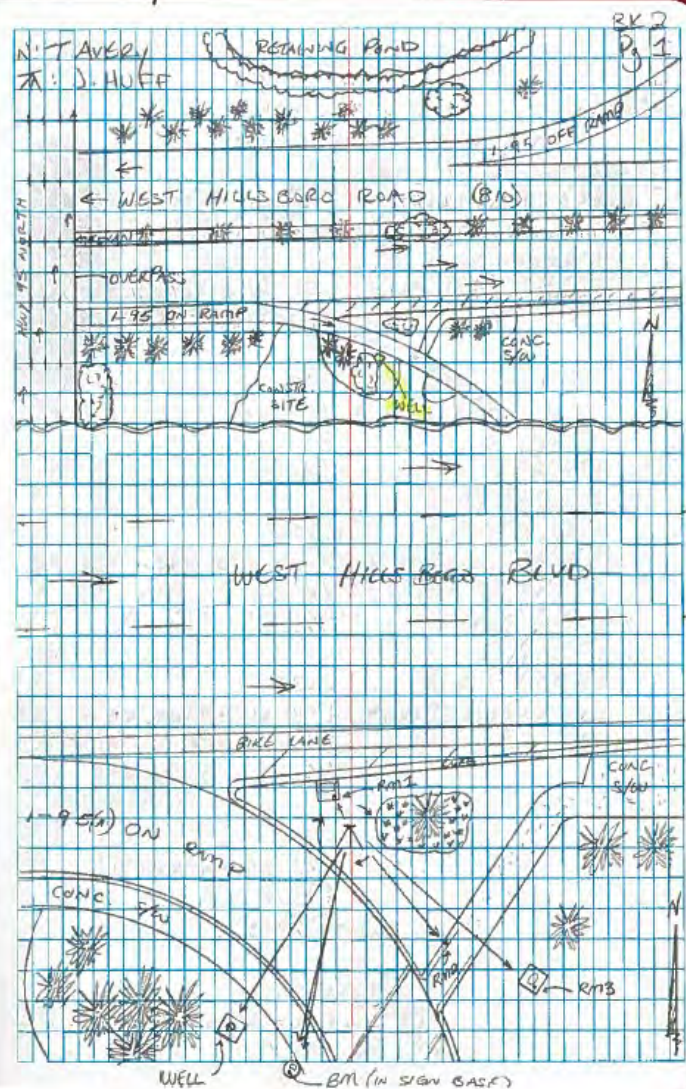



SOUTH FLORIDA WATER MANAGEMENT DISTRICT

Rev. 1/16

Dewberry Field Notes (2 of 3)

Table		SFWMD		09/27/19	
AFG?		USGS WELLS & BMS			
S/N: 148A		JOB #: 5009-944A			
		WELL SITE: G-1260			
<p>TASK: ELEVATE MONITORING POINT, REFERENCE MONUMENTATION, & GROUND @ WELL SITE</p>					
BACKSIGHT (+)			FORESIGHT (-) ASMD AD:		
STA ID	RODS	MEAN ELEV	RODS	MEAN ELEV	ELEV
	7.07		7.32		10.00 10.89
BM	6.815	6.8133	7.06	7.0600	977399 12.1433
	6.555	17.7033	6.80		
	51.5' / 51.5'		52' / 103.5'		
			8.355		
"	"	17.7033	8.10	8.1000	987403 9.6033
			7.845		
			51' / 102.5'		
			5.035		
"	"	17.7033	4.985	4.9817	101891 12.7216
			4.925		
			11' / 62.5'		
			5.38		
"	"	17.7033	5.115	5.1150	1016403 12.5813
			4.85		
			53' / 104.5'		
			5.435		
"	"	17.7033	5.065	5.0623	1017000 12.6400
			4.69		
			74.5' / 126'		

N: T. AVERY		B2	
A: J. HUFF		822	
BEGIN @	ELEVATION	DESCRIPTION	
	10.00 10.89 (WHITEDEN) (HANDS)	ALUMINUM DISC, 2", SET ATOP OF CONCRETE BASE FOR STREET SIGN SOUTH OF SOUTHEASTLY OVERLINE FOR I-95 N. ON RAMP	
FORESIGHT (-)			
DESCRIPTION			
M.P. ENCLOSURE BASE @ NORTH CORNER OF PIPE OPENING			
GROUND SIGN NORTH OF WELL ENCLOSURE			
RM-1 - REC MAG NAIL & DISC, STAMPED "USGS RM1" LOCATED IN TOP OF CURB INLET ACROSS THE ON-RAMP TO I-95 NORTH, NORTH OF WELL ENCLOSURE			
RM-2, REC MND STAMPED "USGS RM2" IN SIDEWALK ACROSS THE I-95 ON-RAMP, NORTHEASTERLY DIRECTION FROM WELL ENCLOSURE			
RM-3, REC MND STAMPED "USGS RM3" LOCATED IN CONCRETE UTILITY SCAB ACROSS I-95 ON RAMP NORTH, IN THE NORTHEASTERLY DIRECTION FROM WELL ENCLOSURE			
* BREAK SET-UP			



SOUTH FLORIDA WATER MANAGEMENT DISTRICT

Rev. 1/16

Dewberry Field Notes (3 of 3)

Tables AT-GZ S/N: 1439		SEWMD USGS WELLS E. BMS JOB # 5009 9049 WELL SITE: G-1260		09/21/19		
TASK: CONTINUE ELEVATING POINTS OF INTEREST						
BACKSIGHT (+)		IK		FORESIGHT (-)		ADJ
STA. ID	RODS	MEAN	ELEV	RODS	MEAN	ELEV
	5.69			7.25		
RMS	5.225	5.2267	106.7767	6.98	6.9783	99.8983 10.1884
	4.865		17.8667	6.73		
	17.5'/98.5'			49.5'/248'		

N: T. AVERY IK: J. HUFF		B3 BKR
FORESIGHT (-) DESCRIPTION:		
BACK @ STARTING POINT (SITE BM)		
check I _m = -0.0016'		
T. N. Avery		



SOUTH FLORIDA WATER MANAGEMENT DISTRICT

Rev. 1/16

Whidden Field Notes (1 of 3)

STA.	+	HI	-	EL	
61260					
E235	8.839	19.809		18.267	
TP 1			5.986	18.525	
	7.576	20.299			
TP 2			4.284	16.645	
	4.957	21.396			
TP 3			8.967	15.628	
	3.965	19.955			
TP 4			6.666	16.928	
	4.265	18.113			
TP 5			4.577	10.527	
	5.343	18.670			
TP 6			5.65	10.140	
	4.565	14.605			
TP 7			8.057	9.521	
	6.592	16.073			
TP 8			4.395	11.69	
	5.911	17.601			
TP 9			4.575	18.226	
	3.846	18.772			
TP 10			5.708	13.064	
	3.095	14.159			

STA.	+	HI	-	EL	
61260 TPI					
	8.103	18.999			
TP 12				3.291	18.708
	4.970	18.698			
TP 13				6.306	18.372
	9.469	17.091			
TP 14				6.102	16.989
	3.931	14.850			
TP 15				5.973	9.906
	8.965	18.309			
TP 16				4.779	16.550
	4.620	15.150			
TP 17				5.526	9.823
	6.995	16.518			
TP 18				2.011	14.777
	6.150	20.905			
TP 19				4.646	16.288
	5.547	21.805			
TP 20				6.650	14.150



SOUTH FLORIDA WATER MANAGEMENT DISTRICT

Rev. 1/16

Whidden Field Notes (2 of 3)

G1260 CONT

STATION	+	HI	-	FC
	3.921	18.377		
7771			4.040	14.337
	4.840	19.377		
E235			5.703	13.674

W202/70

STATION	+	HI	-	FC
---------	---	----	---	----



SOUTH FLORIDA WATER MANAGEMENT DISTRICT

Rev. 1/16

Whidden Field Notes (3 of 3)

Item	Value	Unit	Notes
WALK BASE	2235	cm/p	(0.25m)
Diack	010	cm/p	(0.1m)
	10.00		
	10.000		

[Handwritten notes on a grid notebook page]