



SOUTH FLORIDA WATER MANAGEMENT DISTRICT

Rev. 1/16

U.S.G.S. Station Name: G-2897	U.S.G.S. Station Number: 261030080083301	Agency: SFWMD	Date of Field Work: 09/25/19
Party Chief: T. AVERY	Field Book: SFWMD #1	Page(s): 50-53	Report Prepared by: DEWBERRY

SITE SPECIFIC DATA

Site Benchmark: G-2897	Benchmark Elevation(s) (NAVD88): 4.83' feet	Corpscon 6.0.1 Conversion Factor (NAVD88 to NGVD29) + 1.58 feet
Well Reference Elevation (NAVD88): 4.75'	Ground Elevation (NAVD88): 5.0'	Pad Elevation (NAVD88): N/A

GEOGRAPHIC DATA

Section 15	Township 49 SOUTH	Range 42 EAST
Well Latitude: 26°10'31.91"N	Well Longitude: 80°08'33.02"W	Location Source: AVERAGED FPRN & TRIMBLE VRSNOW RTK
State Plane Coordinates:	Northing (Y) = 670417.'	Easting (X) = 937398'

Notes: NAVD88 – North American Vertical Datum of 1988; NGVD29- National Geodetic Vertical Datum of 1929; Corpscon 6.0.1 - A U.S. Army Corps of Engineers Engineering Research and Development Center Topographic Engineering Center Alexandria, Virginia Windows-based program to convert coordinates and elevations between datum's using vertcon05.txt and vertcon05.05 files supplied by the U.S. Army Corps of Engineers South Atlantic Division, Jacksonville FL.

PICTURES

Benchmark "G-2897"
Latitude: 26°10'31.9"
Longitude: 80°08'32.9"
NAVD88 EL = 4.83 FEET

Not to scale (GoogleEarth product)



Well Site and Well Head



Well: 6½" PVC
 Reference Point: N edge of PVC casing at black mark
 Reference Point El. = **4.75 feet NAVD88**
 Distance to water = -4.87 feet from reference point (09/25/19 at 1:17 PM)



SOUTH FLORIDA WATER MANAGEMENT DISTRICT

Rev. 1/16

New Aluminum Tag





SOUTH FLORIDA WATER MANAGEMENT DISTRICT

Rev. 1/16

USGS RMs

NOTE: THERE ARE NO USGS REFERENCE MONUMENTS IN THE VICINITY OF WELL G-2897.



SOUTH FLORIDA WATER MANAGEMENT DISTRICT

Rev. 1/16

Site Benchmark



Site BM: G2897



Latitude: 26°10'31.9"
Longitude: 80°08'32.9"
NAVD88 EL = 4.83 FEET



SOUTH FLORIDA WATER MANAGEMENT DISTRICT

Rev. 1/16

Source Benchmarks



NGS Benchmark "T 664" (DL2190)



Latitude: 26°10'25.9"
Longitude: 80°08'49.0"
NAVD88 EL = 3.34 FEET



NGS Benchmark "S 664" (DL2189)



Latitude: 26°10'25.7"
Longitude: 80°09'50.8"
NAVD88 EL = 3.05 FEET



South Florida Water Management District Benchmark Datasheet

Designation: G-2897	Project Name: USGS Ph 2, BROWARD	Type: V	State Plane Zone: FL East
Stamping: G2897 2019	Field Book Name: W212	Field Book Page: 26 & 66	
Established By: DEWBERRY / WHIDDEN	Recovered By: N/A	Recovery Date: N/A	
Surveyor: WILLIAM D. DONLEY	Established Date: 9/25/2019 & 11/25/19	Status: New	

GEOGRAPHIC POSITION INFORMATION

Section: 15	Township: 49 SOUTH	Range: 42 EAST
County: BROWARD	Quadrangle: FORT LAUDERDALE NORTH	Quad Index: 1802
NAD83 Adj. Year: 2011	Vertical Datum: NAVD1988	Horizontal Datum: NAD1983
NAVD88 Elevation (feet): 4.83	NGVD29 Elevation (feet): 6.408	2022 Elevation: N/A
NAVD88 Class: N/A	NGVD29 Class: N/A	Other Elevation: N/A
NAVD88 Order: 3	NGVD29 Order: N/A	Other Elevation Type: N/A
		NGS Source BM(s): T 644
		NGS PID(s): DL2190
		NGS NAVD88 Elev (ft): 3.34
		NGS NAVD88 Elev (m): 1.019
		NGS 2022 Elev (ft): N/A

CORPSCON 6.0.1 CONVERSION FACTOR (NAVD88 TO NGVD29): (A U.S. Army Corps of Engineers Engineering Research and Development Center Topographic Engineering Center Alexandria, Virginia Windows-based program to convert coordinates and elevations between datum's using vertcon05.txt and vertcon05.05 files supplied by the U.S. Army Corps of Engineers South Atlantic Division, Jacksonville FL)

Vertical Datum Offset: + 1.58	Actual NGS Elevation or ngvd29.txt file: N/A	OPUS Ortho Height: N/A
Northing (Y) (feet): 670418.9	Easting (X) (feet): 937412.5	Source of Latitude & Longitude: AVERAGED FPRN & TRIMBLE VRSNOW RTK
Latitude: 26	10	80
DD°	MM'	SS"
Longitude: 8	32.86	32.86
DD°	MM'	SS"
Latitude (Decimal Degrees): 26.175536	Longitude (Decimal Degrees): -80.142461	

RECOVERY DATA

- How to Reach:
1. FROM I-95, TAKE EXIT 31A TO MERGE ONTO FL-816 E/W OAKLAND PARK BLVD AND HEAD EASTERLY FOR 0.3 MILES
 2. TURN LEFT ONTO NW 9TH AVE/POWERLINE RD, CONTINUE 0.5 MI
 3. TURN RIGHT ONTO NW 38TH ST, CONTINUE 0.7 MI
 4. TURN LEFT ONTO NE 3RD AVE
 5. CONTINUE NORTHERLY FOR 530 FEET TO THE MARK ON THE RIGHT

Description/Notes: **2" ALUMINUM SFWMD DISK SET IN A POURED IN PLACE CONCRETE MONUMENT**

Notable Landmarks: **WIMBERLY ATHLETIC COMPLEX, HOCKEY RINK**

Other Source Benchmarks: **NGS "S 664" (DL2189)**

PICTURES

Aerial View of Overall Site

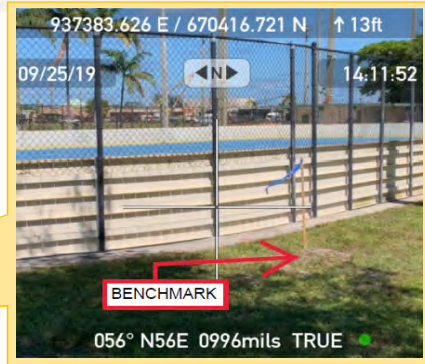
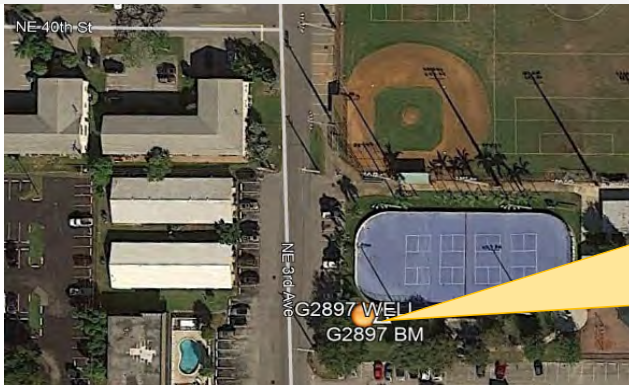

NOT TO SCALE. AERIAL FROM GOOGLE EARTH.

PICTURES

Site Sketch

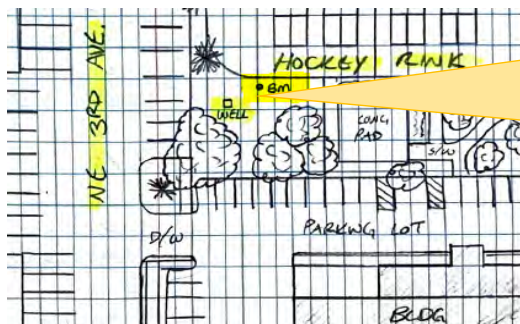



"T 664" Benchmark Datasheet (1 of 2)

The NGS Data Sheet

See file [dsdata.pdf](#) for more information about the datasheet.

PROGRAM = datasheet95, VERSION = 8.12.5.2

1 National Geodetic Survey, Retrieval Date = MAY 20, 2019

DL2190 *****

DL2190 DESIGNATION - T 664

DL2190 PID - DL2190

DL2190 STATE/COUNTY- FL/BROWARD

DL2190 COUNTRY - US

DL2190 USGS QUAD - FORT LAUDERDALE NORTH (1995)

DL2190

DL2190 *CURRENT SURVEY CONTROL

DL2190

DL2190* NAD 83(1986) POSITION- 26 10 26. (N) 080 08 49. (W) SCALED

DL2190* [NAVD 88](#) ORTHO HEIGHT - 1.019 (meters) 3.34 (feet) ADJUSTED

DL2190

DL2190 GEOID HEIGHT - -25.699 (meters) GEOID12B

DL2190 DYNAMIC HEIGHT - 1.017 (meters) 3.34 (feet) COMP

DL2190 MODELED GRAVITY - 979,064.1 (mgal) NAVD 88

DL2190

DL2190 VERT ORDER - FIRST CLASS II

DL2190

DL2190.The horizontal coordinates were scaled from a topographic map and have DL2190.an estimated accuracy of +/- 6 seconds.

DL2190.

DL2190.The orthometric height was determined by differential leveling and DL2190.adjusted by the NATIONAL GEODETIC SURVEY

DL2190.in June 2009.

DL2190

DL2190.Significant digits in the geoid height do not necessarily reflect accuracy.

DL2190.GEOID12B height accuracy estimate available [here](#).

DL2190

DL2190.[Photographs](#) are available for this station.

DL2190

DL2190.The dynamic height is computed by dividing the NAVD 88

DL2190.geopotential number by the normal gravity value computed on the

DL2190.Geodetic Reference System of 1980 (GRS 80) ellipsoid at 45

DL2190.degrees latitude (g = 980.6199 gals.).

DL2190

DL2190.The modeled gravity was interpolated from observed gravity values.

DL2190

DL2190; North East Units Estimated Accuracy

DL2190;SPC FL E - 204,160. 285,280. MT (+/- 180 meters Scaled)

DL2190

DL2190_U.S. NATIONAL GRID SPATIAL ADDRESS: 17RNJ852952(NAD 83)

DL2190

DL2190 SUPERSEDED SURVEY CONTROL

DL2190

DL2190.No superseded survey control is available for this station.

DL2190

DL2190_MARKER: F = FLANGE-ENCASED ROD

DL2190_SETTING: 49 = STAINLESS STEEL ROD W/O SLEEVE (10 FT.+)

DL2190_STAMPING: T 664 2006

DL2190_MARK LOGO: NGS

DL2190_PROJECTION: FLUSH

DL2190_MAGNETIC: M = MARKER EQUIPPED WITH BAR MAGNET

DL2190_STABILITY: B = PROBABLY HOLD POSITION/ELEVATION WELL

DL2190_SATELLITE: THE SITE LOCATION WAS REPORTED AS SUITABLE FOR



SOUTH FLORIDA WATER MANAGEMENT DISTRICT

Rev. 1/16

"T 664" Benchmark Datasheet (2 of 2)

DL2190+SATELLITE: SATELLITE OBSERVATIONS - August 02, 2006

DL2190_ROD/PIPE-DEPTH: 12.5 meters

DL2190

DL2190	HISTORY	- Date	Condition	Report By
--------	---------	--------	-----------	-----------

DL2190	HISTORY	- 20060802	MONUMENTED	FLDEP
--------	---------	------------	------------	-------

DL2190

STATION DESCRIPTION

DL2190

DL2190'DESCRIBED BY FL DEPT OF ENV PRO 2006 (JLM)

DL2190'THE MARK IS IN OAKLAND PARK, IN SECTION 22, TOWNSHIP 49 SOUTH, RANGE

DL2190'42 EAST.

DL2190'

DL2190'TO REACH THE MARK FROM THE INTERSECTION OF INTERSTATE 95 (EXIT 31) AND

DL2190'OAKLAND PARK BOULEVARD (STATE HIGHWAY 816) IN OAKLAND PARK, GO EAST

DL2190'ON OAKLAND PARK BOULEVARD (STATE HIGHWAY 816) FOR 0.8 MI TO THE

DL2190'INTERSECTION OF ANDREWS AVENUE, (COUNTY ROAD 811A), TURN LEFT ON

DL2190'ANDREWS AVENUE (COUNTY ROAD 811A) AND GO NORTH FOR 0.5 MI TO THE

DL2190'INTERSECTION OF NORTHWEST 38TH STREET AND THE MARK ON THE LEFT, A

DL2190'STAINLESS STEEL ROD DRIVEN TO REFUSAL AT A DEPTH OF 40.9 FT WITH A

DL2190'NGS LOGO CAP FLUSH WITH THE GROUND AND ABOUT 0.6 FT ABOVE THE LEVEL

DL2190'OF 38TH STREET, THE DATUM POINT IS RECESSED 0.7 FT BELOW THE LEVEL OF

DL2190'THE NGS LOGO CAP.

DL2190'

DL2190'LOCATED 59.0 FT WEST OF THE WEST EDGE OF THE PAVEMENT OF ANDREWS

DL2190'AVENUE, 20.5 FT WEST OF A WOODEN GUY POLE WITH TWO GUY WIRES

DL2190'ATTACHED, 20.0 FT WEST-NORTHWEST OF A CONCRETE POWER POLE, 11.5 FT

DL2190'WEST OF THE APPROXIMATE CENTERLINE OF THE EASTBOUND LANES OF

DL2190'NORTHWEST 38TH STREET AND 1.0 FT NORTH OF THE NORTH EDGE OF THE

DL2190'SIDEWALK.

DL2190'

DL2190'NOTE A MAGNET WAS PLACED INSIDE OF THE NGS LOGO CAP.

DL2190'

DL2190'NOTE ACCESS TO THE DATUM POINT IS HAD THROUGH A 5-INCH NGS LOGO CAP.

*** retrieval complete.

Elapsed Time = 00:00:04



SOUTH FLORIDA WATER MANAGEMENT DISTRICT

Rev. 1/16

"S 664" Benchmark Datasheet (1 of 2)

The NGS Data Sheet

See file [dsdata.pdf](#) for more information about the datasheet.

```

PROGRAM = datasheet95, VERSION = 8.12.5.4
1      National Geodetic Survey,  Retrieval Date = NOVEMBER 26, 2019
DL2189 *****
DL2189 DESIGNATION - S 664
DL2189 PID - DL2189
DL2189 STATE/COUNTY- FL/BROWARD
DL2189 COUNTRY - US
DL2189 USGS QUAD - FORT LAUDERDALE NORTH (1995)
DL2189
DL2189 *CURRENT SURVEY CONTROL
DL2189
DL2189* NAD 83(1986) POSITION- 26 10 26. (N) 080 09 50. (W) SCALED
DL2189* NAVD 88 ORTHO HEIGHT - 0.930 (meters) 3.05 (feet) ADJUSTED
DL2189
DL2189 GEOID HEIGHT - -25.642 (meters) GEOID18
DL2189 DYNAMIC HEIGHT - 0.928 (meters) 3.04 (feet) COMP
DL2189 MODELED GRAVITY - 979,064.3 (mgal) NAVD 88
DL2189
DL2189 VERT ORDER - FIRST CLASS II
DL2189
DL2189.The horizontal coordinates were scaled from a map and have
DL2189.an estimated accuracy of +/- 6 seconds.
DL2189.
DL2189.The orthometric height was determined by differential leveling and
DL2189.adjusted by the NATIONAL GEODETIC SURVEY
DL2189.in June 2009.
DL2189
DL2189.Significant digits in the geoid height do not necessarily reflect accuracy.
DL2189.GEOID18 height accuracy estimate available here.
DL2189
DL2189.Click here to see if photographs exist for this station.
DL2189
DL2189.The dynamic height is computed by dividing the NAVD 88
DL2189.geopotential number by the normal gravity value computed on the
DL2189.Geodetic Reference System of 1980 (GRS 80) ellipsoid at 45
DL2189.degrees latitude (g = 980.6199 gals.).
DL2189
DL2189.The modeled gravity was interpolated from observed gravity values.
DL2189
DL2189; North East Units Estimated Accuracy
DL2189;SPC FL E - 204,150. 283,580. MT (+/- 180 meters Scaled)
DL2189
DL2189_U.S. NATIONAL GRID SPATIAL ADDRESS: 17RNJ835952 (NAD 83)
DL2189
DL2189 SUPERSEDED SURVEY CONTROL
DL2189
DL2189.No superseded survey control is available for this station.
DL2189
DL2189_MARKER: F = FLANGE-ENCASED ROD
DL2189_SETTING: 49 = STAINLESS STEEL ROD W/O SLEEVE (10 FT.+)
DL2189_STAMPING: S 664 2006

```



SOUTH FLORIDA WATER MANAGEMENT DISTRICT

Rev. 1/16

"S 664" Benchmark Datasheet (2 of 2)

DL2189_MARK LOGO: NGS
DL2189_PROJECTION: RECESSED 3 CENTIMETERS
DL2189_MAGNETIC: M = MARKER EQUIPPED WITH BAR MAGNET
DL2189_STABILITY: B = PROBABLY HOLD POSITION/ELEVATION WELL
DL2189_SATELLITE: THE SITE LOCATION WAS REPORTED AS SUITABLE FOR
DL2189+SATELLITE: SATELLITE OBSERVATIONS - August 02, 2006
DL2189_ROD/PIPE-DEPTH: 5.8 meters
DL2189
DL2189 HISTORY - Date Condition Report By
DL2189 HISTORY - 20060802 MONUMENTED FLDEP
DL2189
DL2189 STATION DESCRIPTION
DL2189
DL2189'DESCRIBED BY FL DEPT OF ENV PRO 2006 (JLM)
DL2189'THE MARK IS IN OAKLAND PARK, IN SECTION 21, TOWNSHIP 49 SOUTH, RANGE
DL2189'42 EAST.
DL2189'
DL2189'TO REACH THE MARK FROM THE INTERSECTION OF INTERSTATE 95 (EXIT 31) AND
DL2189'OAKLAND PARK BOULEVARD (STATE HIGHWAY 816) IN OAKLAND PARK, GO EAST
DL2189'ON OAKLAND PARK BOULEVARD (STATE HIGHWAY 816) FOR 0.3 MI TO THE
DL2189'JUNCTION OF POWERLINE ROAD (COUNTY ROAD 45) ON THE LEFT, TURN LEFT ON
DL2189'POWERLINE ROAD (COUNTY ROAD 845) AND GO NORTH FOR 0.5 MI TO THE
DL2189'INTERSECTION OF NORTHWEST 38TH STREET, TURN LEFT ON NORTHWEST 38TH
DL2189'STREET AND GO WEST FOR 0.5 MI TO THE ENTRANCE TO ROYAL PALM PARK ON
DL2189'THE RIGHT AND THE MARK ON THE RIGHT, A STAINLESS STEEL ROD DRIVEN TO
DL2189'REFUSAL AT A DEPTH OF 19.0 FT WITH A NGS LOGO CAP RECESSED 0.1 FT
DL2189'BELOW THE LEVEL OF THE GROUND AND ABOUT LEVEL WITH NORTHWEST 38TH
DL2189'STREET, THE DATUM POINT IS RECESSED 0.4 FT BELOW THE LEVEL OF THE NGS
DL2189'LOGO CAP.
DL2189'
DL2189'LOCATED 40.0 FT NORTH OF THE CENTERLINE OF NORTHWEST 38TH STREET, 20.5
DL2189'FT WEST OF THE APPROXIMATE CENTERLINE OF THE ENTRANCE TO ROYAL PALM
DL2189'PARK, 13.0 FT NORTH OF THE NORTH EDGE OF THE SIDEWALK, 9.0 FT SOUTH
DL2189'OF THE SOUTHEAST CORNER OF THE PARKING LOT, 4.5 FT EAST OF THE MOST
DL2189'NORTHEAST PALM TREE OF A SET OF FOUR PALM TREES AND 2.3 FT WEST OF THE
DL2189'WEST ENTRANCE GATE POST.
DL2189'
DL2189'NOTE A MAGNET WAS PLACED INSIDE OF THE NGS LOGO CAP.
DL2189'
DL2189'NOTE ACCESS TO THE DATUM POINT IS HAD THROUGH A 5-INCH NGS LOGO CAP.

*** retrieval complete.
Elapsed Time = 00:00:01



SOUTH FLORIDA WATER MANAGEMENT DISTRICT

Rev. 1/16

Dewberry Field Notes (1 of 4)

SPECTRA SPAD SFWM.D 09/25/19
 Rover S/N: USGS WELLS & Bms
 Trimble NET Job # 50099999
 Trimble HI: 6.562 Well SITE: G-2897

TASK: OBTAIN HORIZONTAL LOCATIONS OF MONITORING POINT & ALL REFERENCE MONUMENTATION

STATION AS

PT#	(N) ELEV	(E) ELEV	(Z) ELEV	PT#	DESCRIPTION
5/0	16	-0.071	0.088	C.001	

*LOCATED PT# 12037

5/0	16	-0.069	0.093	F.047	
-----	----	--------	-------	-------	--

PT#	DESCRIPTION
12037	MP @ TOP OF PVC CASING

TASK: MEASURE & RECORD DISTANCE FROM MONITORING POINT TO WATER LINE.

MEASUREMENT: 4.81'; AS MEASURED FROM BLACK SHARPIE MARK ON NORTH EDGE OF PVC CASING (6"±)

THIS WELL SITE IS LOCATED IN A CONCRETE 'IN-GROUND' or 'BELOW GRADE' ENCLOSURE IN A GRASS AREA TO THE SOUTH WEST OF A COMMUNITY OUTDOOR HOCKEY RINK, JUST OFF THE EASTERLY R/W OF NE 3RD AVENUE.

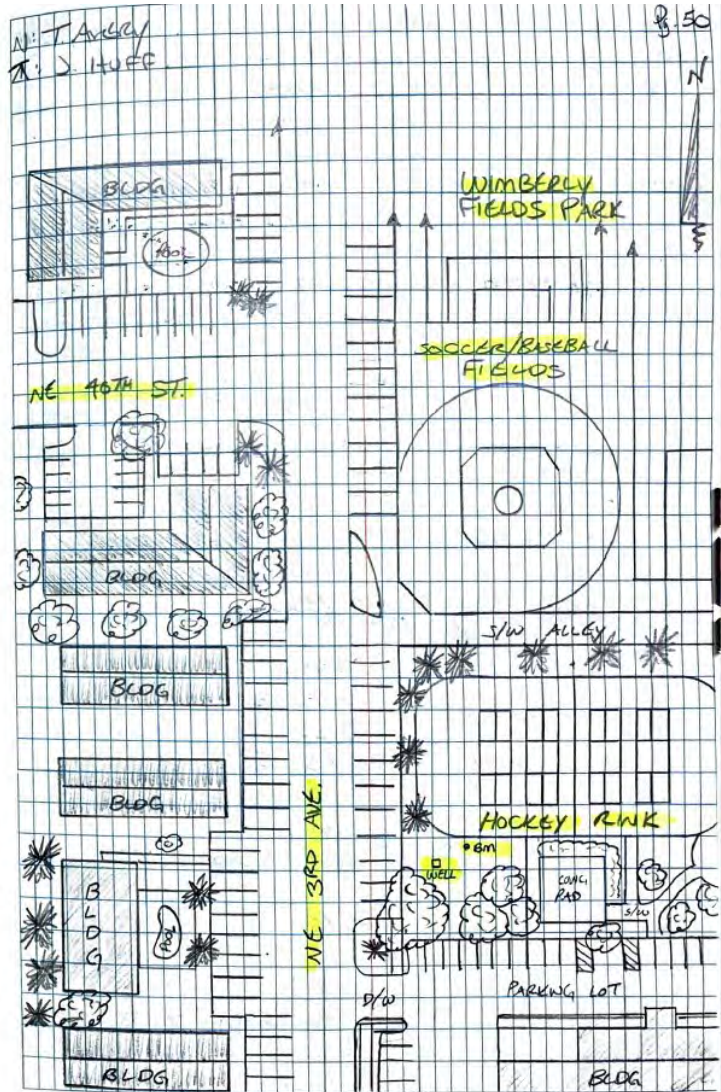



SOUTH FLORIDA WATER MANAGEMENT DISTRICT

Rev. 1/16

Dewberry Field Notes (2 of 4)

Tolson S.F.W.M.D. 09/25/19
 AT-62 USGS WELS E Bms
 \$/N: 1439 JOB #: 5009 9449
 WELL SITE: G-2897

TASK: ELEVATE MONITORING POINT, REFERENCE MONUMENTATION, & GROUND LEVEL @ WELL SITE

ELEVATION	DESCRIPTION
BGN @ 100.00 4.83	ALUMINUM DISC IN CAST CONC STAMPED, "SFWMD SURVEY"

(WHIDDEN/NAV D 88)

BACKSIGHT (+)	ADJ.	FORESIGHT (-)	ADJ.				
STA ID	RD=	MEAN	ELEV.	RD=	MEAN	ELEV.	ELEV.
			100.00				

		3.65			3.50		
B.M.	3.515	3.515	105.5150	3.365	3.3667	100.1405	4.979
		3.38		8.345	3.235		
		27'/27"			26 5'/53.5'		

"	"			3.51			
				3.38	3.380	100.1350	4.965
				3.25			
					26'/53"		

"	"			3.51			
				3.39	3.390	100.1350	4.955
				3.27			
					24'/51"		

"	"			3.505			
				3.38	3.3817	100.1350	4.963
				3.26			
					29.5'/51.5'		

N. T. AVERY
 A. J. HOFF

⊙ GRADE, JUST TO THE EAST OF WELL ENCLOSURE MARKER "G-2897 2019"

FORESIGHT (-)
 DESCRIPTION

NW CORNER OF CONCRETE WELL CASING ENCLOSURE

NE CORNER OF CONCRETE WELL CASING ENCLOSURE

SE CORNER OF CONCRETE WELL CASING ENCLOSURE

SW CORNER OF CONCRETE WELL CASING ENCLOSURE



SOUTH FLORIDA WATER MANAGEMENT DISTRICT

Rev. 1/16

Dewberry Field Notes (3 of 4)

Tellus S.F.W.M.D 9/25/19
 AT-G2 USGS WELLS E. BMS
 S/N: 1434 JOB #: S0009949
 WELL SITE: G-2897

TASK: CONTINUOUS ELEVATING POINTS OF INTEREST

BACKSIGHT (+)		FORESIGHT (-)		ASMP	ADS
STA ID	RDS	MEAN ELEV	RDS	MEAN ELEV	ELEV.

Bm			3.50		
		109.9156	3.365	3.3667	100.0000 4.979
		8.345	3.235		
			26.5' / 59.5'		

"	"	"	3.725		
			3.60	3.5983	99.7167 4.747
			3.47		
			25.5' / 52.5'		

* BREAK SET-UP

	3.54		3.465		
MP	3.415	3.4150	109.9317	3.33	3.3300 100.0017 4.832
	3.22		8.162	3.195	
	25' / 11.5'		27' / 10.5'		

* END LEVEL LOOP

N: T. AVERY
 T: J. HOFFE

8.52

FORESIGHT (-)
 DESCRIPTION

GROUND SHOT, N. OF WELL CASING ENCLOSURE

MEASURING POINT (NORTH EDGE OF PUC CASING)
 (MARKED W/ BLACK STAKE)

BACK @ STARTING POINT (SITE Bm)

CHECK IN = 0.002'



SOUTH FLORIDA WATER MANAGEMENT DISTRICT

Rev. 1/16

Dewberry Field Notes (4 of 4)

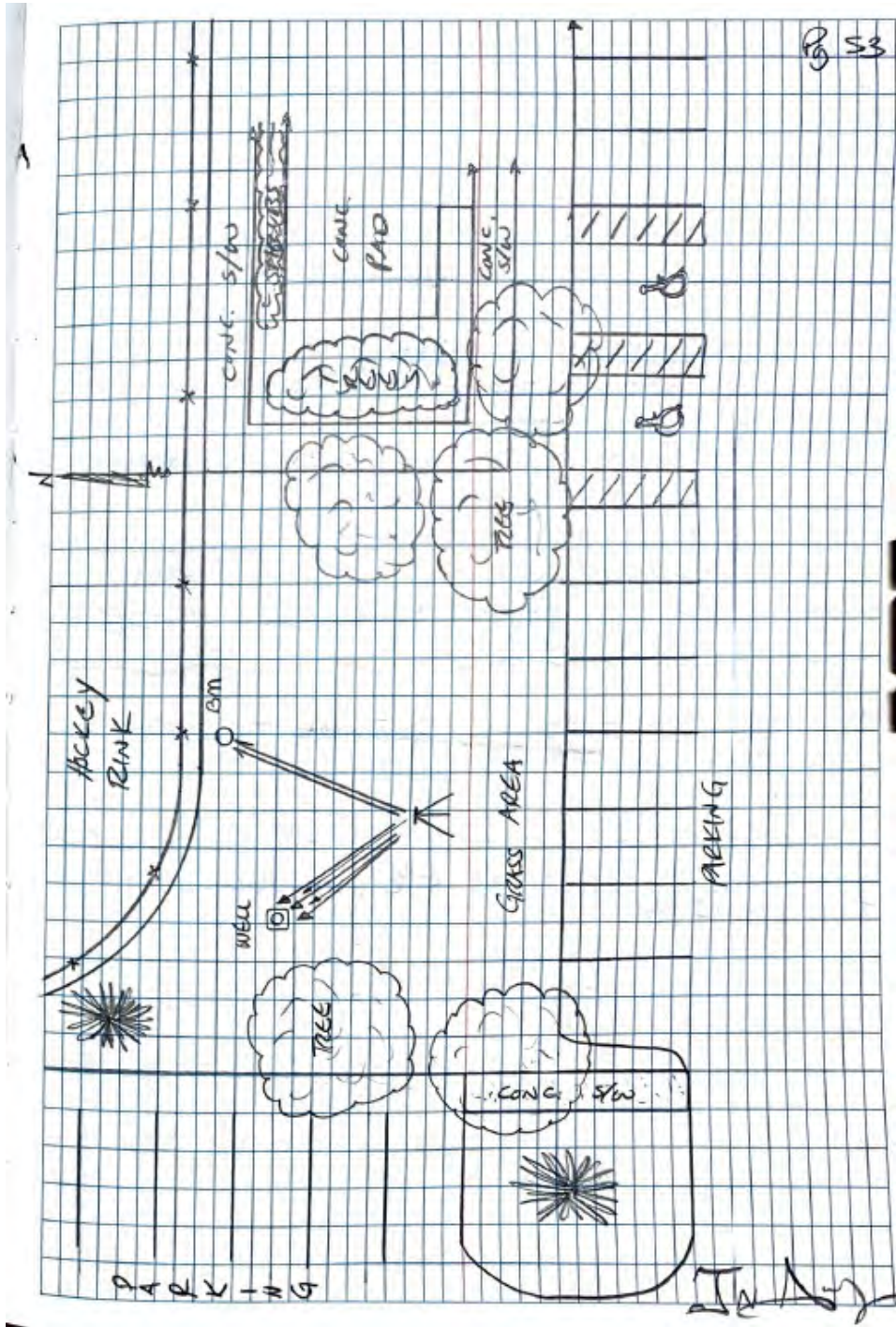



SOUTH FLORIDA WATER MANAGEMENT DISTRICT

Rev. 1/16

Whidden Field Notes (1 of 2)

STA	E	HI	-	RL	
					62897
TSU 4				3.34	(SSR)
TP 1	6.10	9.50		4.396	5.035
	4.455	9.49			
TP 2				4.098	4.492
	5.213	10.16			
TP 3				5.262	5.123
	5.277	10.12			
TP 4				6.277	4.115
	5.407	9.86			
TP 5				5.29	4.281
	6.512	10.778			
62897				5.96	4.84 (TP 6)
	5.60	7.84			
TP 7				5.63	4.21
	5.52	9.78			
TP 8				4.92	4.60
	6.40	10.21			
TP 9				5.86	4.85
	6.05	10.40			
TP 10				5.84	4.72
	4.81	9.52			
TP 11				5.90	3.56

STA	E	HI	-	RL	
					09/26/19
					DW JR BN
					W. R. 1/26
7614				6.284	3.246 (SSR)
Dini S.N.# 73564Z TRIMBLE RB-3 4615113539 TRIMBLE RL-4 022026650A					



SOUTH FLORIDA WATER MANAGEMENT DISTRICT

Rev. 1/16

Whidden Field Notes (2 of 2)

02897-112819

11/11/85	2	5004	5576	"5004" (2M)
766400	2	7664	5572	"7664" (2M)

V. 0.073

02
NO
8M

6/22/66



SOUTH FLORIDA WATER MANAGEMENT DISTRICT

Rev. 1/16