

L2 GW

~~CLEWISTON~~.gen

Identifi cation\_Inf ormati on:

Ci tati on:

Ci tati on\_Inf ormati on:

Origi nator: Robert J. Bi lls(comp.)

Origi nator: U. S. Army Engi neer Di strict, Jacks onvi lle (ed.)

Publ i cati on\_ Date: Unpubl i shed materi al

Publ i cati on\_ Ti me: Unknown

Titl e: S. F. W. M. D. CLEWISTON DEEP WATER INJECTI ON WELL

Edi ti on: 1

Seri es\_Inf ormati on:

Publ i cati on\_Inf ormati on:

Publ i cati on\_ Pl ace: Not publ i shed

Publ i sher: None

Onl i ne\_ Li nkage: bbi lls@cte. cc

Larg er\_ Work\_ Ci tati on:

Ci tati on\_Inf ormati on:

Seri es\_Inf ormati on:

Publ i cati on\_Inf ormati on:

Descr i pti on:

Abstr act:

South Flori da Water Management Di strict  
CLEWISTON DEEP WATER INJECTI ON WELL

**Purpose**

Purpos e:

To establ i sh NAVD 88 and NVGD 29 el evati ons on the  
well and on the well reference benchmark.

**Survey Date**

Time\_ Peri od\_ of\_ Content:

Time\_ Peri od\_ Inf ormati on:

Si ngl e\_ Date/ Ti me:

Cal endar\_ Date: 20050125

Time\_ of\_ Day: 17000000

Range\_ of\_ Dates/ Ti mes:

Mul ti pl e\_ Dates/ Ti mes:

Currentness\_ Reference: Date and time of fi el d work

Status:

Progress: Complete

Mai ntenance\_ and\_ Update\_ Frequency: Unknown

Spati al\_ Domai n:

Boundi ng\_ Coordi nates:

West\_ Boundi ng\_ Coordi nate: -080° 56' 58. 39"

East\_ Boundi ng\_ Coordi nate: -080° 56' 58. 39"

North\_ Boundi ng\_ Coordi nate: +26° 36' 29. 70"

South\_ Boundi ng\_ Coordi nate: +26° 36' 29. 70"

Keywords:

Theme:

Theme\_ Keyword\_ Thesauru s: None

Theme\_ Keyword: Record Survey

Theme\_ Keyword: Well Si te

Pl ace:

Pl ace\_ Keyword\_ Thesauru s: None

Pl ace\_ Keyword: S. F. W. M. D. CLEWISTON DEEP WATER INJECTI ON

WELL

Pl ace\_ Keyword: Sec. 33, Twp. 44 S. , Rge 34 E.

Pl ace\_ Keyword: Hendry County, Flori da

Pl ace\_ Keyword\_ Thesauru s: Geographi c Names Inf ormati on System

Pl ace\_ Keyword: Flori da

Pl ace\_ Keyword: Hendry County

Stratum:

Tempor al :

Access\_ Constrai nts: None

Use\_ Constrai nts: None

Poi nt\_ of\_ Contact:

Contact\_ Inf ormati on:

Contact\_ Person\_ Pri mary:

Page 1

**Elvie Ebanks**  
**SFWMD**

District

CLEWISTON.gen  
Contact\_Person: Elvia Ebanks  
Contact\_Organization: South Florida Water Management

Contact\_Organization\_Primary:  
Contact\_Address:  
Address\_Type: mailing and physical address  
Address: 3301 Gun Club Road  
City: West Palm Beach  
State\_or\_Province: Florida  
Postal\_Code: 33406-4680  
Country: USA  
Contact\_Voice\_Telephone: (561) 753 2400 ex 4717  
Hours\_of\_Service: 8:00 am to 5:00 pm EST

Security\_Information:  
Cross\_Reference:

Citation\_Information:  
Series\_Information:  
Publication\_Information:

Data\_Quality\_Information:  
Attribute\_Accuracy:

**Equipment Used**

Attribute\_Accuracy\_Report:  
This survey was prepared using GPS and Leveling instruments. The horizontal location of the benchmark was performed using GPS. The vertical data was collected using a Topcon DL 102 Level. Coordinates are based on the Florida State Plane Coordinate System, East Zone, NAD 83/90. Elevations are based on NAVD 88.

Logical\_Consistency\_Report:  
Horizontal data was established using sub-meter GPS equipment. Vertical data was established using control points HEN 27 and HEN 28. Coordinates are based on the Florida State Plane Coordinate System, East Zone, NAD 83/90. Elevations are based on NAVD 88.

Completeness\_Report:  
Horizontal location taken at the benchmark.

**Project Results**

Lat. +26°36'29.70"  
Long. -080°56'58.39"  
N 826775'  
E 672649'  
Site Benchmark.  
INJ BM 06 is a standard U.S. Army Corps of Engineers brass disc, bearing INJ BM 06 2004 JAX DIST SFWMD, set in a 10" round concrete monument (poured in place, with a magnet placed nearby).  
To reach from the junction of U.S. Highway 27 and County Road 835 on the south side of Clewiston; go West on County Road 835, for 6.7 miles, to the junction of Rogers road on the left and a curve to the right; bear right and continue West on County Road 835 for 0.95 miles, to the junction of Blumberg Road on the left; continue west on County Road 835, for 1.9 miles to the junction of Levee Road L-1 on the left, the east end of bridge number 070034 and the junction of Levee L-1 on the right (on the east side of the canal); turn left on Levee L-1 and go south for 1.0 mile to a turnout on the left and Benchmark HEN 28; continue south 300 feet, BM INJ BM 06, is on the left inside a 4 foot barbed wire gate and is 50 feet more or less northwest of the injection well.  
United States Department of the Interior Geologic Survey  
Quadrangle map -- LAKE HARBOR SW 1994

CLEWISTON.gen

Benchmark INJ BM 06 - 16.34' NAVD 88; 17.70' NGVD 29  
Brass disk in concrete of injection well - 17.05' NAVD 88  
(17.05 stamped on disk); 18.41' NGVD 29

Positional\_Accuracy:

**Horizontal**

Horizontal\_Positional\_Accuracy:

Horizontal\_Positional\_Accuracy\_Report:

The horizontal position of the benchmark INJ BM 06, was established using a differential, submeter, wide area augmentation system, GPS, using Coast

Guard

and FAA beacons for corrected positioning (Trimble Geoplotter CE with Beacon on a Belt) in accordance with the Florida Minimum Technical Standards

(Chapter

61G17-6).

Quantitative\_Horizontal\_Positional\_Accuracy\_Assessment:

Horizontal\_Positional\_Accuracy\_Value: 1 meter

Horizontal\_Positional\_Accuracy\_Explanation: The

intended positional accuracy for this survey is 1 meter.

Vertical\_Positional\_Accuracy:

**Level Line**

Vertical\_Positional\_Accuracy\_Report:

A level line was run originating on BM "HEN 27" with

an

NAVD 88 elevation, running through BM "INJ BM 06"

and

a brass disk in the concrete base of the injection

well and

terminating on BM "HEN 28", in accordance with

Florida

Minimum Technical Standards (Chapter 61G17-6).

The level line was also readjusted using the values

from

the NGS NGVD 29 adjustment of the CERP vertical network.

Quantitative\_Vertical\_Positional\_Accuracy\_Assessment:

Vertical\_Positional\_Accuracy\_Value: +0.015 meter

Vertical\_Positional\_Accuracy\_Explanation: NAVD 88

level run, 0.015 meter closure in 1311 meters, max. allowed 0.017 meter (MTS)

Li neage:

Source\_Information:

Source\_Citation:

Citation\_Information:

Series\_Information:

Publication\_Information:

Larger\_Work\_Citation:

Citation\_Information:

Series\_Information:

Publication\_Information:

Source\_Time\_Period\_of\_Content:

Time\_Period\_Information:

Single\_Date/Time:

Range\_of\_Dates/Times:

Multiple\_Dates/Times:

Process\_Step:

Process\_Description:

The horizontal work was performed using Trimble Geoplotter CE with Beacon on a Belt GPS.

The level line was performed using a Topcon DL 102

level.

Three wire methodology was used.

Process\_Date: 20050125

Process\_Time: 17000000

Process\_Contact:

- CLEWISTON.gen
- Contact\_Information:
  - Contact\_Person\_Primary:
  - Contact\_Organization\_Primary:
  - Contact\_Address:
- Spatial\_Data\_Organization\_Information:
  - Spatial\_Reference\_Information:
    - Horizontal\_Coordinate\_System\_Definition:
      - Geographic:
        - Planar:
          - Map\_Projection:
            - Albers\_Conical\_Equal\_Area:
            - Azimuthal\_Equidistant:
            - Equidistant\_Conic:
            - Equiangular:
            - General\_Vertically\_Near-sited\_Perspective:
            - Gnomonic:
            - Lambert\_Azimuthal\_Equal\_Area:
            - Lambert\_Conformal\_Conic:
            - Mercator:
            - Modified\_Stereographic\_for\_Alaska:
            - Miller\_Cylindrical:
            - Oblique\_Mercator:
              - Oblique\_Linear\_Point:
            - Orthographic:
            - Polar\_Stereographic:
            - Polyconic:
            - Robinson:
            - Sinusoidal:
            - van\_der\_Grinten:
            - Space\_Oblique\_Mercator\_(Landsat):
            - Stereographic:
            - Transverse\_Mercator:
            - van\_der\_Grinten:
          - Grid\_Coordinate\_System:
            - Universal\_Transverse\_Mercator:
              - Transverse\_Mercator:
            - Universal\_Polar\_Stereographic:
              - Polar\_Stereographic:
            - StatePlane\_Coordinate\_System:
              - Lambert\_Conformal\_Conic:
              - Transverse\_Mercator:
              - Oblique\_Mercator:
                - Oblique\_Linear\_Point:
              - Polyconic:
            - ARC\_Coordinate\_System:
              - Equiangular:
              - Azimuthal\_Equidistant:
        - Local\_Planar:
          - Planar\_Coordinate\_Information:
            - Coordinate\_Representation:
            - Distance\_and\_Bearing\_Representation:
      - Local:
        - Geodetic\_Model:
      - Vertical\_Coordinate\_System\_Definition:
        - Altitude\_System\_Definition:
        - Depth\_System\_Definition:
    - Entity\_and\_Attribute\_Information:
      - Detailed\_Description:
        - Entity\_Type:
          - Attribute:
            - Attribute\_Domain\_Values:
              - Attribute\_Value\_Accuracy\_Information:
      - Overview\_Description:

CLEWISTON.gen

Distributi on\_I nformati on:

Distributor:

Contact\_I nformati on:

Contact\_Person\_Pri mary:

Contact\_Organi zati on\_Pri mary:

Contact\_Address:

Standard\_Order\_Process:

Digital\_Form:

Digital\_Transfer\_I nformati on:

Digital\_Transfer\_Opti on:

Online\_Opti on:

Computer\_Contact\_I nformati on:

Network\_Address:

Dial up\_I nstructi ons:

Offline\_Opti on:

Recording\_Capaci ty:

Avai l abl e\_Ti me\_Period:

Time\_Period\_I nformati on:

Si ngl e\_Date/Ti me:

Range\_of\_Dates/Ti mes:

Mul ti pl e\_Dates/Ti mes:

Metadata\_Reference\_I nformati on:

Metadata\_Date: 20050203

\_Contact:

Contact\_I nformati on:

Contact\_Person\_Pri mary:

Contact\_Person: Joseph S. Boggs

Contact\_Organi zati on: Consul -Tech Surveyi ng &

**Joseph S. Boggs**

**Consul-Tech**

**Surveying & Mapping**

Mapping

Contact\_Organi zati on\_Pri mary:

Contact\_Positi on: Project Surveyor

Contact\_Address:

Address\_Type: maili ng and physi cal address

Address: 24831 Old 41 Road

City: Boni ta Springs

State\_or\_Provi nce: Fl ori da

Postal\_Code: 34135

Country: USA

Contact\_Voi ce\_Tel ephone: (239) 947-0266

Contact\_Faci mi l e\_Tel ephone: (239) 947-1323

Contact\_El ectroni c\_Mai l\_Address: j boggs@cte. cc

Hours\_of\_Servi ce: 8:00 am to 5:00 pm EST

Metadata\_Standard\_Name: FGDC Content Standards for Digital Geospatial

Metadata

Metadata\_Standard\_Versi on: FGDC-STD-001-1998

Metadata\_Ti me\_Conventi on: Local time

Metadata\_Securi ty\_I nformati on:

# S.F.W.M.D. Injection Well – Clewiston



Consul-Tech Surveying & Mapping, Inc.

Date of Survey: January 25, 2005

Looking: Southwest from BM

# S.F.W.M.D. Injection Well – Clewiston



Consul-Tech Surveying & Mapping, Inc.

Date of Survey: January 25, 2005

Looking: Southeast From BM

# S.F.W.M.D. Injection Well – Clewiston



Consul-Tech Surveying & Mapping, Inc.

Date of Survey: January 25, 2005

Looking: North



# S.F.W.M.D. Injection Well – Clewiston



Consul-Tech Surveying & Mapping, Inc.

Date of Survey: January 25, 2005

Looking: At "INJ BM 06 2005"

# S.F.W.M.D. Injection Well – Clewiston



Consul-Tech Surveying & Mapping, Inc.

Date of Survey: January 25, 2005

Looking: At Brass Disk At Base Of Well

Marked: "NAVD 88 EL. 17.05"



<b>COUNTY HENDRY</b>		<b>PROJECT DEEP WATER INJECTION WELL SITE</b>		<b>DESIGNATION INJ BM O6 2004</b>	
<b>SECTION 33</b>		<b>TOWNSHIP 44 SOUTH</b>		<b>RANGE 34 EAST</b>	
<b>GEOGRAPHIC INDEX OF QUAD Florida</b>					
Established by Consul-Tech Surveying and Mapping, inc.			NAME OF QUADRANGLE LAKE HARBOR SW		
SURVEYOR <u>Joseph S. Boggs</u> DATE <u>1/26/05</u>			FIELD BOOK <u>516-8</u> PAGE <u>22</u>		
HORIZONTAL DATUM: <b>83/90</b> ZONE <b>EAST</b>					
VERTICAL DATUM: NAVD 88 & NGVD 29 (Based on NGS adjustment of CERP vertical network)					
CONTROL ACCURACY: HORIZONTAL SUB-METER VERTICAL 3 <sup>rd</sup> Order					
STATE PLANE COORDINATES Feet		N=826775		E=672650	
				EL.=16.33 (NAVD 88) EL.=17.69 (NGVD 29)	
LATITUDE 26°36'29.70" N			LONGITUDE 080°56'58.39" W		
<b>DESCRIPTION</b>					
To reach from the junction of U.S. Highway 27 and County Road 835 on the south side of Clewiston; go					
West on County Road 835, for 6.7 miles, to the junction of Rogers road on the left and a curve to the right;					
bear right and continue West on County Road 835 for 0.95 miles, to the junction of Blumberg Road on the					
left; continue west on County Road 835, for 1.9 miles to the junction of Levee Road L-1 on the left, the east					
end of bridge number 070034 and the junction of Levee L-1 on the right (on the east side of the canal); turn					
left on Levee L-1 and go south for 1.0 mile to a turnout on the left and Benchmark HEN 28; continue south					
300 feet, BM INJ BM O6, is on the left inside a 4 foot barbed wire gate and is 50 feet more or less					
Northwest of the injection well.					

SKETCH

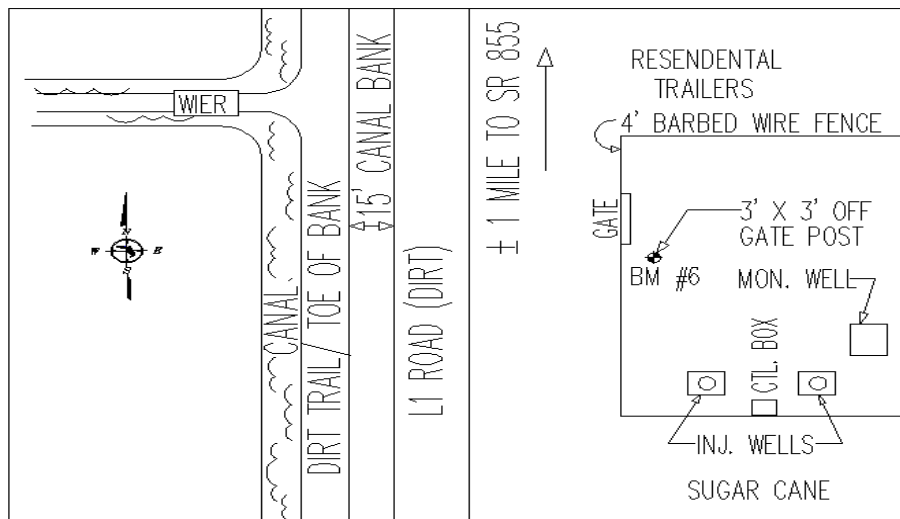



From the "ngvd29.txt" file provided by NGS for the CERP Geodetic Vertical Control Project.						
Line/Part: L26265		SSN+: mark floated, SSN*: mark constrained, SSN#: mark floated & constrained				
Mark ID	SSN	PID	Designation	Geopotential	Elevation	Codes
1897	0026	AI1525	HEN 28	8.2386	8.4067	
1898	0027	AI1524	HEN 27	7.7394	7.8973	

## The NGS Data Sheet

See file [dsdata.txt](#) for more information about the datasheet.

```

PROGRAM = datasheet95, VERSION = 8.8
1      National Geodetic Survey,  Retrieval Date = JANUARY 10, 2016
AI1524 *****
AI1524 DESIGNATION - HEN 27
AI1524 PID - AI1524
AI1524 STATE/COUNTY- FL/HENDRY
AI1524 COUNTRY - US
AI1524 USGS QUAD - LAKE HARBOR SW (1994)
AI1524
AI1524 *CURRENT SURVEY CONTROL
AI1524
AI1524* NAD 83(1986) POSITION- 26 35 42. (N) 080 56 58. (W) SCALED
AI1524* NAVD 88 ORTHO HEIGHT - 7.482 (meters) 24.55 (feet) ADJUSTED
AI1524
AI1524 GEOID HEIGHT - -24.727 (meters) GEOID12B
AI1524 DYNAMIC HEIGHT - 7.470 (meters) 24.51 (feet) COMP
AI1524 MODELED GRAVITY - 979,089.7 (mgal) NAVD 88
AI1524
AI1524 VERT ORDER - FIRST CLASS II
AI1524
AI1524.The horizontal coordinates were scaled from a topographic map and have
AI1524.an estimated accuracy of +/- 6 seconds.
AI1524.
AI1524.The orthometric height was determined by differential leveling and
AI1524.adjusted by the NATIONAL GEODETIC SURVEY
AI1524.in October 1999.
AI1524
AI1524.Significant digits in the geoid height do not necessarily reflect accuracy.
AI1524.GEOID12B height accuracy estimate available here.
AI1524
AI1524.The dynamic height is computed by dividing the NAVD 88
AI1524.geopotential number by the normal gravity value computed on the
AI1524.Geodetic Reference System of 1980 (GRS 80) ellipsoid at 45
AI1524.degrees latitude (g = 980.6199 gals.).
AI1524
AI1524.The modeled gravity was interpolated from observed gravity values.
AI1524
AI1524; North East Units Estimated Accuracy
AI1524;SPC FL E - 250,530. 205,040. MT (+/- 180 meters Scaled)
AI1524
AI1524 SUPERSEDED SURVEY CONTROL
AI1524
AI1524.No superseded survey control is available for this station.
AI1524
AI1524_U.S. NATIONAL GRID SPATIAL ADDRESS: 17RNK050415(NAD 83)
AI1524
AI1524_MARKER: DD = SURVEY DISK
AI1524_SETTING: 7 = SET IN TOP OF CONCRETE MONUMENT
AI1524_STAMPING: BM HEN-27 1983
AI1524_MARK LOGO: SFLWMD
AI1524_PROJECTION: RECESSED 15 CENTIMETERS

```

AI1524\_MAGNETIC: M = MARKER EQUIPPED WITH BAR MAGNET  
 AI1524\_STABILITY: C = MAY HOLD, BUT OF TYPE COMMONLY SUBJECT TO  
 AI1524+STABILITY: SURFACE MOTION  
 AI1524\_SATELLITE: THE SITE LOCATION WAS REPORTED AS SUITABLE FOR  
 AI1524+SATELLITE: SATELLITE OBSERVATIONS - February 21, 2002

AI1524

AI1524	HISTORY	- Date	Condition	Report By
AI1524	HISTORY	- 1983	MONUMENTED	SFLWMD
AI1524	HISTORY	- 19961002	GOOD	FLDEP
AI1524	HISTORY	- 20020221	GOOD	FLDEP

AI1524

AI1524 STATION DESCRIPTION

AI1524

AI1524'DESCRIBED BY FL DEPT OF ENV PRO 1996 (VAJ)

AI1524'THE MARK IS ABOUT 18.4 MI (29.6 KM) SOUTHWEST OF BELLE GLADE, 11.0 MI  
 AI1524'(17.7 KM) SOUTH OF CLEWISTON IN SECTION 4, TOWNSHIP 45 SOUTH, RANGE 34  
 AI1524'EAST. TO REACH THE MARK FROM THE POST OFFICE IN LAKE HARBOR, GO  
 AI1524'SOUTHERLY ON MIAMI CANAL ROAD (WEST SIDE OF CANAL) FOR 0.65 MI (1.05  
 AI1524'KM) TO THE END OF THE PAVEMENT, CONTINUE SOUTH ON MIAMI CANAL ROAD FOR  
 AI1524'2.35 MI (3.78 KM) TO THE JUNCTION OF ROGERS ROAD ON THE RIGHT, TURN  
 AI1524'RIGHT ON ROGERS ROAD AND GO WEST FOR 3.8 MI (6.1 KM) TO THE PALM  
 AI1524'BEACH-HENDRY COUNTY LINE, CONTINUE WEST ON ROGERS ROAD FOR 0.95 MI  
 AI1524'(1.53 KM) TO A SHARP CURVE RIGHT, CONTINUE THRU THE CURVE RIGHT AND GO  
 AI1524'NORTH THEN WEST ON ROGERS ROAD FOR 0.05 (CROSSING OVER THE L1-E CANAL  
 AI1524'BRIDGE) TO THE Y-JUNCTION OF COUNTY ROAD 832, CONTINUE WEST ON COUNTY  
 AI1524'ROAD 832 FOR 1.0 MI (1.6 KM) TO THE APPROXIMATE CENTER OF A SHARP  
 AI1524'CURVE LEFT AND BRIDGE NUMBER 302 OVER THE L1-E CANAL, CONTINUE THRU  
 AI1524'THE CURVE LEFT AND GO SOUTH ON COUNTY ROAD 832 FOR 1.95 MI (3.14 KM)  
 AI1524'TO THE APPROXIMATE CENTER OF A SHARP CURVE RIGHT, CONTINUE THRU THE  
 AI1524'CURVE RIGHT AND GO WEST ON COUNTY ROAD 832 FOR 2.0 MI (3.2 KM) TO THE  
 AI1524'L-2 CANAL AND THE LEVEE ROAD ON THE LEFT (EAST SIDE OF CANAL) , TURN  
 AI1524'LEFT ON THE LEVEE ROAD NUMBER L-2 AND GO SOUTH FOR 2.0 MI (3.2 KM) TO  
 AI1524'A TURNOUT ON THE TOP OF THE LEVEE AND THE MARK ON THE RIGHT, IN THE  
 AI1524'APPROXIMATE CENTER OF THE TURNOUT, SET IN THE TOP OF A ROUND CONCRETE  
 AI1524'MONUMENT RECESSED 0.6 FT (18.3 CM) BELOW GROUND. LOCATED 59.0 FT (18.0  
 AI1524'M) WEST OF A BARBED WIRE FENCE, 50.6 FT (15.4 M) NORTH OF THE  
 AI1524'APPROXIMATE SOUTH END OF THE TURNOUT, 47.1 FT (14.4 M) SOUTH OF THE  
 AI1524'APPROXIMATE NORTH END OF THE TURNOUT, 31.7 FT (9.7 M) WEST OF THE  
 AI1524'APPROXIMATE CENTERLINE OF THE ROAD AT THE TOE OF THE LEVEE, 15.6 FT  
 AI1524'(4.8 M) EAST OF THE APPROXIMATE CENTERLINE OF THE DIM TRACK ROAD AT  
 AI1524'THE TOP OF THE LEVEE AND 1.3 FT (0.4 M) WEST OF A CARSONITE WITNESS  
 AI1524'POST. NOTE CONTACT GENE TANNER, SOUTH FLORIDA WATER MANAGEMENT,  
 AI1524'REGIONAL DIRECTOR, CLEWISTON FIELD STATION, PHONE NUMBER 813-983-1431.

AI1524

AI1524 STATION RECOVERY (2002)

AI1524

AI1524'RECOVERY NOTE BY FL DEPT OF ENV PRO 2002 (JLM)

AI1524'THE MARK IS ABOUT 18.4 MI SOUTHWEST OF BELLE GLADE, 11.0 MI SOUTH OF  
 AI1524'CLEWISTON, IN SECTION  
 AI1524'4, TOWNSHIP 45 SOUTH, RANGE 34 EAST.

AI1524'

AI1524'TO REACH THE MARK FROM THE JUNCTION OF U.S. HIGHWAY 27 AND COUNTY ROAD  
 AI1524'835 ON THE  
 AI1524'SOUTH SIDE OF CLEWISTON, GO WEST ON COUNTY ROAD 835 FOR 6.7 MI TO THE  
 AI1524'JUNCTION OF  
 AI1524'ROGERS ROAD ON THE LEFT AND A CURVE TO THE RIGHT, BEAR RIGHT AND  
 AI1524'CONTINUE WEST ON  
 AI1524'COUNTY ROAD 835 FOR 2.95 MI TO THE JUNCTION OF BLUMBERG ROAD ON THE  
 AI1524'LEFT, CONTINUE WEST  
 AI1524'ON COUNTY ROAD 835 FOR 1.9 MI TO THE JUNCTION OF LEVEE ROAD L-1 ON THE

AI1524'LEFT, THE EAST END  
AI1524'OF BRIDGE NUMBER 070034, THE JUNCTION OF LEVEE L-1 ON THE RIGHT (ON  
AI1524'THE EAST SIDE OF  
AI1524'CANAL), TURN LEFT ON LEVEE L-1 AND GO SOUTH FOR 2.0 MI TO A TURNOUT ON  
AI1524'THE LEFT AND THE  
AI1524'MARK ON THE LEFT, SET IN THE TOP OF A ROUND CONCRETE MONUMENT IN THE  
AI1524'APPROXIMATE  
AI1524'CENTER OF THE TURNOUT, RECESSED 0.6 FT BELOW THE LEVEL OF THE GROUND  
AI1524'AND BELOW THE  
AI1524'LEVEL OF THE LEVEE ROAD.  
AI1524'  
AI1524'LOCATED 59.0 FT WEST OF A BARBED WIRE FENCE, 50.6 FT NORTH OF THE  
AI1524'APPROXIMATE SOUTH END  
AI1524'OF THE TURNOUT, 47.1 FT SOUTH OF THE APPROXIMATE NORTH END OF THE  
AI1524'TURNOUT, 31.7 FT WEST  
AI1524'OF THE APPROXIMATE CENTERLINE OF THE ROAD AT THE TOE OF THE LEVEE AND  
AI1524'15.6 FT EAST OF  
AI1524'THE APPROXIMATE CENTERLINE OF THE LEVEE ROAD AT THE TOP OF THE LEVEE.  
AI1524'NOTE A MAGNET WAS IMBEDDED IN THE GROUND ON THE SOUTH SIDE OF THE  
AI1524'MONUMENT.  
AI1524'  
AI1524'  
AI1524'

\*\*\* retrieval complete.  
Elapsed Time = 00:00:02

From the "ngvd29.txt" file provided by NGS for the CERP Geodetic Vertical Control Project.  
 Line/Part: L26265 SSN+: mark floated, SSN\*: mark constrained, SSN#: mark floated & constrained  
 Mark ID SSN PID Designation Geopotential Elevation Codes  
 1897 0026 AI1525 HEN 28 8.2386 8.4067  
 1898 0027 AI1524 HEN 27 7.7394 7.8973

## The NGS Data Sheet

See file [dsdata.txt](#) for more information about the datasheet.

```
PROGRAM = datasheet95, VERSION = 8.8
1      National Geodetic Survey,  Retrieval Date = JANUARY 10, 2016
AI1525 *****
AI1525 DESIGNATION - HEN 28
AI1525 PID - AI1525
AI1525 STATE/COUNTY- FL/HENDRY
AI1525 COUNTRY - US
AI1525 USGS QUAD - LAKE HARBOR SW (1994)
AI1525
AI1525 *CURRENT SURVEY CONTROL
AI1525
AI1525* NAD 83(1986) POSITION- 26 36 37. (N) 080 57 00. (W) SCALED
AI1525* NAVD 88 ORTHO HEIGHT - 7.991 (meters) 26.22 (feet) ADJUSTED
AI1525
AI1525 GEOID HEIGHT - -24.727 (meters) GEOID12B
AI1525 DYNAMIC HEIGHT - 7.979 (meters) 26.18 (feet) COMP
AI1525 MODELED GRAVITY - 979,092.3 (mgal) NAVD 88
AI1525
AI1525 VERT ORDER - FIRST CLASS II
AI1525
AI1525.The horizontal coordinates were scaled from a topographic map and have
AI1525.an estimated accuracy of +/- 6 seconds.
AI1525.
AI1525.The orthometric height was determined by differential leveling and
AI1525.adjusted by the NATIONAL GEODETIC SURVEY
AI1525.in October 1999.
AI1525
AI1525.Significant digits in the geoid height do not necessarily reflect accuracy.
AI1525.GEOID12B height accuracy estimate available here.
AI1525
AI1525.The dynamic height is computed by dividing the NAVD 88
AI1525.geopotential number by the normal gravity value computed on the
AI1525.Geodetic Reference System of 1980 (GRS 80) ellipsoid at 45
AI1525.degrees latitude (g = 980.6199 gals.).
AI1525
AI1525.The modeled gravity was interpolated from observed gravity values.
AI1525
AI1525; North East Units Estimated Accuracy
AI1525;SPC FL E - 252,230. 204,980. MT (+/- 180 meters Scaled)
AI1525
AI1525 SUPERSEDED SURVEY CONTROL
AI1525
AI1525.No superseded survey control is available for this station.
AI1525
AI1525_U.S. NATIONAL GRID SPATIAL ADDRESS: 17RNK049432 (NAD 83)
AI1525
AI1525_MARKER: F = FLANGE-ENCASED ROD
AI1525_SETTING: 49 = STAINLESS STEEL ROD W/O SLEEVE (10 FT.+)
AI1525_STAMPING: BM HEN-28 1983 SFLWMD
AI1525_MARK LOGO: SFLWMD
AI1525_PROJECTION: RECESSED 15 CENTIMETERS
```



AI1525\_MAGNETIC: M = MARKER EQUIPPED WITH BAR MAGNET  
 AI1525\_STABILITY: B = PROBABLY HOLD POSITION/ELEVATION WELL  
 AI1525\_SATELLITE: THE SITE LOCATION WAS REPORTED AS SUITABLE FOR  
 AI1525+SATELLITE: SATELLITE OBSERVATIONS - March 05, 2009  
 AI1525\_ROD/PIPE-DEPTH: 12.8 meters

AI1525

AI1525	HISTORY	- Date	Condition	Report By
AI1525	HISTORY	- 1983	MONUMENTED	SFLWMD
AI1525	HISTORY	- 19961002	GOOD	FLDEP
AI1525	HISTORY	- 20020221	GOOD	FLDEP
AI1525	HISTORY	- 20050811	GOOD	INDIV
AI1525	HISTORY	- 20090305	GOOD	PICKET

AI1525

AI1525

STATION DESCRIPTION

AI1525

AI1525'DESCRIBED BY FL DEPT OF ENV PRO 1996 (VAJ)  
 AI1525'THE MARK IS ABOUT 18.1 MI (29.1 KM) WEST-SOUTHWEST OF BELLE GLADE,  
 AI1525'10.0 MI (16.1 KM) SOUTH OF CLEWISTON IN SECTION 33, TOWNSHIP 45 SOUTH,  
 AI1525'RANGE 34 EAST. TO REACH THE MARK FROM THE POST OFFICE IN LAKE HARBOR,  
 AI1525'GO SOUTHERLY ON MIAMI CANAL ROAD (WEST SIDE OF CANAL) FOR 0.65 MI  
 AI1525'(1.05 KM) TO THE END OF THE PAVEMENT, CONTINUE SOUTH ON MIAMI CANAL  
 AI1525'ROAD FOR 2.35 MI (3.78 KM) TO THE JUNCTION OF ROGERS ROAD ON THE  
 AI1525'RIGHT, TURN RIGHT ON ROGERS ROAD AND GO WEST FOR 3.8 MI (6.1 KM) TO  
 AI1525'THE PALM BEACH-HENDRY COUNTY LINE, CONTINUE WEST ON ROGERS ROAD FOR  
 AI1525'0.95 MI (1.53 KM) TO A SHARP CURVE RIGHT, CONTINUE THRU THE CURVE  
 AI1525'RIGHT AND GO NORTH THEN WEST ON ROGERS ROAD FOR 0.05 (CROSSING OVER  
 AI1525'THE L1-E CANAL BRIDGE) TO THE Y-JUNCTION OF COUNTY ROAD 832, CONTINUE  
 AI1525'WEST ON COUNTY ROAD 832 FOR 1.0 MI (1.6 KM) TO THE APPROXIMATE CENTER  
 AI1525'OF A SHARP CURVE LEFT AND BRIDGE NUMBER 302 OVER THE L1-E CANAL,  
 AI1525'CONTINUE THRU THE CURVE LEFT AND GO SOUTH ON COUNTY ROAD 832 FOR 1.95  
 AI1525'MI (3.14 KM) TO A SHARP CURVE RIGHT, CONTINUE THRU THE CURVE RIGHT AND  
 AI1525'GO WEST ON COUNTY ROAD 832 FOR 2.0 MI (3.2 KM) TO THE L-2 CANAL AND  
 AI1525'THE LEVEE ROAD ON THE LEFT (EAST SIDE OF CANAL) , TURN LEFT ON LEVEE  
 AI1525'ROAD NUMBER L-2 AND GO SOUTH FOR 1.0 MI (1.6 KM) TO A TURNOUT ON THE  
 AI1525'TOP OF THE LEVEE AND THE MARK ON THE RIGHT, SET IN THE APPROXIMATE  
 AI1525'CENTER OF THE TURNOUT, A STAINLESS STEEL ROD DRIVEN INTO THE GROUND,  
 AI1525'ENCASED IN A 6-INCH PVC PIPE RECESSED 0.2 FT (6.1 CM) BELOW THE LEVEL  
 AI1525'OF THE GROUND, THE DATUM POINT IS RECESSED 0.6 FT (18.3 CM) BELOW THE  
 AI1525'LEVEL OF THE 6-INCH PVC SCREW CAP. LOCATED 52.1 FT (15.9 M) NORTH OF  
 AI1525'THE APPROXIMATE SOUTH END OF THE TURNOUT, 48.0 FT (14.6 M) SOUTH OF  
 AI1525'THE APPROXIMATE NORTH END OF THE TURNOUT, 43.5 FT (13.3 M) WEST OF THE  
 AI1525'APPROXIMATE CENTERLINE OF THE DIRT ROAD AT THE TOE OF THE LEVEE, 30.0  
 AI1525'FT (9.1 M) WEST OF A CARSONITE WITNESS POST AND 13.0 FT (4.0 M) EAST  
 AI1525'OF THE APPROXIMATE CENTERLINE OF THE DIM TRACK ROAD AT THE TOP OF THE  
 AI1525'LEVEE. NOTE ACCESS TO DATUM POINT IS HAD THROUGH A 6-INCH PVC SCREW  
 AI1525'CAP. CONTACT GENE TANNER, SOUTH FLORIDA WATER MANAGEMENT, REGIONAL  
 AI1525'DIRECTOR, CLEWISTON FIELD STATION, PHONE NUMBER 813-983-1431.

AI1525

AI1525

STATION RECOVERY (2002)

AI1525

AI1525'RECOVERY NOTE BY FL DEPT OF ENV PRO 2002 (JLM)  
 AI1525'THE MARK IS ABOUT 18.1 MI WEST-SOUTHWEST OF BELLE GLADE, 10.0 MI SOUTH  
 AI1525'OF CLEWISTON, IN  
 AI1525'SECTION 33, TOWNSHIP 45 SOUTH, RANGE 34 EAST.  
 AI1525'  
 AI1525'TO REACH THE MARK FROM THE JUNCTION OF U.S. HIGHWAY 27 AND COUNTY ROAD  
 AI1525'835 ON THE  
 AI1525'SOUTH SIDE OF CLEWISTON, GO WEST ON COUNTY ROAD 835 FOR 6.7 MI TO THE  
 AI1525'JUNCTION OF  
 AI1525'ROGERS ROAD ON THE LEFT AND A CURVE TO THE RIGHT, BEAR RIGHT AND





