

1WSD - MZ2, -MZ3

11-14-06

IMMOKALEE WWTP

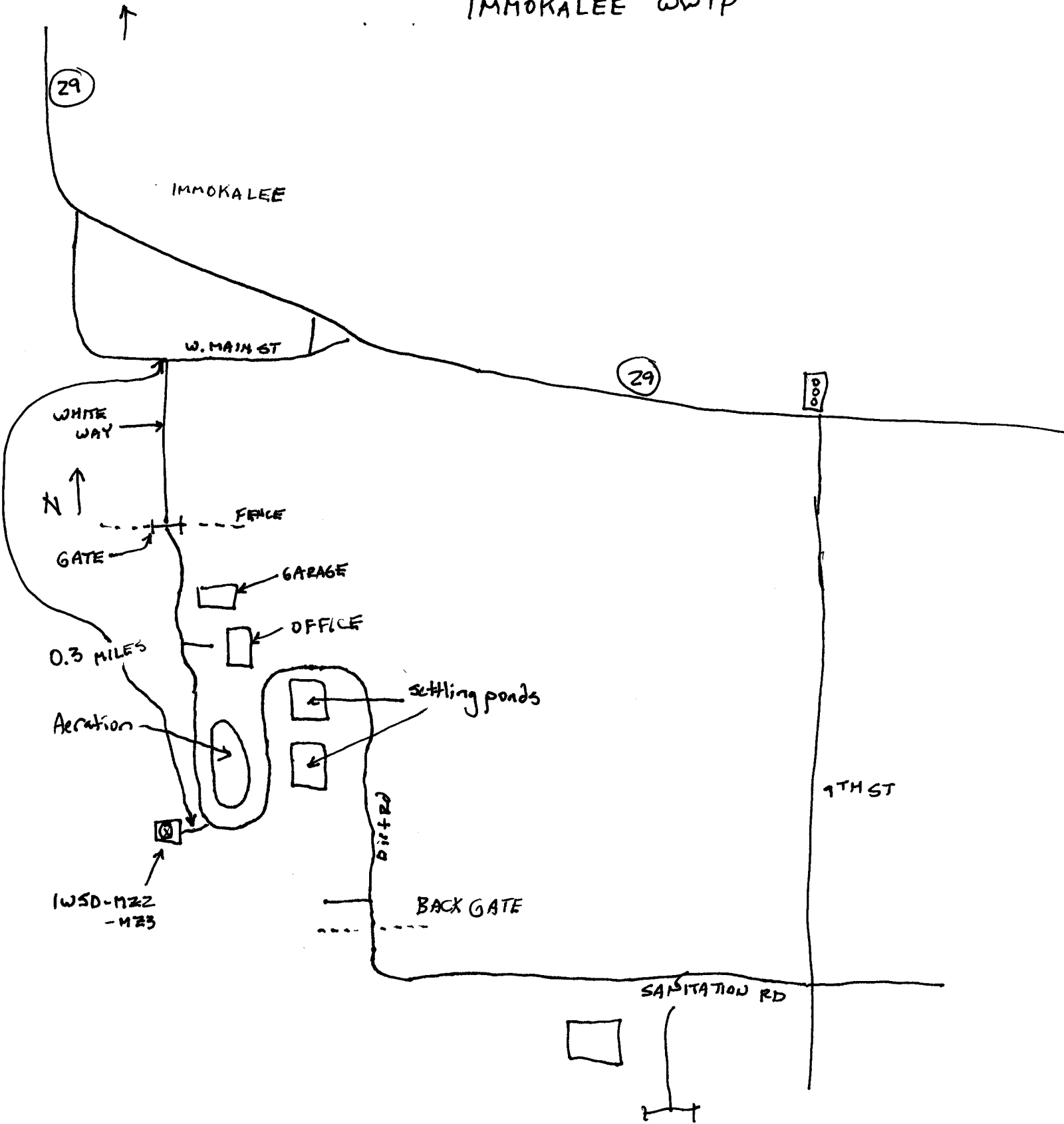

1WSD-MZ2 - MZ3

IMMOKALEE WJTP

11-14-06

NW

AP 1315 HRS

FLOWING

* SAMPLE ON 1ST MONDAY - EVERY MONTH

(CALL AHEAD)

JON SHORT 239-216-0826

TOOK 2 PICS

PIC 1 → MZ2 . SAMPLE PORT ON RIGHT
FACING NORTH

PIC 2 → MZ3
FACING SE

* NOTE: NO MZ1 ZONE ANYMORE

- 2 PIPES → UPPER (MZ2)
- 1 PIPE → MIDDLE (MZ3)
- 1 PIPE → LOWER (MZ4)