

MARTIN CO WELLS FB#6 12/8/88
 LEVELS TO MARTIN CO WELL NO. 1240 FROM FCD P.1.437
 BM NO. #23 (LINE A)

STA	+	H I	-	ELEV	BM ELEV
BM					30.47
		SEC 31 TWP 37 RGE 39			
	4.95				
	2.31	35.42			
TP			5.65	29.77	
			1.61		
	5.61	35.38			
	1.65				
TP			5.33	30.05	
			1.93		
	5.02	35.07			
	2.24				
TP			5.95	29.12	
			1.31		
	5.89	35.01			
	1.37				
TP			4.64	30.37	
			2.62		
	5.07	35.44			
	2.19				
TP			5.64	29.80	
			1.62		
	5.55	35.35			
	1.71				
TP			4.73	30.62	
			2.53		
	5.08	35.70			
	2.18				

CONT'D ON PG-7

MARTIN CO WELLS FB#6 12/08/88 MS 6

COMMENTS
 FCD P.1.437 BM#23 (LINE A) 1976 ITLUCIE WELLS FB#6
 PG-24 RECOVERED AS DESCRIBED BUT 1.2' BELOW GRND.

MARTIN CO WELLS FB#6 12/08/88

CONT'D FROM PG-6

STA	+	H I	-	ELEV	BM ELEV
		35.70			
TP			5.50	30.20	
			1.76		
	4.64	34.84			
	2.62				
TP			6.28	28.56	
			0.98		
	4.92	33.48			
	2.34				
TP			5.40	28.08	
			1.86		
	5.53	31.61			
	1.73				
TP			5.64	27.97	
			1.62		
	5.53	33.50			
	1.73				
TP			4.96	28.54	
			2.30		
	4.80	33.34			
	2.46				
TP			4.27	29.07	
			2.99		
	5.03	34.10			
	2.23				
TP			4.50	29.60	
			2.76		
	6.81	36.41			
	0.45				
BM			1.02	35.39	35.39
			6.24		

RETURN LEVELS ON PG-8

MARTIN CO WELLS FB#6

12/08/88

7

COMMENTS

SET BM C-23-609

S 36 T 37 R 38

NOTE FCD P1-441 (BM 25) & BM #23 LINE A HAVE BEEN DESTROYED BECAUSE OF BRIDGE WIDENING

C-23

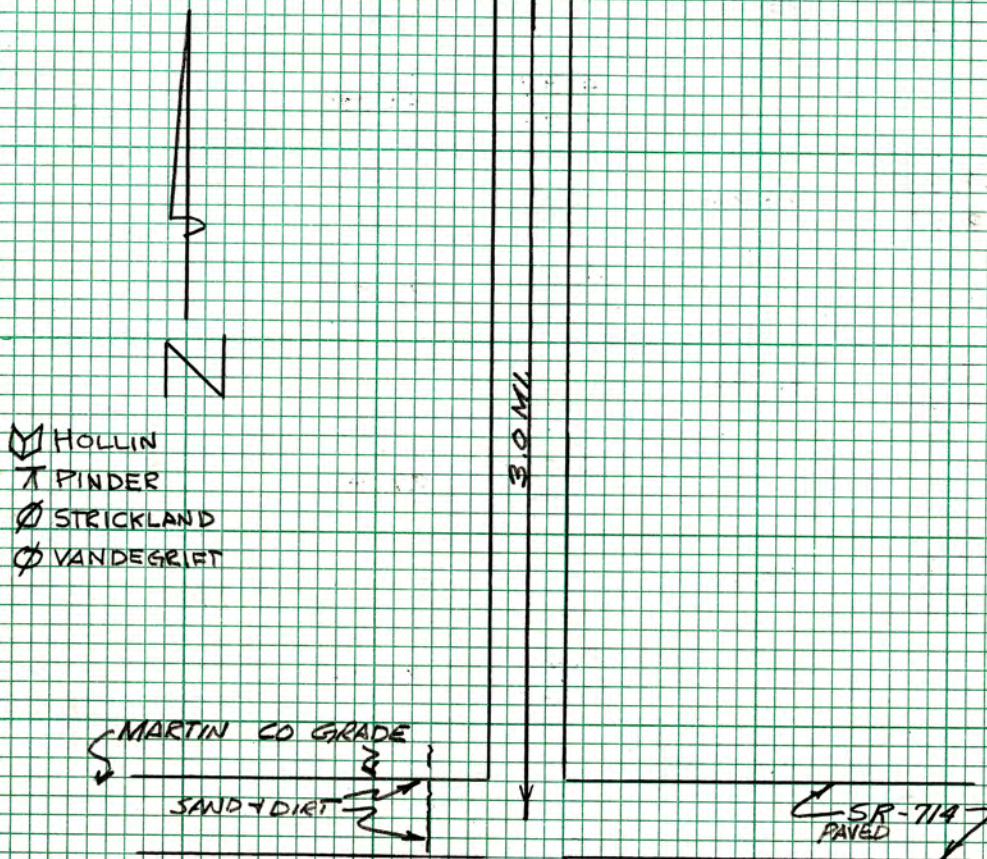

BM C-23 609 SET S.F.W.M.D. ALUM. DISK IN N.W. END OF OF BRIDGE RAIL OF BRIDGE OVER C-23 ON S.R. 609. STA IS 3.0 MI N. OF THE INTERSECTION OF S.R. 714 + SR-609. NOTE BRIDGE WAS WIDENED IN 1987 + BM #24 LINE A + FCD P1 441 (BM #25) HAVE BEEN DESTROYED

RETURN LEVELS FROM PG-7

STA	+	HI	-	ELEV	BMELEV
BM				35.39	35.39
	1.17	36.56			
	6.09				
TP			6.916	29.60	
			0.30		
	4.46	34.06			
	2.81				
TP			4.97	29.09	
			2.29		
	4.29	33.38			
	2.97				
TP			4.85	28.53	
			2.41		
	5.05	33.58			
	2.21				
TP			5.59	27.99	
			1.67		
	5.71	33.70			
	1.55				
TP			5.66	28.04	
			1.60		
	5.62	33.66			
	1.64				
TP			5.09	28.57	
			2.17		
	6.28	34.85			
	0.98				

CONT'D ON PG-9

S 36 T 37 R 12 38 7

BM C-23 609 S.F.W.M.D ALUM DISK SET IN N.W. END OF BRIDGE RAIL OF BRIDGE OVER C-23 SEE PG-7

CONT'D FROM Pg-8

STA	+	H I	-	ELEV	BM ELEV
TP		34.85	4.86 2.40	29.99	
	5.66 1.60	35.65			
TP			5.06 2.20	30.59	
	4.80 2.46	35.39			
TP			5.55 1.71	29.84	
	5.65 1.61	35.49			
TP			5.06 2.20	30.43	
	4.64 2.62	35.07			
TP			5.96 1.30	29.11	
	6.06 1.20	35.17			
TP			5.09 2.17	30.08	
	5.47 1.79	35.55			
TP			5.80 1.46	29.75	
	5.91 1.35	35.66			
BM			5.18 2.08	30.43	30.47

LEVELS TO MARTIN CO WELL 1240 CONT'D ON Pg-10

COMMENTS

LEVELS TO MARTIN CO WELL 1240 CONT'D FROM Pg-9

STA	+	HI	-	ELEV	BM ELEV
BM					35.39
		2.34			
		4.92			
TP			7.03		
			0.23		
		4.01			
		3.26			
TP			5.25		
			2.01		
		5.36			
		1.90			
WELL MARTIN CO # 1240			5.00		
			2.26		

NGS
 10.350m (33.956625') NAVD88
 10.7874m (35.3916615') NGVD29

F 11.71 - 17.28 = -5.57
 28.386625' NAVD88
 29.8216615' NGVD29

RETURN LEVELS

		5.10			
		2.16			
TP			5.96		
			1.80		
		5.34			
		1.92			
TP			3.86		
			3.41		
		6.66			
		0.61			
BM			2.21		35.39'
			5.05		

TIE TO WELLS CONT' ON Pg-11

COMMENTS:

BM C-23 609 S.F.W.M.D. ALUM DISK SET IN N.W. END OF BRIDGE RAIL SEE Pg-7

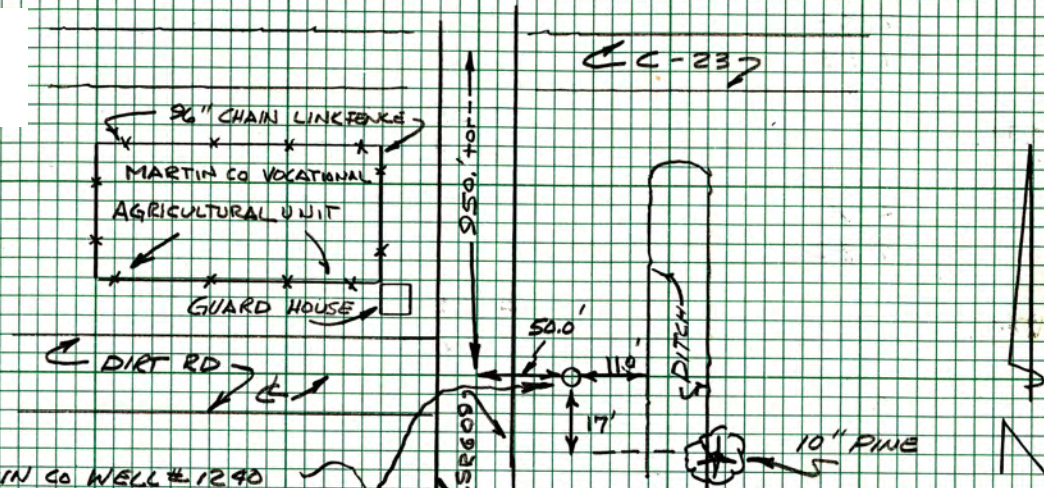

MARTIN CO WELL # 1240
 TOP + N. SIDE OF 2" (I.D.) PVC WELL ELEV IS A X-MARK PAINT ORANGE ON TOP OF CASING, WELL IS 2.8 MI N. OF THE INTERSECTION OF S.R. 714 ON SR-609, STA IS 50.0' E. OF C OF SR-609, 11.0' W OF THE TOP OF BANK OF A N. + S DITCH AND 17.0' @ RIGHT ANGLES TO A 10" PINE ON E. TOP OF BANK OF N+S DITCH AND ON PROJECTED C OF RD TO W TO MARTIN VOCATIONAL AGRICULTURAL UNIT + 950' S HOR - C OF C-23 CANAL IN SEC 6 TWP 38 R6E 39 WELL IS 0.10 ABOVE THE LEVEL OF THE GRND.

BM C-23 609 SEE Pg-7

From the "ngvd29.txt" file provided by NGS for the CERP Geodetic Vertical Control Project.
 Line/Part: L26245 SSN+: mark floated, SSN*: mark constrained, SSN#: mark floated
 & constrained

The NGS Data Sheet

Mark ID	SSN	PID	Designation	Geopotential	Elevation	Codes
1802	3155	AJ8597	C 23 609	10.5717	10.7874	

See file [dsdata.txt](#) for more information about

```

PROGRAM = datasheet95, VERSION = 8.8
1      National Geodetic Survey,      Retrieval Date = OCTOBER 14, 2015
AJ8597 *****
AJ8597 DESIGNATION - C 23 609
AJ8597 PID - AJ8597
AJ8597 STATE/COUNTY- FL/ST LUCIE
AJ8597 COUNTRY - US
AJ8597 USGS QUAD - INDIAN TOWN NW (1983)
AJ8597
AJ8597 *CURRENT SURVEY CONTROL
AJ8597
AJ8597* NAD 83(1986) POSITION- 27 12 23.6 (N) 080 28 53.4 (W) HD_HELD2
AJ8597* NAVD 88 ORTHO HEIGHT - 10.350 (meters) 33.96 (feet) ADJUSTED
AJ8597
AJ8597 GEOID HEIGHT - -27.086 (meters) GEOID12B
AJ8597 DYNAMIC HEIGHT - 10.334 (meters) 33.90 (feet) COMP
AJ8597 MODELED GRAVITY - 979,106.2 (mgal) NAVD 88
AJ8597
AJ8597 VERT ORDER - FIRST CLASS II
AJ8597
AJ8597.The horizontal coordinates were established by autonomous hand held GPS
AJ8597.observations and have an estimated accuracy of +/- 10 meters.
AJ8597.
AJ8597.The orthometric height was determined by differential leveling and
AJ8597.adjusted by the NATIONAL GEODETIC SURVEY
AJ8597.in May 2002.
AJ8597
AJ8597.Significant digits in the geoid height do not necessarily reflect accuracy.
AJ8597.GEOID12B height accuracy estimate available here.
AJ8597
AJ8597.The dynamic height is computed by dividing the NAVD 88
AJ8597.geopotential number by the normal gravity value computed on the
AJ8597.Geodetic Reference System of 1980 (GRS 80) ellipsoid at 45
AJ8597.degrees latitude (g = 980.6199 gals.).
AJ8597
AJ8597.The modeled gravity was interpolated from observed gravity values.
AJ8597
AJ8597; North East Units Estimated Accuracy
AJ8597;SPC FL E - 318,396. 251,367. MT (+/- 10 meters HH2 GPS)
AJ8597
AJ8597 SUPERSEDED SURVEY CONTROL
AJ8597
AJ8597.No superseded survey control is available for this station.
AJ8597
AJ8597_U.S. NATIONAL GRID SPATIAL ADDRESS: 17RNL5134909419(NAD 83)
AJ8597
AJ8597_MARKER: DD = SURVEY DISK
AJ8597_SETTING: 31 = SET IN A PAVEMENT SUCH AS STREET, SIDEWALK, CURB, ETC.
AJ8597_SP_SET: GUARDRAIL
AJ8597_STAMPING: C-23 609
AJ8597_MARK LOGO: SFLWMD
AJ8597_MAGNETIC: N = NO MAGNETIC MATERIAL
AJ8597_STABILITY: D = MARK OF QUESTIONABLE OR UNKNOWN STABILITY
AJ8597_SATELLITE: THE SITE LOCATION WAS REPORTED AS NOT SUITABLE FOR
AJ8597+SATELLITE: SATELLITE OBSERVATIONS - January 13, 2015
AJ8597
AJ8597 HISTORY - Date Condition Report By
    
```

AJ8597	HISTORY	- 1994	MONUMENTED	SFLWMD
AJ8597	HISTORY	- 20010906	GOOD	FOST
AJ8597	HISTORY	- 20060817	GOOD	FLDEP
AJ8597	HISTORY	- 20150113	GOOD	FLDEP

AJ8597

AJ8597

AJ8597

STATION DESCRIPTION

AJ8597

AJ8597'DESCRIBED BY CHARLEY FOSTER AND ASSOCIATES 2001 (JB)

AJ8597'THE MONUMENT IS LOCATED 13.0 MILES (20.92 KM) NORTH OF INDIANTOWN, FL.

AJ8597'AND 14.0 MILES (22.53 KM) WEST

AJ8597'OF PALM CITY, FL., SECTION 36, TOWNSHIP 37 SOUTH, RANGE 38 EAST.

AJ8597'

AJ8597'OWNERSHIP IS ST. LUCIE COUNTY RIGHT OF WAY.

AJ8597'

AJ8597'TO REACH THE MONUMENT FROM THE INTERSECTION OF COUNTY ROAD 714 AND

AJ8597'COUNTY ROAD 609, 11.1 MILES

AJ8597'(17.86 KM) WEST OF THE JUNCTION OF THE FLORIDA TURNPIKE, STATE ROAD

AJ8597'714 AND COUNTY ROAD 714 IN

AJ8597'PALM CITY FL., GO NORTH ON COUNTY ROAD 609 FOR 3.0 MILES (4.83 KM) TO

AJ8597'MONUMENT LOCATION ON WEST

AJ8597'SIDE (LEFT) OF HIGHWAY AT THE NORTHWEST END OF BRIDGE NO. 940026 AT

AJ8597'GUARDRAIL ATTACHMENT.

AJ8597'

AJ8597'THE MONUMENT IS 21.5 FEET (6.55 M) WEST OF THE CENTERLINE OF COUNTY

AJ8597'ROAD 609, 67.0 FEET (20.42 M)

AJ8597'SOUTH OF THE CENTER OF A DIRT CANAL/ORANGE GROVE ACCESS ROAD, 5.1 FEET

AJ8597'(1.55 M) SOUTHEAST OF THE

AJ8597'EAST POST OF A SIGN READING C-23 SFLWMD PROTECTING OUR WATER

AJ8597'RESOURCES, 1.6 FEET (0.49 M) SOUTH

AJ8597'OF THE END OF CONCRETE GUARDRAIL ANCHOR AT NORTHWEST CORNER OF BRIDGE.

AJ8597'

AJ8597

AJ8597

STATION RECOVERY (2006)

AJ8597

AJ8597'RECOVERY NOTE BY FL DEPT OF ENV PRO 2006 (BPJ)

AJ8597'RECOVERED AS DESCRIBED.

AJ8597

AJ8597

STATION RECOVERY (2015)

AJ8597

AJ8597'RECOVERY NOTE BY FL DEPT OF ENV PRO 2015 (BPJ)

AJ8597'RECOVERED AS DESCRIBED.

*** retrieval complete.

Elapsed Time = 00:00:04