



PB 1155		Elevation:	15.29 ft	(NAVD 88)	16.74 ft	(NGVD 29)
Bench Mark 1:	ENR 103		20.07 ft	(NAVD 88)	21.49 ft	(NGVD 29)
Bench Mark 2:	CAN AZ MK		36.52 ft	(NAVD 88)	37.75 ft	(NGVD 29)
Bench Mark 3:	L 402		15.91 ft	(NAVD 88)	17.42 ft	(NGVD 29)
Bench Mark 4:	C 402		14.97 ft	(NAVD 88)	16.52 ft	(NGVD 29)
Bench Mark 5:	X 537		23.29 ft	(NAVD 88)	24.74 ft	(NGVD 29)
Monitoring Well:	PB 1155		16.76 ft	(NAVD 88)	18.20 ft	(NGVD 29)
			To Reach PB 1155:			
			<p>FROM INTERSECTION OF LAKE WORTH ROAD & PINEHURST DRIVE. GO NORTH ON PINEHURST DRIVE FOR 0.9 MILE TO OAKMONT DRIVE. GO WEST ON OAKMONT DRIVE FOR 0.8 MILE TO HOYLAKES ROAD. GO NORTH ON HOYLAKES ROAD +/- 75 FEET TO MARK ON RIGHT. 12.5 FEET EAST OF CENTERLINE OF HOYLAKES ROAD, 95.0 FEET SOUTHEAST OF MONITORING WELL PB 1155, 12.0 FEET WEST OF FACE OF EAST SIDEWALK, 64.0 FEET NORTH OF NORTHWEST CORNER OF STORM BASIN. SET MAGNET 1 FOOT NORTH OF CONCRETE MONUMENT.</p>			

PB 1534		Elevation:	19.71 ft	(NAVD 88)	21.18 ft	(NGVD 29)
Bench Mark 1:	R 537		18.74 ft	(NAVD 88)	20.21ft	(NGVD 29)
Bench Mark 2:	Q 537		21.20 ft	(NAVD 88)	22.67ft	(NGVD 29)
Monitoring Well:	PB 1534		19.86 ft	(NAVD 88)	21.33ft	(NGVD 29)
Length of Run:	4.48 km		To Reach PB 1534:			
Max Allowable Misclosure:	17 mm					
Actual Misclosure:	0 mm		<p>FROM INTERSECTION OF SEMINOLE PRATT WHITNEY ROAD & ORANGE BLVD. GO SOUTH ON SEMINOLE PRATT WHITNEY FOR 1.35' MILE TO SOUTH LEVEE ROAD OF M CANAL (934151) GO THROUGH LOCKED GATE WEST PALM BEACH WATER DEPARTMENT. GO EAST ON SOUTH LEVEE ROAD FOR 1.7 MILE. CONCRETE MONUMENT WILL BE ON RIGHT 47.7' NORTHWEST OF MONITORING WELL PB 1534, 6.10' SOUTH OF SOUTH TOP OF BANK OF M CANAL, 41.8' NORTHEAST OF NORTHEAST CORNER OF BLACK CULVERT, 8.3' EAST OF EAST TOP OF BANK OF M CANAL. SET MAGNET 1' NORTH OF CONCRETE MONUMENT.</p>			
						

PB-1155



Nick Miller, Inc.

Date of Photo: August 4, 2005

View: Looking at the well PB-1155 facing south

PB-1155



Nick Miller, Inc.
Date of Photo: August 4, 2005
View: Close-up of the well PB-1155 showing the contractor's markings

PB-1155



Nick Miller, Inc.

Date of Photo: August 4, 2005

View: Looking at the benchmark PB-1155 facing north

PB-1155



Nick Miller, Inc.
Date of Photo: August 4, 2005
View: A top view of the benchmark

1078

SFUMD

SET MONUMENT @ MONITORING
WELL SITE PB 1155

PB 1155

- SET POURED-IN-PLACE CONCRETE MONUMENT
w/ BRASS DISK
- SET MAGNET 1' NORTH OF CONC. MONUMENT
- SET CONC. MONUMENT 12.5' EAST OF E HOYLAKIE ROAD
- " " " 95.0' SE OF MONITORING WELL PB 1155
- " " " 12.0' WEST OF FACE OF SIDEWALK
- " " " 64' NORTH OF NW COR. OF STORM BASIN

STAMPED PB 1155
2005

COORDINATES ON CONCRETE MONUMENT PB 1155

STATE PLANE 83	WGS 84
N. 254873.218 METERS	N. 26° 37' 55.009"
E. 282479.992 METERS	W. 080° 10' 17.964"

COORDINATES ON MONITORING WELL PB 1155

STATE PLANE 83	WGS 84
N. 254920.762 METERS	N. 26° 37' 55.906"
E. 282470.392 METERS	W. 080° 10' 18.304"

THRU. AUG. 4, 2005

E. DETASSIS
GRAGER III

SFUMD 8,9

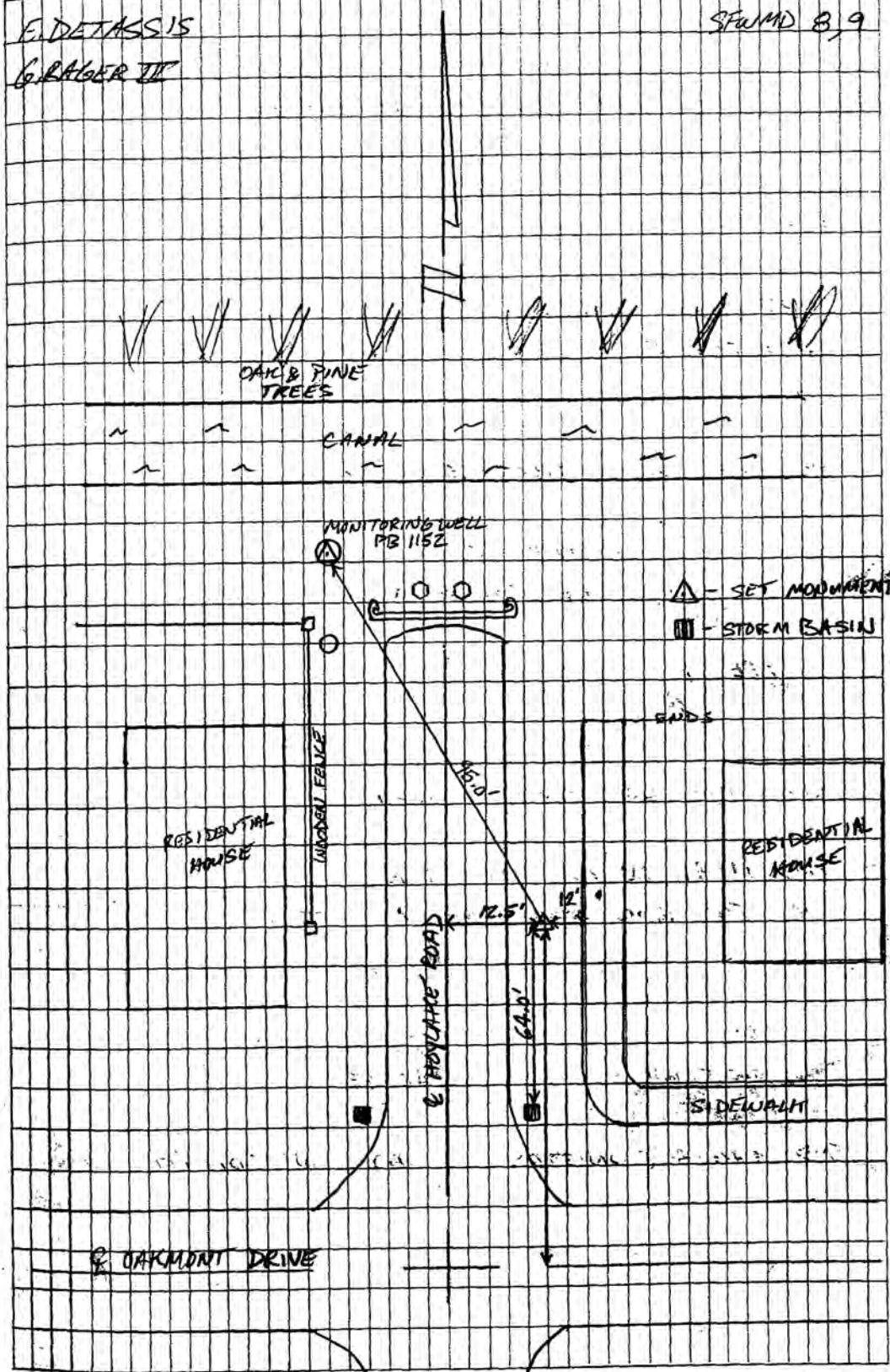



SOUTH FLORIDA WATER MANAGEMENT DISTRICT

Rev. 4/01

COUNTY	PALM BEACH		PROJECT	Hydrology – Palm Beach County Wells		DESIGNATION	PB 1155 2005	
SECTION	20		TOWNSHIP	44 SOUTH		RANGE	42 EAST	
GEOGRAPHIC INDEX OF QUAD								
Established by <u>Nick Miller Inc.</u> Recovered by				NAME OF QUADRANGLE Palm Beach Farms				
SURVEYOR <u>Stephen M. Gordon</u> DATE <u>8/26/2005</u>				FIELD BOOK <u>8</u> PAGE <u>9</u>				
HORIZONTAL DATUM: 1927 <input checked="" type="radio"/> 1983 Other _____ (circle one) ZONE <input checked="" type="radio"/> E or W								
STATE PLANE COORDINATES			E 926,770 ft			N 836,262 ft		
LATITUDE: N 26.63195°			LONGITUDE: W 80.17166°					
VERTICAL DATUM: MSL 1929 <input checked="" type="radio"/> 1988 Other _____ (circle one)						EL. 15.29 ft		
VERTICAL DATUM: MSL <input checked="" type="radio"/> 1929 1988 Other _____ (circle one)						EL. 16.74 ft		
CONTROL ACCURACY: HORIZONTAL 1 2 3 <input checked="" type="radio"/> SUB-METER (circle one) VERTICAL 1 2 <input checked="" type="radio"/> 3								
DESCRIPTION								
<p>To Reach:</p> <p>FROM INTERSECTION OF LAKE WORTH ROAD & PINEHURST DRIVE. GO NORTH ON PINEHURST DRIVE FOR 0.9 MILE TO OAKMONT DRIVE. GO WEST ON OAKMONT DRIVE FOR 0.8 MILE TO HOYLAKES ROAD. GO NORTH ON HOYLAKES ROAD +/- 75 FEET TO MARK ON RIGHT. 12.5 FEET EAST OF CENTERLINE OF HOYLAKES ROAD, 95.0 FEET SOUTHEAST OF MONITORING WELL PB 1155, 12.0 FEET WEST OF FACE OF EAST SIDEWALK, 64.0 FEET NORTH OF NORTHWEST CORNER OF STORM BASIN. SET MAGNET 1 FOOT NORTH OF CONCRETE MONUMENT.</p> <p>Benchmarks Used: ENR 103, CAN AZ MK, L 402, C 402, and X 537</p> <p>Notable Land marks:</p>								



SOUTH FLORIDA WATER MANAGEMENT DISTRICT

Rev. 4/01

SKETCH

1078

SEWARD

SET MONUMENT @ MONITORING
WELL SITE PR 1155

PR 1155

- SET ROUNDED-IN-PLACE CONCRETE MONUMENT
w/ BRASS DISK
- SET MAGNET 1' NORTH OF CONK MONUMENT
- SET CONK MONUMENT 12.5' EAST OF E HOVLANE ROAD
- " " " 95.0' SE OF MONITORING WELL PR 1155
- " " " 17.0' WEST OF FACE OF SIDEWALK
- " " " 64' NORTH OF NW COR OF STORM BASIN

STAMPED PR 1155
2005

COORDINATES ON CONCRETE MONUMENT PR 1155
STATE PLANE 83 WGS 84
N. 254920.218 METERS N. 26° 37' 55.009"
E. 282479.992 METERS W. 080° 10' 17.964"

COORDINATES ON MONITORING WELL PR 1155
STATE PLANE 83 WGS 84
N. 254920.762 METERS N. 26° 37' 55.906"
E. 282470.392 METERS W. 080° 10' 18.304"

THRU. AUG. 4, 2005

E. DETAKSIS
G. RAGER II

SEWARD B, 9

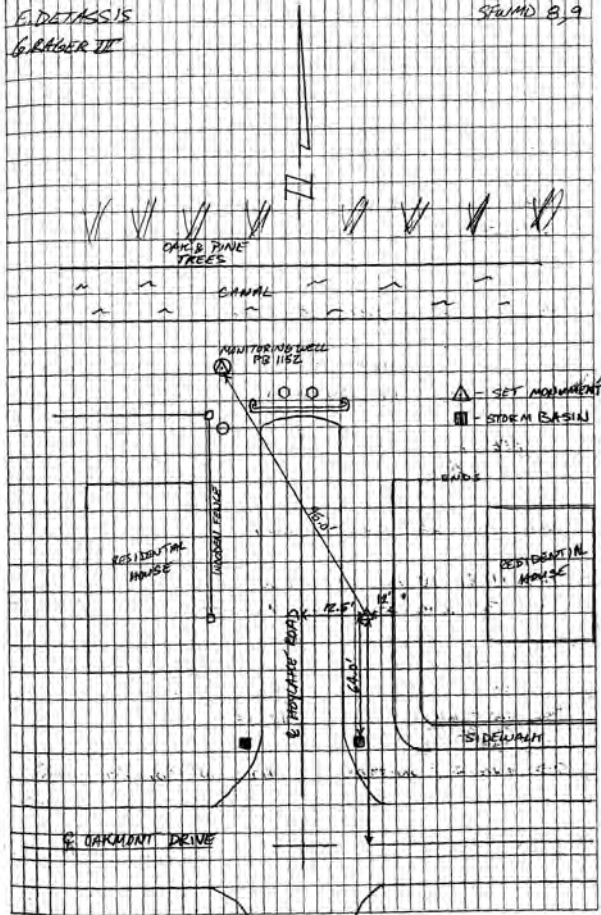

PB-1534



Nick Miller, Inc.

Date of Photo: June 15, 2005

View: Looking at the well PB-1534 facing south

PB-1534



Nick Miller, Inc.
Date of Photo: June 15, 2005
View: Close-up of the well PB-1534 showing the contractor's markings

PB-1534



Nick Miller, Inc.

Date of Photo: June 15, 2005

View: Looking at the benchmark facing west

PB-1534



Nick Miller, Inc.
Date of Photo: June 15, 2005
View: A top view of the benchmark

1078

SFUMAD

SET CONC. MONUMENT AT SITE
OF MONITORING WELL PB 1534

PB 1534

- SET POURED-IN-PLACE CONCRETE MONUMENT
- SET MAGNET 1' NORTH OF CONC. MONUMENT
- SET CONC. MONUMENT 47.70' NW OF MONITORING WELL PB 1534
- " " " 6.10' SOUTH OF SOUTH TOP OF BANK OF CANAL
- " " " 4.80' NE OF NE CORNER OF BLACK CULVERT
- " " " 8.3' EAST OF EAST TOP OF BANK OF CANAL

STAMPED PB 1534
2005

COORDINATES ON CONC. MON. PB 1534

STATE PLANE 83

NAD 83

N. 269573.980 m

N. $26^{\circ}45'54.119''$

E. 271698.272 m

W. $080^{\circ}16'44.746''$

COORDINATES ON MONITORING WELL PB 1534

STATE PLANE 83

NAD 83

N. 269569.891 m

N. $26^{\circ}45'53.983''$

E. 271711.347

W. $080^{\circ}16'44.273''$

WED. JUNE 15, 2005

EIDETASSIS

4-71

R. BLAIR

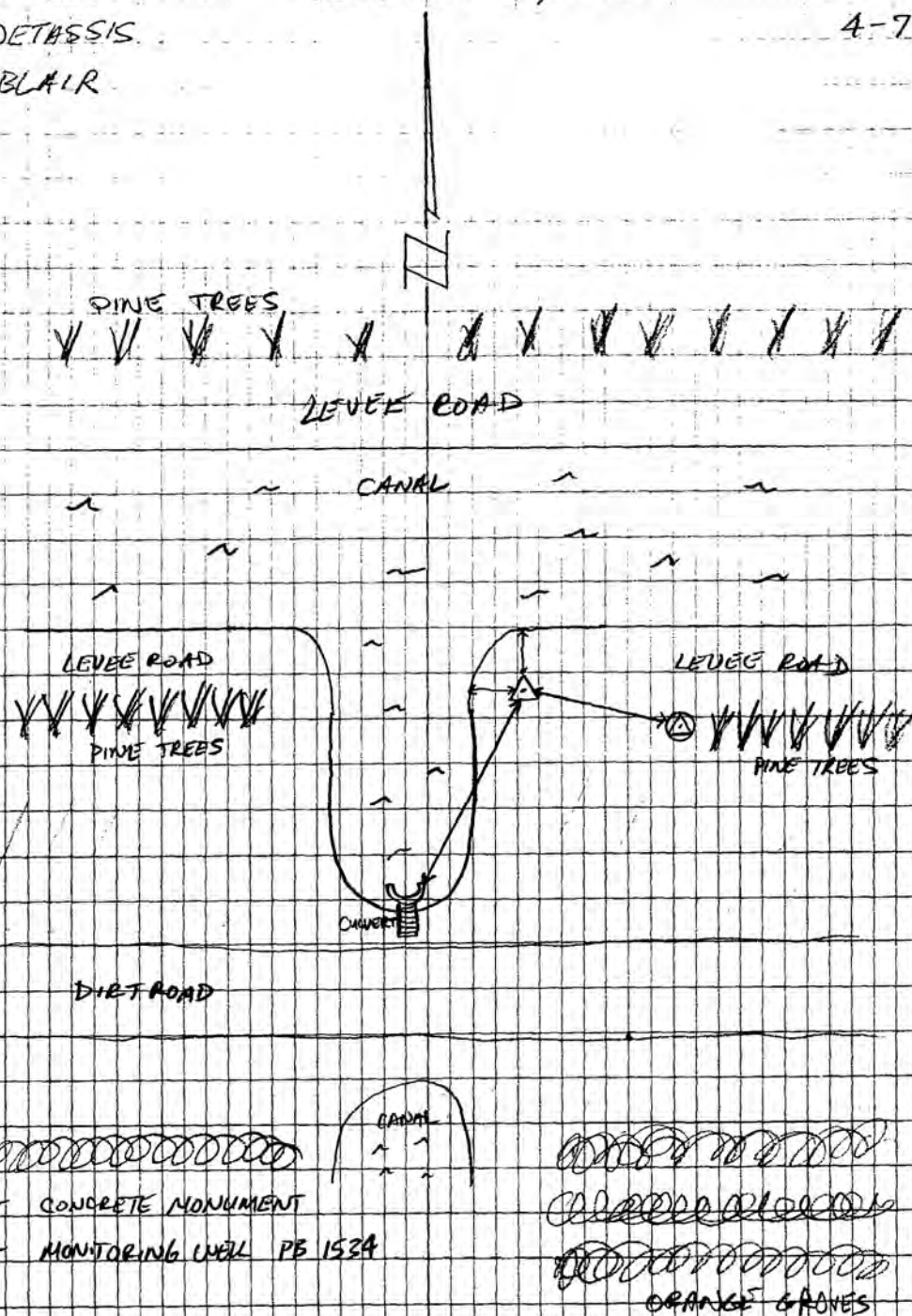



SOUTH FLORIDA WATER MANAGEMENT DISTRICT

Rev. 4/01

COUNTY	PALM BEACH		PROJECT	Hydrology – Palm Beach County Wells		DESIGNATION	PB 1534 2005	
SECTION	05		TOWNSHIP	43 SOUTH		RANGE	41 EAST	
GEOGRAPHIC INDEX OF QUAD								
Established by <u>Nick Miller Inc.</u> Recovered by				NAME OF QUADRANGLE West of Delta				
SURVEYOR <u>Stephen M. Gordon</u> DATE <u>7/28/2005</u>				FIELD BOOK <u>4</u> PAGE <u>71</u>				
HORIZONTAL DATUM: 1927 <input checked="" type="radio"/> 1983 Other _____ (circle one) ZONE <input checked="" type="radio"/> E or W								
STATE PLANE COORDINATES			E 891,395 ft			N 884,426 ft		
LATITUDE: N 26.76503°			LONGITUDE: W 80.27910°					
VERTICAL DATUM: MSL 1929 <input checked="" type="radio"/> 1988 Other _____ (circle one)						EL. 19.71 ft		
VERTICAL DATUM: MSL <input checked="" type="radio"/> 1929 1988 Other _____ (circle one)						EL. 21.18 ft		
CONTROL ACCURACY: HORIZONTAL 1 2 3 <input checked="" type="radio"/> SUB-METER (circle one) VERTICAL 1 2 <input checked="" type="radio"/> 3								
DESCRIPTION								
<p>To Reach:</p> <p>FROM INTERSECTION OF SEMINOLE PRATT WHITNEY ROAD & ORANGE BLVD. GO SOUTH ON SEMINOLE PRATT WHITNEY FOR 1.35 MILES TO SOUTH LEVEE ROAD OF M CANAL (934151) GO THROUGH LOCKED GATE WEST PALM BEACH WATER DEPARTMENT. GO EAST ON SOUTH LEVEE ROAD FOR 1.7 MILES. CONCRETE MONUMENT WILL BE ON RIGHT 47.7 FEET NORTHWEST OF MONITORING WELL PB 1534, 6.10 FEET SOUTH OF SOUTH TOP OF BANK OF M CANAL, 41.8 FEET NORTHEAST OF NORTHEAST CORNER OF BLACK CULVERT, 8.3 FEET EAST OF EAST TOP OF BANK OF M CANAL. SET MAGNET 1 FOOT NORTH OF CONCRETE MONUMENT.</p> <p>Benchmarks Used: R 537 and Q 537</p> <p>Notable Land marks:</p>								



SOUTH FLORIDA WATER MANAGEMENT DISTRICT

Rev. 4/01

SKETCH

1078

SFWMD

SET CONCRETE MONUMENT AT SITE
OF MONITORING WELL PB 1534

PB 1534

- SET Poured-IN-PLACE CONCRETE MONUMENT
- SET MAGNET 1' NORTH OF CONCRETE MONUMENT
- SET CONCRETE MONUMENT 47.70' NW OF MONITORING WELL PB 1534
- " " " 6.10' SOUTH OF SOUTH TOP OF BANK OF CANAL
- " " " 41.80' NW OF NE CORNER OF BLACK CULVERT
- " " " 8.3' EAST OF EAST TOP OF BANK OF CANAL

STAMPED PB 1534
2005

COORDINATES ON CONCRETE MON. PB 1534
STATE PLANE 83 WGS 84
N. 269573.980m N. 26°45'57" 119
E. 271698.272m W. 080°16'44" 746

COORDINATES ON MONITORING WELL PB 1534
STATE PLANE 83 WGS 84
N. 269569.891m N. 26°45'53" 983
E. 271711.347 W. 080°16'44" 273

WED. JUNE 15, 2005

E. DETASSIS
R. BLAIR

4-71

