

SFWMD

St Lucie County Wells

Work Order # C-C19901P-W010

STL 191

Well and Benchmark



WELL SITE: STL 191

WELL LOCATION:

N - 1133715

E - 873437

WELL ELEVATION:

6.606 (NAVD1988)

8.115 (NGVD1929)

BENCHMARK USED FOR THIS WELL SITE: SFWMD STL 191 2005

BENCHMARK LOCATION:

N - 1133680

E - 873453

BENCHMARK ELEVATION:

5.509 (NAVD1988)

7.018 (NGVD1929)

NOTES:

1. COORDINATES USED HEREON ARE REFERENCED TO THE STATE PLANE COORDINATE SYSTEM, FLORIDA EAST ZONE, NAD83/99 AND ARE IN U.S. SURVEY FEET.
2. ELEVATIONS WERE DETERMINED BY SECOND ORDER, CLASS 2 LEVELING FROM PUBLISHED NGS BENCHMARKS TO NEW BENCHMARKS ESTABLISHED AT THE WELL SITE. LEVELING IS BEING SUBMITTED TO NGS FOR INCLUSION INTO THE NGS DATABASE. **ELEVATIONS SHOWN HEREON ARE PRELIMINARY AND ARE SUBJECT TO CHANGE UPON EXCEPTANCE OF THE BLUE BOOK DATA INTO THE NGS DATABASE.**

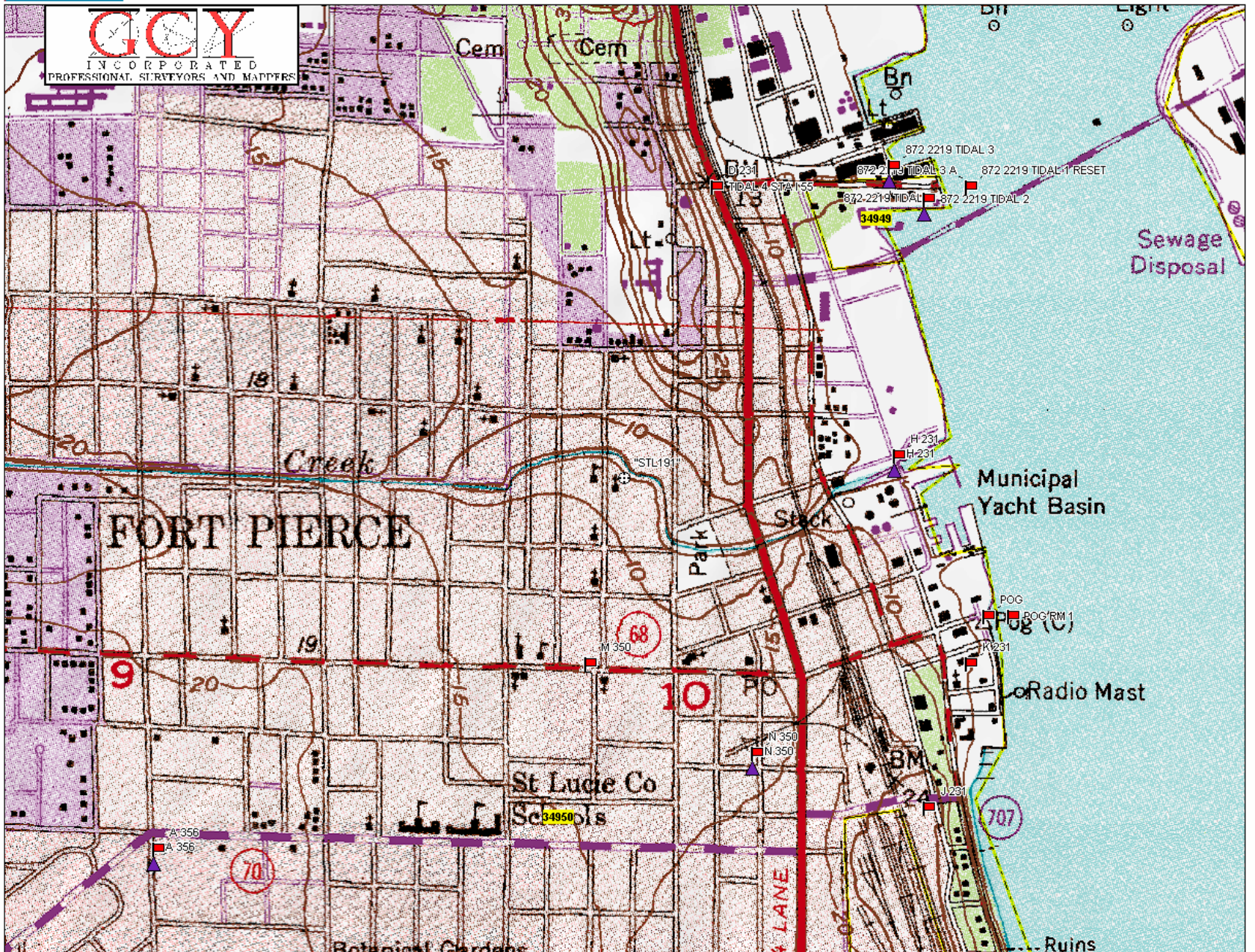

Data use subject to license.

© 2004 DeLorme. XMap® 4.5.

www.delorme.com



MN (5.7° W)



Data Zoom 14-0

STL 191

Fieldnotes

St. Lucie County Wells

BENCHMARK & WELL RECON
STL-191

WELL IS $520 \pm$ SOUTH OF AVE D
AND $975 \pm$ WEST OF NS 1 IN
FR. PIERCE.

RECOVERED BM "M 350" AS DESCRIBED
MAKE SURE PAINT IS CAREFULLY
SCRAPED FROM MARK.

RECOVERED BM "N 350" AS DESCRIBED

RUN N 350 TO M 350 TO STL 191
THEN BACK TO M 350

8-5-05

SORRA, TAVARES

SET $3\frac{1}{2}$ " BRASS DISK IN CONG. (3-8018 BASS IN
STANDARD "BELL SHAPED HOLE") 5" FIRM SURVEY MARKER
STL 191 2005

WMD
113A 11

02-10/10-25-01

6-25-2005

P. ANDERSON

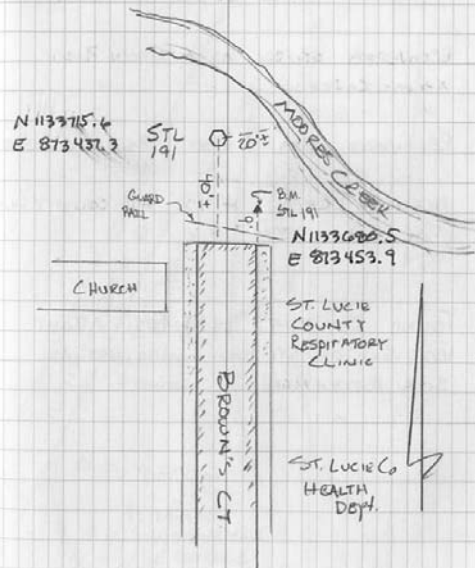

STL 191

Well



STL 191

Well



STL 191

Benchmark



STL 191

Benchmark



SURVEYOR'S REPORT

BENCHMARK AND WELL "STL 191"

1. Elevations shown herein are referenced to the North American Vertical Datum of 1988 (NAVD88) and are in represented in U.S. Survey Feet.
2. Elevations represented as NGVD 1929 (National Geodetic Vertical Datum of 1929) were determined from either the superceded values given on the NGS Datasheet downloaded from the NGS website or were determined using the "NGVD29.TXT" file. Vertcon **was not** used to transform NAVD88 elevations to NGVD29 values.
3. A Second Order Class II level run was performed to bring vertical control to newly constructed benchmarks at or near the specific well site. The data for level run is being submitted to NGS in "Blue-Book" format so that it will be included into the NGS database. Newly constructed benchmarks meet the NGS guidelines for a "Stability C" monument and have a SFWMD Survey Marker set in them.
4. A 3 wire – third order leveling was performed between the established benchmark and the existing well.
5. Vertical Control used for this Benchmark and Well are as follows:
H 231 (NGS PID AF3246)
N 350 (NGS PID AF6645)
6. Leveling for this site was performed on September 27, 2005.

Certification

(Not valid without the signature and original raised seal of a Florida licensed Surveyor and Mapper)

I hereby certify that the Specific Purpose Survey indicated hereon was completed under my direction. I further certify that this Survey meets the Minimum Technical Standards for Surveys set forth by the Florida Board of Professional Surveyors and Mappers in Chapter 61G17-6, Florida Administrative Code, pursuant to Section 472.027, Florida State Statutes.

Date of Survey _____

Date of Signature _____

Peter Andersen
Professional Survey and Mapper
Florida Certificate No. 5199