

III T STRICKLAND
 Ø GARDNER
 Ø SWANSON

COMMENTS SEC 7 TWP 35S RNG 36E

WELL # OKS 95 DP1 EAST MOST 6" PVC WELL
 0.9' ABOVE GRND X MARK WEST SIDE
 ON

B.M. 68-3 PG-74

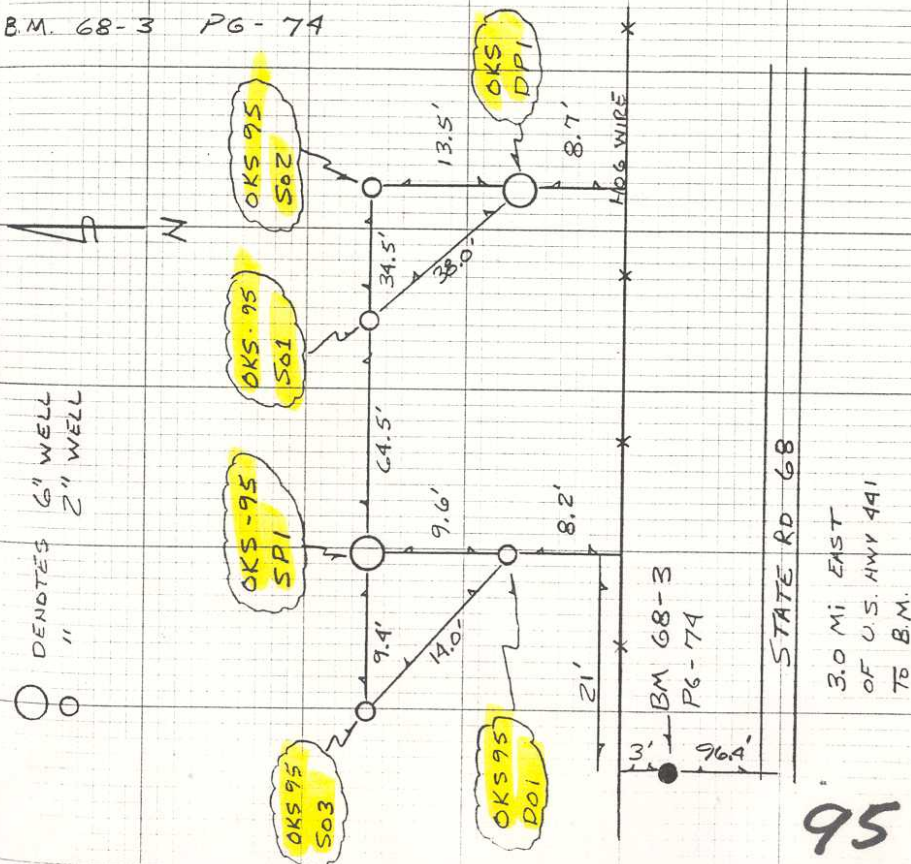

3.0 MI EAST
 OF U.S. HWY 441
 TO B.M.

95