



SOUTH FLORIDA WATER MANAGEMENT DISTRICT

Rev. 1/16

SCADA RTU Station Name: C43214A C43214B	DB Hydro Station Name: C43214G1 C43214G2	DB Hydro Site Name: C43214	Agency: S.F.W.M.D	Date of Field Work: 3/27/2019
Party Chief: EBANKS	Field Book: SCADA FB# 13	Page(s): 25	Prepared by: E. Ebanks	

SITE SPECIFIC DATA

Site Benchmark(s): PZ214A PZ214B	Benchmark Elevation(s) (NAVD88) 22.69feet 22.96feet	Corpscon 6.0.1 Conversion Factor (NAVD88 to NGVD29) +1.24 feet
Reference Elevation(s) (NAVD88): C43214A = 26.72 feet C43214B = 26.38 feet	Calibration Port Elevation(s) (NAVD88): N/A	
Ground Elevation (NAVD88): 22.7 feet	Pad Elevation (NAVD88): A = 23.39 feet, B = 23.04 feet	

GEOGRAPHIC DATA

Section 8	Township 44 South	Range 28 East	
Well(s) Gate(s) Benchmark(s)	Latitude: C43214A 26°39'58.0" C43214B 26 °39'58.0" State Plane Coordinates	Longitude: C43214A - 81°32'50.6" C43214B - 81°32'50.6" Northing (Y) = N/A	Source: Scaled pick point aerial esri product Easting (X) = N/A

Notes: **NAVD88** – North American Vertical Datum of 1988; **NGVD29**- National Geodetic Vertical Datum of 1929; **Corpscon 6.0.1** - A U.S. Army Corps of Engineers Engineering Research and Development Center Topographic Engineering Center Alexandria, Virginia Windows-based program to convert coordinates and elevations between datum's using vertcon05.txt and vertcon05.05 files supplied by the U.S. Army Corps of Engineers South Atlantic Division, Jacksonville FL.

PICTURES

Aerial of Overall Site
Not to scale (esri product)

C43214A
Latitude: **26°39'58.0"**
Longitude: **- 81°32' 50.6"**

Benchmark "**PZ214A**"
Latitude: **26°39'33.7"**
Longitude: **- 81°31'59.6"**
El. **22.69 feet NAVD88**

C43214B
Latitude: **26°39'58.0"**
Longitude: **- 81°32'50.6"**

Benchmark "**PZ214B**"
Latitude: **26°39'57.8"**
Longitude: **- 81°32'50.7"**
El. **22.96 feet NAVD88**



SOUTH FLORIDA WATER MANAGEMENT DISTRICT

Rev. 1/16

C43214 Piezometer Well Site

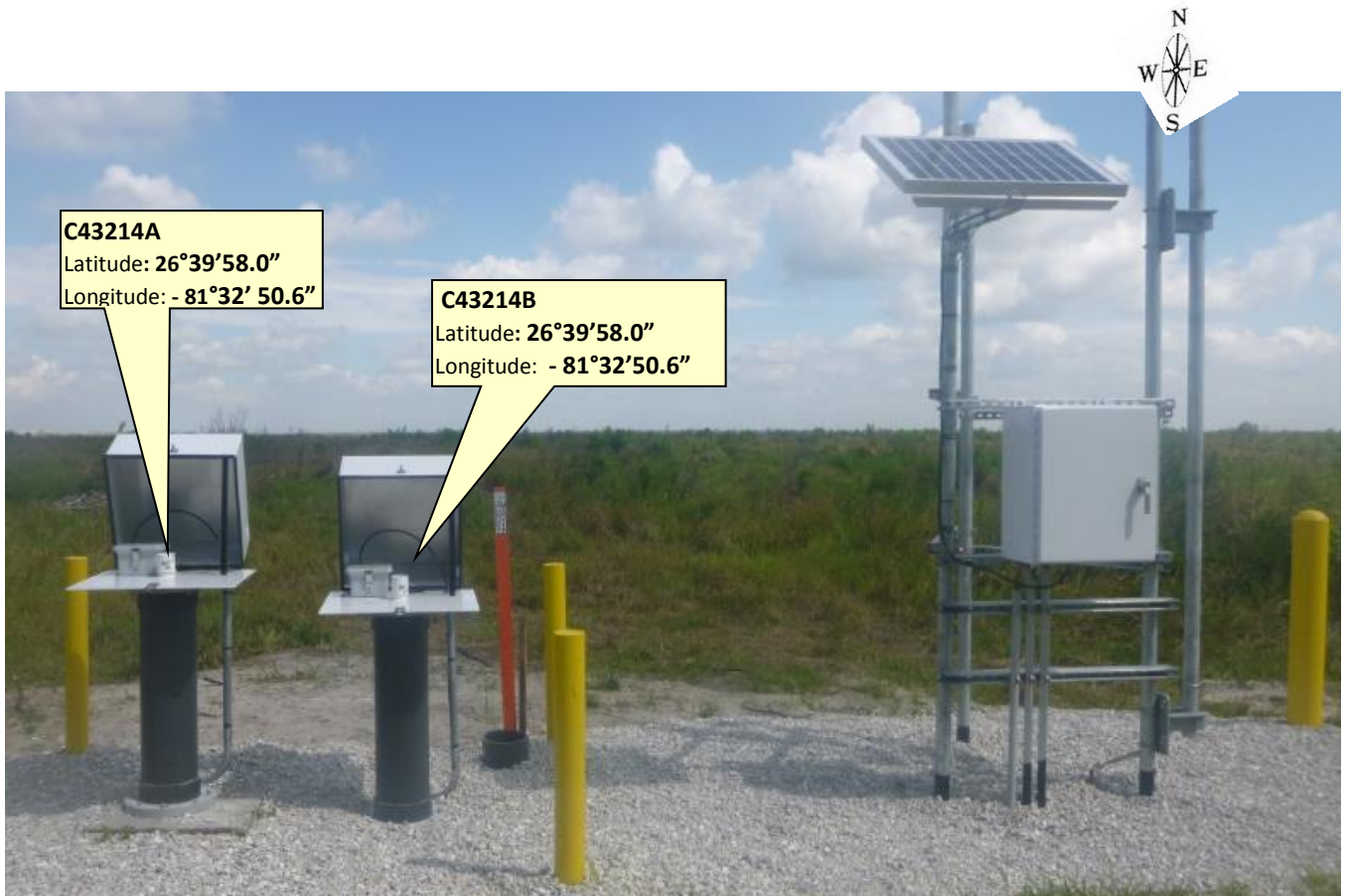



SOUTH FLORIDA WATER MANAGEMENT DISTRICT

Rev. 1/16

C43214 Piezometer Wells

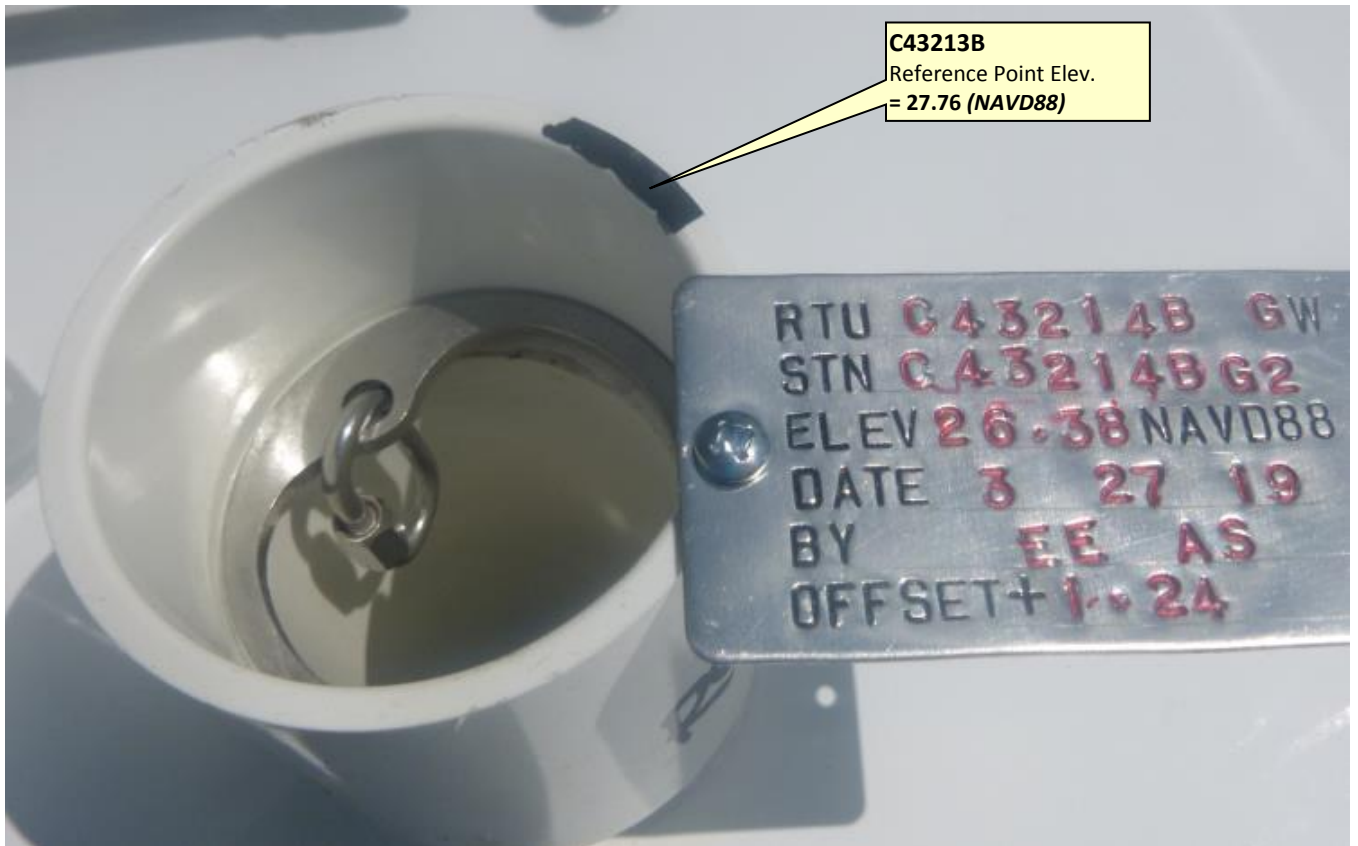
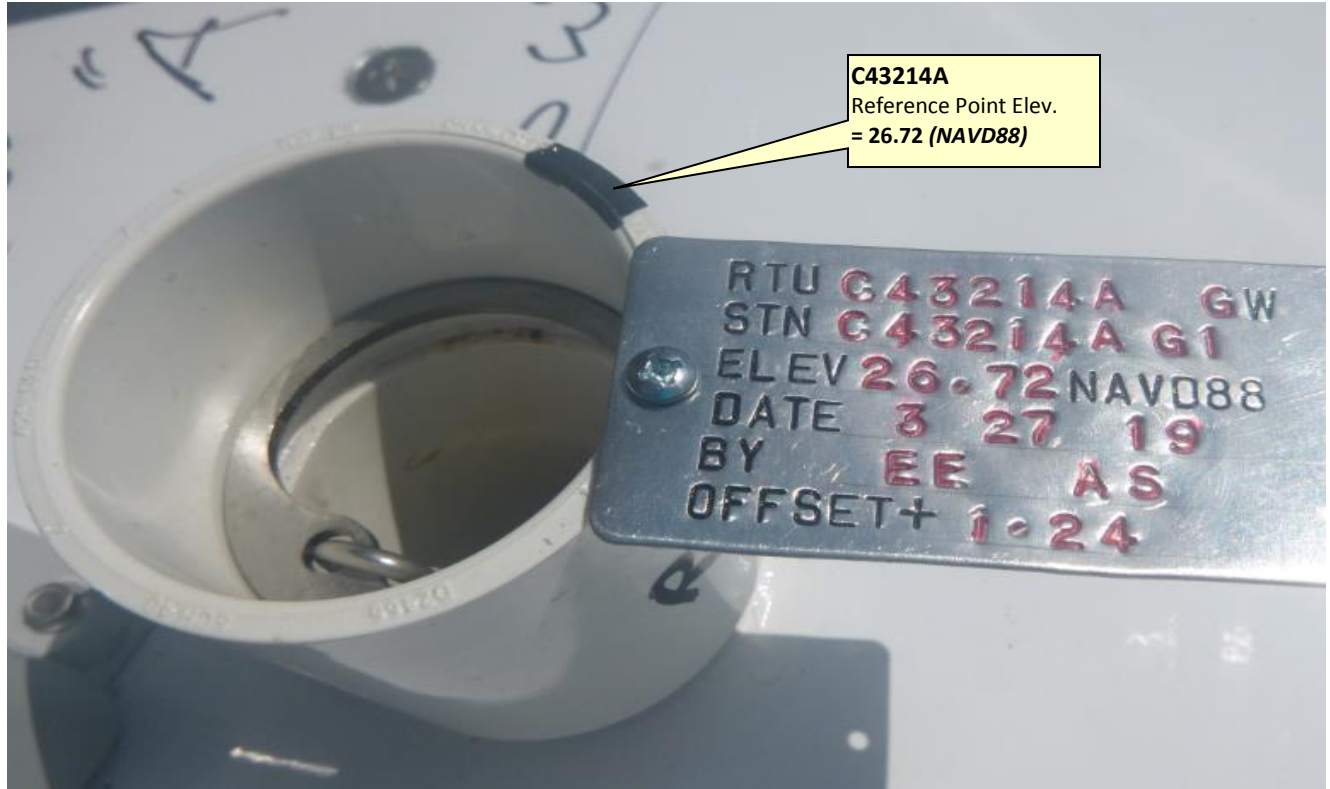



SOUTH FLORIDA WATER MANAGEMENT DISTRICT

Rev. 1/16

"PZ214A" Benchmark Location
Benchmark: El. **22.69 feet (NAVD88)**

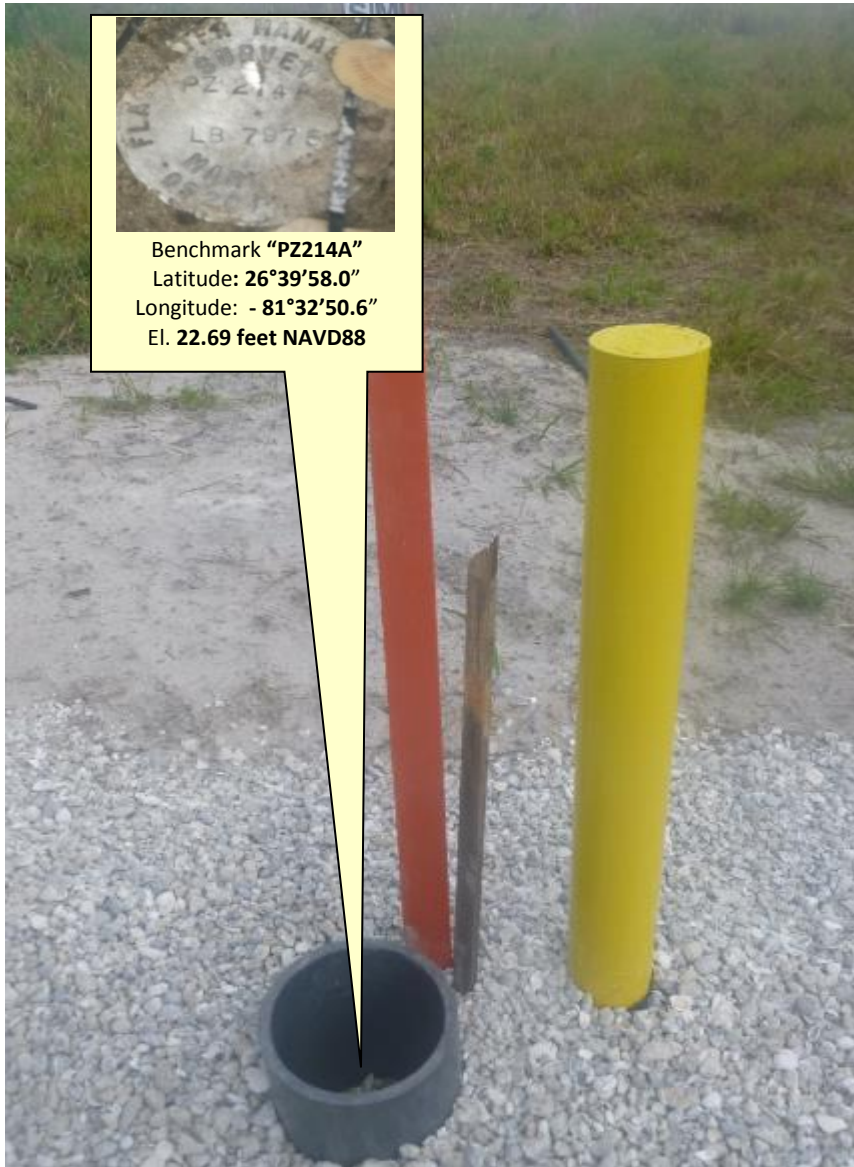



SOUTH FLORIDA WATER MANAGEMENT DISTRICT

Rev. 1/16

"PZ214B" Benchmark Location Benchmark: El. 22.96 feet (NAVD88)

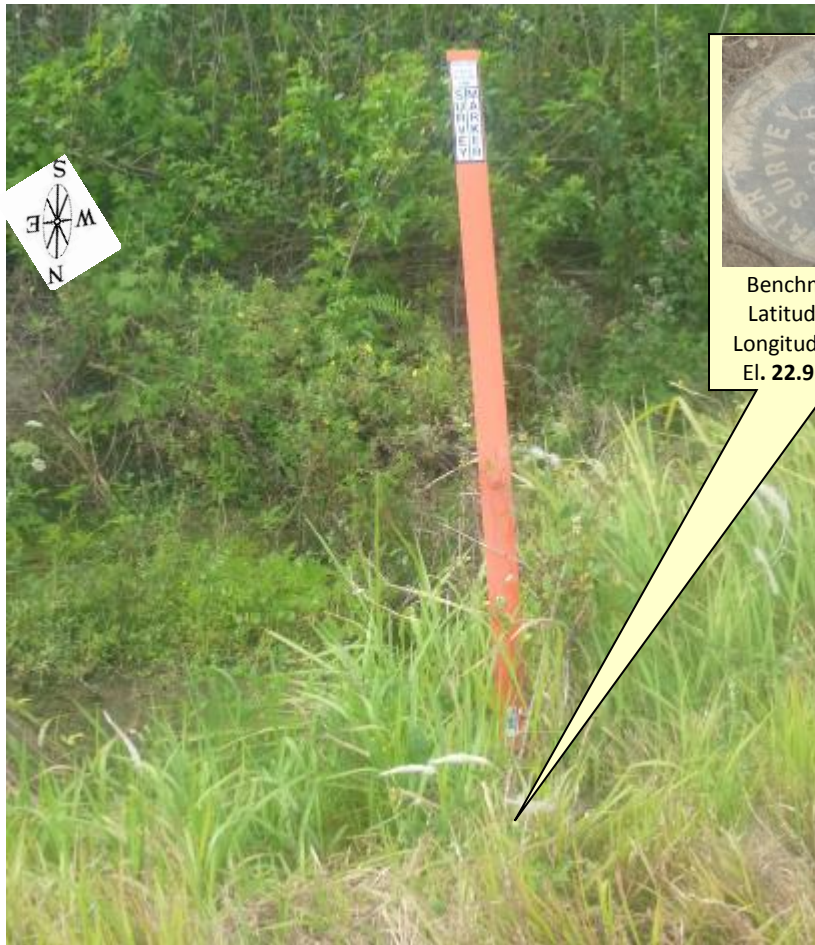

Benchmark "PZ214B"
Latitude: 26°39'57.8"
Longitude: -81°32'50.7"
El. 22.96 feet NAVD88



Benchmark "PZ214B"
Latitude: 26°39'57.8"
Longitude: - 81°32'50.7"
El. 22.96 feet NAVD88



SOUTH FLORIDA WATER MANAGEMENT DISTRICT

Rev. 1/16

"PZ214A" Benchmark Datasheet (1 of 1)



SOUTH FLORIDA WATER MANAGEMENT DISTRICT

Rev. 8/07

DESIGNATION: PZ 214A		PROJECT: C-43 VERTICAL CONTROL SURVEY FOR PIEZOMETER WELLS	
ESTABLISHED BY: J. HAYWOOD		SURVEYOR: SCOTT URQUHART	
RECOVERED BY		DATE: FEBRUARY 19, 2018	
GEOGRAPHIC POSITION			
SECTION: 8	TOWNSHIP: 44 SOUTH	RANGE: 28 EAST	
COUNTY: HENDRY	NAME OF QUADRANGLE: ALVA		
GEOGRAPHIC INDEX OF QUAD:			
HORIZONTAL DATUM: 1927 (1983) Other _____ (circle one) ZONE (E) or W			
VERTICAL DATUM: MSL 1929 (1988) Other N/A (circle one)			
CONTROL ACCURACY: HORIZONTAL 1 2 (3) _____ (circle one) VERTICAL 1 2 (3) N/A			
STATE PLANE COORDINATES	X = 477399.3	Y = 848184.8	NAVD 88 ELEV. 22.69' NGVD 29 ELEV. 23.94'
LATITUDE = N26° 39' 57.98"		LONGITUDE = W81° 32' 50.62"	
RECOVERY DESCRIPTION			
Stamping: POURED IN PLACE CONCRETE MONUMENT WITH ALUMINIUM DISK SO. FLA. WATER MANAGEMENT DIST. "PZ 214A LB 7975 2018"			
To Reach: To reach the station from the intersection of S.R. 80 and West Cowboy Way, Go along S.R. 80 SW for 3.9 miles to Congen Rd. on the left. Go along Congen Rd. South 0.14 miles to gate (SFWMD Lock) continue South 0.4 miles to the intersection of an East-West dirt road. Thence go West along dirt road for 3.0 miles to the junction of a North-South dirt road. Thence South along the dirt road for 2.0 miles to a junction with a dirt road to the East. Thence go East, along the dirt road, for 0.65 miles, to a junction with a North-South dirt road. Thence South, along the dirt road, for a distance of 0.45 miles, to a curve to the right (West). Thence West, along a dirt road, for 0.1 miles to a mark on the left.			
Notable Land marks: PZ 214A, is a poured in place concrete monument with an aluminum disk that is 23 ft. North of the top of bank of an East-West canal. 5.50 ft. North of the southeast bollard around wells. 0.8 ft. southwest of the northeast bollard around wells.			
FIELD BOOK: 510		PAGE: 32	



SOUTH FLORIDA WATER MANAGEMENT DISTRICT

Rev. 1/16

"PZ214B" Benchmark Datasheet (1 of 1)



SOUTH FLORIDA WATER MANAGEMENT DISTRICT

Rev. 8/07

DESIGNATION: PZ 214B		PROJECT: C-43 VERTICAL CONTROL SURVEY FOR PIEZOMETER WELLS	
ESTABLISHED BY: J. HAYWOOD		SURVEYOR: SCOTT URQUHART	
RECOVERED BY		DATE: FEBRUARY 19, 2018	
GEOGRAPHIC POSITION			
SECTION: 8	TOWNSHIP: 44 SOUTH	RANGE: 28 EAST	
COUNTY: HENDRY	NAME OF QUADRANGLE: ALVA		
	GEOGRAPHIC INDEX OF QUAD:		
HORIZONTAL DATUM: 1927 (1983) Other _____ (circle one) ZONE (E) or W			
VERTICAL DATUM: MSL 1929 (1988) Other N/A (circle one)			
CONTROL ACCURACY: HORIZONTAL 1 2 (3) _____ (circle one) VERTICAL 1 2 (3) N/A			
STATE PLANE COORDINATES	X = 477395.2	Y = 848163.9	NAVD 88 ELEV. 22.96' NGVD 29 ELEV. 24.21'
LATITUDE = N26° 39' 57.77"		LONGITUDE = W81° 32' 50.66"	
RECOVERY DESCRIPTION			
Stamping: POURED IN PLACE CONCRETE MONUMENT WITH ALUMINIUM DISK SO. FLA. WATER MANAGEMENT DIST. "PZ 214B LB 7975 2018"			
To Reach: To reach the station from the intersection of S.R. 80 and West Cowboy Way, Go along S.R. 80 SW for 3.9 miles to Congen Rd. on the left. Go along Congen Rd. South 0.14 miles to gate (SFWMD Lock) continue South 0.4 miles to the intersection of an East-West dirt road. Thence go West along dirt road for 3.0 miles to the junction of a North-South dirt road. Thence South along the dirt road for 2.0 miles to a junction with a dirt road to the East. Thence go East, along the dirt road, for 0.65 miles, to a junction with a North-South dirt road. Thence South, along the dirt road, for a distance of 0.45 miles, to a curve to the right (West). Thence West, along a dirt road, for 0.1 miles to a mark on the right.			
Notable Land marks: PZ 214B is a poured in place concrete monument with an aluminum disk that is 16.30 ft. southwest of the southeast bollard around wells. 15.50 ft. southeast of the southwest bollard around wells. 2.0 ft. North of the top of bank of an East-West canal.			
FIELD BOOK: 510		PAGE: 32	



SOUTH FLORIDA WATER MANAGEMENT DISTRICT

Rev. 1/16

Field Notes (1 of 1)

25 SCADA FB # 13 3-27-19

SEC IWP RUC ESTABLISH REF. ELEV. FOR C-43 RESERVOIR
PIEZOMETER WELLS PZ214

E. SPANIK
G. SPANIK

SPZ	I	HI	—	ELEV	REMARKS
BM PZ214A	5.39	28.08	1.30	22.69	(MAY 2008)
GW1 = A				20.72	
GW2 = B			1.70	20.38	
CONC PAD A			4.69	23.39	
CONC PAD B			5.04	23.04	
GROUND N+20'			5.2	22.88	
GROUND W+20'			6.0	22.08	
GROUND S+20'			5.0	23.08	
GROUND E+20'			5.1	22.98	
BM PZ214B			5.1	22.98	
BM PZ214B	5.02	28.08	RT		
GW 2 = B			1.61	26.39	
GW 1 = A			1.28	26.72	
BM PZ214A			5.30	22.70	