

Identification_Information:
Citation:

**Darren Townsend
Cooner & Associates**

Citation_Information:
Originator: Darren Townsend(ed.)
Publication_Date: 20050518
Publication_Time: Unknown
Title: S. F. W. M. D. Well KEENANSVILLE
Series_Information:
Publication_Information:
Publication_Place: 20050518
Publisher: None
Online_Linkage: darrent@cooner.com
Larger_Work_Citation:
Citation_Information:
Series_Information:
Publication_Information:

Description:

Purpose

Abstract:
South Florida Water Management District
Well KEENANSVILLE
Purpose:
To establish NAVD 88 and NGVD 29 elevations on the
wells reference marks from nearby, existing benchmarks.

Supplemental_Information:
ACCOMPANYING DIGITAL FILES
KENANSVILLE.GEN , CORPSMET95 FILE
KENANSVILLE.DOC , BENCHMARK RECOVERY FORM
KENANSVILLE.PDF , SCANNED COPIES OF FIELD
NOTES, VERTCON CALCULATIONS (IF APPLICABLE)
AND LEAST SQUARES ADJUSTMENT
KENANSVILLE.PPT , POWER POINT FILES OF WELL
SITE PICTURES

Survey Date

Time_Period_of_Content:
Time_Period_Information:
Single_Date/Time:
Range_of_Dates/Times:
Beginning_Date: 20050121
Ending_Date: 20050328
Multiple_Dates/Times:
Currentness_Reference: Publication Date

Status:

Progress: Complete
Maintenance_and_Update_Frequency: Unknown

Spatial_Domain:

Bounding_Coordinates:
West_Bounding_Coordinate: -081°01' 05.89"
East_Bounding_Coordinate: -081°01' 05.88"
North_Bounding_Coordinate: +27°53' 19.06"
South_Bounding_Coordinate: +27°53' 19.05"

Keywords:

Theme:
Theme_Keyword_Thesaurus: None
Theme_Keyword: Record Survey
Theme_Keyword: Well Site
Place:
Place_Keyword_Thesaurus: None
Place_Keyword: SFWDM WELL KEENANSVILLE
Place_Keyword: SEC. 10, TWP 30 S, RGE 33 E
Place_Keyword: OSCEOLA COUNTY, FL

Stratum:

Temporal:

Access_Constraints: None

Use_Constraints:

The wells have keyed or combination locks.
See point of contact for key or combination.

Point_of_Contact:

Contact_Information:
Contact_Person_Primary:
Contact_Person: Elvie D. Ebanks
Contact_Organization: South Florida Water Management

**Elvie Ebanks
SFWMD**

District

Contact_Organization_Primary:
 Contact_Position: Professional Surveyor & Mapper
 Contact_Address:
 Address_Type: mailing and physical address
 Address: 3301 Gun Club Road
 City: West Palm Beach
 State_or_Province: Florida
 Postal_Code: 33406
 Country: USA
 Contact_Voice_Telephone: (561) 753-2400, Ext. 4717
 Contact_Electronic_Mail_Address: eebanks@sfwmd.gov
 Hours_of_Service: 8:00 am to 5:00 pm EST

Security_Information:

Cross_Reference:

Citation_Information:

Series_Information:

Publication_Information:

Data_Quality_Information:

Attribute_Accuracy:

Attribute_Accuracy_Report:

The horizontal location of the wells and benchmark was performed using differentially corrected TRIMBLE GPS PATHFINDER PRO XR receiver. The vertical data was collected using a LEICA NA3003 electronic digital level. Coordinates are based on the Florida State Plane Coordinate System, East Zone, NAD 83/99. Elevations are based on NAVD 88.

Equipment Used

Logical_Consistency_Report:

Horizontal data was established using differentially corrected GPS signals from U.S. Coast Guard Beacon at Cape Canaveral. Vertical data was established using existing NGS control points S495, D198 and G198.

Completeness_Report:

Horizontal location taken at approximate center of well.

Project Results

Well KEENANSVILLE
 Lat. +27°53'19.06"
 Long. -081°01'05.89"
 N 1292209.96'
 E 650254.77'

Elevation taken on top of pipe extending vertically above the well platform at the tip of a black arrow.

New leveled elevations.

78.10' (NAVD 88)

79.32' (NGVD 29) calculated using 1.22' offset value based on

difference between superseded survey control NAVD88 and NGVD29 elevations as posted on existing NGS data sheet for benchmarks D198 and G198.

NEW SITE BENCHMARK

KEEN5 is a standard SFWMD aluminum disk set in top of a class "C" concrete monument, flush with the ground. A magnet was set on the south side of the mark. To reach the mark from the intersection of US Highway 441 and State Road 523, head west along SR 523 for 1.6 miles To a steel gate on the right. Go through the gate, heading north along an asphalt road. Follow road taking a left at a Large pond, heading west to the mark on the right, inside a fenced in well enclosure. Mark is 23', bearing 50°E, from a north-south barbed wire fence and 10' bearing N 41°E from a monitoring well

Lat. +27°53'19.05"

Long. -081°01'05.88"

N 1292213.75'

E 650255.34'

74.61' (NAVD 88)

75.83' (NGVD 29) calculated using 1.22' offset value based on

difference between superseded survey control

KENSVL.gen

NAVD88 and NGVD29 elevations as posted on existing
NGS data sheet for benchmarks D198 and G198.

Positional_Accuracy:

Horizontal_Positional_Accuracy:

Horizontal

Horizontal_Positional_Accuracy_Report:

The horizontal positions of the well and benchmark
KEEN5 were established with differentially
corrected GPS signals from U.S. Coast Guard Beacon at
Cape Canaveral.

Quantitative_Horizontal_Positional_Accuracy_Assessment:

Horizontal_Positional_Accuracy_Value: sub meter

Horizontal_Positional_Accuracy_Explanation: The intended

positional accuracy for this survey is sub meter.

Vertical_Positional_Accuracy:

Level Line

Vertical_Positional_Accuracy_Report:

AA Level Line was run originating on NGS benchmark S495
with an NAVD 88 elevation and running through
existing NGS benchmark D198 and through new
site benchmark KEEN5 and terminating on NGS
benchmark G198 in accordance with Florida Minimum
Technical Standards (Chapter 61G17-6). The well platform
was then elevated by a level line originating on new site
benchmark KEEN5 with an newly established NAVD 88
elevation running through mark on well platform and
terminating on new site benchmark KEEN5 in accordance
with Florida Minimum Technical Standards (Chapter
61G17-6).

Quantitative_Vertical_Positional_Accuracy_Assessment:

Vertical_Positional_Accuracy_Value: 0.012 ft

run, 0.012 ft closure in 19852.5 ft, max. allowed 0.058 ft (MTS)

Quantitative_Vertical_Positional_Accuracy_Assessment:

Vertical_Positional_Accuracy_Value: 0.001 ft

run, 0.001 ft closure in 91.7 ft, max. allowed 0.004 ft (MTS)

Lineage:

Source_Information:

Source_Citation:

Citation_Information:

Series_Information:

Publication_Information:

Larger_Work_Citation:

Citation_Information:

Series_Information:

Publication_Information:

Source_Time_Period_of_Content:

Time_Period_Information:

Single_Date/Time:

Range_of_Dates/Times:

Multiple_Dates/Times:

Process_Step:

Process_Description:

The horizontal work was performed using a Trimble GPS
Pathfinder Pro XR receiver using U.S. Coast Guard
beacon at Cape Canaveral. The level line was performed
using a Leica NA3003 electronic digital level.

Process_Date: 20050422

Process_Contact:

Contact_Information:

Contact_Person_Primary:

Contact_Organization_Primary:

Contact_Address:

Spatial_Data_Organization_Information:

Spatial_Reference_Information:

Horizontal_Coordinate_System_Definition:

Geographic:

Planar:

Map_Projection:

Albers_Conical_Equal_Area:

Azimuthal_Equidistant:

- KENSVL_gen
- Equidistant_Conic:
- Equiangular:
- General_Vertical_Near-sidereal_Perspective:
- Gnomonic:
- Lambert_Azimuthal_Equal_Area:
- Lambert_Conformal_Conic:
- Mercator:
- Modified_Stereographic_for_Alaska:
- Miller_Cylindrical:
- Oblique_Mercator:
 - Oblique_Line_Point:
- Orthographic:
- Polar_Stereographic:
- Polyconic:
- Robinson:
- Sinusoidal:
- van_der_Grinten:
- Space_Oblique_Mercator_(Landsat):
- Stereographic:
- Transverse_Mercator:
- van_der_Grinten:
- Grid_Coordinate_System:
 - Universal_Transverse_Mercator:
 - Transverse_Mercator:
 - Universal_Polar_Stereographic:
 - Polar_Stereographic:
 - State_Plane_Coordinate_System:
 - Lambert_Conformal_Conic:
 - Transverse_Mercator:
 - Oblique_Mercator:
 - Oblique_Line_Point:
 - Polyconic:
 - ARC_Coordinate_System:
 - Equiangular:
 - Azimuthal_Equidistant:
- Local_Planar:
 - Planar_Coordinate_Information:
 - Coordinate_Representation:
 - Distance_and_Bearing_Representation:
- Local:
 - Geodetic_Model:
 - Horizontal_Datum_Name: North American Datum of 1983
 - Ellipsoid_Name: Geodetic Reference System 80
 - Vertical_Coordinate_System_Definition:
 - Altitude_System_Definition:
 - Depth_System_Definition:
- Entity_and_Attribute_Information:
 - Detailed_Description:
 - Entity_Type:
 - Attribute:
 - Attribute_Domain_Values:
 - Attribute_Value_Accuracy_Information:
 - Overview_Description:
 - Distribution_Information:
 - Distributor:
 - Contact_Information:
 - Contact_Person_Primary:
 - Contact_Organization_Primary:
 - Contact_Address:
 - Standard_Order_Process:
 - Digital_Form:
 - Digital_Transfer_Information:
 - Digital_Transfer_Option:
 - Online_Option:
 - Computer_Contact_Information:
 - Network_Address:
 - Display_Instructions:
 - Offline_Option:
 - Recording_Capacity:

KENSVL.gen

Time_Period_Information:

Single_Date/Time:

Range_of_Dates/Times:

Multiple_Dates/Times:

Metadata_Reference_Information:

Metadata_Date: 20050518

Metadata_Contact:

Contact_Information:

Contact_Person_Primary:

Contact_Person: Darren Townsend

Contact_Organization: Cooner & Associates, Inc.

Contact_Organization_Primary:

Contact_Position: Project Surveyor

Contact_Address:

Address_Type: mailing and physical address

Address: 5670 Zip Drive

City: Fort Myers

State_or_Province: Florida

Postal_Code: 33905

Country: USA

Contact_Voice_Telephone: (239) 277-0722

Contact_Facsimile_Telephone: (239) 277-7179

Contact_Electronic_Mail_Address: darrent@cooner.com

Hours_of_Service: 8:00 am to 5:00 pm EST

Metadata_Standard_Name: FGDC Content Standards for Digital Geospatial Metadata

Metadata_Standard_Version: 19980601

Metadata_Security_Information:

KEENANSVILLE



- COONER & ASSOCIATES, INC.
 - Date of photo: January 21, 2005
- View: Looking North at BM KEEN5

KEENANSVILLE



- COONER & ASSOCIATES, INC.
 - Date of photo: January 21, 2005
- View: Looking at top view of BM KEEN5

KEENANSVILLE



- COONER & ASSOCIATES, INC.
- Date of photo: January 21, 2005
 - View: Looking North at well

KEENANSVILLE



- COONER & ASSOCIATES, INC.
- Date of photo: January 21, 2005
- View: Looking at Elevation mark on well

020801.03

SFWMD
Kenanville

Benchmark Recovery Notes

G198 - Mark Recovered In Good Condition

D198 - Mark Recovered In Good Condition

E198 - Mark Recovered In Good Condition.

School Is Now An Abandoned Library

S495 - Mark Recovered In Good Condition

Z60 - Mark Not Found

H198 - Mark Not Found. Headwall and Culvert
Gone

N435 - Mark Not Found. Area Where Mark
Was Supposed To Be Has Been Paved

1/21/05

F081

PG27

Etgeton

Z. Amam Collins

020801.03

SFWMD

Kenansville

A-Well site

N-1292209.96'

E-650254.77'

EK

B-Set 3" Aluminum Disk In ~12" Poured Concrete Monument

"SO. FLA. WATER MANAGEMENT DIST."

N-1292213.75'

E-650255.34'

EK

Florida State PWWS, EAST ZONE

1/21/05

FB81

PG28

Etgeton

Z. Amann

Collins

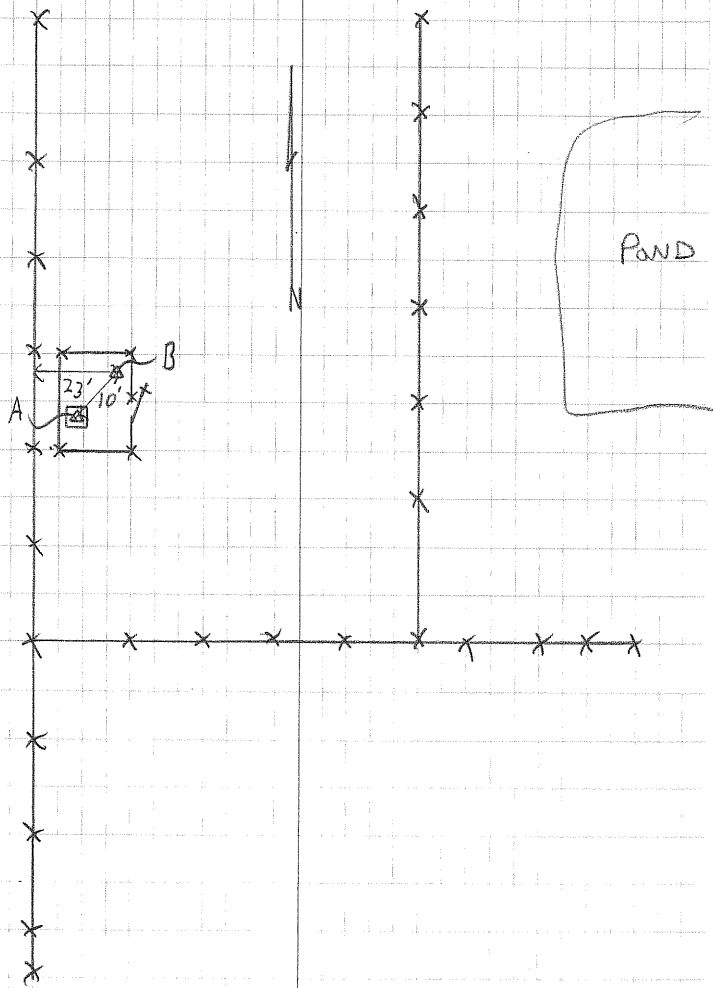

020801.03	SFWMO				
Card* 2, Run 3			EL	Adj. EL	PT#
4.348			76.62		Start
	80.968				
3.324		6.760	74.208		1
	77.532				
4.053		5.408	72.124		2
	76.117				
4.952		4.557	71.620		3
	76.572				
5.439		4.330	72.242		4
	77.681				
4.457		4.415	73.266		5
	77.723				
4.136		4.124	73.599		6
	77.735				
4.154		5.088	72.647		7
	76.801				
5.459		5.332	71.469		8
	76.928				
5.072		4.282	72.646		9
	77.718				
		3.138	74.580		10

1/21/05

FB81

PG 29

Etgeton

z. Annam Collins

Description
 Found 4" Brass Disk In ~12" Poured Concrete Monument
 "U.S. COAST + GEODETIC SURVEY G198 1960"

TP (60D Nail)

TP (60D Nail)

TP (60D Nail)

TP (60D Nail)

TP (60 DNail)

TP (60D Nail)

TP (60D Nail)

TP (60D Nail)

TP (60D Nail)

Set 3" Aluminum Disk In ~12" Poured Concrete Monument
 "SD. FLA. WATER MANAGEMENT DIST."

VOID

SEE PAGE 35

020801.03

SFWMO

Kenansville

+	HI	-	EL	Adj EL	PT #
3.617			74.580		10
	78.197				
4.700		5.807	72.390		11
	77.090				
5.115		5.266	71.824		12
	76.939				
4.299		4.992	71.947		13
	76.246				
4.725		3.542	72.704		14
	77.429				
3.944		3.944	73.485		15
	77.429				
4.225		4.189	73.240		16
	77.465				
3.572		5.290	72.175		17
	75.747				
5.618		4.246	71.501		18
	77.119				
7.376		5.481	71.638		19
	79.014				
4.902		2.688	76.326		20
	81.228				

1/24/05

FB 81

P630

Egerton
Collins

Description

Set 3" Aluminum Disk In ~12" Poured Concrete Monument
"SO. FLA WATER MANAGEMENT DIST."

TP

TP

TP

TP

TP

TP

TP

TP

TP

TP

VOID - SEE PAGE 35

020801.03

SFWMD

Kenansville

HI = 81.228

+	HI	-	EL	Adj EL	PT#
4.598	80.479	5.347	75.881		21
4.337	80.013	4.803	75.676		22
3.423	78.270	5.166	74.847		23
3.801	76.044	6.027	72.243		24
4.244	75.497	4.791	71.253		25
4.509	75.529	4.477	71.020		26
4.514	75.620	4.423	71.106		27
6.381	77.040	4.961	70.659		28
4.569	75.818	5.791	71.249		29
4.539	75.682	4.675	71.143		30
4.376	75.729	4.329	71.353		31

1/24/05

FB 81

PG 31

Etgeton
Collins

Description

TP

TP

TP

TP

TP

TP

TP

TP

TP

TP

TP

VOID - SEE PAGE 35

02080103		SFWMD			
		Kenansville			
HI=75.729					
+	HI	-	EL	Adj. EL	PT#
1.308		1.669	74.060		32
	75.368				
3.933		4.510	70.858		33
	74.791				
4.351		4.669	70.122		34
	74.473				
5.223		4.334	70.139		35
	75.362				
5.318		3.797	71.565		36
	76.883				
4.653		4.414	72.469		37
	77.022				
5.198		4.595	72.527		38
	77.725				
4.687		5.336	72.389		39
	77.076				
4.467		4.466	72.610		40
	77.077				
4.560		4.963	72.114		41
	76.674				
		6.717	69.957		42
			(Ported 70.02)		

1/24/05

FB81

Pg 32

Etgeon
Collins.

Description

Found 4" Brass Disk Set Vertically In Northeast Corner
of Old Library Building. "U.S. Coast + Geodetic Survey
E198 1960"

TP

TP

TP

TP

Found 4" Brass Disk In ~12" Paired Concrete Monument
"U.S. Coast + Geodetic Survey D198 1960"

TP

TP

TP

TP

Found 3" Brass Disk In ~12" Paired Concrete Monument
"FLORIDA DEPARTMENT OF ENVIRONMENTAL PROTECTION
5495 2000"

VOID - SEE PAGE
35

020801.03

SFWMO
Kenansville

+	HI	-	EL	Adj EL	PT#
6.889			69.957		42
	76.846				
4.944		4.610	72.236		43
	77.180				
4.784		4.759	72.421		44
	77.205				
4.560		4.433	72.772		45
	77.332				
4.006		4.853	72.479		46
	76.485				
4.103		5.581	70.904		47
	75.007				
4.836		4.871	70.136		48
	74.972				
5.305		4.733	70.239		49
	75.544				
5.741		5.129	70.415		50
	76.156				
4.868		4.981	71.175		51
	76.043				
5.671		5.279	70.764		52
	76.435				

1/24/05

FB81

P633

Etgeton
Collins

Description

Found 3" Brass Disk In ~12" Poured Concrete Monument
"FLORIDA DEPARTMENT OF ENVIRONMENTAL PROTECTION
5495 2000"

TP

TP

TP

TP

TP

TP

TP

TP

TP

TP

VOID - SEE PAGE 35

020801.03

SFWMO

Kenansville

HI = 76.435

+	HI	-	EL	Adj. EL	PT#
3.956		4.833	71.602		53
	75.558				
4.518		4.728	70.830		54
	75.348				
4.955		4.449	70.899		55
	75.854				
5.760		4.132	71.722		56
	77.482				
5.264		3.146	74.336		57
	79.600				
4.544		3.740	75.860		58
5.202	80.404				
4.467		4.271	76.133		59
	81.335				
		4.792	76.543		60
			(Posted 76.62)		

1/24/05

F081

P634

Etzeton
CollinsDescription
TP

TP

TP

TP

TP

TP

TP (PK + Disk "CONT PT LB6773")

Found 4" Brass Disk In ~12" Poured Concrete Monument
"U.S. COAST + GEODETIC SURVEY G198 1960"

VOID - SEE PAGE 35

020801.03	SFWMD				
Card #1, Run 1	Kenansville				
+	HI	-	EL	Adj EL	PT#
7.251			70.02'	NAUG 88	100
	77.271				
4.903		4.960	72.311		1
	77.214				
4.539		4.592	72.622		2
	77.161				
4.506		4.324	72.837		3
	77.343				
4.519		4.631	72.712		4
	77.231				
4.538		4.708	72.523	72.52'	105
	77.061				
3.982		5.572	71.489		6
	75.471				
4.806		5.218	70.253		7
	75.059				
4.514		4.505	70.554		8
	75.068				
4.896		3.825	71.243		9
	76.139				
4.252		4.843	71.296		10
	75.548				

1/25/05

FB81

Pg 35

Etgeton
Collins

Description

Found 3" Brass Disk In ~12" Poured Concrete Monument
" FLORIDA DEPARTMENT OF ENVIRONMENTAL PROTECTION

~~S498~~ 2000" S495" PID # A57636
AJ7636

TP

TP

TP

TP

Found 4" Brass Disk In ~12" Poured Concrete Monument
" U.S. COAST + GEODETIC SURVEY D198 1960"

TP

TP

TP

TP

TP

020801.02

SFWMO

Kenansville

HI=75.548

+	HI	-	EL	Adj EL	PT#
4.496	75.829	4.215	71.333		11
3.879	75.546	4.162	71.667		12
4.156	75.386	4.316	71.230		13
4.095	75.558	3.923	71.463		14
6.239	78.254	3.543	72.015		15
5.317	80.297	3.274	74.980		16
4.428	80.567	4.158	76.139		17
4.981	81.189	4.359	76.209		18
2.952	78.882	5.259	75.930		19
3.938	76.652	6.168	72.714		20
4.795	76.137	5.310	71.342		21

1/25/05

FB81

PG-36

Etgeton
Collins

Description

TP

TP

TP

TP

TP

TP

TP

TP

TP

TP

TP

020801.03		SFWMO Kenansville			
+	HI	-	EL	Adj. EL	PT#
5.267	78.628	4.695	73.361		33
4.886	78.088	5.426	73.202		34
3.859	76.677	5.270	72.818		35
4.764	76.287	5.154	71.523		36
4.905	77.202	3.490	72.297		37
6.509	81.616	2.095	75.107		38
		4.985	76.631	76.62'	¹³⁹ 39
			(Posted 76.62')		

LINE LENGTH = 19852.5'

$$\begin{aligned} \text{ALLOWABLE MISCLOSURE} &= 0.03 \sqrt{\frac{19852.5}{5280}} \\ &= \pm 0.058' \end{aligned}$$

ACTUAL MISCLOSURE = 0.012'

1/25/05

1881

P638
Etgeton
Collins

Description
TP

TP

TP

TP

TP

TP

Found 4" Brass Disk In ~12" Poured Concrete Monument
"U.S. COAST + GEODETIC SURVEY G198 1960"
PID No. AFG163

020801.03

SFWMO

Kenansville (Well Elevation)

Cardi, Run 5

+	HI	-	EL	Adj EL	PT#
5.092			74.61'	NAVD 88	129
	79.702				
1.961		1.605	78.097	78.10'	201
	80.058				
		5.448	74.610	74.61'	129
			(74.61 Posted)		

LINE LENGTH = 91.7'

$$\text{Allowable Misclosure} = 0.03 \sqrt{91.7 / 5280}$$

$$= \pm 0.004$$

Actual Misclosure = -0.001'

3/28/05

FB 86

PAGE 54

Etgoton

Collins

Description

Set 2" Aluminum Disk In ~12" Poured Concrete Monument
"SO FLA. WATER MANAGMENT DIST BM KEEN'S"

Elevated Well AT Mark On Top of Pipe

Check In To Start Point

KENANSVILLE .raw

410001+?.1
110002+00000100 83..11+00070020
110003+00000100 32..01+00086330 331107+00072508 52..07+0003+009
110004+00000001 32..01+00269770 332107+00049600 52..07+0003+006
110005+00000001 573..1-00183440 574..1+00356100 83..01+00072311
110006+00000001 32..01+00284940 331107+00049028 52..07+0003+005
110007+00000002 32..01+00254890 332107+00045925 52..07+0003+008
110008+00000002 573..1-00153380 574..1+00895930 83..01+00072621
110009+00000002 32..01+00280230 331107+00045394 52..07+0003+018
110010+00000003 32..01+00288260 332107+00043238 52..07+0003+011
110011+00000003 573..1-00161420 574..1+01464420 83..01+00072837
110012+00000003 32..01+00137210 331107+00045060 52..07+0003+017
110013+00000004 32..01+00273130 332107+00046311 52..07+0003+005
110014+00000004 573..1-00297340 574..1+01874770 83..01+00072712
110015+00000004 32..01+00111670 331107+00045186 52..07+0003+004
110016+00000105 32..01+00076550 332107+00047077 52..07+0003+004
110017+00000105 573..1-00262210 574..1+02062990 83..01+00072523
110018+00000105 32..01+00180510 331107+00045381 52..07+0003+005
110019+00000006 32..01+00286190 332107+00055723 52..07+0003+023
110020+00000006 573..1-00367900 574..1+02529690 83..01+00071488
110021+00000006 32..01+00280190 331107+00039821 52..07+0003+029
110022+00000007 32..01+00284200 332107+00052176 52..07+0003+019
110023+00000007 573..1-00371910 574..1+03094070 83..01+00070253
110024+00000007 32..01+00324480 331107+00048056 52..07+0003+007
110025+00000008 32..01+00286820 332107+00045051 52..07+0003+045
110026+00000008 573..1-00334250 574..1+03705370 83..01+00070553
110027+00000008 32..01+00286840 331107+00045138 52..07+0003+035
110028+00000009 32..01+00263940 332107+00038252 52..07+0003+016
110029+00000009 573..1-00311350 574..1+04256140 83..01+00071242
110030+00000009 32..01+00283610 331107+00048955 52..07+0003+020
110031+00000010 32..01+00288870 332107+00048429 52..07+0003+009
110032+00000010 573..1-00316610 574..1+04828620 83..01+00071295
110033+00000010 32..01+00287680 331107+00042522 52..07+0003+014
110034+00000011 32..01+00278820 332107+00042149 52..07+0003+009
110035+00000011 573..1-00307750 574..1+05395130 83..01+00071332
110036+00000011 32..01+00303230 331107+00044955 52..07+0003+016
110037+00000012 32..01+00303680 332107+00041618 52..07+0003+005
110038+00000012 573..1-00308200 574..1+06002040 83..01+00071666
110039+00000012 32..01+00280790 331107+00038789 52..07+0003+004
110040+00000013 32..01+00260570 332107+00043164 52..07+0003+006
110041+00000013 573..1-00287980 574..1+06543410 83..01+00071228
110042+00000013 32..01+00280570 331107+00041556 52..07+0003+027
110043+00000014 32..01+00281790 332107+00039227 52..07+0003+014
110044+00000014 573..1-00289200 574..1+07105770 83..01+00071461
110045+00000014 32..01+00287160 331107+00040954 52..07+0003+013
110046+00000015 32..01+00275360 332107+00035428 52..07+0003+047
110047+00000015 573..1-00277390 574..1+07668280 83..01+00072014
110048+00000015 32..01+00322270 331107+00062388 52..07+0003+026
110049+00000016 32..01+00289150 332107+00032736 52..07+0003+007
110050+00000016 573..1-00244280 574..1+08279700 83..01+00074979
110051+00000016 32..01+00290140 331107+00053172 52..07+0003+030
110052+00000017 32..01+00241050 332107+00041577 52..07+0003+013
110053+00000017 573..1-00195190 574..1+08810890 83..01+00076139
110054+00000017 32..01+00294230 331107+00044284 52..07+0003+021
110055+00000018 32..01+00280300 332107+00043594 52..07+0003+022
110056+00000018 573..1-00181270 574..1+09385420 83..01+00076208
110057+00000018 32..01+00283150 331107+00049806 52..07+0003+010
110058+00000019 32..01+00226900 332107+00052588 52..07+0003+016
110059+00000019 573..1-00125020 574..1+09895470 83..01+00075929
110060+00000019 32..01+00191770 331107+00029525 52..07+0003+048
110061+00000020 32..01+00235430 332107+00061678 52..07+0003+032
110062+00000020 573..1-00168680 574..1+10322660 83..01+00072714
110063+00000020 32..01+00288290 331107+00039379 52..07+0003+042
110064+00000021 32..01+00229230 332107+00053103 52..07+0003+010
110065+00000021 573..1-00109620 574..1+10840180 83..01+00071342
110066+00000021 32..01+00286170 331107+00047945 52..07+0003+006
110067+00000022 32..01+00225730 332107+00041927 52..07+0003+021

KENANSVILLE.raw

110068+00000022	573..1-00049170	574..1+11352080	83..01+00071943
110069+00000022	32..01+00284380	331107+00051964	52..07+0003+010
110070+00000023	32..01+00242320	332107+00042900	52..07+0003+012
110071+00000023	573..1-00007110	574..1+11878790	83..01+00072850
110072+00000023	32..01+00282190	331107+00052188	52..07+0003+023
110073+00000024	32..01+00265790	332107+00039607	52..07+0003+046
110074+00000024	573..1+00009300	574..1+12426770	83..01+00074108
110075+00000024	32..01+00220790	331107+00042173	52..07+0003+007
110076+00000025	32..01+00261290	332107+00050233	52..07+0003+039
110077+00000025	573..1-00031200	574..1+12908840	83..01+00073302
110078+00000025	32..01+00295630	331107+00039700	52..07+0003+012
110079+00000026	32..01+00246120	332107+00056525	52..07+0003+011
110080+00000026	573..1+00018320	574..1+13450600	83..01+00071619
110081+00000026	32..01+00287290	331107+00056347	52..07+0003+021
110082+00000027	32..01+00266450	332107+00049743	52..07+0003+013
110083+00000027	573..1+00039160	574..1+14004330	83..01+00072280
110084+00000027	32..01+00280830	331107+00052815	52..07+0003+010
110085+00000028	32..01+00200230	332107+00047421	52..07+0003+010
110086+00000028	573..1+00119760	574..1+14485400	83..01+00072819
110087+00000028	32..01+00140170	331107+00047385	52..07+0003+009
110088+00000129	32..01+00112270	332107+00029363	52..07+0003+004
110089+00000129	573..1+00147660	574..1+14737840	83..01+00074621
110090+00000129	32..01+00112320	331107+00032204	52..07+0003+010
110091+00000030	32..01+00206860	332107+00053910	52..07+0003+031
110092+00000030	573..1+00053130	574..1+15057020	83..01+00072451
110093+00000030	32..01+00278070	331107+00046884	52..07+0003+023
110094+00000031	32..01+00300450	332107+00043936	52..07+0003+026
110095+00000031	573..1+00030750	574..1+15635540	83..01+00072745
110096+00000031	32..01+00301530	331107+00039814	52..07+0003+001
110097+00000032	32..01+00260060	332107+00048558	52..07+0003+008
110098+00000032	573..1+00072220	574..1+16197140	83..01+00071871
110099+00000032	32..01+00294690	331107+00061861	52..07+0003+012
110100+00000033	32..01+00283600	332107+00046950	52..07+0003+016
110101+00000033	573..1+00083310	574..1+16775420	83..01+00073362
110102+00000033	32..01+00239990	331107+00052667	52..07+0003+007
110103+00000034	32..01+00252860	332107+00054257	52..07+0003+011
110104+00000034	573..1+00070440	574..1+17268280	83..01+00073203
110105+00000034	32..01+00297250	331107+00048862	52..07+0003+023
110106+00000035	32..01+00244560	332107+00052702	52..07+0003+009
110107+00000035	573..1+00123130	574..1+17810080	83..01+00072819
110108+00000035	32..01+00286710	331107+00038587	52..07+0003+038
110109+00000036	32..01+00289630	332107+00051536	52..07+0003+012
110110+00000036	573..1+00120210	574..1+18386430	83..01+00071524
110111+00000036	32..01+00259640	331107+00047644	52..07+0003+011
110112+00000037	32..01+00256490	332107+00039902	52..07+0003+011
110113+00000037	573..1+00123370	574..1+18902560	83..01+00072298
110114+00000037	32..01+00295640	331107+00049046	52..07+0003+006
110115+00000038	32..01+00260900	332107+00020949	52..07+0003+004
110116+00000038	573..1+00158110	574..1+19459100	83..01+00075108
110117+00000038	32..01+00146860	331107+00065086	52..07+0003+021
110118+00000139	32..01+00246500	332107+00049848	52..07+0003+028
110119+00000139	573..1+00058470	574..1+19852450	83..01+00076632

KENANSVILLE

STAR*DNA Version 4.0.2
 Copyright 2003 Starplus Software, Inc.

Input Field File : J:\2002\A020801.03\levelpak\KENANSVILLE\KENANSVILLE.raw
 Output Data File : J:\2002\A020801.03\STARNET\KENANSVILLE.dat
 Date Processed : 02-08-2005 16:40:54

Line	Point	Type	E	D	Sum E	Sum D	Desc
3	100	B	7.2508	86.3300	0.0000	0.0000	
4		F	4.9600	269.7700	2.2908	356.1000	
6		B	4.9028	284.9400			
7		F	4.5925	254.8900	2.6011	895.9300	
9		B	4.5394	280.2300			
10		F	4.3238	288.2600	2.8167	1464.4200	
12		B	4.5060	137.2100			
13		F	4.6311	273.1300	2.6916	1874.7600	
15		B	4.5186	111.6700			
16	105	F	4.7077	76.5500	2.5025	2062.9800	

Line	Point	Type	E	D	Sum E	Sum D	Desc
18	105	B	4.5381	180.5100	0.0000	0.0000	
19		F	5.5723	286.1900	-1.0342	466.7000	
21		B	3.9821	280.1900			
22		F	5.2176	284.2000	-2.2697	1031.0900	
24		B	4.8056	324.4800			
25		F	4.5051	286.8200	-1.9692	1642.3900	
27		B	4.5138	286.8400			
28		F	3.8252	263.9400	-1.2806	2193.1700	
30		B	4.8955	283.6100			
31		F	4.8429	288.8700	-1.2280	2765.6500	
33		B	4.2522	287.6800			
34		F	4.2149	278.8200	-1.1907	3332.1500	
36		B	4.4955	303.2300			
37		F	4.1618	303.6800	-0.8570	3939.0600	
39		B	3.8789	280.7900			
40		F	4.3164	260.5700	-1.2945	4480.4200	
42		B	4.1556	280.5700			
43		F	3.9227	281.7900	-1.0616	5042.7800	
45		B	4.0954	287.1600			
46		F	3.5428	275.3600	-0.5090	5605.3000	
48		B	6.2388	322.2700			
49		F	3.2736	289.1500	2.4562	6216.7200	
51		B	5.3172	290.1400			
52		F	4.1577	241.0500	3.6157	6747.9100	
54		B	4.4284	294.2300			
55		F	4.3594	280.3000	3.6847	7322.4400	
57		B	4.9806	283.1500			
58		F	5.2588	226.9000	3.4065	7832.4900	
60		B	2.9525	191.7700			
61		F	6.1678	235.4300	0.1912	8259.6900	
63		B	3.9379	288.2900			
64		F	5.3103	229.2300	-1.1812	8777.2100	
66		B	4.7945	286.1700			
67		F	4.1927	225.7300	-0.5794	9289.1100	
69		B	5.1964	284.3800			
70		F	4.2900	242.3200	0.3270	9815.8100	
72		B	5.2188	282.1900			
73		F	3.9607	265.7900	1.5851	10363.7900	
75		B	4.2173	220.7900			
76		F	5.0233	261.2900	0.7791	10845.8700	
78		B	3.9700	295.6300			
79		F	5.6525	246.1200	-0.9034	11387.6200	

KENANSVILLE

81		B	5.6347	287.2900		
82		F	4.9743	266.4500	-0.2430	11941.3600
84		B	5.2815	280.8300		
85		F	4.7421	200.2300	0.2964	12422.4200
87		B	4.7385	140.1700		
88	129	F	2.9363	112.2700	2.0986	12674.8600

Line	Point	Type	E	D	Sum E	Sum D	Desc
90	129	B	3.2204	112.3200	0.0000	0.0000	
91		F	5.3910	206.8600	-2.1706	319.1800	
93		B	4.6884	278.0700			
94		F	4.3936	300.4500	-1.8758	897.7000	
96		B	3.9814	301.5300			
97		F	4.8558	260.0600	-2.7502	1459.2900	
99		B	6.1861	294.6900			
100		F	4.6950	283.6000	-1.2591	2037.5800	
102		B	5.2667	239.9900			
103		F	5.4257	252.8600	-1.4181	2530.4300	
105		B	4.8862	297.2500			
106		F	5.2702	244.5600	-1.8021	3072.2400	
108		B	3.8587	286.7100			
109		F	5.1536	289.6300	-3.0970	3648.5800	
111		B	4.7644	259.6400			
112		F	3.9902	256.4900	-2.3228	4164.7100	
114		B	4.9046	295.6400			
115		F	2.0949	260.9000	0.4869	4721.2500	
117		B	6.5086	146.8600			
118	139	F	4.9848	246.5000	2.0107	5114.6100	

Process completed with 0 errors and 0 warnings.

Summary of Files Used and Option Settings
=====

Project Folder and Data Files

Project Name KENANSVILLE
Project Folder J:\2002\A020801.03\STARNET
Data File List KENANSVILLE.dat

Project Option Settings

STAR*NET Run Mode : Adjust with Error Propagation
Type of Adjustment : Lev
Project Units : FeetUS
Input/Output Coordinate Order : North-East
Create Coordinate File : Yes

Instrument Standard Error Settings

Project Default Instrument
Differential Levels : 0.010000 FeetUS / Mile

Listing of Input Data

=====

[File: J:\2002\A020801.03\STARNET\KENANSVILLE.DAT]

STAR*DNA Version 4.0.2

Copyright 2003 Starplus Software, Inc.

Input Field File : J:\2002\A020801.03\levelpak\KENANSVILLE\KENANSVILLE.raw

Date Processed : 02-08-2005 16:40:54

.Units FeetUS

.Sep -

.3D

NAVD 88 BM ELEVATIONS

E 100 70.02 !

E 139 76.62 !

Elevation Difference Records

Stations

L 100-105

L 105-129

L 129-139

Diff

Dist

Descriptor

2.50250 2063

2.09860 12675

2.01070 5115

Summary of Unadjusted Input Observations

=====

Number of Entered Stations (FeetUS) = 2

Fixed Stations	Elev	Description
100	70.0200	
139	76.6200	

Number of Differential Level Observations (FeetUS) = 3

From	To	Elev Diff	StdErr	Length
100	105	2.5025	0.0063	2063
105	129	2.0986	0.0155	12675
129	139	2.0107	0.0098	5115

Adjustment Statistical Summary

=====

Number of Stations = 4
Number of Observations = 3
Number of Unknowns = 2
Number of Redundant Obs = 1

Observation	Count	Sum Squares of StdRes	Error Factor
Level Data	3	0.370	0.609
Total	3	0.370	0.609

The Chi-Square Test at 5.00% Level Passed
Lower/Upper Bounds (0.031/2.241)

Adjusted Elevations and Error Propagation (FeetUS)

=====

Station	Elev	StdDev	95%	Description
100 S495	70.0200	0.000000	0.000000	
139 G198	76.6200	0.000000	0.000000	
105 D198	72.5213	0.005917	0.011597	
129 KEENS	74.6123	0.008480	0.016621	

Adjusted Observations and Residuals

=====

Adjusted Differential Level Observations (FeetUS)

From	To	Elev Diff	Residual	StdErr	StdRes
100	105	2.5013	-0.0012	0.0063	0.2
105	129	2.0911	-0.0075	0.0155	0.5
129	139	2.0077	-0.0030	0.0098	0.3

Elapsed Time = 00:00:00

KENANSVILLE-WELL.RAW

410033+?.....1
110034+00000129 83..11+00074610
110035+00000129 32..01+00022090 331107+00050925 52..07+0003+003
110036+00000201 32..01+00023730 332107+00016046 52..07+0003+007
110037+00000201 573..1-00001640 574..1+00045820 83..01+00078098
110038+00000201 32..01+00023770 331107+00019610 52..07+0003+003
110039+00000129 32..01+00022060 332107+00054482 52..07+0003+003
110040+00000129 573..1+00000070 574..1+00091650 83..01+00074611

KENANSVILLE-WELL.log

STAR*DNA Version 4.0.2
Copyright 2003 Starplus Software, Inc.

Input Field File :
J:\2002\A020801.03\levelpak\KENANSVILLE\KENANSVILLE-WELL.RAW
Output Data File : J:\2002\A020801.03\STARNET\KENANSVILLE-WELL.dat
Date Processed : 04-22-2005 15:52:19

Line	Point	Type	E	D	Sum E	Sum D	Desc
3	129	B	5.0925	22.0900	0.0000	0.0000	
4	201	F	1.6046	23.7300	3.4879	45.8200	

Line	Point	Type	E	D	Sum E	Sum D	Desc
6	201	B	1.9610	23.7700	0.0000	0.0000	
7	129	F	5.4482	22.0600	-3.4872	45.8300	

Process completed with 0 errors and 0 warnings.

Summary of Files Used and Option Settings

=====

Project Folder and Data Files

Project Name KENANSVILLE
Project Folder J:\2002\A020801.03\STARNET
Data File List KENANSVILLE-WELL.dat

Project Option Settings

STAR*NET Run Mode : Adjust with Error Propagation
Type of Adjustment : Lev
Project Units : FeetUS
Input/Output Coordinate Order : North-East
Create Coordinate File : Yes

Instrument Standard Error Settings

Project Default Instrument
Differential Levels : 0.010000 FeetUS / Mile

Listing of Input Data

=====

[File: J:\2002\A020801.03\STARNET\KENANSVILLE-WELL.DAT]

STAR*DNA Version 4.0.2

Copyright 2003 Starplus Software, Inc.

Input Field File : J:\2002\A020801.03\levelpak\KENANSVILLE\KENANSVILLE-WELL.RAW

Date Processed : 04-22-2005 15:52:19

.Units FeetUS

.Sep -

.3D

#NAVD 88 ELVATIONS

E 129 74.61 !

Elevation Difference Records

Stations

	Diff	Dist	Descriptor
--	------	------	------------

L 129-201	3.48790	46	
-----------	---------	----	--

L 201-129	-3.48720	46	
-----------	----------	----	--

Summary of Unadjusted Input Observations

Number of Entered Stations (FeetUS) = 1

Fixed Stations	Elev	Description
129	74.6100	

Number of Differential Level Observations (FeetUS) = 2

From	To	Elev Diff	StdErr	Length
129	201	3.4879	0.0009	46
201	129	-3.4872	0.0009	46

Adjustment Statistical Summary

=====

Number of Stations = 2
Number of Observations = 2
Number of Unknowns = 1
Number of Redundant Obs = 1

Observation	Count	Sum Squares of StdRes	Error Factor
Level Data	2	0.281	0.530
Total	2	0.281	0.530

The Chi-Square Test at 5.00% Level Passed
Lower/Upper Bounds (0.031/2.241)

Adjusted Elevations and Error Propagation (FeetUS)

=====

Station	Elev	StdDev	95%	Description
129	74.6100	0.000000	0.000000	
201	78.0975	0.000660	0.001294	

Adjusted Observations and Residuals

=====

Adjusted Differential Level Observations (FeetUS)

From	To	Elev Diff	Residual	StdErr	StdRes
129	201	3.4875	-0.0004	0.0009	0.4
201	129	-3.4875	-0.0003	0.0009	0.4

Elapsed Time = 00:00:00



SOUTH FLORIDA WATER MANAGEMENT DISTRICT

Rev. 4/01

COUNTY Osceola	PROJECT Kenansville	DESIGNATION KEEN 5
SECTION <u>10</u>	TOWNSHIP <u>30S</u>	RANGE <u>33E</u>
GEOGRAPHIC INDEX OF QUAD		
Established by <u>X</u> Recovered by Cooner & Associates, Inc.	NAME OF QUADRANGLE Keenansville (1972)	
SURVEYOR <u>RJE</u> DATE <u>01 / 02 / 2005</u>	FIELD BOOK <u>81</u>	PAGE <u>28</u>
HORIZONTAL DATUM: 1927 <u>1983</u> Other _____ (circle one)	ZONE <u>E</u> or W	
VERTICAL DATUM: MSL 1929 <u>1988</u> Other _____ (circle one)		
CONTROL ACCURACY: HORIZONTAL 1 2 3 <u>Sub-meter</u> (circle one)	VERTICAL 1 <u>2</u> 3	
STATE PLANE COORDINATES	X 650254.77'	Y 1292213.75' EL. 74.61' 74.612
LATITUDE 27° 53' 19.05" N	LONGITUDE 081° 01' 05.88" W 75.832' NGVD29	
DESCRIPTION SFWMD ALUM. DISK IN CONCRETE		
To Reach:		
To reach the mark from the intersection of US Highway 441 and State Road 523, head west along SR 523 for 1.6 miles		
To a steel gate on the right. Go through the gate, heading north along an asphalt road. Follow road taking a left at a		
Large pond, heading west to the mark on the right, inside a fenced in well enclosure.		
Notable Land marks:		
Mark is 23', bearing 50 °E, from a north-south barbed wire fence and 10' bearing N 41 °E from a monitoring well		

SKETCH

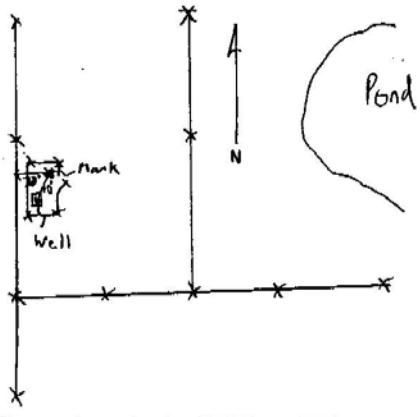

The NGS Data Sheet

See file [dsdata.txt](#) for more information about the datasheet.

```

PROGRAM = datasheet95, VERSION = 8.8
1      National Geodetic Survey,   Retrieval Date = DECEMBER 3, 2015
AJ7636 *****
AJ7636 DESIGNATION - S 495
AJ7636 PID - AJ7636
AJ7636 STATE/COUNTY- FL/OSCEOLA
AJ7636 COUNTRY - US
AJ7636 USGS QUAD - KENANSVILLE (1972)
AJ7636
AJ7636 *CURRENT SURVEY CONTROL
AJ7636
AJ7636* NAD 83(1986) POSITION- 27 52 50.6 (N) 080 59 23.3 (W) HD HELD2
AJ7636* NAVD 88 ORTHO HEIGHT - 21.345 (meters) 70.03 (feet) ADJUSTED
AJ7636
AJ7636 GEOID HEIGHT - -27.280 (meters) GEOID12B
AJ7636 DYNAMIC HEIGHT - 21.313 (meters) 69.92 (feet) COMP
AJ7636 MODELED GRAVITY - 979,162.1 (mgal) NAVD 88
AJ7636
AJ7636 VERT ORDER - FIRST CLASS II
AJ7636
AJ7636.The horizontal coordinates were established by autonomous hand held GPS
AJ7636.observations and have an estimated accuracy of +/- 10 meters.
AJ7636.
AJ7636.The orthometric height was determined by differential leveling and
AJ7636.adjusted by the NATIONAL GEODETIC SURVEY
AJ7636.in January 2014.
AJ7636
AJ7636.Significant digits in the geoid height do not necessarily reflect accuracy.
AJ7636.GEOID12B height accuracy estimate available here.
AJ7636
AJ7636.Photographs are available for this station.
AJ7636
AJ7636.The dynamic height is computed by dividing the NAVD 88
AJ7636.geopotential number by the normal gravity value computed on the
AJ7636.Geodetic Reference System of 1980 (GRS 80) ellipsoid at 45
AJ7636.degrees latitude (g = 980.6199 gals.).
AJ7636
AJ7636.The modeled gravity was interpolated from observed gravity values.
AJ7636
AJ7636;
AJ7636;SPC FL E - North East Units Estimated Accuracy
AJ7636; 392,992. 201,004. MT (+/- 10 meters HH2 GPS)
AJ7636
AJ7636 SUPERSEDED SURVEY CONTROL
AJ7636
AJ7636 NAVD 88 (03/11/02) 21.343 (m) 70.02 (f) SUPERSEDED 2 1
AJ7636
AJ7636.Superseded values are not recommended for survey control.
AJ7636
AJ7636.NGS no longer adjusts projects to the NAD 27 or NGVD 29 datums.
AJ7636.See file dsdata.txt to determine how the superseded data were derived.
AJ7636
AJ7636_U.S. NATIONAL GRID SPATIAL ADDRESS: 17RNL0100383989(NAD 83)
AJ7636
AJ7636_MARKER: DD = SURVEY DISK
AJ7636_SETTING: 7 = SET IN TOP OF CONCRETE MONUMENT
AJ7636_STAMPING: S 495 2000
AJ7636_MARK LOGO: FLDEP

```

AJ7636_PROJECTION: FLUSH
AJ7636_MAGNETIC: M = MARKER EQUIPPED WITH BAR MAGNET
AJ7636_STABILITY: C = MAY HOLD, BUT OF TYPE COMMONLY SUBJECT TO
AJ7636+STABILITY: SURFACE MOTION
AJ7636_SATELLITE: THE SITE LOCATION WAS REPORTED AS SUITABLE FOR
AJ7636+SATELLITE: SATELLITE OBSERVATIONS - March 18, 2008

AJ7636

AJ7636	HISTORY	- Date	Condition	Report By
AJ7636	HISTORY	- 2000	MONUMENTED	FLDEP
AJ7636	HISTORY	- 20050121	GOOD	INDIV
AJ7636	HISTORY	- 20080318	GOOD	FLDEP

AJ7636

AJ7636 STATION DESCRIPTION

AJ7636

AJ7636'DESCRIBED BY FL DEPT OF ENV PRO 2000 (JLM)
AJ7636'THE MARK IS ABOUT 18.7 MI (30.1 KM) SOUTH OF HOLOPAW, 0.3 MI (0.5 KM)
AJ7636'NORTH-NORTHWEST OF KENANSVILLE, IN SECTION 11, TOWNSHIP 30 SOUTH,
AJ7636'RANGE 33 EAST. TO REACH THE MARK FROM THE JUNCTION OF COUNTY ROAD 523
AJ7636'(SOUTH CANOE CREEK ROAD) AND U.S. HIGHWAY 441 (SOUTH KENANSVILLE
AJ7636'ROAD) IN KENANSVILLE, GO NORTH-NORTHWEST ON U.S. HIGHWAY 441 (STATE
AJ7636'ROAD 15) FOR 0.35 TO THE JUNCTION OF NORTH POST OFFICE ROAD ON THE
AJ7636'LEFT AND THE MARK ON THE LEFT, SET IN THE TOP OF A ROUND CONCRETE
AJ7636'MONUMENT FLUSH WITH THE GROUND AND 1.3 FT (0.4 M) BELOW THE LEVEL OF
AJ7636'U.S. HIGHWAY 441. LOCATED 129.0 FT (39.3 M) SOUTH OF A STOP SIGN, 47.5
AJ7636'FT (14.5 M) WEST OF THE CENTERLINE OF U.S. HIGHWAY 441, 30.2 FT (9.2
AJ7636'M) EAST OF THE APPROXIMATE CENTERLINE OF NORTH POST OFFICE ROAD AND
AJ7636'0.6 FT (18.3 CM) EAST OF A CARSONITE WITNESS POST.

AJ7636

AJ7636 STATION RECOVERY (2005)

AJ7636

AJ7636'RECOVERY NOTE BY INDIVIDUAL CONTRIBUTORS 2005
AJ7636'RECOVERED AS DESCRIBED. RECOVERY NOTE BY COONER AND ASSOCIATES, INC.

AJ7636

AJ7636 STATION RECOVERY (2008)

AJ7636

AJ7636'RECOVERY NOTE BY FL DEPT OF ENV PRO 2008 (JLM)
AJ7636'RECOVERED AS DESCRIBED.

*** retrieval complete.

Elapsed Time = 00:00:02

The NGS Data Sheet

See file [dsdata.txt](#) for more information about the datasheet.

```

DATABASE = Sybase ,PROGRAM = datasheet, VERSION = 7.35
1 National Geodetic Survey, Retrieval Date = APRIL 26, 2006
AF6167 *****
AF6167 DESIGNATION - D 198
AF6167 PID - AF6167
AF6167 STATE/COUNTY- FL/OSCEOLA
AF6167 USGS QUAD - KENANSVILLE (1972)
AF6167
AF6167 *CURRENT SURVEY CONTROL
AF6167
AF6167* NAD 83(1986)- 27 52 34. (N) 080 59 25. (W) SCALED
AF6167* NAVD 88 - 22.103 (meters) 72.52 (feet) ADJUSTED
AF6167
AF6167 GEOID HEIGHT- -27.24 (meters) GEOID03
AF6167 DYNAMIC HT - 22.071 (meters) 72.41 (feet) COMP
AF6167 MODELED GRAV- 979,162.9 (mgal) NAVD 88
AF6167
AF6167 VERT ORDER - SECOND CLASS 0
AF6167
AF6167.The horizontal coordinates were scaled from a topographic map and have
AF6167.an estimated accuracy of +/- 6 seconds.
AF6167
AF6167.The orthometric height was determined by differential leveling
AF6167.and adjusted by the National Geodetic Survey in June 1991..
AF6167
AF6167.The geoid height was determined by GEOID03.
AF6167
AF6167.The dynamic height is computed by dividing the NAVD 88
AF6167.geopotential number by the normal gravity value computed on the
AF6167.Geodetic Reference System of 1980 (GRS 80) ellipsoid at 45
AF6167.degrees latitude (g = 980.6199 gals.).
AF6167
AF6167.The modeled gravity was interpolated from observed gravity values.
AF6167
AF6167; North East Units Estimated Accuracy
AF6167;SPC FL E - 392,480. 200,960. MT (+/- 180 meters Scaled)
AF6167
AF6167 SUPERSEDED SURVEY CONTROL
AF6167
AF6167 NGVD 29 (??/??/92) 22.475 (m) 73.74 (f) ADJ UNCH 2 0
AF6167
AF6167.Superseded values are not recommended for survey control.
AF6167.NGS no longer adjusts projects to the NAD 27 or NGVD 29 datums.
AF6167.See file dsdata.txt to determine how the superseded data were derived.
AF6167
AF6167_U.S. NATIONAL GRID SPATIAL ADDRESS: 17RNL009834(NAD 83)
AF6167_MARKER: DB = BENCH MARK DISK
AF6167_SETTING: 7 = SET IN TOP OF CONCRETE MONUMENT
AF6167_SP_SET: SET IN TOP OF CONCRETE MONUMENT
AF6167_STAMPING: D 198 1960
AF6167_MARK LOGO: CGS
AF6167_MAGNETIC: N = NO MAGNETIC MATERIAL
AF6167_STABILITY: C = MAY HOLD, BUT OF TYPE COMMONLY SUBJECT TO
AF6167+STABILITY: SURFACE MOTION
AF6167_SATELLITE: THE SITE LOCATION WAS REPORTED AS NOT SUITABLE FOR
AF6167+SATELLITE: SATELLITE OBSERVATIONS - August 26, 1995
AF6167
AF6167 HISTORY - Date Condition Report By
AF6167 HISTORY - 1960 MONUMENTED CGS
AF6167 HISTORY - 1987 GOOD USPSQD
AF6167 HISTORY - 1989 GOOD USPSQD
AF6167 HISTORY - 19950826 GOOD FLDEP
AF6167 HISTORY - 20050118 GOOD INDIV
AF6167
AF6167 STATION DESCRIPTION
AF6167
AF6167'DESCRIBED BY COAST AND GEODETIC SURVEY 1960
AF6167'AT KENANSVILLE.
AF6167'AT KENANSVILLE, 0.15 MILE WEST ALONG STATE ROAD 523 FROM THE

```

AF6167' JUNCTION OF U.S. HIGHWAY 441, AT THE JUNCTION OF PEAVINE TRAIL
AF6167' LEADING SOUTHWEST, 55 FEET SOUTH OF THE CENTER LINE OF ROAD 523,
AF6167' 38 FEET EAST OF THE CENTER LINE OF PEAVINE TRAIL, 72 FEET
AF6167' SOUTHEAST OF THE CENTER OF JUNCTION, 70 1/2 FEET EAST OF AND
AF6167' ACROSS PEAVINE TRAIL FROM THE NORTHEAST CORNER OF WEBBS
AF6167' HEARTBRAKE HOTEL, 11 1/2 FEET EAST-NORTHEAST OF POWER LINE POLE
AF6167' 17-591, 3 1/2 FEET NORTH OF A EAST-WEST FENCE LINE, 2 FEET
AF6167' NORTHWEST OF A STEEL WITNESS POST, ABOUT LEVEL WITH THE JUNCTION,
AF6167' AND SET IN TOP OF A CONCRETE POST PROJECTING 5 INCHES.

AF6167
AF6167 STATION RECOVERY (1987)

AF6167
AF6167 RECOVERY NOTE BY US POWER SQUADRON 1987 (AG)
AF6167 RECOVERED IN GOOD CONDITION.

AF6167
AF6167 STATION RECOVERY (1989)

AF6167
AF6167 RECOVERY NOTE BY US POWER SQUADRON 1989 (AG)
AF6167 RECOVERED IN GOOD CONDITION.

AF6167
AF6167 STATION RECOVERY (1995)

AF6167
AF6167 RECOVERY NOTE BY FL DEPT OF ENV PRO 1995 (JLM)
AF6167 THE MARK IS ABOUT 0.15 MI (0.24 KM) SOUTHEAST OF KENANSVILLE IN
AF6167 SECTION 14, TOWNSHIP 30 SOUTH, RANGE 33 EAST. TO REACH THE MARK FROM
AF6167 THE POST OFFICE IN KENANSVILLE, GO SOUTHEAST ON U.S. HIGHWAY 441
AF6167 (STATE ROAD 15) FOR 0.15 MI (0.24 KM) TO THE JUNCTION OF COUNTY ROAD
AF6167 523 ON THE RIGHT, TURN RIGHT ON COUNTY ROAD 523 AND GO WEST FOR 0.15
AF6167 MI (0.24 KM) TO THE JUNCTION OF PEAVINE TRAIL ON THE LEFT, LEADING
AF6167 SOUTHWEST, AND THE MARK ON THE LEFT, SET IN THE TOP OF A ROUND
AF6167 CONCRETE MONUMENT PROJECTING 0.5 FT (15.2 CM) ABOVE THE LEVEL OF THE
AF6167 GROUND. LOCATED 70.5 FT (21.5 M) EAST OF AND ACROSS PEAVINE TRAIL FROM
AF6167 THE NORTHEAST CORNER OF WEBBS HEARTBRAKE HOTEL, 55.0 FT (16.8 M) SOUTH
AF6167 OF THE CENTERLINE OF STATE ROAD 523, 30.4 FT (9.3 M) EAST OF THE
AF6167 APPROXIMATE CENTERLINE OF PEAVINE TRAIL, 11.5 FT (3.5 M)
AF6167 EAST-NORTHEAST OF POWER POLE NUMBER 17-591, 4.5 FT (1.4 M) SOUTH OF A
AF6167 BARB WIRE FENCE LEADING EAST, 2.4 FT (0.7 M) EAST OF A BARB WIRE FENCE
AF6167 LEADING SOUTH AND 2.0 FT (0.6 M) NORTHWEST OF A STEEL WITNESS POST.

AF6167
AF6167 STATION RECOVERY (2005)

AF6167
AF6167 RECOVERY NOTE BY INDIVIDUAL CONTRIBUTORS 2005
AF6167 RECOVERED AS DESCRIBED. RECOVERY NOTE BY COONER AND ASSOCIATES, INC.

*** retrieval complete.
Elapsed Time = 00:00:00

The NGS Data Sheet

See file [dsdata.txt](#) for more information about the datasheet.

```

DATABASE = Sybase ,PROGRAM = datasheet, VERSION = 7.35
1 National Geodetic Survey, Retrieval Date = APRIL 26, 2006
AF6163 *****
AF6163 DESIGNATION - G 198
AF6163 PID - AF6163
AF6163 STATE/COUNTY- FL/OSCEOLA
AF6163 USGS QUAD - LAKE MARIAN NE (1972)
AF6163
AF6163 *CURRENT SURVEY CONTROL
AF6163
AF6163 * NAD 83(1986)- 27 52 34. (N) 081 00 51. (W) SCALED
AF6163 * NAVD 88 - 23.355 (meters) 76.62 (feet) ADJUSTED
AF6163
AF6163 GEOID HEIGHT- -27.21 (meters) GEOID03
AF6163 DYNAMIC HT - 23.320 (meters) 76.51 (feet) COMP
AF6163 MODELED GRAV- 979,165.1 (mgal) NAVD 88
AF6163
AF6163 VERT ORDER - SECOND CLASS 0
AF6163
AF6163.The horizontal coordinates were scaled from a topographic map and have
AF6163.an estimated accuracy of +/- 6 seconds.
AF6163
AF6163.The orthometric height was determined by differential leveling
AF6163.and adjusted by the National Geodetic Survey in June 1991..
AF6163
AF6163.The geoid height was determined by GEOID03.
AF6163
AF6163.The dynamic height is computed by dividing the NAVD 88
AF6163.geopotential number by the normal gravity value computed on the
AF6163.Geodetic Reference System of 1980 (GRS 80) ellipsoid at 45
AF6163.degrees latitude (g = 980.6199 gals.).
AF6163
AF6163.The modeled gravity was interpolated from observed gravity values.
AF6163
AF6163; North East Units Estimated Accuracy
AF6163;SPC FL E - 392,480. 198,610. MT (+/- 180 meters Scaled)
AF6163
AF6163 SUPERSEDED SURVEY CONTROL
AF6163
AF6163 NGVD 29 (??/??/92) 23.726 (m) 77.84 (f) ADJ UNCH 2 0
AF6163
AF6163.Superseded values are not recommended for survey control.
AF6163.NGS no longer adjusts projects to the NAD 27 or NGVD 29 datums.
AF6163.See file dsdata.txt to determine how the superseded data were derived.
AF6163
AF6163_U.S. NATIONAL GRID SPATIAL ADDRESS: 17RML986834(NAD 83)
AF6163_MARKER: DB = BENCH MARK DISK
AF6163_SETTING: 7 = SET IN TOP OF CONCRETE MONUMENT
AF6163_SP_SET: SET IN TOP OF CONCRETE MONUMENT
AF6163_STAMPING: G 198 1960
AF6163_STABILITY: C = MAY HOLD, BUT OF TYPE COMMONLY SUBJECT TO
AF6163+STABILITY: SURFACE MOTION
AF6163
AF6163 HISTORY - Date Condition Report By
AF6163 HISTORY - 1960 MONUMENTED CGS
AF6163 HISTORY - 20050121 GOOD INDIV
AF6163
AF6163 STATION DESCRIPTION
AF6163
AF6163'DESCRIBED BY COAST AND GEODETIC SURVEY 1960
AF6163'1.6 MI W FROM KENANSVILLE.
AF6163'1.6 MILES WEST ALONG STATE ROAD 523 FROM THE JUNCTION OF U.S.
AF6163'HIGHWAY 441 AT KENANSVILLE, ABOUT 1.05 MILES WEST OF A LARGE
AF6163'TWO-STORY SCHOOL BUILDING SOUTH OF THE ROAD, AT THE JUNCTION OF
AF6163'STATE ROAD 523 A LEADING SOUTH AND PAST THE LAKEVIEW BAPTIST
AF6163'CHURCH, 66 1/2 FEET SOUTHWEST OF THE CENTER OF JUNCTION, 52 FEET
AF6163'SOUTH OF THE CENTER LINE OF ROAD 523, 42 FEET WEST OF THE CENTER
AF6163'LINE OF ROAD 523 A, 9 FEET WEST-SOUTHWEST OF A
AF6163'HIGHWAY-RIGHT-OF-WAY POST, 2 FEET EAST OF A STEEL WITNESS POST,

```

DATASHEETS

AF6163'ABOUT LEVEL WITH THE ROAD, AND SET IN TOP OF A CONCRETE POST
AF6163'PROJECTING 3 INCHES.
AF6163
AF6163 STATION RECOVERY (2005)
AF6163
AF6163'RECOVERY NOTE BY INDIVIDUAL CONTRIBUTORS 2005
AF6163'RECOVERED AS DESCRIBED. RECOVERY NOTE BY COONER AND ASSOCIATES, INC.

*** retrieval complete.
Elapsed Time = 00:00:01