





Site Name KIRCOF GW1		Date of Field Work July 7, 2015
Party Chief Strickland/Clanton	Field Book Name/Number MISC FB # 6X	Page Number 27
Site Benchmark Name OS 134	Benchmark Elevation (NAVD88) 70.649ft	Datum Offset to NGVD29 + 1.01ft
Reference Elevation (NAVD 88) 73.825ft		Existing Tag Elevation (Datum) 74.68ft (NGVD 29)
Latitude 28°09'17.96"N		Longitude 81°25'27.55"W
Notes: Ground elevation = 70.13ft (NAVD 88). Corpscon v6.0.1 offset = +1.01ft, Field offset = +0.86ft		

Photographs:

<p>Overall Site</p> 	<p>Benchmark Close Up</p> 	<p>Benchmark Location</p> 
<p>Brass Tag Close Up</p> 	<p>Brass Tag + Reference Mark</p> 	<p>Staff Gauge N/A</p>

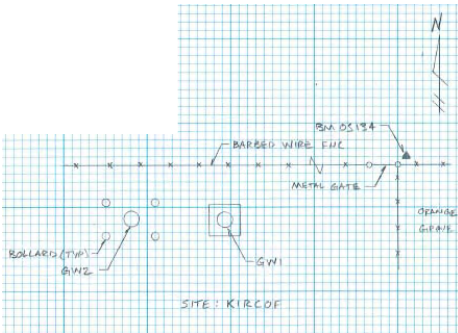
Site Name KIRCOF GW2		Date of Field Work July 7, 2015
Party Chief Strickland/Clanton	Field Book Name/Number MISC FB # 6X	Page Number 27
Site Benchmark Name OS 134	Benchmark Elevation (NAVD88) 70.649ft	Datum Offset to NGVD29 + 1.01ft
Reference Elevation (NAVD 88) 72.91ft		Existing Tag Elevation (Datum) 73.77ft (NGVD 29)
Latitude 28°09'17.96"N		Longitude 81°25'27.55"W
Notes: Ground elevation = 70.13ft (NAVD 88). Corpscon v6.0.1 offset = +1.01ft, Field offset = +0.86ft		

Photographs:

<p>Overall Site</p> 	<p>Benchmark Close Up</p> 	<p>Benchmark Location</p> 
<p>Brass Tag Close Up</p> 	<p>Brass Tag + Reference Mark</p> 	<p>Staff Gauge N/A</p>



GW1

GW2

PROPERTY OF:

South Florida Water Management District

RTU Name: KIRCOF

Contact SCADA: 561-682-2047



300V E54661 (E54661) CSPH P/MW 1/11 P/B 80°C 200W FT1 03707

5024 FEET
In-Situ, Inc. RusselCable
In-Situ, Inc. RusselCable
In-Situ, Inc. RusselCable
100V 300V E54661

ANTENNA
Polymer
100 to 1000MHz @ 50W
220 to 250MHz @ 100W
125 to 150MHz @ 250W

KIRCOF GW2
ELEV. 73.77
DATE 11 25 08
BY EE MR
NAVD NGVD 29

KIRCOF
ELEV. GW 2
DATE 73.77
BY 11 25 08
NAVD EE MR
NGVD 29

KIRCOF GW1
ELEV. 74.675
DATE 11 25 08
BY EE MR
NAVD NGVD 29

STN KIRCOF

GW1

ELEV. 73.825

DATE 7.7.15

BY JS TC

NAVD 88

NGVD

OFFSET + 1.01

STN KIRCOF

GW2

ELEV. 72.91

DATE 7.7.15

BY JS TC

NAVD 88

NGVD

OFFSET + 1.01

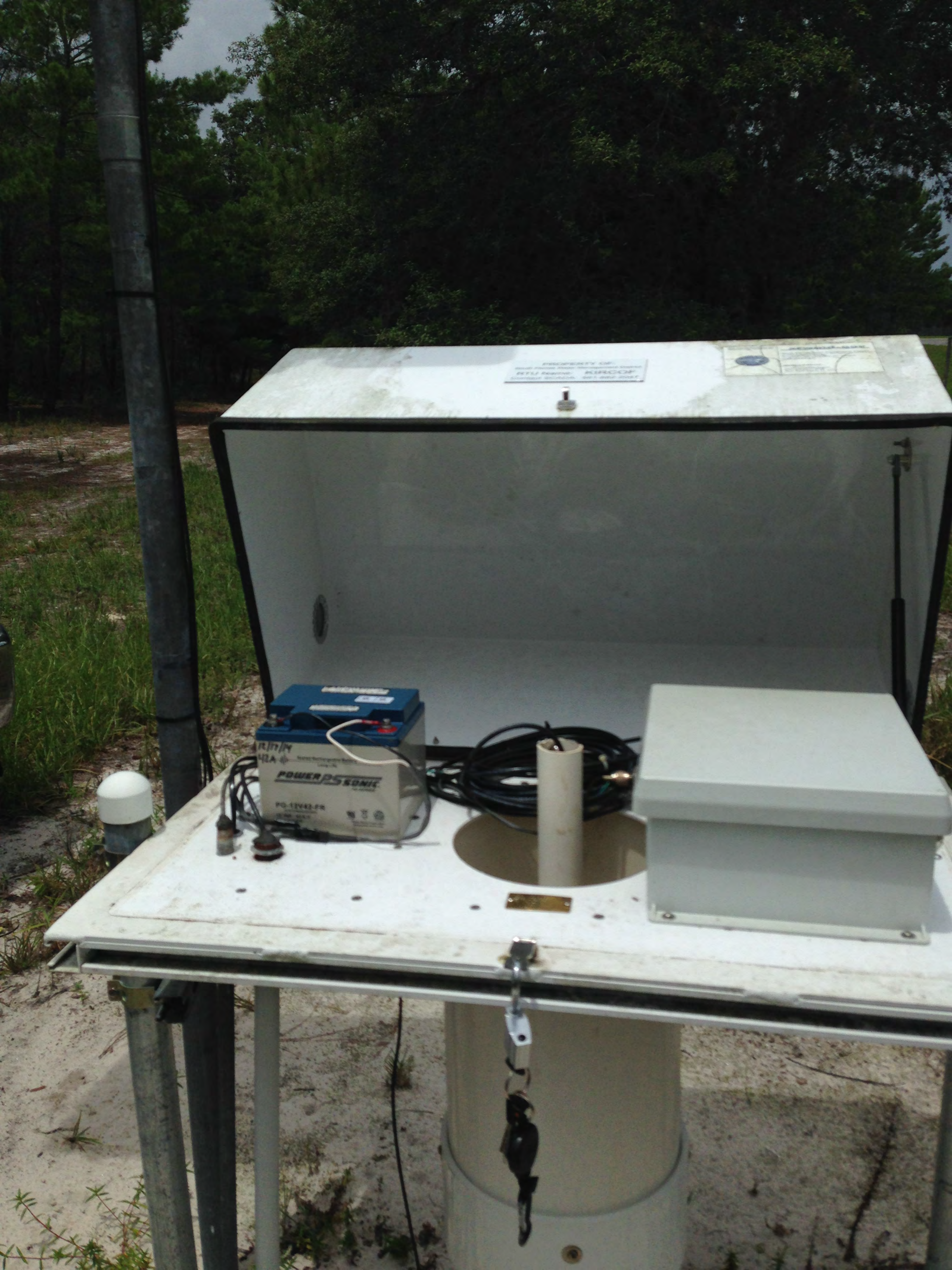

PROPERTY OF
KIRKCOFF
CONTACT: 803-782-2007



POWER SONIC
PG-1544FR
12V 15Ah



Small illegible label on the front panel of the cabinet.

STN KIRCOF

GW1

ELEV. 73.825

DATE 7.7.15

BY JS TC

NAVD 88

NGVD

OFFSET + 1.01

STN KIRCOF
ELEV. 72.91
DATE 7.7.15
BY JS TC
NAVD 88
OFFSET + 1.01
GW2
NGVD

FLA. WATER MANAGEMENT DIST.
SURVEY MARKER
OS-134
1981
BM

SEC	8	TWP	27	RGE	29
ESTABLISH	NAVD 88	ELEV @	KIRCOF	GWI	WELLS
STA	+	HI	-	ELEV	BM ELEV
BM	5.28 1.49	75.93		70.65	70.649
GWI			2.105	73.825	
GW2			3.02	72.91	
GRND			5.8	70.13	
BM			5.28	70.65	70.65

STRICKLANDS
CLANTON

COMMENTS

BM OS134 1981 SFWWD ALUM DISK FID GOOD COND

KIRCOF GW1 REF MARK 2" PVC PIPE W/ "X" MARK ON NW SIDE

KIRCOF GW2 REF MARK 6" PVC PIPE W/ "X" MARK ON NE SIDE

GROUND BETWEEN WELLS

BM OS134 1981

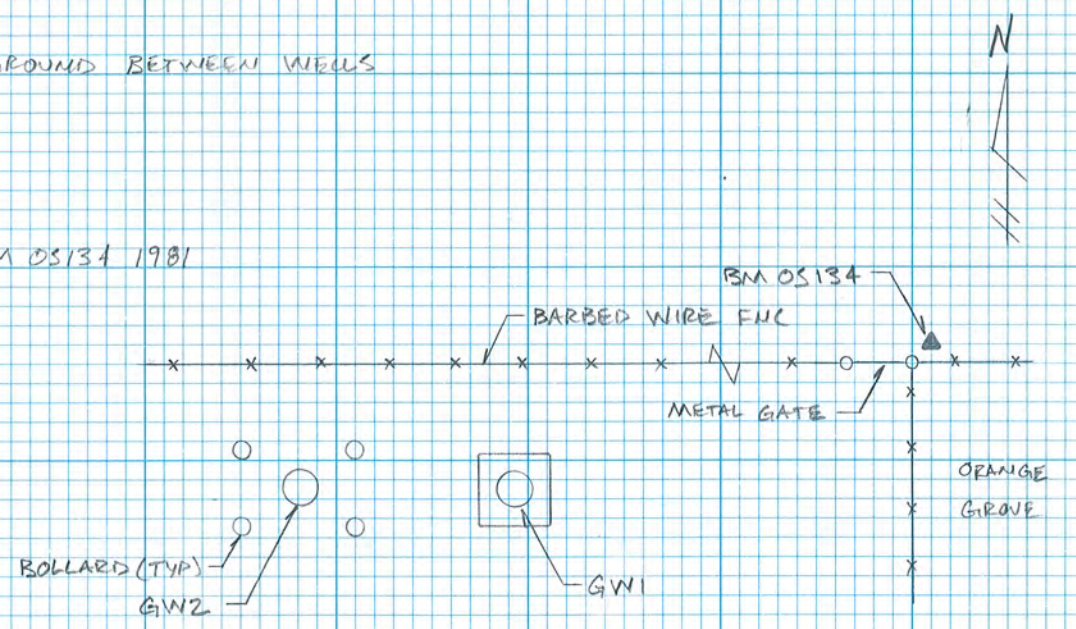

SITE: KIRCOF

The NGS Data Sheet

See file [dsdata.txt](#) for more information about the datasheet.



```

PROGRAM = datasheet95, VERSION = 8.7.1
1      National Geodetic Survey,   Retrieval Date = AUGUST 10, 2015
DF6743 *****
DF6743 DESIGNATION - OS 134
DF6743 PID - DF6743
DF6743 STATE/COUNTY- FL/OSCEOLA
DF6743 COUNTRY - US
DF6743 USGS QUAD - LAKE TOHOPEKALIGA (1987)
DF6743
DF6743 *CURRENT SURVEY CONTROL
DF6743
DF6743* NAD 83(1986) POSITION- 28 09 18. (N) 081 25 23. (W) SCALED
DF6743* NAVD 88 ORTHO HEIGHT - 21.534 (meters) 70.65 (feet) ADJUSTED
DF6743
DF6743 GEOID HEIGHT - -27.62 (meters) GEOID12B
DF6743 DYNAMIC HEIGHT - 21.502 (meters) 70.54 (feet) COMP
DF6743 MODELED GRAVITY - 979,153.7 (mgal) NAVD 88
DF6743
DF6743 VERT ORDER - SECOND CLASS I
DF6743
DF6743.The horizontal coordinates were scaled from a topographic map and have
DF6743.an estimated accuracy of +/- 6 seconds.
DF6743.
DF6743.The orthometric height was determined by differential leveling and
DF6743.adjusted by the NATIONAL GEODETIC SURVEY
DF6743.in April 2004.
DF6743
DF6743.The dynamic height is computed by dividing the NAVD 88
DF6743.geopotential number by the normal gravity value computed on the
DF6743.Geodetic Reference System of 1980 (GRS 80) ellipsoid at 45
DF6743.degrees latitude (g = 980.6199 gals.).
DF6743
DF6743.The modeled gravity was interpolated from observed gravity values.
DF6743
DF6743; North East Units Estimated Accuracy
DF6743;SPC FL E - 423,460. 158,450. MT (+/- 180 meters Scaled)
DF6743
DF6743 SUPERSEDED SURVEY CONTROL
DF6743
DF6743.No superseded survey control is available for this station.
DF6743
DF6743_U.S. NATIONAL GRID SPATIAL ADDRESS: 17RMM584144(NAD 83)
DF6743
DF6743_MARKER: DD = SURVEY DISK
DF6743_SETTING: 7 = SET IN TOP OF CONCRETE MONUMENT
DF6743_STAMPING: BM OS-134 1981
DF6743_MARK LOGO: SFLWMD
DF6743_PROJECTION: RECESSED 15 CENTIMETERS
DF6743_MAGNETIC: N = NO MAGNETIC MATERIAL
DF6743_STABILITY: C = MAY HOLD, BUT OF TYPE COMMONLY SUBJECT TO
DF6743+STABILITY: SURFACE MOTION
DF6743_SATELLITE: THE SITE LOCATION WAS REPORTED AS SUITABLE FOR
DF6743+SATELLITE: SATELLITE OBSERVATIONS - July 20, 2001
DF6743
DF6743 HISTORY - Date Condition Report By
DF6743 HISTORY - 1981 MONUMENTED SFLWMD
DF6743 HISTORY - 20010720 GOOD FLDEP

```

DATASHEETS

DF6743 HISTORY - 20050202 GOOD INDIV
 DF6743 HISTORY - 20071017 GOOD WOOLPT

DF6743

DF6743 STATION DESCRIPTION

DF6743

DF6743'DESCRIBED BY FL DEPT OF ENV PRO 2001 (JLM)

DF6743'THE MARK IS ABOUT 12.25 MI SOUTHWEST OF KISSIMMEE, IN SECTION 8,

DF6743'TOWNSHIP 27 SOUTH, RANGE

DF6743'29 EAST.

DF6743'

DF6743'TO REACH THE MARK FROM THE JUNCTION OF U.S. HIGHWAY 192 (VINE STREET)

DF6743'AND U.S. HIGHWAY

DF6743'17, 92 (JOHN YOUNG PARKWAY) IN KISSIMMEE, GO SOUTH ON U.S. HIGHWAY 17,

DF6743'92 FOR 3.5 MI TO THE

DF6743'JUNCTION OF PLEASANT HILL ROAD (COUNTY ROAD 531) ON THE LEFT, TURN

DF6743'LEFT ON PLEASANT HILL

DF6743'ROAD (COUNTY ROAD 531) AND GO SOUTH FOR 7.55 MI TO THE JUNCTION OF

DF6743'SOUTHPORT ROAD ON

DF6743'THE LEFT, TURN LEFT ON SOUTHPORT ROAD AND GO EAST FOR 1.2 MI TO THE

DF6743'MARK ON THE RIGHT,

DF6743'SET IN THE TOP OF A ROUND CONCRETE MONUMENT RECESSED 0.6 FT BELOW THE

DF6743'LEVEL OF THE

DF6743'GROUND AND THE LEVEL OF SOUTHPORT ROAD.

DF6743'

DF6743'LOCATED 265.0 FT WEST OF THE APPROXIMATE CENTERLINE OF HURT ROAD, 22.5

DF6743'FT SOUTH OF THE

DF6743'CENTERLINE OF SOUTHPORT ROAD, 1.2 FT NORTH OF A SFWMD METAL WITNESS

DF6743'POST, 1.0 FT WEST

DF6743'OF A BARBWIRE FENCE LEADING SOUTH AND 0.9 FT NORTH OF A BARBWIRE

DF6743'FENCE.

DF6743'

DF6743'

DF6743

DF6743 STATION RECOVERY (2005)

DF6743

DF6743'RECOVERY NOTE BY INDIVIDUAL CONTRIBUTORS 2005

DF6743'RECOVERED AS DESCRIBED. RECOVERY NOTE BY COONER AND ASSOCIATES, INC.

DF6743

DF6743 STATION RECOVERY (2007)

DF6743

DF6743'RECOVERY NOTE BY WOOLPERT CONSULTANTS 2007 (NM)

DF6743'RECOVERED IN GOOD CONDITION.

*** retrieval complete.

Elapsed Time = 00:00:02