



SOUTH FLORIDA WATER MANAGEMENT DISTRICT

Rev. 1/16

SCADA RTU Station Name: CAMPLOE	DB Hydro Station Name: OSS-2 GW	DB Hydro Site Name: OSS-2	Agency: S.F.W.M.D	Date of Field Work: 04/22/2020
Party Chief: STRICKLAND	Field Book: SCADA FB#13	Page(s): 56-57	Report Prepared by: A.Schauer	
Surveyors Notes:		Surveyor's Certification:		

SITE SPECIFIC DATA

Reference Elevation(s) (NAVD88): OSS-2 (CAMPLOE) = 84.11 feet	Site Benchmark(s)/Elevation(s) (NAVD88): BM OSS-2 2020 = 79.98 feet OSS 2A = 79.97 feet OSS 2B = 78.59 feet	Source Benchmark(s) /Elev(s) (NAVD88): OSS 2B = 78.59 feet
Calibration Port Elev(s) (NAVD88): N/A	Ground Elevation (NAVD88): 79.5 feet	Pad Elevation (NAVD88): 79.95 feet
Corpscon 6.0.1 Conversion Factor (NAVD88 to NGVD29): +1.11 feet		

GEOGRAPHIC DATA

Section 6 Township 28 South Range 32 East				
<input checked="" type="checkbox"/> Well(s) <input type="checkbox"/> Gate(s)	Latitude: GW WELL: 28°04'59.5"	Longitude: GW WELL: -81°09'43.4"	Northing (Y): N/A	Easting (X): N/A
<input checked="" type="checkbox"/> Benchmark				
Position (horizontal) Source: ESRI Pick Point & Garmin Handheld GPSMAP78				

Notes: NAVD88 – North American Vertical Datum of 1988; NGVD29- National Geodetic Vertical Datum of 1929; Corpscon 6.0.1 - A U.S. Army Corps of Engineers Engineering Research and Development Center Topographic Engineering Center Alexandria, Virginia Windows-based program to convert coordinates and elevations between datum's using vertcon05.txt and vertcon05.05 files supplied by the U.S. Army Corps of Engineers South Atlantic Division, Jacksonville FL.

PICTURES

Legend: SFWMD Disk = ▲ Well = ●





SOUTH FLORIDA WATER MANAGEMENT DISTRICT

Rev. 1/16

OSS-2 CAMPLOE Well

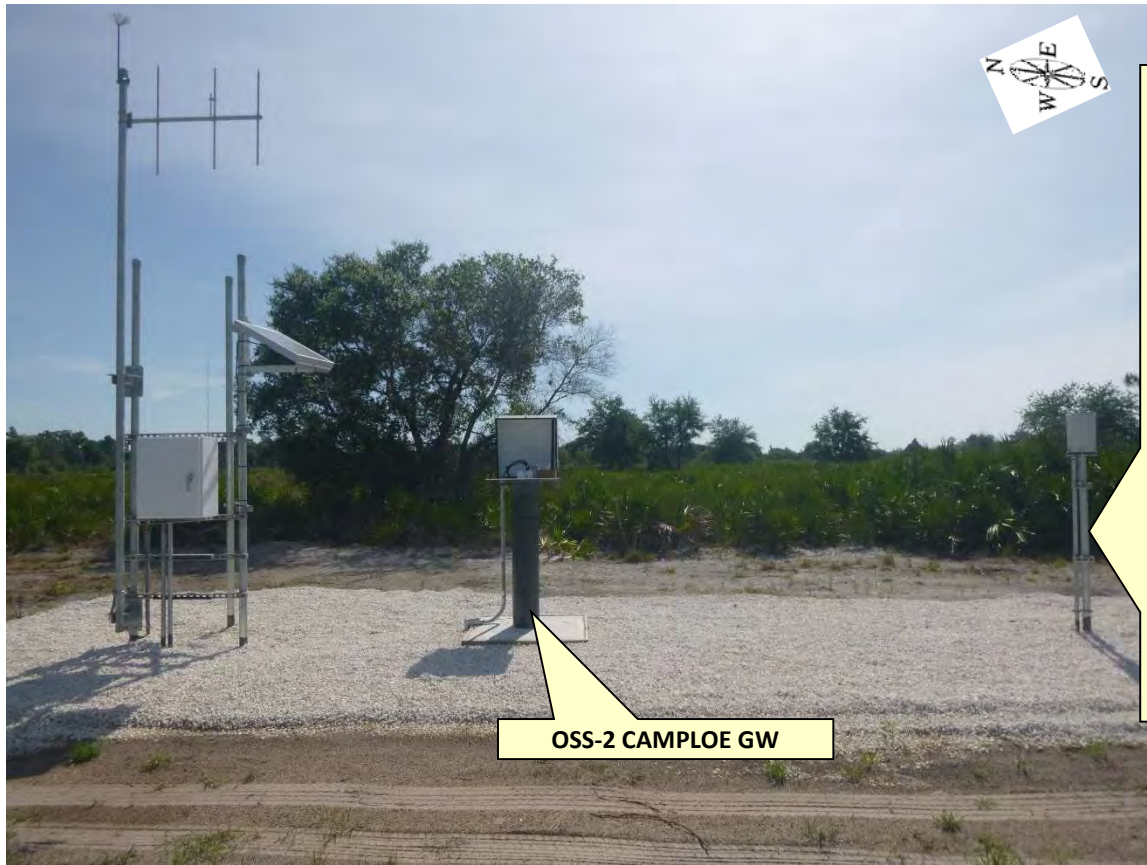

OSS-2 CAMPLOE GW



OSS-2 CAMPLOE Rain Gauge
28° 04' 59.4"
-81° 09' 43.3"



OSS-2 CAMPLOE GW Well
Reference Point
El. = 84.11 feet NAVD88

RTU CAMPLOE GW
STN OSS-2
ELEV 84.11 NAVD88
DATE 4,22,20
BY AS
OFFSET + 1.11

RTU CAMPLOE GW
STN OSS-2
ELEV 84.11 NAVD88
DATE 4,22,20
BY AS
OFFSET + 1.11





SOUTH FLORIDA WATER MANAGEMENT DISTRICT

Rev. 1/16

OSS-2 CAMPLOE SITE BENCHMARK "BM OSS-2 2020" El. = 79.98 feet (NAVD88)

Benchmark "BM OSS-2 2020"
28°04'59.5" (N)
81° 09'43.4" (W)
Elev. = 79.98 feet (NAVD88)



Benchmark "BM OSS-2 2020"
28°04'59.5" (N)
81° 09'43.4" (W)
Elev. = 79.98 feet (NAVD88)



SOUTH FLORIDA WATER MANAGEMENT DISTRICT

Rev. 1/16

OSS-2 CAMPLOE SITE BENCHMARK "OSS 2A" El. = 78.97 feet (NAVD88)



Benchmark "OSS 2A"
28° 04' 58.91205" (N)
81° 09' 43.63076" (W)
Elev. = 78.97 feet (NAVD88)



Benchmark "OSS 2A"
28° 04' 58.91205" (N)
81° 09' 43.63076" (W)
Elev. = 78.97 feet (NAVD88)



SOUTH FLORIDA WATER MANAGEMENT DISTRICT

Rev. 1/16

OSS-2 CAMPLOE SITE BENCHMARK "OSS 2B" El. = 78.59 feet (NAVD88)



Benchmark "OSS 2B"
28° 04' 49.87372 (N)
81° 09' 43.61847" (W)
Elev. = 78.59 feet (NAVD88)

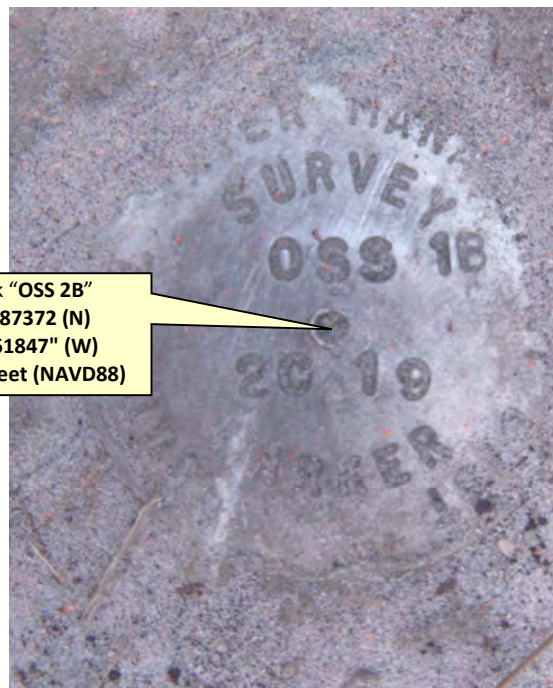

Benchmark "OSS 2B"
28° 04' 49.87372 (N)
81° 09' 43.61847" (W)
Elev. = 78.59 feet (NAVD88)



South Florida Water Management District Benchmark Datasheet

Designation: **BM OSS-2 2020**
 Stamping: **BM OSS-2 2020**
 Established By: **SFWMD**
 Surveyor: **STRICKLAND**

Project Name: **CFWI WELL CAMPLOE**
 Field Book Name: **SCADA13**
 Recovered By: **STRICKLAND**
 Established Date: **04/22/20**

Type: **V**
 State Plane Zone: **FL East**
 Field Book Page: **56**
 Recovery Date: _____
 Status: **New**

GEOGRAPHIC POSITION INFORMATION

Section: **6** Township: **28 SOUTH** Range: **32 EAST**
 County: **OSCEOLA** Quadrange: _____ Quad Index: _____ NGS Source BM(s): **OSS 2B 2019**
 NAD83 Adj. Year: _____ Vertical Datum: **NAVD1988** Horizontal Datum: **NAD1983** NGS PID(s): _____
 NAVD88 Elevation (feet): **79.98** NGVD29 Elevation (feet): _____ 2022 Elevation: _____ NGS NAVD88 Elev (ft): **78.59**
 NAVD88 Class: _____ NGVD29 Class: _____ Other Elevation: _____ NGS NAVD88 Elev (m): _____
 NAVD88 Order: _____ NGVD29 Order: _____ Other Elevation Type: _____ NGS 2022 Elev (ft): _____

CORPSCON 6.0.1 CONVERSION FACTOR (NAVD88 TO NGVD29): (A U.S. Army Corps of Engineers Engineering Research and Development Center Topographic Engineering Center Alexandria, Virginia Windows-based program to convert coordinates and elevations between datum's using vertcon05.txt and vertcon05.05 files supplied by the U.S. Army Corps of Engineers South Atlantic Division, Jacksonville FL.)

Vertical Datum Offset: + **1.11** Actual NGS Elevation or ngvd29.txt file: _____ OPUS Ortho Height: _____
 Northing (Y) (feet): _____ Easting (X) (feet): _____ Source of Latitude & Longitude: _____
 Latitude: **28** **4** **59.5** Longitude: **81** **9** **43.4**
 DD° MM' SS" DD° MM' SS"
 Latitude (Decimal Degrees): **28.08319444** Longitude (Decimal Degrees): **-81.16205556**

RECOVERY DATA

How to Reach: From St. Cloud, travel south on Canoe Creek Road approximately 16 miles to an unpaved road drive running east from Canoe Creek Road and under the Florida Turnpike. Go easterly along dirt road 2 entrance to Camp Lonesome Conservation Area. Enter and go northerly .4 miles to locked access gate. Go through gate and go west and follow marked trail road approximately 3.5 miles to area known as Piss-Pot Hammock, go NNW .4 miles to north line of Conservation area; go east along trail road .6 miles to trail leading south; go south 0.1 miles to mark on the left. Mark is a standard SFWMD aluminum disk set in northeast corner of concrete well pad OSS-2 (CAMPLOE). SFWMD key is required for gate into property. Gate code #8659.

Description/Notes:

Notable Landmarks: **Well Site OSS-2 (CAMPLOE)**
 Other Source Benchmarks: **SFWMD Alum. Disks: OSS 2A 2019 Elev. = 78.97 feet (88) and OSS 2B 2019 Elev. = 78.59 feet (88)**

PICTURES

Aerial View of Overall Site



PICTURES

Site Sketch

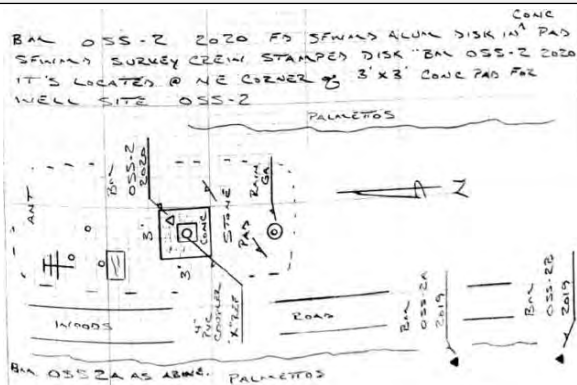



SOUTH FLORIDA WATER MANAGEMENT DISTRICT

Rev. 1/16

DESIGNATION: OSS-2A	PROJECT: CFWI CAMP LONESOME EAST
ESTABLISHED BY: PICKETT AND ASSOCIATES, INC	SURVEYOR: John M. Clyatt
RECOVERED BY:	DATE: May 16, 2019

GEOGRAPHIC POSITION

SECTION 6	TOWNSHIP 28 SOUTH	RANGE 32 EAST
COUNTY: OSCEOLA	NAME OF QUADRANGLE: HOLOPAW SW	
	GEOGRAPHIC INDEX OF QUAD: 3310	

HORIZONTAL DATUM: 1927 (1983) 2022 Other <u> </u> (circle one) ZONE (E) or W
VERTICAL DATUM: MSL 1929 (1988) 2022 Other <u> </u> (circle one)

VERTICAL ACCURACY: 1 2 **(3)**

STATE PLANE COORDINATE	(N) Y= 1,362,925.671	(E) X= 603,892.404	NAVD 88 EL. 78.97' NGVD 29 EL. 80.08'
------------------------	-----------------------------	---------------------------	--

CORPSCON 6.0.1 CONVERSION FACTOR (NAVD88 TO NGVD29): **1.112'**
(A U.S. Army Corps of Engineers Engineering Research and Development Center Topographic Engineering Center Alexandria, Virginia Windows-based program to convert coordinates and elevations between datum's using vertcon05.txt and vertcon05.05 files supplied by the U.S. Army Corps of Engineers South Atlantic Division, Jacksonville Fl.) ACTUAL NGS or (ngvd29.txt file) OPUS Ortho Height = 23.355 meters

LATITUDE: 28° 04' 58.91205" (N)	LONGITUDE: 81° 09' 43.63076" (W)	(NAD_83 (2011) EPOCH:2010.0000)
--	---	---------------------------------

RECOVERY DATA

Stamping: **OSS-2A 2019**

To Reach: From St. Cloud, travel south on Canoe Creek Road approximately 16 miles to an unpaved road drive running east from Canoe Creek Road and under the Florida Turnpike. Go easterly along dirt road 2 entrance to Camp Lonesome Conservation Area. Enter and go northerly .4 miles to locked access gate. Go through gate and go west and follow marked trail road approximately 3.5 miles to area known as Piss-Pot Hammock, go NNW .4 miles to north line of Conservation area; go east along trail road .6 miles to trail leading south; go south 0.1 miles to mark on the right. Mark is a standard SFWMD aluminum disk set in a 1-1/4" pipe with a concrete collar 3" below ground surface, 1' east of a metal post with survey marker decal. SFWMD key is required for gate into property.

NOTABLE LAND MARKS: Camp Lonesome Conservation Area ; Piss Pot Hammock

NGS-SOURCE BENCHMARK: N/A Determined by OPUS Solution

FIELD BOOK **972 PAGE 37**

PICTURES

Aerial Overall Site
From: Google Earth
Imagery Date: 2/11/17



SOUTH FLORIDA WATER MANAGEMENT DISTRICT

Rev. 1/16



Top View



SOUTH FLORIDA WATER MANAGEMENT DISTRICT

Rev. 1/16

DESIGNATION: OSS-2B		PROJECT: CFWI CAMP LONESOME EAST	
ESTABLISHED BY: PICKETT AND ASSOCIATES, INC		SURVEYOR: John M. Clyatt	
RECOVERED BY:		DATE: May 16, 2019	
GEOGRAPHIC POSITION			
SECTION 6	TOWNSHIP 28 SOUTH	RANGE 32 EAST	
COUNTY: OSCEOLA	NAME OF QUADRANGLE: HOLOPAW SW		
	GEOGRAPHIC INDEX OF QUAD: 3310		
HORIZONTAL DATUM: 1927 (1983) 2022 Other _____ (circle one) ZONE (E) or W			
VERTICAL DATUM: MSL 1929 (1988) 2022 Other _____ (circle one)			
VERTICAL ACCURACY: 1 2 (3)			
STATE PLANE COORDINATE	(N) Y= 1,362,012.889	(E) X= 603,892.289	NAVD 88 EL. 78.59' NGVD 29 EL. 79.70'
CORPSCON 6.0.1 CONVERSION FACTOR (NAVD88 TO NGVD29): + 1.112' <small>(A U.S. Army Corps of Engineers Engineering Research and Development Center Topographic Engineering Center Alexandria, Virginia Windows-based program to convert coordinates and elevations between datum's using vertcon05.txt and vertcon05.05 files supplied by the U.S. Army Corps of Engineers South Atlantic Division, Jacksonville FL.) ACTUAL NGS or (ngvd29.txt file) OPUS Ortho Height = 23.355 meters</small>			
LATITUDE: 28° 04' 49.87372" (N)		LONGITUDE: 81° 09' 43.61847" (W) (NAD 83 (2011) EPOCH:2010.0000)	
RECOVERY DATA			
Stamping: OSS-2B 2019			
<p>To Reach: From St. Cloud, travel south on Canoe Creek Road approximately 16 miles to an unpaved road drive running east from Canoe Creek Road and under the Florida Turnpike. Go easterly along dirt road 2 entrance to Camp Lonesome Conservation Area. Enter and go northerly .4 miles to locked access gate. Go through gate and go west and follow marked trail road approximately 3.5 miles to area known as Piss-Pot Hammock, go NNW .4 miles to north line of Conservation area; go east along trail road .6 miles to trail leading south; go south 0.25 miles to mark on the right. Mark is a standard SFWMD aluminum disk set in a 1-1/4" pipe with a concrete collar 3" below ground surface, 1' east of a metal post with survey marker decal. SFWMD key is required for gate into property.</p>			
NOTABLE LAND MARKS: Camp Lonesome Conservation Area ; Piss Pot Hammock			
NGS-SOURCE BENCHMARK: N/A Determined by OPUS Solution			
FIELD BOOK 972 PAGE 37			
PICTURES			
Aerial Overall Site From: Google Earth Imagery Date: 2/11/17			



SOUTH FLORIDA WATER MANAGEMENT DISTRICT

Rev. 1/16



Top View

SEC	LN	TYP	ZB	ZGE	ZZ
		CONT'D	FROM	PG-56	
STA	PT #		EL	BML EL	
OSS ZA	4			78.97	
REF MARK "X"	7		84.106		
NE CONC	8		79.985		
SE PAD	9		79.97		
SW CONC	10		79.916		
NW PAD	11		79.924		
NE NATL	12		79.7		
SE GRDS	13		79.3		
SW NATL	14		79.2		
NW GRDS	15		79.7		
OSS ZA	16		78.97	78.97	

STRICKLAND
 WISE
 SCHAUER

COMMENTS

BML OSS-2A 2019 SEE PG-56

REF "X" MARK CHISELED ON WEST SIDE OF 4" PVC COUPLER

NE CONC PAD

SE " "

SW " "

NW " "

NE NATURAL GRASS PALMETTOS

SE " " " "

SW " " " "

NW " " " "

BML OSS-2A 2019 AS ABOVE