



SOUTH FLORIDA WATER MANAGEMENT DISTRICT

Rev. 1/16

DB Hydro Station Name: SEBRNG		DB Hydro Site Name: SEBRNG		Date of Field Work: 20-jun-17
Party Chief: Wise		Field Book: Misc 7B	Page 67	Prepared by: H. Ehmke
SITE SPECIFIC DATA				
Site Benchmark: SEBRING MW 2004		Benchmark Elevation (NAVD88) 61.95	Corpscon 6.0.1 Conversion Factor (NAVD88 to NGVD29) +1.089	
Reference Elevation(s) (NAVD88): 65.26		Existing Brass Tag Elevation (Datum): 66.35 1-10-08 WOOLPERT	Calibration Port Elevation(s) (NAVD88): Not applicable	
Ground Elevation (NAVD88): 62.0			Pad Elevation (NAVD88): Not applicable	
GEOGRAPHIC DATA				
Section 5		Township 35 South		Range 30 East
Benchmark	Latitude: 27°27'30.541"		Longitude: 81°21'15.337"	Source: OPUS session on benchmark
	State Plane Coordinates		Northing (Y) = 1136002.452	Easting (X) = 541283.619

Notes:

NAVD88 – North American Vertical Datum of 1988

NGVD29- National Geodetic Vertical Datum of 1929

Corpscon 6.0.1 - A U.S. Army Corps of Engineers Engineering Research and Development Center Topographic Engineering Center Alexandria, Virginia Windows-based program to convert coordinates and elevations between datum's using vertcon05.txt and vertcon05.05 files supplied by the U.S. Army Corps of Engineers South Atlantic Division, Jacksonville Fl.

PICTURES

Aerial Overall Site



Not to scale (esri product)



SOUTH FLORIDA WATER MANAGEMENT DISTRICT

Rev. 1/16

Overall

PROPERTY OF:
South Florida Water Management District
RTU Name: **SEBRNG**
Contact SCADA: 561-682-2047

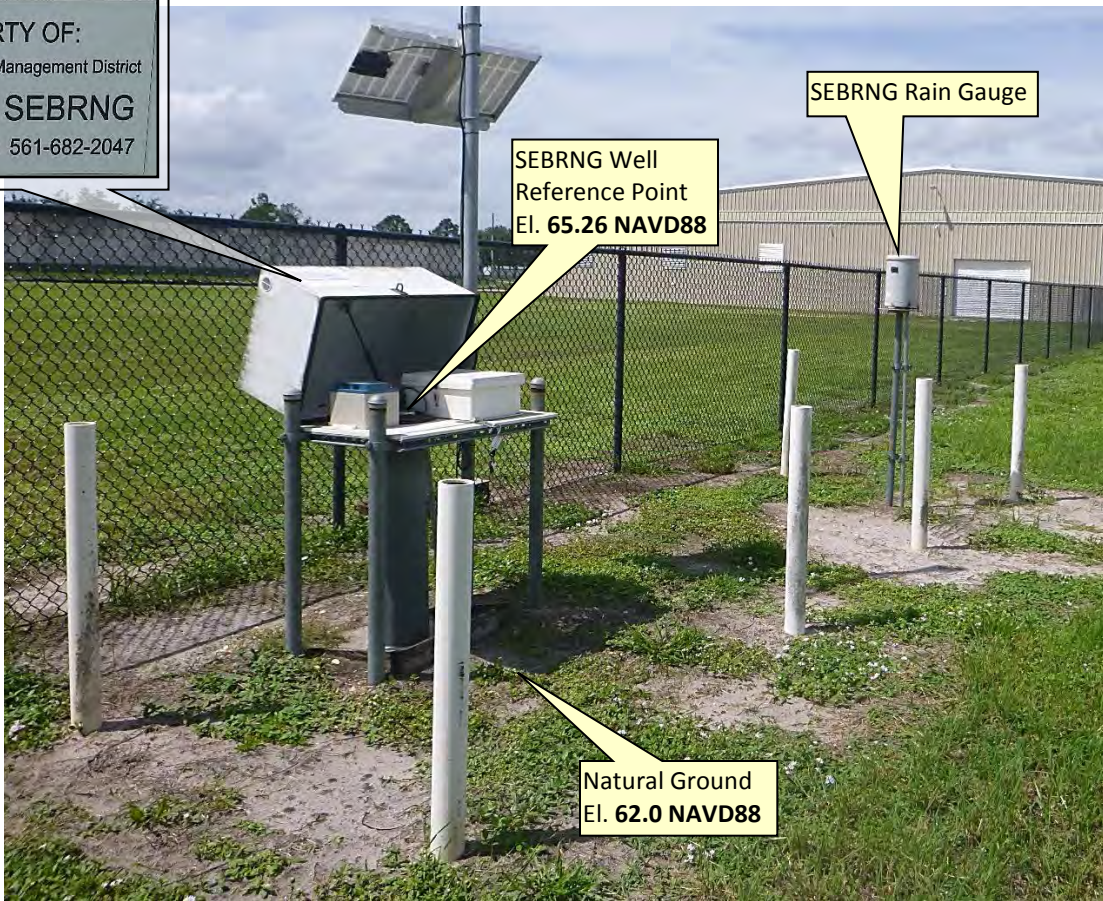

Looking Southwesterly (oblique not to scale) (20-jun-17)

SEBRNG Well Head

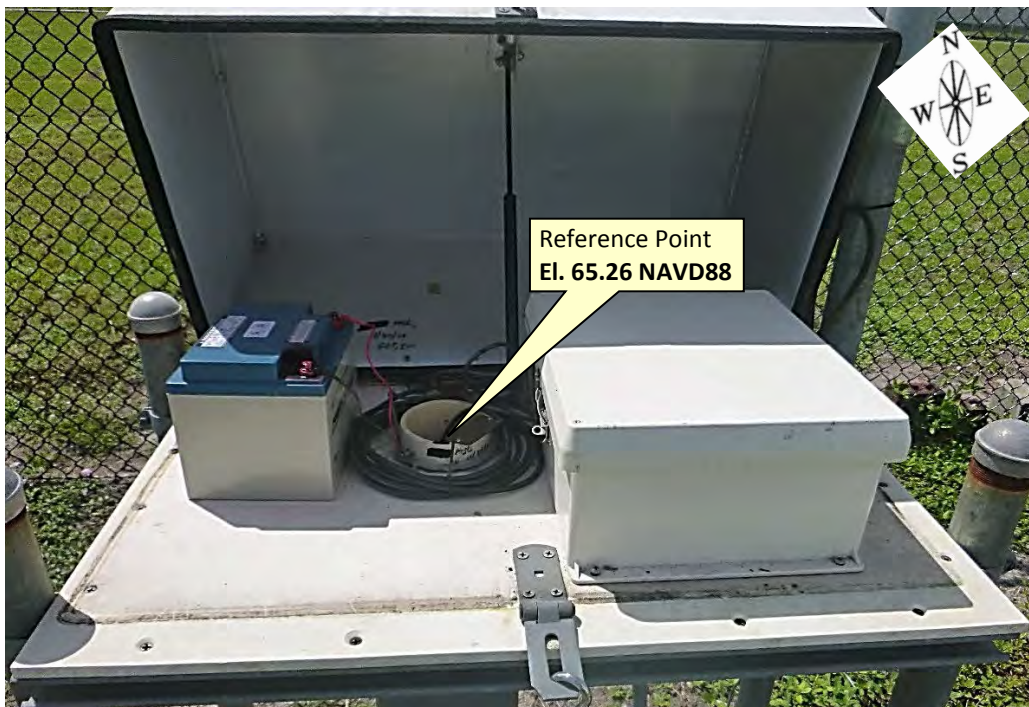

Looking Southwesterly (oblique not to scale) (20-jun-17)



SOUTH FLORIDA WATER MANAGEMENT DISTRICT

Rev. 1/16

Old brass tag and reference point



Top view (Not to scale) (20-jun-17)

Old NGVD29 Brass Tag Close-up (*to be removed*)

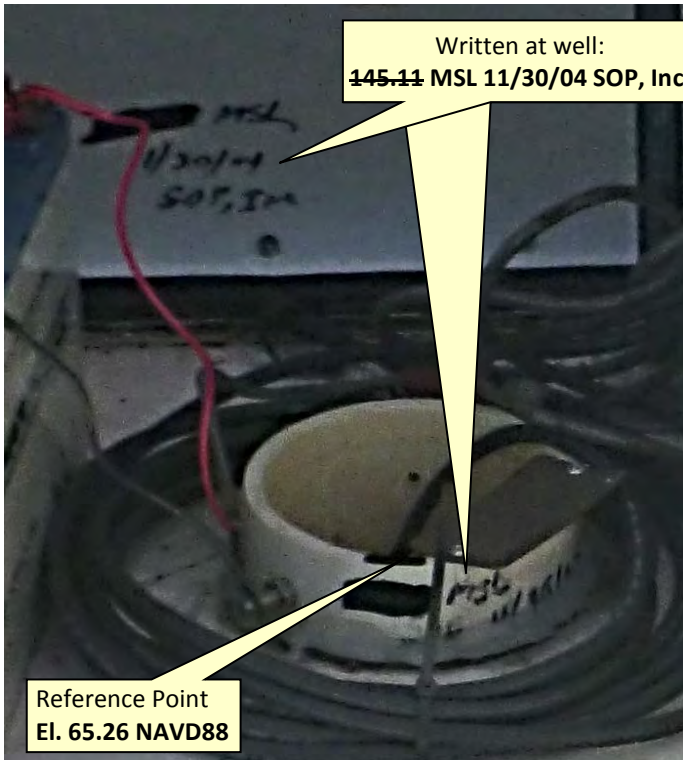
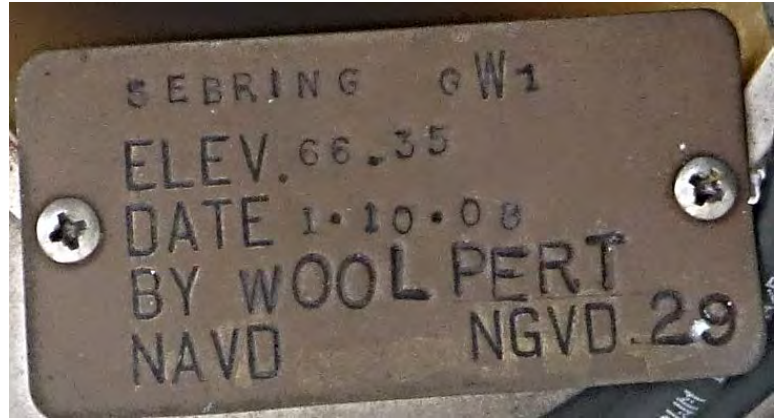

Side view (Oblique Not to scale) (20-jun-17)

New NAVD88 Brass Tag Close-up (*to be added*)





SOUTH FLORIDA WATER MANAGEMENT DISTRICT

Rev. 1/16

DESIGNATION: SEBRING MW	PROJECT: SEBRNG Well Site
ESTABLISHED BY: SOUTH FLORIDA WATER MANAGEMENT DISTRICT	SURVEYOR: Wise
RECOVERED BY: SOUTH FLORIDA WATER MANAGEMENT DISTRICT	DATE: 20-jun-17

GEOGRAPHIC POSITION

SECTION 5	TOWNSHIP 35 SOUTH	RANGE 30 EAST
------------------	--------------------------	----------------------

COUNTY: Highlands	NAME OF QUADRANGLE: Lorida
	GEOGRAPHIC INDEX OF QUAD: 2811

HORIZONTAL DATUM: 1927 **(1983)** Other ____ (circle one) ZONE **(E)** or W

VERTICAL DATUM: MSL 1929 **(1988)** Other ____ (circle one)

VERTICAL ACCURACY: 1 2 **(3)**

STATE PLANE COORDINATE	(N) Y= 1136002.452	(E) X= 541283.619	NAVD 88 EL. 61.95
			NGVD 29 EL. 63.042

CORPSCON 6.0.1 CONVERSION FACTOR (NAVD88 TO NGVD29): **+1.089**

LATITUDE: **27°27'30.541"** LONGITUDE: **81°21'15.337"** (OPUS Session)

RECOVERY DATA

Stamping: **BM SEBRING 2004 MW**

To Reach: From the intersection of Midway Drive and Haywood Taylor Boulevard near the entrance to Sebring Airport: go northeasterly along Haywood Boulevard 0.4 of a mile to Webster Turn Drive on the left; turn left onto Webster Turn Drive and go 0.3 of a mile to Boeing Street on the right; turn right onto Boeing Street and go 200 feet to the entrance to the Sebring Water Treatment Plant on the right and the station location on the base for the support of the old removed raised water tank on the southeast side of the building. The benchmark is a South Florida Water Management District (SFWMD) aluminum disk grouted into the concrete and stamped "BM SEBRING MW 2004". Access is thru a locked gate to chain link enclosure. The keys may be obtained from airport operations customer service telephone number 863-655-6444 Extension 102.

NGS SOURCE BENCHMARK: **SUPPLY (AF5470)**

FIELD BOOK: **ESDA 6 PAGE 56**

PICTURES

Overall Site

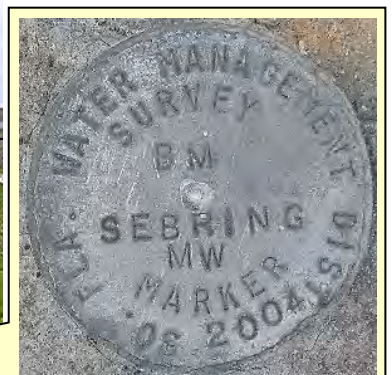

Benchmark:
"SEBRING MW"
 Latitude: **27°27'30.541"**
 Longitude: **81°21'15.337"**
 El. **61.95 NAVD88**

Looking Northeasterly Oblique Not to scale (20-jun-17)



SOUTH FLORIDA WATER MANAGEMENT DISTRICT

Rev. 1/16

Field Notes: Misc 7B page 67

67 MISC FB # 7B 6-20-17

SEC	5	TWP	35	RGE	30
ESTABLISH NAVD 88 ELEVATION ON GROUND WATER WELL SEBRING					
STA	+	HI	-	EL	BM EL
BM	4.89	66.84			61.95
GROUND			4.80	62.04	
REF			1.58	65.26	
BM		4.89		61.95	

OPUS FOUND BM SEBRING 2004
FILE NAME: SEBRING MW

START	11:30 AM	HI	1.5 M
END	1:40 PM	CKE	8425

MISC FB # 7B 6-20-17 67

X M. WISE
B STRICKLAND

COMMENTS

BM SEBRING SFNMD ALUM DISC STAMPED SEBRING MW 2004 IN CONCRETE SLAB GOOD CONDITION

GROUND SLAB AT WELL

REFERENCE IS MAGIC MARKER MARK ON NW SIDE OF 4" PVC PIPE LOCATED UNDER LOCK BOX.

BM SEBRING SAME AS ABOVE

The diagram shows a rectangular building at the top right. To its left is a 'WATER TREATMENT TANK'. Below the tank are two vertical rectangular structures labeled 'C/L'. A 'BM SEBRING' is marked with a triangle and 'A' near the first 'C/L'. Below the 'C/L' structures is a 'WELL' with a 'GEN' (generator) nearby. A horizontal line at the bottom is labeled 'C/L FENCE'. A north arrow is drawn in the upper left quadrant of the diagram.

SEC 5 TWP 35 RGE 30

ESTABLISH NAVD 88 ELEVATION ON
GROUND WATER WELL SEBRING

STA	+	HI	-	EL	BM EL
BM	4.89	66.84			61.95
GROUND			4.80	62.04	
REF			1.58	65.26	
BM			4.89	61.95	

OPUS FOUND BM SEBRING 2004
FILE NAME: SEBRING MW

START 11:30 AM

HI 1.5 M

END 1:40 PM

OXEE 8425

π □ M. WISE
δ STRICKLAND

COMMENTS

BM SEBRING SFNMD ALUM DISC STAMPED SEBRING MW
2004 IN CONCRETE SLAB GOOD CONDITION

GROUND SHOT AT WELL

REFERENCE IS MAGIC MARKER MARK ON NW SIDE OF 4"
PVC PIPE LOCATED UNDER LOCK BOX.

BM SEBRING SAME AS ABOVE

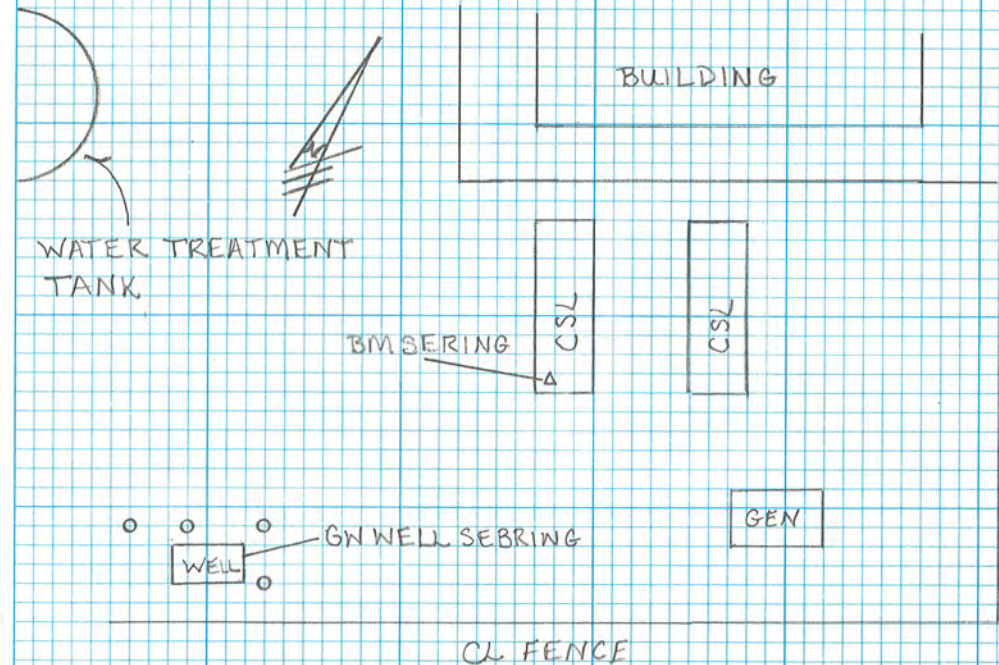

REGISTRATION WORKSHEET - SEBRNG Addendum

Site Name: **SEBRNG** Today's Date: **7/5/2017** Type Recorder: **CR1000**
 Activity: **Addendum** Effective Date: _____ Start Date of Data : _____
 Customer: **Steve Krupa** Bus. Area: **5720** Agency: **SFWMD** Internal Order: _____
 Project Manager: **Howard Ehmke** Bus. Area: **Survey & Mapping** Agency: **SFWMD** Fund: _____
 Contract #: _____
 Project Name: _____ Legal Mandate: _____

Short Common Name / Description: _____

Proj. Mgr. Notes: This addendum was performed to add NAVD 88 surveying data for the reference elevation. To convert to NGVD 29 add +1.089ft.

Site Directions: From the Okeechobee Field Station drive north on US98 for approximately 37 miles to Haywood Taylor Rd.; turn right on to Haywood Taylor Road. Follow Haywood Taylor Road for approximately 1.9 miles to Boeing Drive; turn left on to Boeing Drive. The monitoring site is located within the fenced area surrounding the water treatment plant. If there is not an Abloy "O" lock on the gate call (863) 655-6444 and request someone from the utilities department

Site Address (if any): _____

Transportation: _____ Lock type or combination: **Abloy S** # _____

Recorder Location/Purpose: **Stand-Alone Recorder (Non-Flow Site)** Structure Type: _____

Array ID Configuration table attached **NO**

SURVEY INFORMATION

B.M. Elevation: **61.95 ft** Date: **4/8/2004** Stamp: **BM SEBRING MW 2004**
 Agency: **SFWMD** Type: **ALUM** Datum: **NAVD 88**

Benchmark Location/ Description: Marker is an aluminum disk, stamped "South Florida Water Management District Survey Marker "BM SEBRING MW 2004 ".

COMMUNICATIONS INFORMATION

Communications System: _____ Loggernet Server: _____ Loggernet IP Address: _____
 Tower: _____ Communication Type: _____ R.F. Code/Modem Address: _____ R.F. Access Point: _____
 Phone Number: _____
 RTU Address: _____ Gateways: _____

WELL INFORMATION

Sensor	Customer Ref	Ref Elev	Elev Date	Top of Well	Bottom of Well	Ground Elev	Benchmark Elev	Benchmark Datum	Ref Elevation Location
GW1	SEBRNG	65.26	1/10/2008	65.26			61.65	NAVD 88	Black mark on rim of PVC well pipe

Sensor	GW Sensor Location Offset	Meas Pt Elevation	GW Land Elevation	Depth of Well	Type of Well	Top of Monitored Interval	Base of Monitored Interval	Parameter Transmitted								
GW1																

COORDINATE INFORMATION

Item/Param	Lat	Long	X-Coord	Y-Coord	Sec	Township	Range	Quad	Basin	County	Description
GW1	27 27 30	81 21 15.53			5	35	30			Highlands	

DBHYDRO | by station

STATION INFORMATION

Station	SEBRNG
Site	SEBRNG
Type	WELL
Latitude (ddmmss.sss)	272729.932
Longitude (ddmmss.sss)	812115.455
X Coord (ft) NAD83	541273
Y Coord (ft) NAD83	1135941
County	Highlands
Basin	ARBUCKLE CREEK
Section	5
Township	35
Range	30
Show Map	Google Map
Well Info	Info
Description	SEBRING REGIONAL AIRPORT GROUNDWATER
Notes	
Nearby Stations	Nearby Stations
Attachments	None Available

Query returned 1 station record(s).

[Get Time Series Data](#)