



SOUTH FLORIDA WATER MANAGEMENT DISTRICT

Rev. 1/16

DB Hydro Station Name: STL-192		DB Hydro Site Name: STL192	Date of Field Work: 27-jun-17
Party Chief: Wise	Field Book: Misc 7B	Page 69	
Site Benchmark: K483 (AJ3238)	Benchmark Elevation (NAVD88) 15.436	Corpscon 6.0.1 Conversion Factor (NAVD88 to NGVD29) +1.499	
Reference Elevation(s) (NAVD88): 19.93	Existing Tag Elevation (Datum): None	Calibration Port Elevation(s) (NAVD88): Not applicable	
Ground Elevation (NAVD88): 20.1		Pad Elevation (NAVD88):	
Latitude: 27°28'06.224"		Longitude: 80°20'18.635" (established from FDOT Network)	
Northing (Y) = 1140013.13	Easting (X) = 870664.01	Taken in the center of the well cap (established from FDOT Network)	

Notes:

FDOT – Florida Department of Transportation

NAVD88 – North American Vertical Datum of 1988

NGVD29 - National Geodetic Vertical Datum of 1929

Corpscon 6.0.1 - A U.S. Army Corps of Engineers Engineering Research and Development Center Topographic Engineering Center Alexandria, Virginia Windows-based program to convert coordinates and elevations between datum's using vertcon05.txt and vertcon05.05 files supplied by the U.S. Army Corps of Engineers South Atlantic Division, Jacksonville FL.

PICTURES

Overall Site



Not to scale (esri product)



SOUTH FLORIDA WATER MANAGEMENT DISTRICT

Rev. 1/16

Overall Site

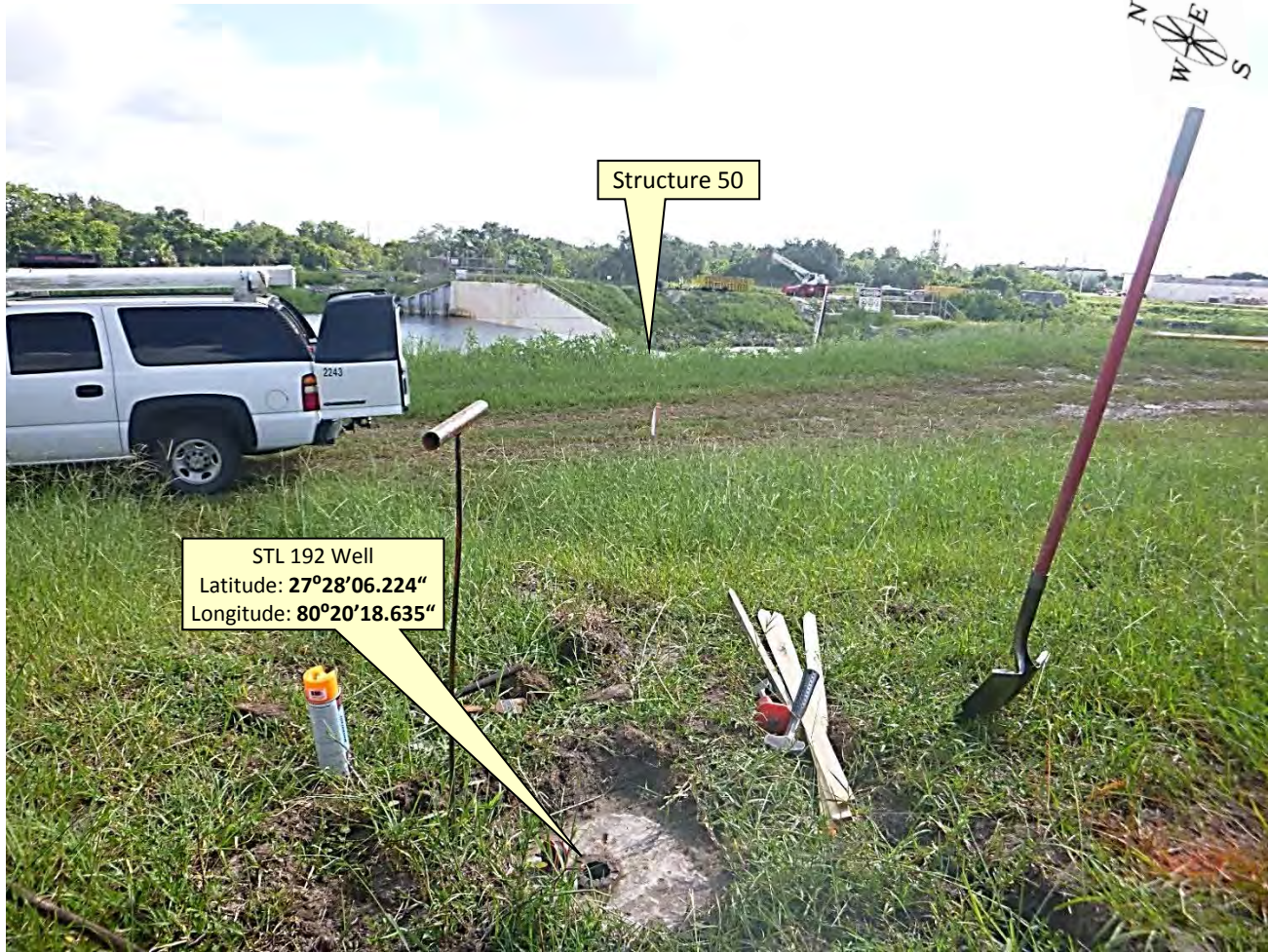

Looking Northeasterly (Not to scale) (27-jun-17)

STL 192 Capped Well



STL192 Uncapped Well

Reference Point
El. 19.93 NAVD88





SOUTH FLORIDA WATER MANAGEMENT DISTRICT

Rev. 1/16

Field Notes (Misc 7B page 69)

69 MISC FB # 7B 6-27-17					
SEC	4	TWP	35	RGE	40
ESTABLISH NAVD 88 EL @ STL-192 G-W WELL					
STA	F	HI	-	EL	BM EL
BM 483	5.75			21.19	15.44 NAVD 88
GRND			1.10	20.09	
REF			1.26	19.93	
BM 483		5.75		15.44	15.44

MISC FB # 7
6-27-17
69

III M. WISE
 X STRICKLAND

COMMENTS

BM 483 FDEP BRASS DISC STAMPED 483 1999 IN CONCRETE GOOD CONDITION

GROUND SHOT AT WELL

REFERENCE IS X-MARK IN NORTH WEST CORNER OF METAL FLANGE AROUND 2" PIPE

BM 483 SAME AS ABOVE

NOTE: WELL LOCATION ESTABLISHED USING FDOT NETWORK

N - 1140613.13
E - 870664.01

SEC 4 TWP 35 RGE 40

ESTABLISH NAVD 88 EL @ STL-192
GN WELL

STA	T	HI	—	EL	BM EL
BM K483	5.75			21.19	15.44 NAVD 88

GRND 1.10 20.09

REF 1.26 19.93

BM483 5.75 15.44 15.44

M. WISE
STRICKLAND

COMMENTS
BM K483 FDEP BRASS DISC STAMPED K483 1999 IN
CONCRETE GOOD CONDITION

GROUND SHOT AT WELL

REFERENCE IS X-MARK IN NORTH WEST CORNER OF METAL
FLANGE AROUND 2" PIPE

BM 483 SAME AS ABOVE

NOTE: WELL LOCATION
WELL STL192 ESTABLISHED USING FDOT
N-1140013.13 NETWORK
E-870664.01

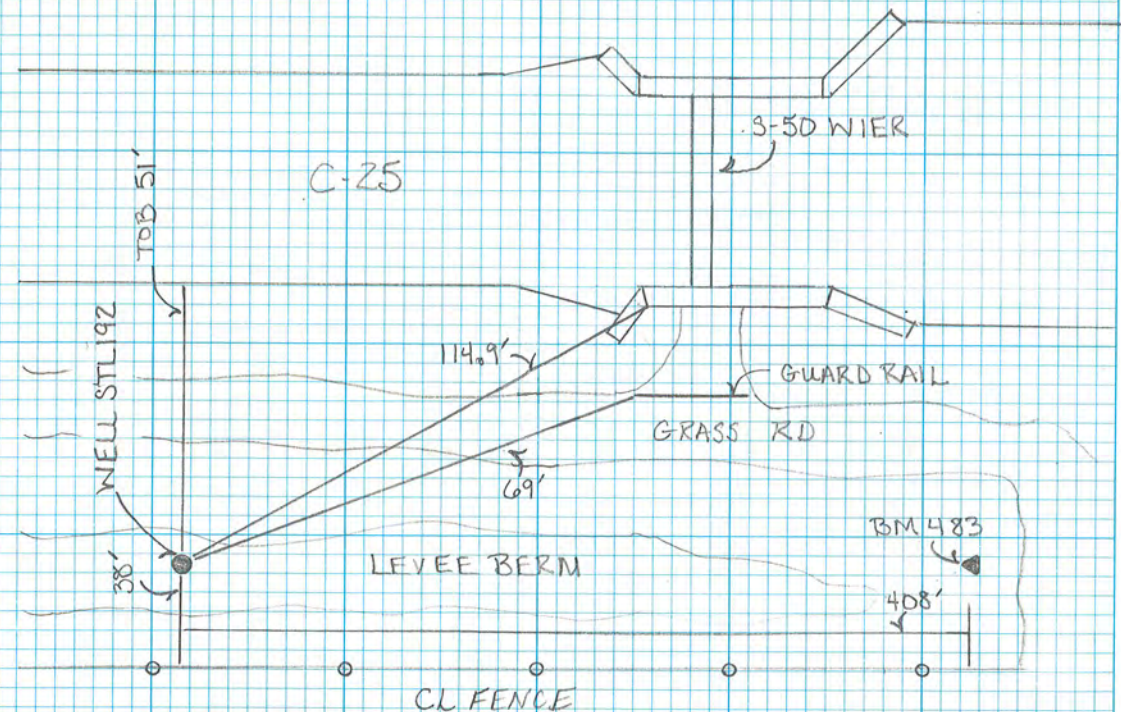

From the "ngvd29.txt" file provided by NGS for the CERP Geodetic Vertical Control Project.						
Line/Part: L26043		SSN+: mark floated, SSN*: mark constrained, SSN#: mark floated & constrained				
Mark ID	SSN	PID	Designation	Geopotential	Elevation	Codes
444	0004	AJ3238	K 483	5.0577	5.1610	

The NGS Data Sheet

See file [dsdata.pdf](#) for more information about the datasheet.

```

PROGRAM = datasheet95, VERSION = 8.12.1
1      National Geodetic Survey,  Retrieval Date = JUNE 27, 2017
AJ3238 *****
AJ3238 DESIGNATION - K 483
AJ3238 PID - AJ3238
AJ3238 STATE/COUNTY- FL/ST LUCIE
AJ3238 COUNTRY - US
AJ3238 USGS QUAD - FORT PIERCE (1983)
AJ3238
AJ3238 *CURRENT SURVEY CONTROL
AJ3238
AJ3238* NAD 83(1986) POSITION- 27 28 06. (N) 080 20 14. (W) SCALED
AJ3238* NAVD 88 ORTHO HEIGHT - 4.705 (meters) 15.44 (feet) ADJUSTED
AJ3238
AJ3238 GEOID HEIGHT - -27.538 (meters) GEOID12B
AJ3238 DYNAMIC HEIGHT - 4.698 (meters) 15.41 (feet) COMP
AJ3238 MODELED GRAVITY - 979,149.0 (mgal) NAVD 88
AJ3238
AJ3238 VERT ORDER - SECOND CLASS I
AJ3238
AJ3238.The horizontal coordinates were scaled from a topographic map and have
AJ3238.an estimated accuracy of +/- 6 seconds.
AJ3238.
AJ3238.The orthometric height was determined by differential leveling and
AJ3238.adjusted by the NATIONAL GEODETIC SURVEY
AJ3238.in October 2001.
AJ3238
AJ3238.Significant digits in the geoid height do not necessarily reflect accuracy.
AJ3238.GEOID12B height accuracy estimate available here.
AJ3238
AJ3238.The dynamic height is computed by dividing the NAVD 88
AJ3238.geopotential number by the normal gravity value computed on the
AJ3238.Geodetic Reference System of 1980 (GRS 80) ellipsoid at 45
AJ3238.degrees latitude (g = 980.6199 gals.).
AJ3238
AJ3238.The modeled gravity was interpolated from observed gravity values.
AJ3238
AJ3238; North East Units Estimated Accuracy
AJ3238;SPC FL E - 347,470. 265,510. MT (+/- 180 meters Scaled)
AJ3238
AJ3238_U.S. NATIONAL GRID SPATIAL ADDRESS: 17RNL654384(NAD 83)
AJ3238
AJ3238 SUPERSEDED SURVEY CONTROL
AJ3238
AJ3238.No superseded survey control is available for this station.
AJ3238
AJ3238_MARKER: DD = SURVEY DISK
AJ3238_SETTING: 7 = SET IN TOP OF CONCRETE MONUMENT
AJ3238_STAMPING: K 483 1999
AJ3238_MARK LOGO: FLDEP
AJ3238_MAGNETIC: N = NO MAGNETIC MATERIAL

```

AJ3238_STABILITY: C = MAY HOLD, BUT OF TYPE COMMONLY SUBJECT TO
 AJ3238+STABILITY: SURFACE MOTION
 AJ3238_SATELLITE: THE SITE LOCATION WAS REPORTED AS SUITABLE FOR
 AJ3238+SATELLITE: SATELLITE OBSERVATIONS - 1999

AJ3238	HISTORY	- Date	Condition	Report By
AJ3238	HISTORY	- 1999	MONUMENTED	FLDEP
AJ3238	HISTORY	- 20050805	GOOD	GCVI

AJ3238
 AJ3238 STATION DESCRIPTION
 AJ3238

AJ3238'DESCRIBED BY FL DEPT OF ENV PRO 1999 (JLM)
 AJ3238'THE MARK IS ABOUT 38.5 MI (62.0 KM) NORTHEAST OF OKEECHOBEE, 12.0 MI
 AJ3238'(19.3 KM) SOUTH OF VERO BEACH, 1.7 MI (2.7 KM) NORTH OF FT PIERCE, IN
 AJ3238'SECTION 4, TOWNSHIP 35 SOUTH, RANGE 40 EAST, TO REACH THE MARK FROM
 AJ3238'THE JUNCTION OF U.S. HIGHWAY 1 AND STATE ROAD A1A SOUTH (SEAWAY DRIVE)
 AJ3238'IN FORT PIERCE, GO NORTH OF U.S. HIGHWAY 1 FOR 0.5 MI (0.8 KM) TO THE
 AJ3238'JUNCTION OF AVENUE O ON THE LEFT, TURN LEFT ON AVENUE O AND GO WEST
 AJ3238'FOR 0.45 MI (0.72 KM) TO THE INTERSECTION OF 13TH STREET, TURN RIGHT
 AJ3238'ON 13TH STREET AND GO NORTH FOR 0.3 MI (0.5 KM) TO THE MARK ON THE
 AJ3238'LEFT, SET IN THE TOP OF A ROUND CONCRETE MONUMENT FLUSH WITH THE
 AJ3238'GROUND AND LEVEL WITH THE BERM ROAD. LOCATED 291.5 FT (88.8 M)
 AJ3238'SOUTHEAST OF THE EAST END OF THE GUARDRAIL AT STRUCTURE 50, 52.5 FT
 AJ3238'(16.0 M) SOUTH OF THE SOUTH EDGE OF CANAL 25, 40.2 FT (12.3 M) WEST
 AJ3238'OF THE APPROXITELY CENTERLINE OF THE EXTENDED CENTERLINE OF 13TH
 AJ3238'STREET, 11.2 FT (3.4 M) WEST OF THE NORTHEAST CORNER OF THE FENCE, 8.6
 AJ3238'FT (2.6 M) EAST OF A POWERPOLE WITH 4 GUY WIRES AND 1.4 FT (0.4 M)
 AJ3238'NORTH OF A CHAINLINK FENCE.

AJ3238
 AJ3238 STATION RECOVERY (2005)
 AJ3238
 AJ3238'RECOVERY NOTE BY G.C.Y., INCORPORATED 2005 (JES)
 AJ3238'RECOVERED IN GOOD CONDITION.

*** retrieval complete.
 Elapsed Time = 00:00:01



Office

Project

27 June 2017

INPUT

State Plane, flhpgn - Florida HPGN
0901 - Florida East, U.S. Feet
Vertical - NAVD88, U.S. Feet

OUTPUT

Geographic, flhpgn - Florida HPGN
Vertical - NGVD29 (Custom), U.S. Feet

STL192

1/1

Northing/Y: 1140013.13

Easting/X: 870664.01

Elevation/Z: 0

Convergence: 0 18 18.46568

Scale Factor: 0.999993920

Combined Factor: 0.999998238

Latitude: 27 28 06.22408

Longitude: 80 20 18.63506

Elevation/Z: 1.499

Remark:

Corpscon v6.0.1, U.S. Army Corps of Engineers

DBHYDRO | by station

STATION INFORMATION

Station	STL-192
Site	STL192
Type	WELL
Latitude (ddmmss.sss)	272806.214
Longitude (ddmmss.sss)	802018.623
X Coord (ft) NAD83	870665
Y Coord (ft) NAD83	1140012
County	St. Lucie
Basin	MID COASTAL
Section	4
Township	35
Range	40
Show Map	Google Map
Well Info	Info
Description	HOWDI:272806080201801
Notes	
Nearby Stations	Nearby Stations
Attachments	Show Attachments

Query returned 1 station record(s).

[Get Time Series Data](#)