



# SOUTH FLORIDA WATER MANAGEMENT DISTRICT

Rev. 1/16

SCADA RTU Station Name: <b>C43204A</b> <b>C43204B</b>	DB Hydro Station Name: <b>C43204G1</b> <b>C43204G2</b>	DB Hydro Site Name: <b>C43204</b>	Agency: <b>S.F.W.M.D</b>	Date of Field Work: <b>6/17/2019</b>
Party Chief: <b>EBANKS</b>	Field Book: <b>SCADA FB#13</b>	Page(s): <b>20</b>	Prepared by: <b>E. Ebanks</b>	

## SITE SPECIFIC DATA

Site Benchmark(s): <b>PZ204A 2018</b> <b>PZ204B 2018</b>	Benchmark Elevation(s) (NAVD88) <b>23.61 feet</b> <b>23.60 feet</b>	Corpscon 6.0.1 Conversion Factor (NAVD88 to NGVD29) <b>+1.26 feet</b>
Reference Elevation(s) (NAVD88): <b>C43204A = 23.61 feet</b> <b>C43204B = 23.60 feet</b>		Calibration Port Elevation(s) (NAVD88): <b>N/A</b>
Ground Elevation (NAVD88): <b>20.0 feet</b>		Pad Elevation (NAVD88): <b>20.31 feet</b>

## GEOGRAPHIC DATA

Section <b>27</b>		Township <b>43 South</b>	Range <b>28 East</b>
Well(s) Gate(s)  Benchmark(s)	Latitude:	Longitude:	Source: Scaled pick point aerial esri product
	<b>C43204A 26°42'10.8"</b> <b>C43204B 26°42'10.7"</b>	<b>C43204A -81°30'07.3"</b> <b>C43204B -81°30'07.1"</b>	
State Plane Coordinates		Northing (Y) = <b>N/A</b>	Easting (X) = <b>N/A</b>

**Notes:** NAVD88 – North American Vertical Datum of 1988; NGVD29- National Geodetic Vertical Datum of 1929; Corpscon 6.0.1 - A U.S. Army Corps of Engineers Engineering Research and Development Center Topographic Engineering Center Alexandria, Virginia Windows-based program to convert coordinates and elevations between datum's using vertcon05.txt and vertcon05.05 files supplied by the U.S. Army Corps of Engineers South Atlantic Division, Jacksonville Fl.

## PICTURES

### Aerial of Overall Site

Not to scale (esri product)

**Benchmark "PZ204B 2018"**  
Latitude: **26°42'10.9"**  
Longitude: **-81°30'07.2"**  
El. **19.45 feet NAVD88**

**C43204A**  
Latitude: **26°42'10.8"**  
Longitude: **-81°30'07.3"**

**Benchmark "PZ204A 2018"**  
Latitude: **26°42'10.7"**  
Longitude: **-81°30'07.1"**  
El. **20.37 feet NAVD88**

**C43204B**  
Latitude: **26°42'10.7"**  
Longitude: **-81°30'07.1"**



# SOUTH FLORIDA WATER MANAGEMENT DISTRICT

Rev. 1/16

## C43204 Piezometer Well Site

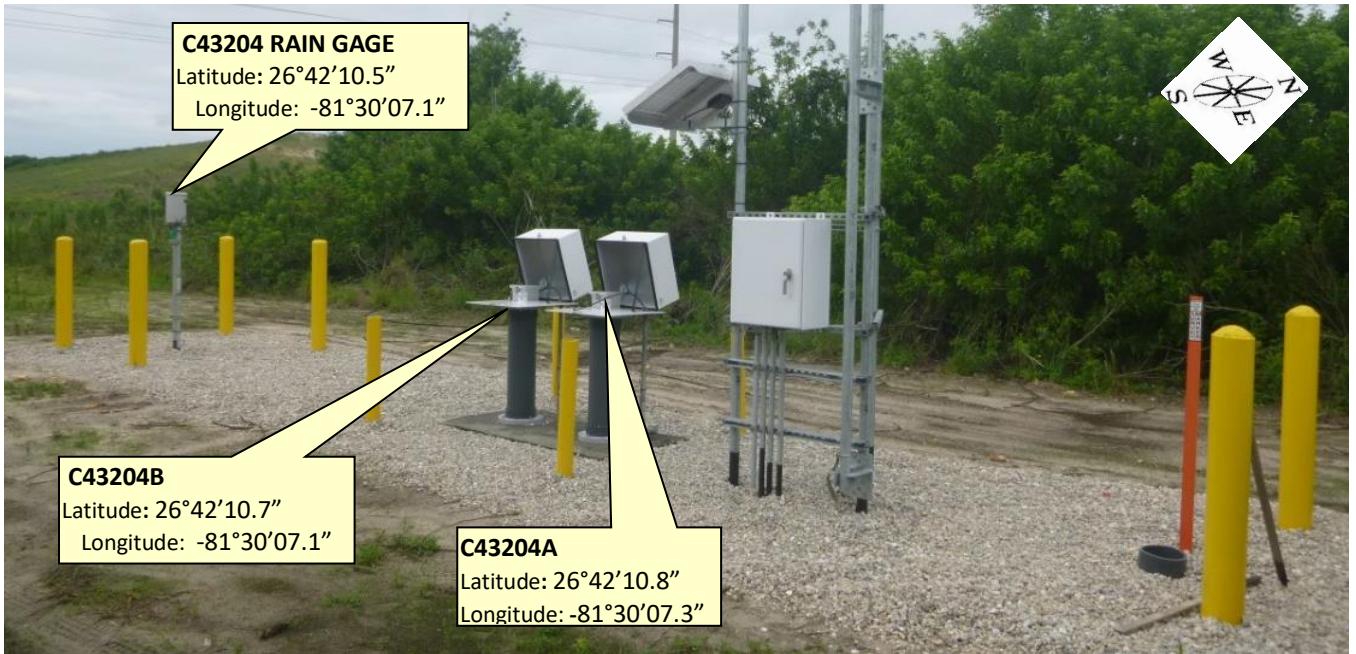





# SOUTH FLORIDA WATER MANAGEMENT DISTRICT

Rev. 1/16

## C43204 Piezometer Wells

**C43204A**  
Reference Point Elev.  
= 23.61 (NAVD88)



**C43204B**  
Reference Point Elev.  
= 23.60 (NAVD88)

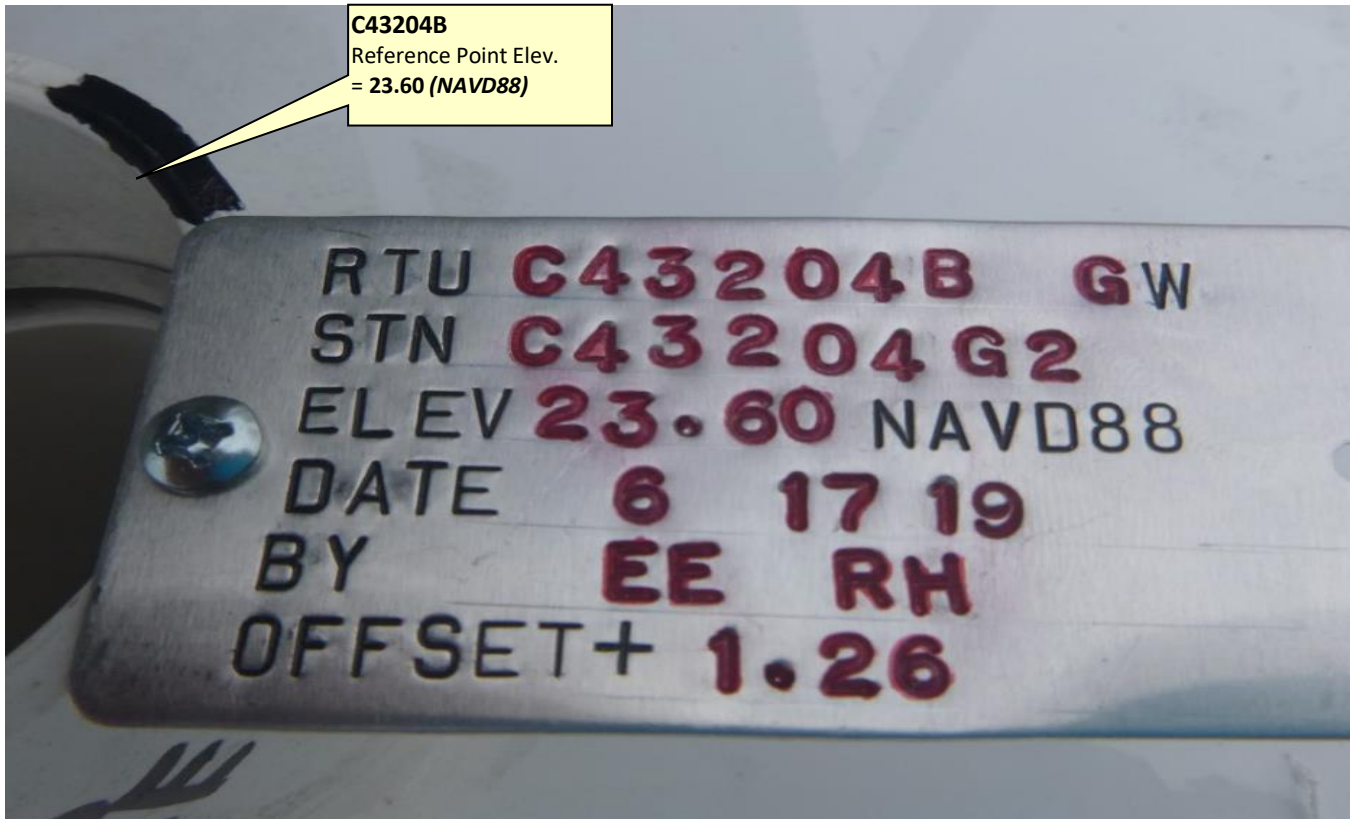



# SOUTH FLORIDA WATER MANAGEMENT DISTRICT

Rev. 1/16

**"C43204A 2018" Benchmark Location**  
Benchmark: El. 20.37 feet (NAVD88)

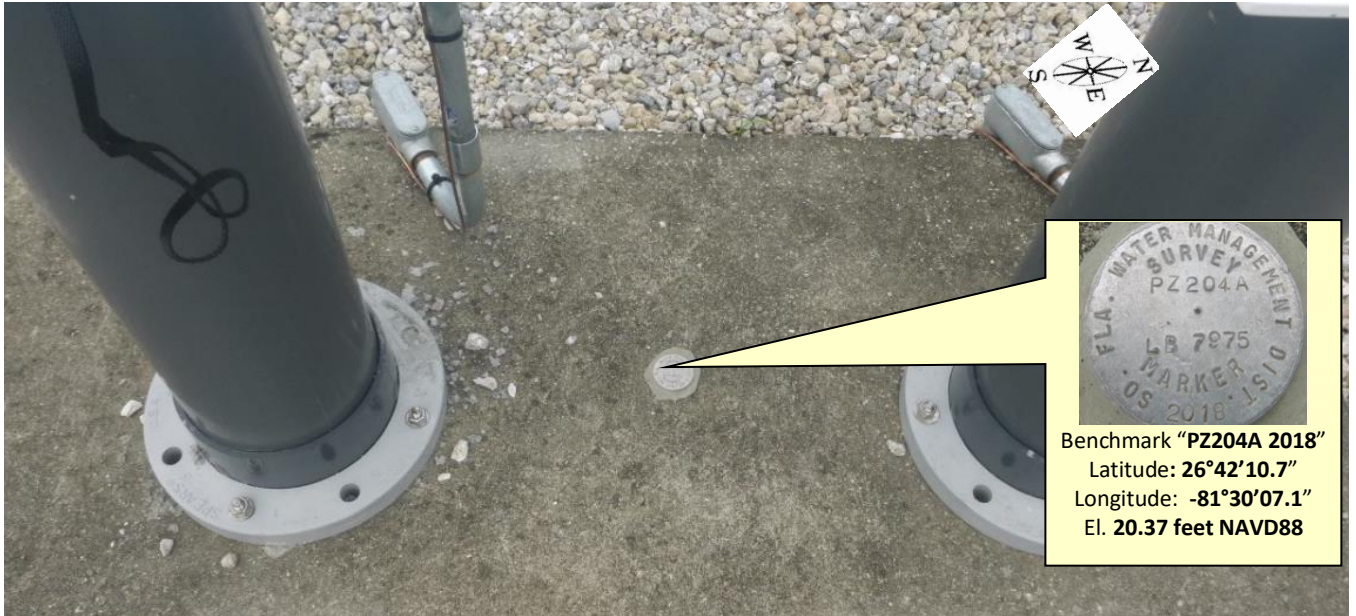





# SOUTH FLORIDA WATER MANAGEMENT DISTRICT

Rev. 1/16

## "C43204B 2018" Benchmark Location Benchmark: El. 19.45 feet (NAVD88)

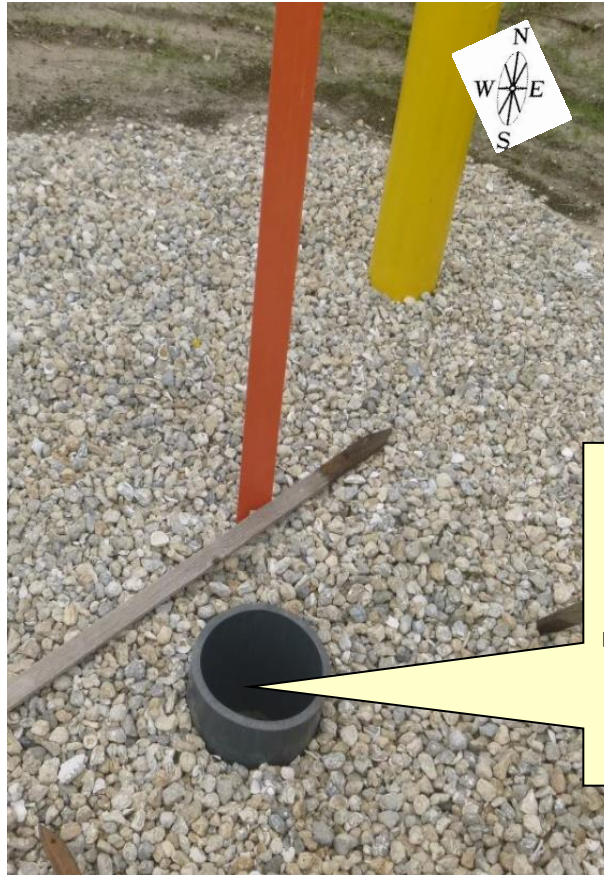

Benchmark "PZ204B 2018"  
Latitude: 26°42'10.9"  
Longitude: -81°30'07.2"  
El. 19.45 feet NAVD88



Benchmark "PZ204B 2018"  
Latitude: 26°42'10.9"  
Longitude: -81°30'07.2"  
El. 19.45 feet NAVD88



# SOUTH FLORIDA WATER MANAGEMENT DISTRICT

Rev. 1/16

## "PZ204A 2018" Benchmark Datasheet (1 of 1)



### SOUTH FLORIDA WATER MANAGEMENT DISTRICT

Rev. 8/07

DESIGNATION: PZ 204A		PROJECT: C-43 VERTICAL CONTROL SURVEY FOR PIEZOMETER WELLS	
ESTABLISHED BY: J. HAYWOOD		SURVEYOR: SCOTT URQUHART	
RECOVERED BY		DATE: FEBRUARY 21, 2018	
<b>GEOGRAPHIC POSITION</b>			
SECTION: 27	TOWNSHIP: 43 SOUTH	RANGE: 28 EAST	
COUNTY: HENDRY	NAME OF QUADRANGLE: ALVA		
	GEOGRAPHIC INDEX OF QUAD:		
HORIZONTAL DATUM: 1927 (1983) Other _____ (circle one) ZONE (E) or W			
VERTICAL DATUM: MSL 1929 (1988) Other N/A (circle one)			
CONTROL ACCURACY: HORIZONTAL 1 2 (3) _____ (circle one) VERTICAL 1 2 (3) N/A			
STATE PLANE COORDINATES	X = 492275.6	Y = 861525.9	NAVD 88 ELEV. 20.37' NGVD 29 ELEV. 21.64'
LATITUDE = N26° 42' 10.71"		LONGITUDE = W81° 30' 07.22"	
<b>RECOVERY DESCRIPTION</b>			
Stamping: SET ALUMINIUM DISK SO. FLA. WATER MANAGEMENT DIST. "PZ 204A LB 7975 2018"			
To Reach: To reach the station from the intersection of S.R. 80 and West Cowboy Way, Go along S.R. 80 SW for 3.9 miles to Congen Rd. on the left. Go along Congen Rd. South 0.14 miles to gate (SFWMD Lock) continue South 0.4 miles to the intersection of an East-West dirt road. Thence go East, along the dirt road, for 0.4 miles. The mark is on the left.			
Notable Land marks: PZ 204 A, is an aluminum disk in a concrete pad, between two monitoring wells and is 116 ft. North of the top of bank of an East-West running canal. 29 ft. East of the Top of Bank of a North-South running canal. 44ft. South of the first citrus tree in the Westerly most row of citrus trees.			
FIELD BOOK:	510	PAGE:	9



# SOUTH FLORIDA WATER MANAGEMENT DISTRICT

Rev. 1/16

## "PZ204B 2018" Benchmark Datasheet (1 of 1)



## SOUTH FLORIDA WATER MANAGEMENT DISTRICT

Rev. 8/07

DESIGNATION: PZ 204B		PROJECT: C-43 VERTICAL CONTROL SURVEY FOR PIEZOMETER WELLS	
ESTABLISHED BY: J. HAYWOOD		SURVEYOR: SCOTT URQUHART	
RECOVERED BY		DATE: FEBRUARY 21, 2018	
<b>GEOGRAPHIC POSITION</b>			
SECTION: 27	TOWNSHIP: 43 SOUTH	RANGE: 28 EAST	
COUNTY: HENDRY	NAME OF QUADRANGLE: ALVA		
GEOGRAPHIC INDEX OF QUAD:			
HORIZONTAL DATUM: 1927 <u>1983</u> Other _____ (circle one) ZONE <u>E</u> or W			
VERTICAL DATUM: MSL 1929 <u>1988</u> Other N/A (circle one)			
CONTROL ACCURACY: HORIZONTAL 1 2 <u>3</u> _____ (circle one) VERTICAL 1 2 <u>3</u> N/A			
STATE PLANE COORDINATES	X = 492275.2	Y = 861539.9	NAVD 88 ELEV. 19.45' NGVD 29 ELEV. 20.73'
LATITUDE = N26° 42' 10.85"		LONGITUDE = W81° 30' 07.22"	
<b>RECOVERY DESCRIPTION</b>			
Stamping: POURED IN PLACE CONCRETE MONUMENT WITH ALUMINIUM DISK SO. FLA. WATER MANAGEMENT DIST. "PZ 204B LB 7575 2018"			
To Reach: To reach the station from the intersection of S.R. 80 and West Cowboy Way, Go along S.R. 80 SW for 3.9 miles to Congen Rd. on the left. Go along Congen Rd. South 0.14 miles to gate (SFWMD Lock) continue South 0.4 miles to the intersection of an East-West dirt road. Thence go East, along the dirt road, for 0.4 miles. The mark is on the left.			
Notable Land marks: PZ 204B, is a poured in place concrete monument with an aluminum disk, and is 30 ft. South of the first citrus tree in the Westerly most row of citrus trees. 11.3 ft. North of the NW corner of a concrete pad. 127 ft. North of the Top of Bank of an East-West running canal.			
FIELD BOOK:	510	PAGE:	9





# SOUTH FLORIDA WATER MANAGEMENT DISTRICT

Rev. 1/16

## C43204 Field Notes (1 of 1)

20

SCADA FB#13 6/17/19

SEC 4 TWP 44 RGE 28

ESTABLISH REF. ELEV. FOR PIEZO METER WELLS

PZ204 (C) C-43 RESERVOIR.

EDWARDS  
HUDSON

STA	+	HI	-	ELEV	REMARKS
BMPZ204A	4.36	24.73		20.37	
GW A			1.12	23.61	
GW B			1.13	23.60	
SE COR CONC PAD			4.43	20.30	
SW COR CONC PAD			4.43	20.30	
NW COR CONC PAD			4.41	20.32	
NE COR CONC PAD			4.41	20.32	
N GROUND			4.8	19.9	
W GROUND			4.7	20.0	
S GROUND			4.6	20.1	
E GROUND			4.8	19.9	
BMPZ204B			5.28	19.45	[19.45]
		RT			
BMPZ204B	5.37	24.82			
GW A			1.22	23.60	
GW B			1.23	23.59	
BMPZ204A			4.46	20.36	[20.37]