



SOUTH FLORIDA WATER MANAGEMENT DISTRICT

Rev. 1/16

SCADA RTU Station Name: C43209A C43209B	DB Hydro Station Name: C43209G1 C43209G2	DB Hydro Site Name: C43209	Agency: S.F.W.M.D	Date of Field Work: 5/08/2019
Party Chief: EBANKS	Field Book: SCADA FB# 13	Page(s): 31	Prepared by: E. Ebanks	

SITE SPECIFIC DATA

Site Benchmark(s): PZ209A PZ209B	Benchmark Elevation(s) (NAVD88) 28.59 feet 27.68 feet	Corpscon 6.0.1 Conversion Factor (NAVD88 to NGVD29) +1.27 feet
Reference Elevation(s) (NAVD88): C43209A = 31.83 feet C43209B = 31.91 feet	Calibration Port Elevation(s) (NAVD88): N/A	
Ground Elevation (NAVD88): 26.2feet	Pad Elevation (NAVD88): = 28.55 feet	

GEOGRAPHIC DATA

Section 7	Township 44 South	Range 29 East
Well(s) Gate(s) Benchmark(s)	Latitude: C43209A 26°40'04.0" C43208B 26°40'03.9" State Plane Coordinates	Longitude: C43208A - 81°28'08.1" C43208B - 81°28'08.0" Northing (Y) = N/A
		Source: Scaled pick point aerial esri product Easting (X) = N/A

Notes: **NAVD88** – North American Vertical Datum of 1988; **NGVD29**- National Geodetic Vertical Datum of 1929; **Corpscon 6.0.1** - A U.S. Army Corps of Engineers Engineering Research and Development Center Topographic Engineering Center Alexandria, Virginia Windows-based program to convert coordinates and elevations between datum's using vertcon05.txt and vertcon05.05 files supplied by the U.S. Army Corps of Engineers South Atlantic Division, Jacksonville FL.

PICTURES





SOUTH FLORIDA WATER MANAGEMENT DISTRICT

Rev. 1/16

C43209 Piezometer Well Site

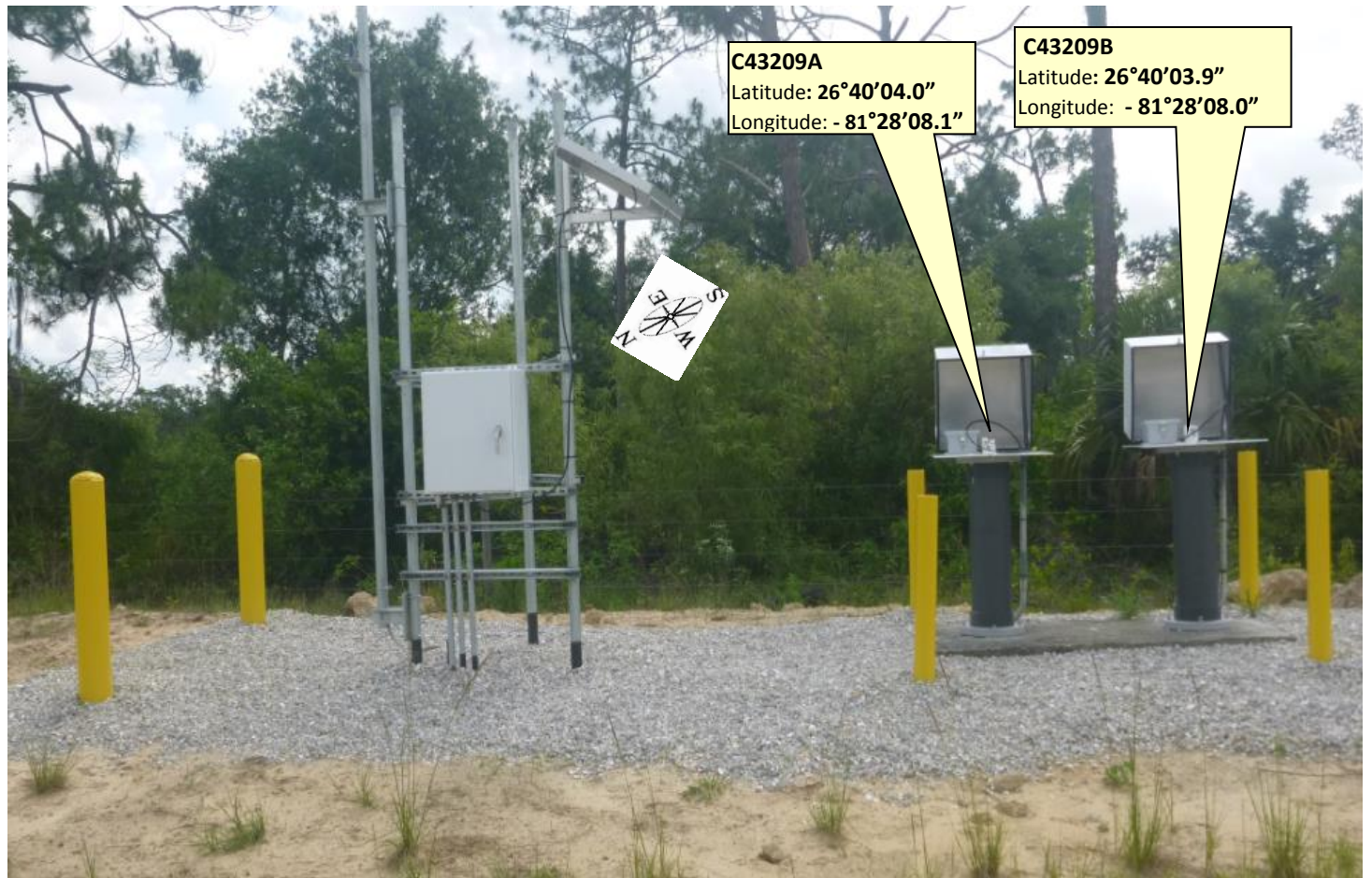



SOUTH FLORIDA WATER MANAGEMENT DISTRICT

Rev. 1/16

C43209 Piezometer Wells

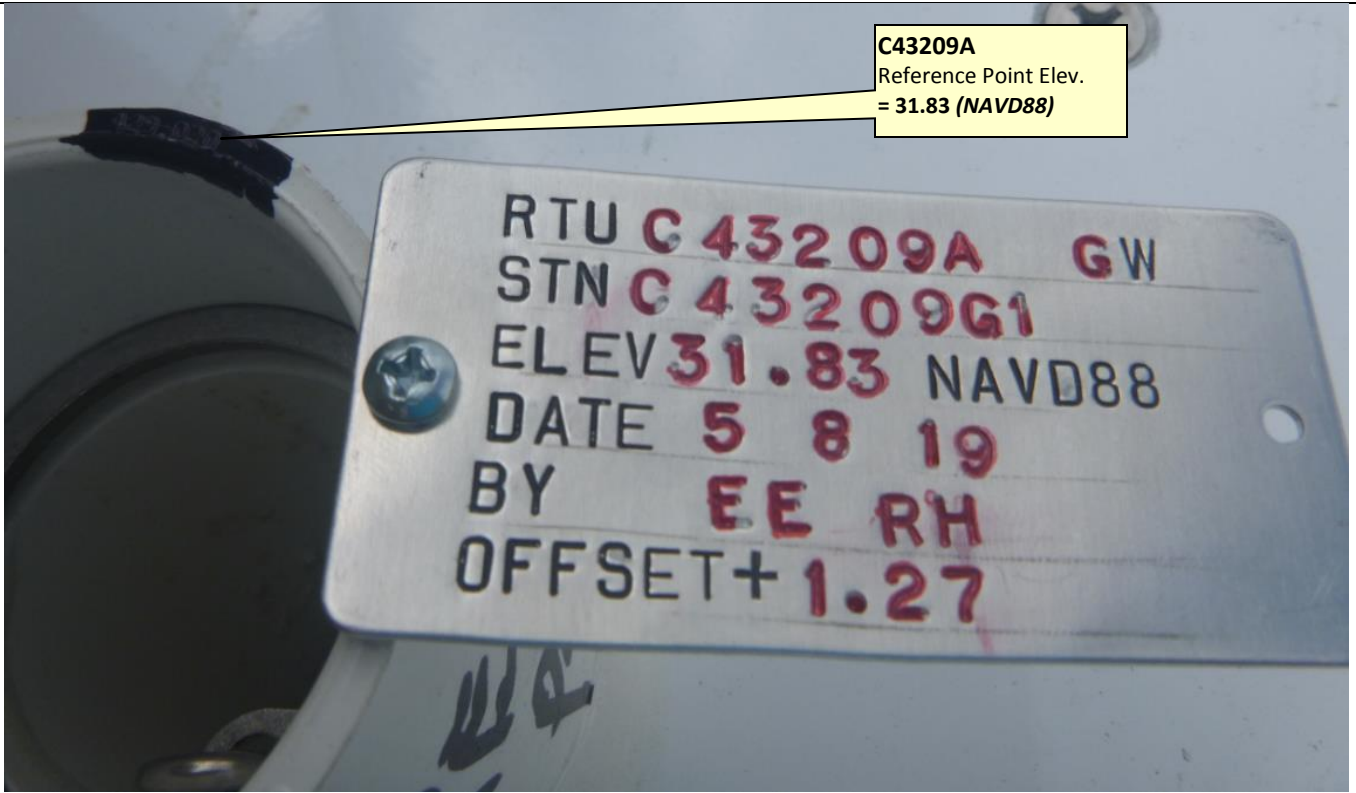

C43209A
Reference Point Elev.
= 31.83 (NAVD88)

RTU C 43209A GW
STN C 43209G1
ELEV 31.83 NAVD88
DATE 5 8 19
BY EE RH
OFFSET + 1.27

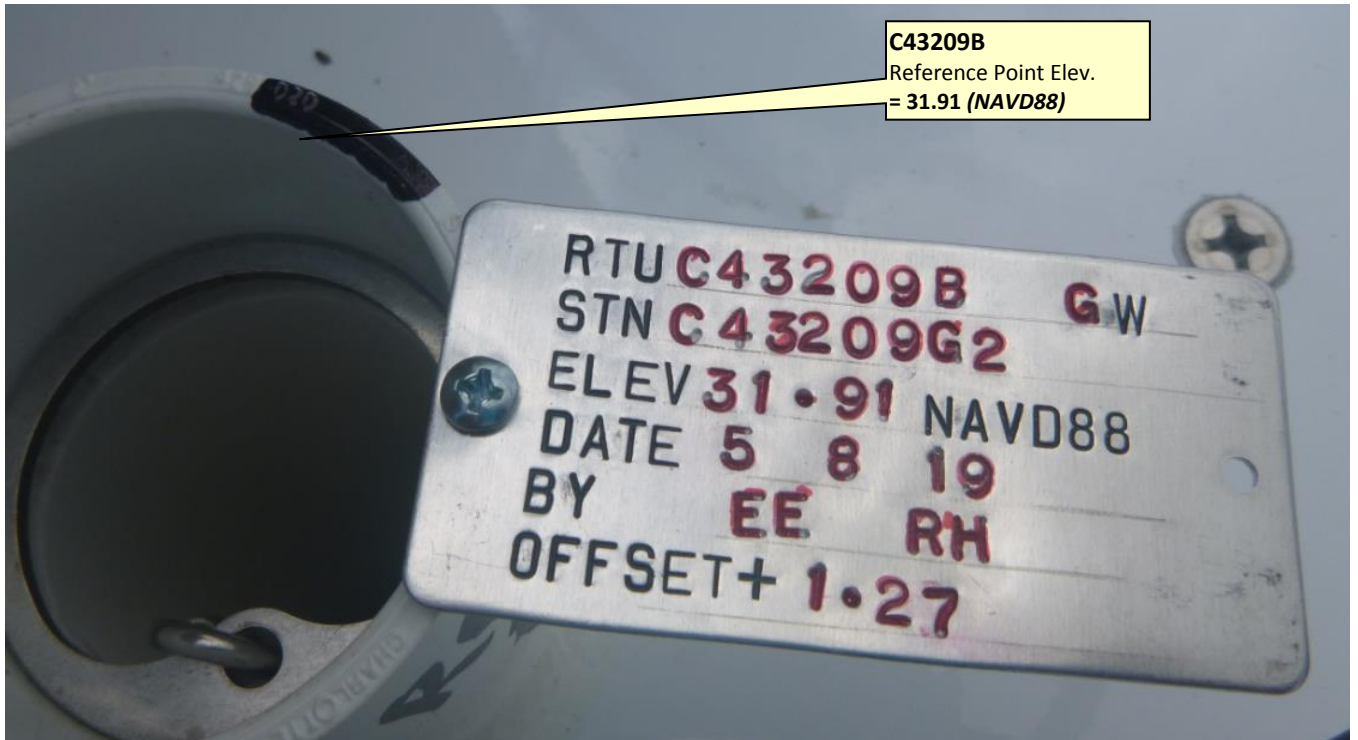

C43209B
Reference Point Elev.
= 31.91 (NAVD88)

RTU C 43209B GW
STN C 43209G2
ELEV 31.91 NAVD88
DATE 5 8 19
BY EE RH
OFFSET + 1.27



SOUTH FLORIDA WATER MANAGEMENT DISTRICT

Rev. 1/16

"PZ209A" Benchmark Location
Benchmark: El. **28.59 feet (NAVD88)**

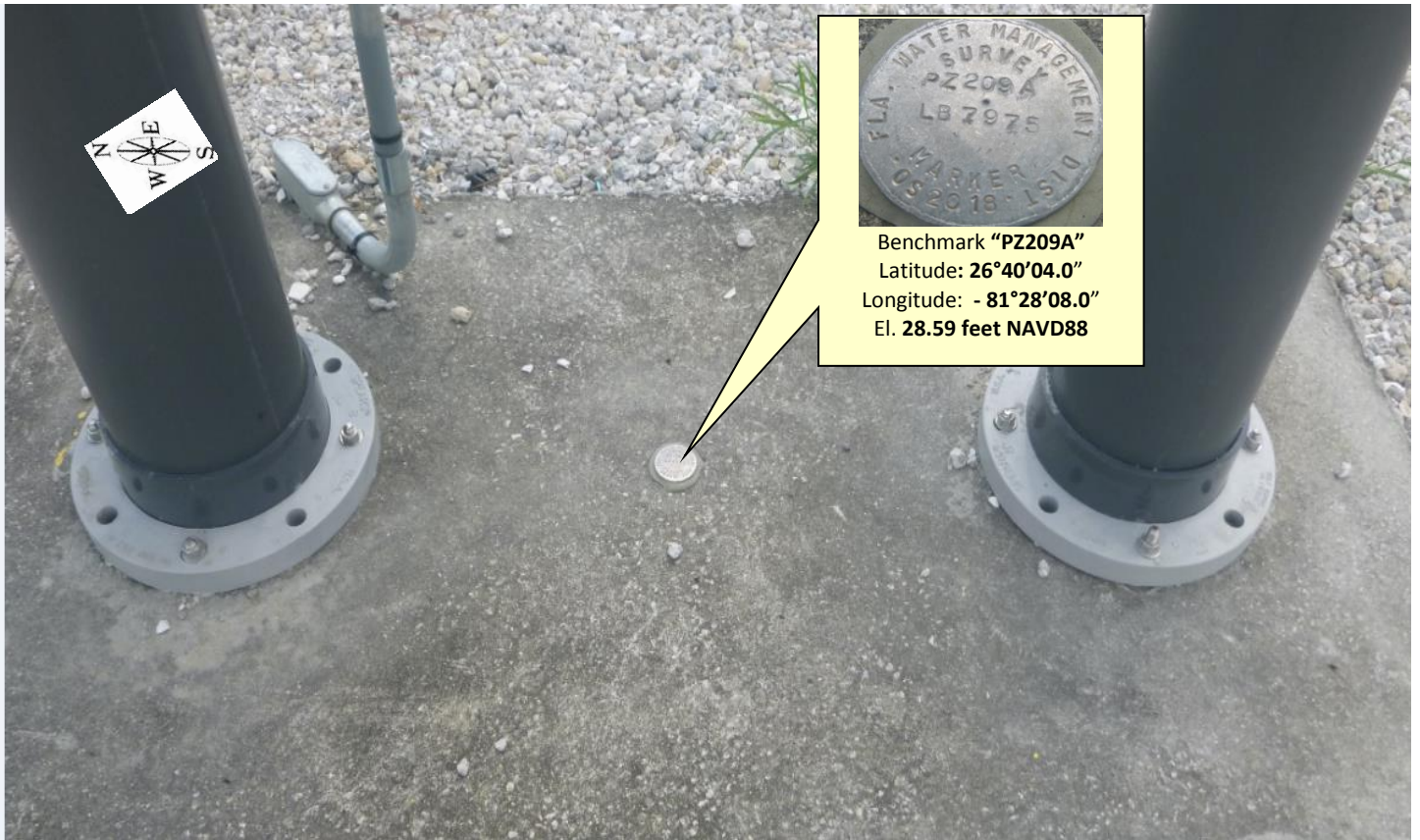



SOUTH FLORIDA WATER MANAGEMENT DISTRICT

Rev. 1/16

"PZ209B" Benchmark Location Benchmark: El. 27.68 feet (NAVD88)

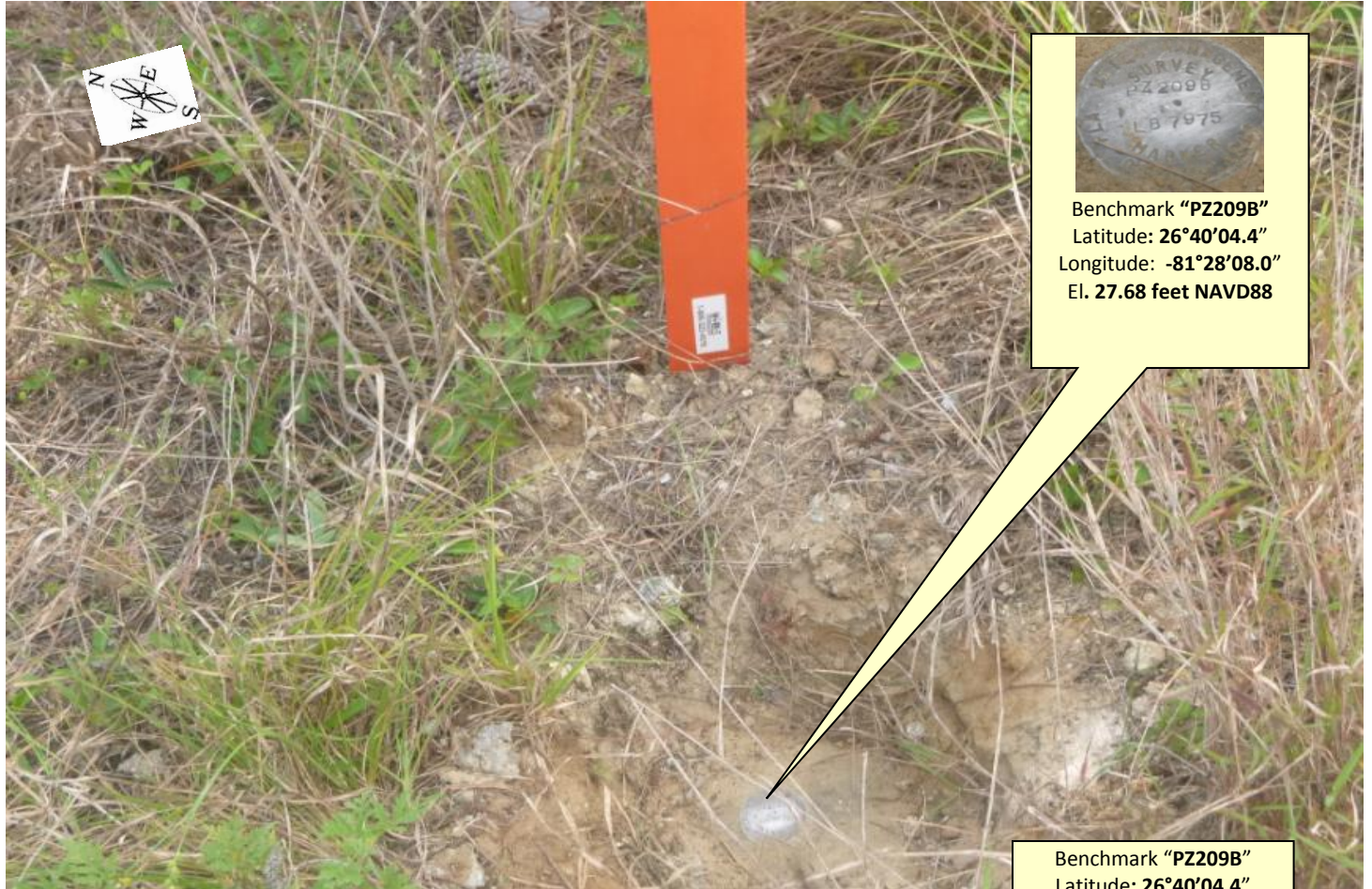

Benchmark "PZ209B"
Latitude: 26°40'04.4"
Longitude: -81°28'08.0"
El. 27.68 feet NAVD88



Benchmark "PZ209B"
Latitude: 26°40'04.4"
Longitude: -81°28'08.0"
El. 27.68 feet NAVD88



SOUTH FLORIDA WATER MANAGEMENT DISTRICT

Rev. 1/16

"PZ209A" Benchmark Datasheet (1 of 1)



SOUTH FLORIDA WATER MANAGEMENT DISTRICT

Rev. 8/07

DESIGNATION: PZ 209A		PROJECT: C-43 VERTICAL CONTROL SURVEY FOR PIEZOMETER WELLS	
ESTABLISHED BY: J. HAYWOOD		SURVEYOR: SCOTT URQUHART	
RECOVERED BY		DATE: FEBRUARY 21, 2018	
GEOGRAPHIC POSITION			
SECTION: 7	TOWNSHIP: 44 SOUTH	RANGE: 29 EAST	
COUNTY: HENDRY	NAME OF QUADRANGLE: ALVA		
GEOGRAPHIC INDEX OF QUAD:			
HORIZONTAL DATUM: 1927 (1983) Other _____ (circle one) ZONE (E) or W			
VERTICAL DATUM: MSL 1929 (1988) Other N/A (circle one)			
CONTROL ACCURACY: HORIZONTAL 1 2 (3) _____ (circle one) VERTICAL 1 2 (3) N/A			
STATE PLANE COORDINATES	X = 503033.8	Y = 848678.4	NAVD 88 ELEV. 28.59' NGVD 29 ELEV. 29.85'
LATITUDE = N26° 40' 03.88"		LONGITUDE = W81° 28' 08.07"	
RECOVERY DESCRIPTION			
Stamping: SET ALUMINIUM DISK SO. FLA. WATER MANAGEMENT DIST. "PZ 209A LB 7975 2018"			
To Reach: To reach the station from the intersection of S.R. 80 and West Cowboy Way, Go along S.R. 80 southwest for 3.9 miles to Congen Rd. on the left. Go along Congen Rd. South 0.14 miles to gate (SFWMD Lock) continue South 0.4 miles to the intersection of an East-West dirt road. Thence go East 1.2 miles to junction of a dirt road running South. Go South along the dirt road for 2.3 miles to a crossing on the left (East). Thence East, using crossing, for 175 ft. to the junction of a dirt trail running North-South. Thence go South for 0.4 miles. The mark is on the left.			
Notable Land marks: PZ 209A is an aluminum disk in a concrete pad that is between two monitoring wells and is 4 ft. northeast of the southwest bollard around wells. 4.3 ft. southeast of the northwest bollard around wells. 14.6 ft. West of a four strand barbed wire fence.			
FIELD BOOK: 510		PAGE: 15	



SOUTH FLORIDA WATER MANAGEMENT DISTRICT

Rev. 1/16

"PZ209B" Benchmark Datasheet (1 of 1)



SOUTH FLORIDA WATER MANAGEMENT DISTRICT

Rev. 807

DESIGNATION: PZ 209B		PROJECT: C-43 VERTICAL CONTROL SURVEY FOR PIEZOMETER WELLS	
ESTABLISHED BY: J. HAYWOOD		SURVEYOR: SCOTT URQUHART	
RECOVERED BY		DATE: FEBRUARY 21, 2018	
GEOGRAPHIC POSITION			
SECTION: 7	TOWNSHIP: 44 SOUTH	RANGE: 29 EAST	
COUNTY: HENDRY	NAME OF QUADRANGLE: ALVA		
	GEOGRAPHIC INDEX OF QUAD:		
HORIZONTAL DATUM: 1927 (1983) Other _____ (circle one) ZONE (E) or W			
VERTICAL DATUM: MSL 1929 (1988) Other N/A (circle one)			
CONTROL ACCURACY: HORIZONTAL 1 2 (3) _____ (circle one) VERTICAL 1 2 (3) N/A			
STATE PLANE COORDINATES	X = 503040.1	Y = 848735.5	NAVD 88 ELEV. 27.68' NGVD 29 ELEV. 28.95'
LATITUDE = N26° 40' 04.44"		LONGITUDE = W81° 28' 08.00"	
RECOVERY DESCRIPTION			
Stamping: POURED IN PLACE CONCRETE MONUMENT WITH ALUMINIUM DISK SO. FLA. WATER MANAGEMENT DIST. "PZ 209B LB 7975 2018"			
To Reach: To reach the station from the intersection of S.R. 80 and West Cowboy Way, Go along S.R. 80 southwest for 3.9 miles to Congen Rd. on the left. Go along Congen Rd. South 0.14 miles to gate (SFWM D Lock) continue South 0.4 miles to the intersection of an East-West dirt road. Thence go East 1.2 miles to junction of a dirt road running South. Go South along the dirt road for 2.3 miles to a crossing on the left (East). Thence East, using crossing, for 175 ft. to the junction of a dirt trail running North-South. Thence go South for 0.4 miles. The mark is on the left.			
Notable Land marks: PZ 209B, is a poured in place concrete monument with an aluminum disk that is 7.7 ft. West of a four strand barbed wire fence. 38 ft. southwest of a 12" oak tree. 54.3 ft. North of the northeast corner of a concrete pad.			
FIELD BOOK: 510		PAGE: 15	



SOUTH FLORIDA WATER MANAGEMENT DISTRICT

Rev. 1/16

"PZ209" Field Notes

STA	+	+1.	-	Elev	Remarks
31					GLADA FB#13 5-8-19
SEC. 7 Twp 44 Rge 29 Ebanks Hudson					
Establish REF. elev. for wells @ C-43					
Well PZ 209					
3M PZ209A	3.58	32.17		28.59	
GW1-A			0.34	31.83	
GW2-B			0.26	31.91	
PAD NE			3.62	28.55	} 28.55
PAD NW			3.70	28.47	
PAD SW			3.55	28.62	
PAD SE			3.61	28.56	
Berm S			3.9 ✓	28.27	28.2 Berm
Ground E			* 5.9	26.27	
Ground N Berm			4.0 ✓	28.17	* 26.17 NG.
Ground W			* 6.1	26.07	
Ground S Berm			3.9	28.27	
Bm PZ209B			4.42	27.69	[27.62]
2+					
Bm PZ 209B	4.64	32.32		27.68	
GW2-B			0.42	31.90	
GW1-A			0.495	31.825	
3M PZ209A			3.735	28.585	[28.59]