



# SOUTH FLORIDA WATER MANAGEMENT DISTRICT

Rev. 1/16

SCADA RTU Station Name: <b>C43211A</b> <b>C43211B</b>	DB Hydro Station Name: <b>C43211G1</b> <b>C43211G2</b>	DB Hydro Site Name: <b>C43211</b>	Agency: <b>S.F.W.M.D</b>	Date of Field Work: <b>4/24/2019</b>
Party Chief: <b>EBANKS</b>	Field Book: <b>SCADA FB# 13</b>	Page(s): <b>28</b>	Prepared by: <b>E. Ebanks</b>	

### SITE SPECIFIC DATA

Site Benchmark(s): <b>PZ211A</b> <b>PZ211B</b>	Benchmark Elevation(s) (NAVD88) <b>24.83feet</b> <b>24.62feet</b>	Corpscon 6.0.1 Conversion Factor (NAVD88 to NGVD29) <b>+1.25 feet</b>
Reference Elevation(s) (NAVD88): <b>C43211A = 28.12 feet</b> <b>C43211B = 28.12 feet</b>	Calibration Port Elevation(s) (NAVD88): <b>N/A</b>	
Ground Elevation (NAVD88): <b>25.0 feet</b>	Pad Elevation (NAVD88): <b>24.79 feet</b>	

### GEOGRAPHIC DATA

Section <b>10</b>	Township <b>44 South</b>	Range <b>28 East</b>
Well(s) Gate(s)  Benchmark(s)	Latitude: <b>C43211A 26°39'32.4"</b> <b>C43211B 26 °39'32.4"</b>  State Plane Coordinates	Longitude: <b>C43213A - 81°30'05.9"</b> <b>C43213B - 81°30'05.9"</b>  Northing (Y) = <b>N/A</b>
		Source: <b>Scaled pick point aerial esri product</b>  Easting (X) = <b>N/A</b>

**Notes:** **NAVD88** – North American Vertical Datum of 1988; **NGVD29**- National Geodetic Vertical Datum of 1929; **Corpscon 6.0.1** - A U.S. Army Corps of Engineers Engineering Research and Development Center Topographic Engineering Center Alexandria, Virginia Windows-based program to convert coordinates and elevations between datum's using vertcon05.txt and vertcon05.05 files supplied by the U.S. Army Corps of Engineers South Atlantic Division, Jacksonville FL.

### PICTURES

## Aerial of Overall Site

Not to scale (esri product)

**Benchmark "PZ211A"**  
Latitude: **26°39'32.4"**  
Longitude: **- 81°30'05.9"**  
El. **24.83 feet NAVD88**

**Benchmark "PZ211B"**  
Latitude: **26°39'32.5"**  
Longitude: **- 81°30'06.2"**  
El. **24.62 feet NAVD88**

**C43211A**  
Latitude: **26°39'32.4"**  
Longitude: **- 81°30'05.9"**

**C43211B**  
Latitude: **26°39'32.4"**  
Longitude: **- 81°30'05.9"**

203 ft
© 2018 Google
Google Earth



# SOUTH FLORIDA WATER MANAGEMENT DISTRICT

Rev. 1/16

C43211 Piezometer Well Site

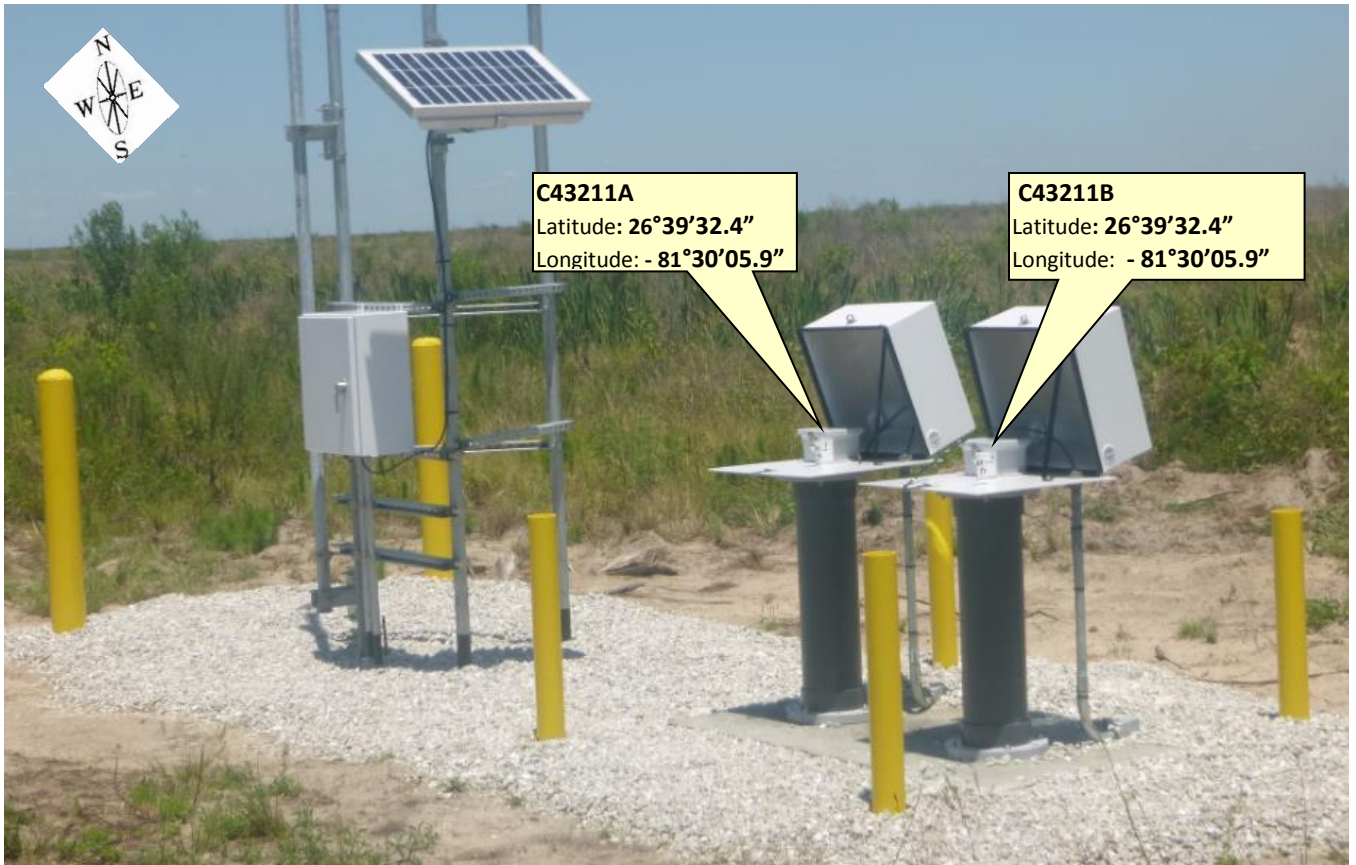





# SOUTH FLORIDA WATER MANAGEMENT DISTRICT

Rev. 1/16

## C43211 Piezometer Wells

C43211A  
Reference Point Elev.  
= 28.12 (NAVD88)



C43211B  
Reference Point Elev.  
= 28.12 (NAVD88)

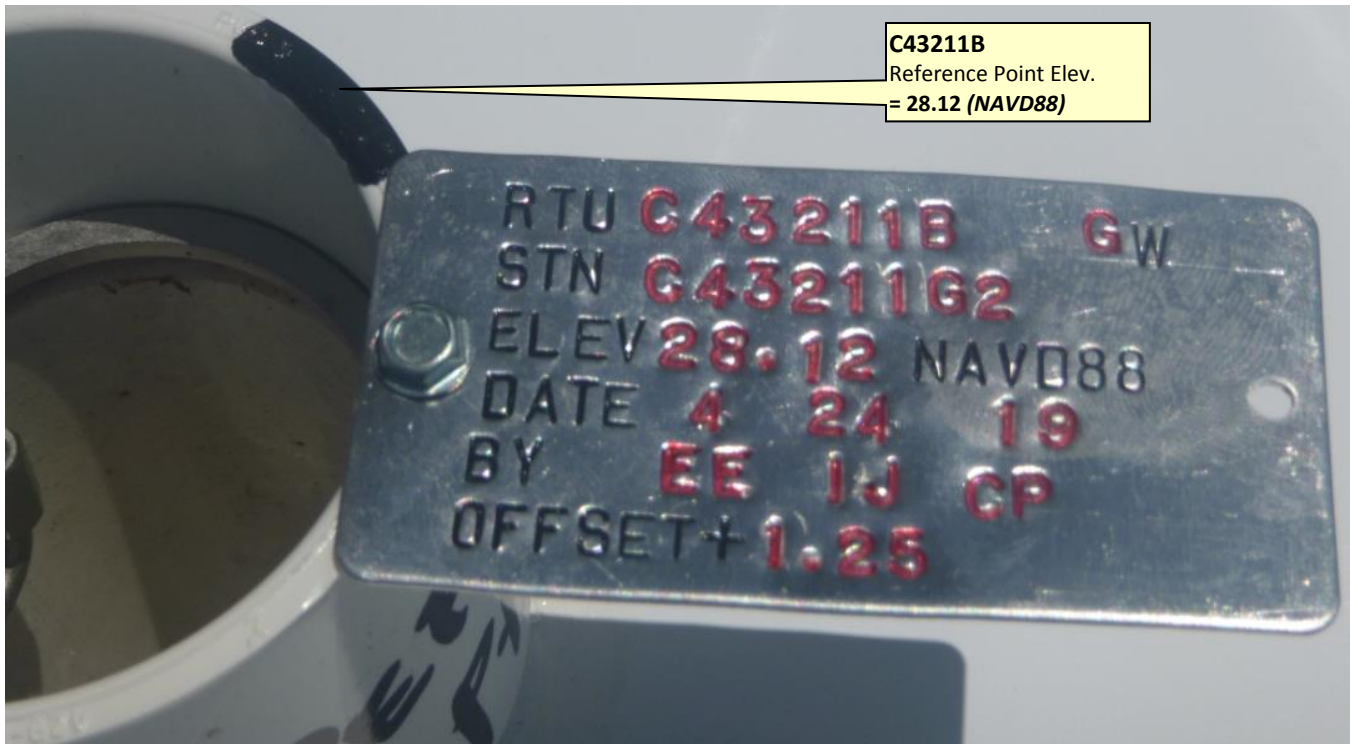



# SOUTH FLORIDA WATER MANAGEMENT DISTRICT

Rev. 1/16

**"PZ211A" Benchmark Location**  
Benchmark: El. **24.83 feet (NAVD88)**

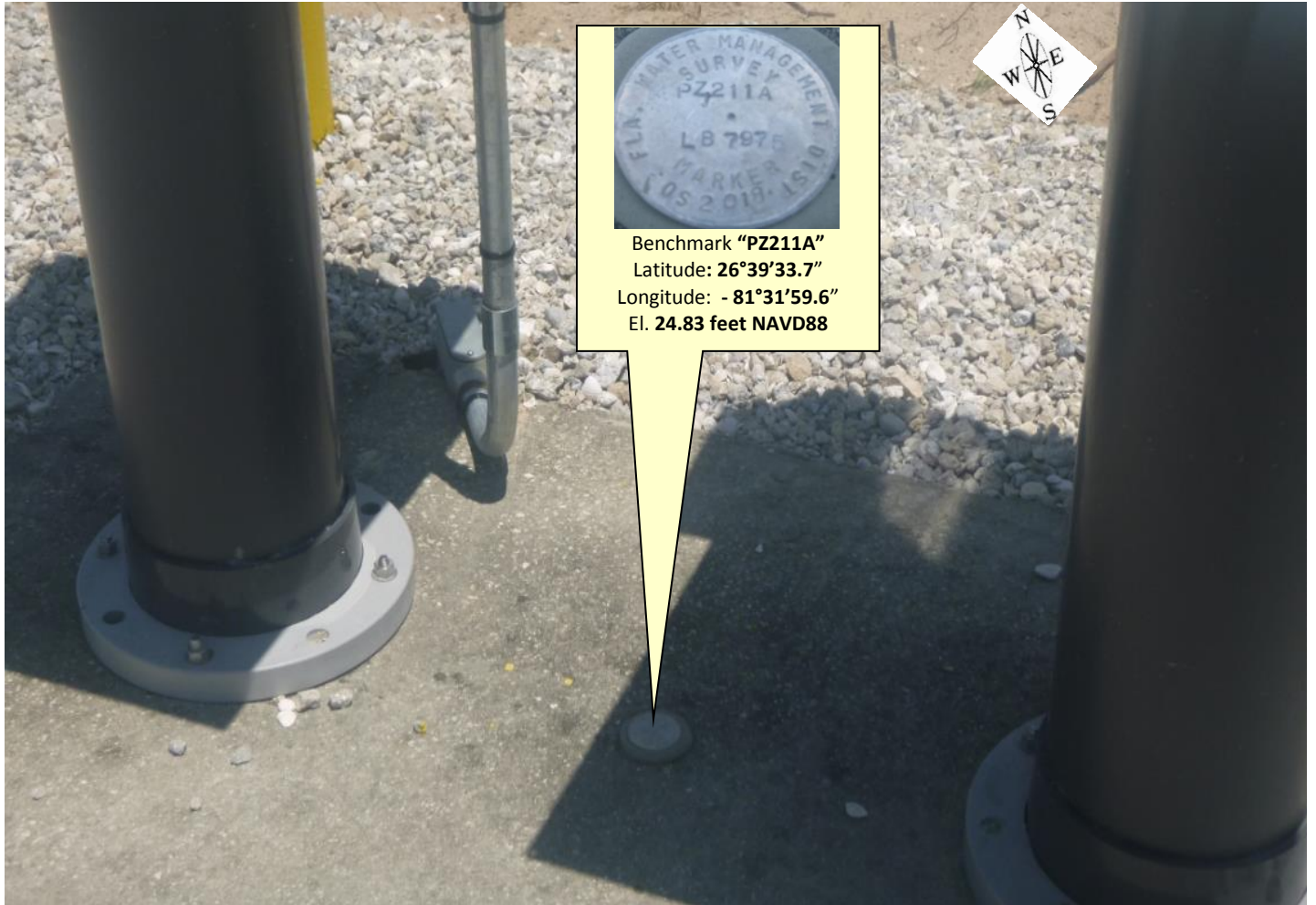





# SOUTH FLORIDA WATER MANAGEMENT DISTRICT

Rev. 1/16

**"PZ213B" Benchmark Location**  
Benchmark: El. **23.80 feet (NAVD88)**

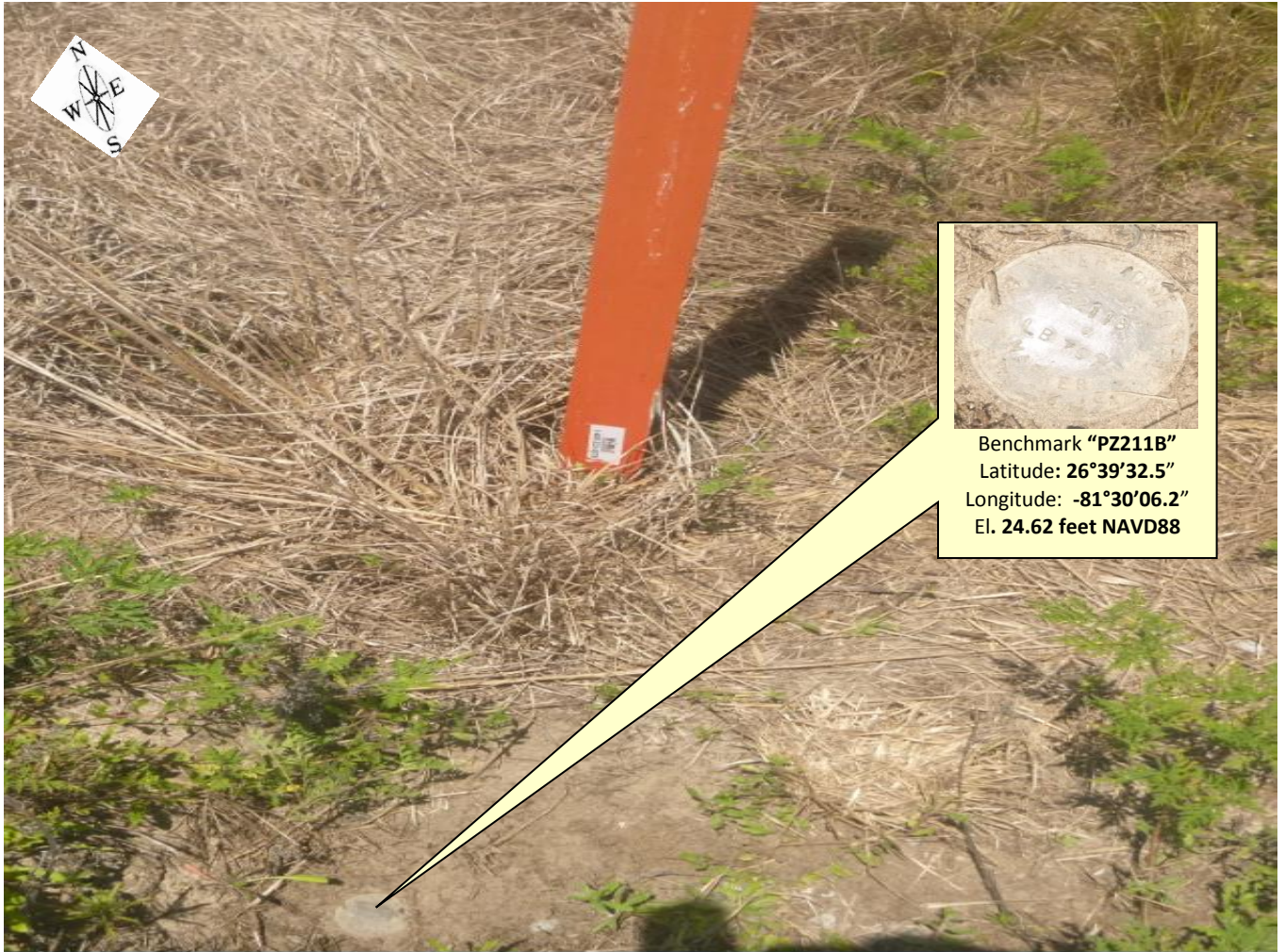

Benchmark **"PZ211B"**  
Latitude: **26°39'32.5"**  
Longitude: **-81°30'06.2"**  
El. **24.62 feet NAVD88**



Benchmark **"PZ211B"**  
Latitude: **26°39'32.5"**  
Longitude: **-81°30'06.2"**  
El. **24.62 feet NAVD88**



# SOUTH FLORIDA WATER MANAGEMENT DISTRICT

Rev. 1/16

## "PZ211A" Benchmark Datasheet (1 of 1)



### SOUTH FLORIDA WATER MANAGEMENT DISTRICT

Rev. 8/07

DESIGNATION: PZ 211A		PROJECT: C-43 VERTICAL CONTROL SURVEY FOR PIEZOMETER WELLS	
ESTABLISHED BY: J. HAYWOOD		SURVEYOR: SCOTT URQUHART	
RECOVERED BY		DATE: JANUARY 25, 2018	
<b>GEOGRAPHIC POSITION</b>			
SECTION: 10	TOWNSHIP: 44 SOUTH	RANGE: 28 EAST	
COUNTY: HENDRY	NAME OF QUADRANGLE: ALVA		
	GEOGRAPHIC INDEX OF QUAD:		
HORIZONTAL DATUM: 1927 (1983) Other _____ (circle one)		ZONE (E) or W	
VERTICAL DATUM: MSL 1929 (1988) Other N/A (circle one)			
CONTROL ACCURACY: HORIZONTAL 1 2 (3) _____ (circle one) VERTICAL 1 2 (3) N/A			
STATE PLANE COORDINATES	X = 492334.1	Y = 845539.6	NAVD 88 ELEV. 24.83' NGVD 29 ELEV. 26.10'
LATITUDE = N26° 39' 32.39"		LONGITUDE = W81° 30' 05.88"	
<b>RECOVERY DESCRIPTION</b>			
Stamping: SET ALUMINIUM DISK SO. FLA. WATER MANAGEMENT DIST. "PZ 211A LB 7975 2018"			
To Reach: To reach the station from the intersection of S.R. 80 and West Cowboy Way, Go along S.R. 80 SW for 3.9 miles to Congen Rd. on the left. Go along Congen Rd. South 0.14 miles to gate (SFWMD Lock) continue South 0.4 miles to the intersection of an East-West dirt road. Thence East for 0.26 miles to the junction of a dirt road to the South. Thence south 1 mile to a bridge. Thence continue South along the East side of a canal for 2.2 miles to an Eastward turn in the dirt road. Thence continue East for 0.1 miles. The mark is on the left.			
Notable Land marks: : PZ 211A, is an aluminum disk in a concrete pad between two monitoring wells and is 4.5 ft. southwest of the northeast bollard around wells. 4.5 ft. northwest of the southeast bollard around the wells. 55 ft. North of the top of bank of an East-West canal.			
FIELD BOOK: 510		PAGE: 16	



# SOUTH FLORIDA WATER MANAGEMENT DISTRICT

Rev. 1/16

"PZ211B" Benchmark Datasheet (1 of 1)



## SOUTH FLORIDA WATER MANAGEMENT DISTRICT

Rev. 8/07

DESIGNATION: PZ 211B		PROJECT: C-43 VERTICAL CONTROL SURVEY FOR PIEZOMETER WELLS	
ESTABLISHED BY: J. HAYWOOD		SURVEYOR: SCOTT URQUHART	
RECOVERED BY		DATE: JANUARY 25, 2018	
<b>GEOGRAPHIC POSITION</b>			
SECTION: 10	TOWNSHIP: 44 SOUTH	RANGE: 28 EAST	
COUNTY: HENDRY	NAME OF QUADRANGLE: ALVA		
	GEOGRAPHIC INDEX OF QUAD:		
HORIZONTAL DATUM: 1927 (1983) Other _____ (circle one) ZONE (E) or W			
VERTICAL DATUM: MSL 1929 (1988) Other N/A (circle one)			
CONTROL ACCURACY: HORIZONTAL 1 2 (3) _____ (circle one) VERTICAL 1 2 (3) N/A			
STATE PLANE COORDINATES	X = 492301.2	Y = 845548.9	NAVD 88 ELEV. 24.62' NGVD 29 ELEV. 25.88'
LATITUDE = N26° 39' 32.48"		LONGITUDE = W81° 30' 06.24"	
<b>RECOVERY DESCRIPTION</b>			
Stamping: POURED IN PLACE CONCRETE MONUMENT WITH ALUMINIUM DISK SO. FLA. WATER MANAGEMENT DIST. "PZ 211B LB 7975 2018"			
To Reach: To reach the station from the intersection of S.R. 80 and West Cowboy Way, Go along S.R. 80 SW for 3.9 miles to Congen Rd. on the left. Go along Congen Rd. South 0.14 miles to gate (SFWMD Lock) continue South 0.4 miles to the intersection of an East-West dirt road. Thence East for 0.26 miles to the junction of a dirt road to the South. Thence south 1 mile to a bridge. Thence continue South along the East side of a canal for 2.2 miles to an Eastward turn in the dirt road. Thence continue East for 0.1 miles. The mark is on the left.			
Notable Land marks: PZ 211B, is a poured in place concrete monument with an aluminum that is 32 ft. West of the northwest corner of a concrete pad. 32.8 ft. northwest of the southwest bollard around wells. 66 ft. North of the top of bank of an East-West canal.			
FIELD BOOK: 510		PAGE: 16	





# SOUTH FLORIDA WATER MANAGEMENT DISTRICT

Rev. 1/16

## Field Notes (1 of 1)

28 SCADA FB# 13 4-24-19  
 sec. 10 TWP 44 Rge 28 Ebanks Jones Porter  
 Establish Ref. Elev. for Wells @ C-43 Reservoir  
 Wells C-43 211

HTA	+	HTA	-	Elev	Remarks
Bm PZ 211A	4.95	29.78		24.83	
GW1-A			1.66	28.12	✓
GW2-B			1.64	28.12	✓
PIV Elev. NE			5.02	24.76	
" NW			4.99	24.79	
" SW			4.95	24.83	
" SE			4.99	24.79	
Ground E			4.5	25.3	
Ground N			5.1	24.7	
Ground W			4.9	24.9	
Ground S			4.7	25.1	
Bm PZ 211B			5.65	24.65	[24.62]
					Ref.
Bm PZ 211B	5.32	29.94		24.62	
GW2-B			1.81	28.13	
GW1-A			1.81	28.13	
Bm PZ 211A			5.11	24.83	[24.83]
					CHECK
Bm PZ 211B	5.21	29.83		24.62	
Bm PZ 211A			5.00	24.83	