

hwp. 13 hwp 24 Rge 31.

Chantel's  
Rechart.

Verify Ref. elev for GW 1 & GW 2 AT  
T.M. Ranch

STA	+	h.i.	-	Elev	Remarks
BM TMRH5	4.50	73.18		68.68	IND.
GW 1			1.013	72.167	(72.17)
GW 2			1.30	71.88	(71.89)
BM TMRH5	4.50			68.68	✓

Sec 34 hwp 25 Rge 30

Verify Ref. elev for NEW Telemetry  
wells. AT S-59. (note: wells TAGGED in  
NAVD 88 by FRS.)

STA	+	h.i.	-	Elev	Remarks
BM OS81	5.37 8.28	70.47		65.10	NAVD 29 (0.97) offset.
H/W well			5.06	65.41	
T/W well			4.32	66.15	
BM OS81	5.37 8.28			65.10	(65.10)
FOR WEIR T/W.					
BM OS81	3.20 10.45	68.30		65.10	
WEIR T/W			3.18 10.47	65.12	
S-59 T/W			2.16	66.14	✓
WEIR T/W CR10 well			5.69	62.61	(62.52)
BM OS81	3.20			65.10	(65.10)

Note: S-59 HAS 3 gauges needing bucket & Adj.

TM RANCH  
ELEV. 71.89  
DATE 5 18 05  
BY EE & COON INC.

04.22.2009

ELEV. TM RANCH  
DATE 72.17  
BY 1 6 06  
EE

W

04.22.2009



SOUTH FLORIDA WATER MANAGEMENT DISTRICT

Rev. 4/01

<b>COUNTY</b> Orange		<b>PROJECT</b> TM Ranch		<b>DESIGNATION</b> TMRH 5	
<b>SECTION</b> <u>13</u>		<b>TOWNSHIP</b> <u>24S</u>		<b>RANGE</b> <u>31E</u>	
<b>GEOGRAPHIC INDEX OF QUAD</b>					
Established by <u>X</u> Recovered by Cooner & Associates, Inc. (Field work by EF Gaines)			NAME OF QUADRANGLE Narcoossee NW		
SURVEYOR <u>A. Johnson</u> DATE <u>02 / 25 / 2005</u>			FIELD BOOK <u>137</u> PAGE <u>1-8</u>		
HORIZONTAL DATUM: 1927 <b>1983</b> Other _____ (circle one) ZONE <b>E</b> or W					
VERTICAL DATUM: MSL 1929 <b>1988</b> Other _____ (circle one)					
CONTROL ACCURACY: HORIZONTAL 1 2 3 <u>Sub-meter</u> (circle one) VERTICAL 1 <b>2</b> 3					
STATE PLANE COORDINATES		X 604253.73'	Y 1476233.98'	EL. 67.63'	
LATITUDE 28° 23' 40.86" N		LONGITUDE 081° 09' 41.28" W			
<b>DESCRIPTION</b> SFWMD ALUM. DISK IN CONCRETE STAMPED "TMRH5"					
To Reach:					
From Orlando, take 528 East to Narcoossee Road. Go south on Narcoossee; Left on Moss Park Road; Left on East Lake Mary Jane Road; Left into entrance to TM Ranch. Follow to Bunk House Road and mark near well site.					
Notable Land marks:					
Mark is near well site.					

SKETCH

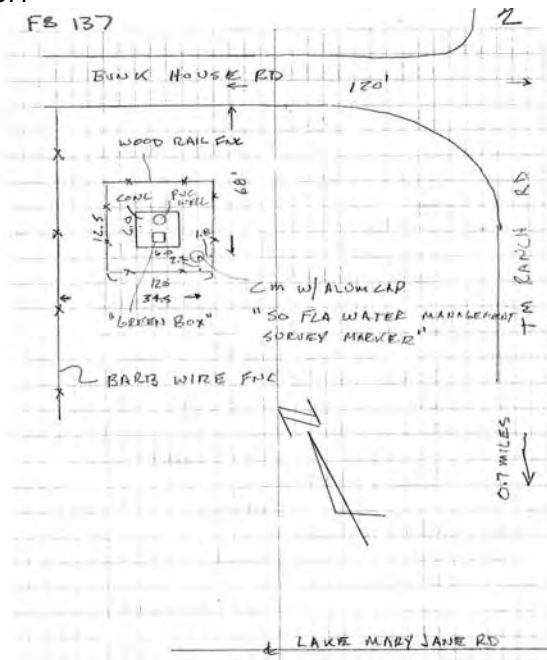

- COOPER & ASSOCIATES, INC.
- Date of photo: March 30, 2005
- View: Looking North at BM TMRH5