



SOUTH FLORIDA WATER MANAGEMENT DISTRICT

Rev. 1/16

| | | | | | |
|--|--|--|---|---|--|
| DB Hydro Station Name: SLF-21 | | DB Hydro Site Name: SLF21 | | Last Date of Field Work: 04-may-17 | |
| Party Chief: Strickland | | Field Book: Misc 7B | | Pages 45, 46, 50 and 52 | |
| Site Benchmark: SLF21 | | Benchmark Elevation (NAVD88) 18.289 | | Corpscon 6.0.1 Conversion Factor (NAVD88 to NGVD29) +1.486 | |
| Reference Elevation(s) (NAVD88): 21.09 | | Existing Tag Elevation (Datum): Not Given | | Calibration Port Elevation(s) (NAVD88): 21.09 | |
| Ground Elevation (NAVD88): NE corner El. 17.9 SE corner El. 18.1 SW corner El. 18.1 NW corner EL. 17.9 | | | Pad Elevation (NAVD88): NE corner El. 18.26 SE corner El. 18.28 SW corner El. 18.28 NW corner EL. 18.27 | | |
| Latitude: 27°25'41.867" | | | Longitude: 80°24'07.488" (OPUS session on benchmark) | | |

Notes:
OPUS – Online Positioning User Service from the National Geodetic Survey
NAVD88 – North American Vertical Datum of 1988
NGVD29- National Geodetic Vertical Datum of 1929
Corpscon 6.0.1 - A U.S. Army Corps of Engineers Engineering Research and Development Center Topographic Engineering Center Alexandria, Virginia Windows-based program to convert coordinates and elevations between datum's using vertcon05.txt and vertcon05.05 files supplied by the U.S. Army Corps of Engineers South Atlantic Division, Jacksonville Fl.

PICTURES

Overall Site

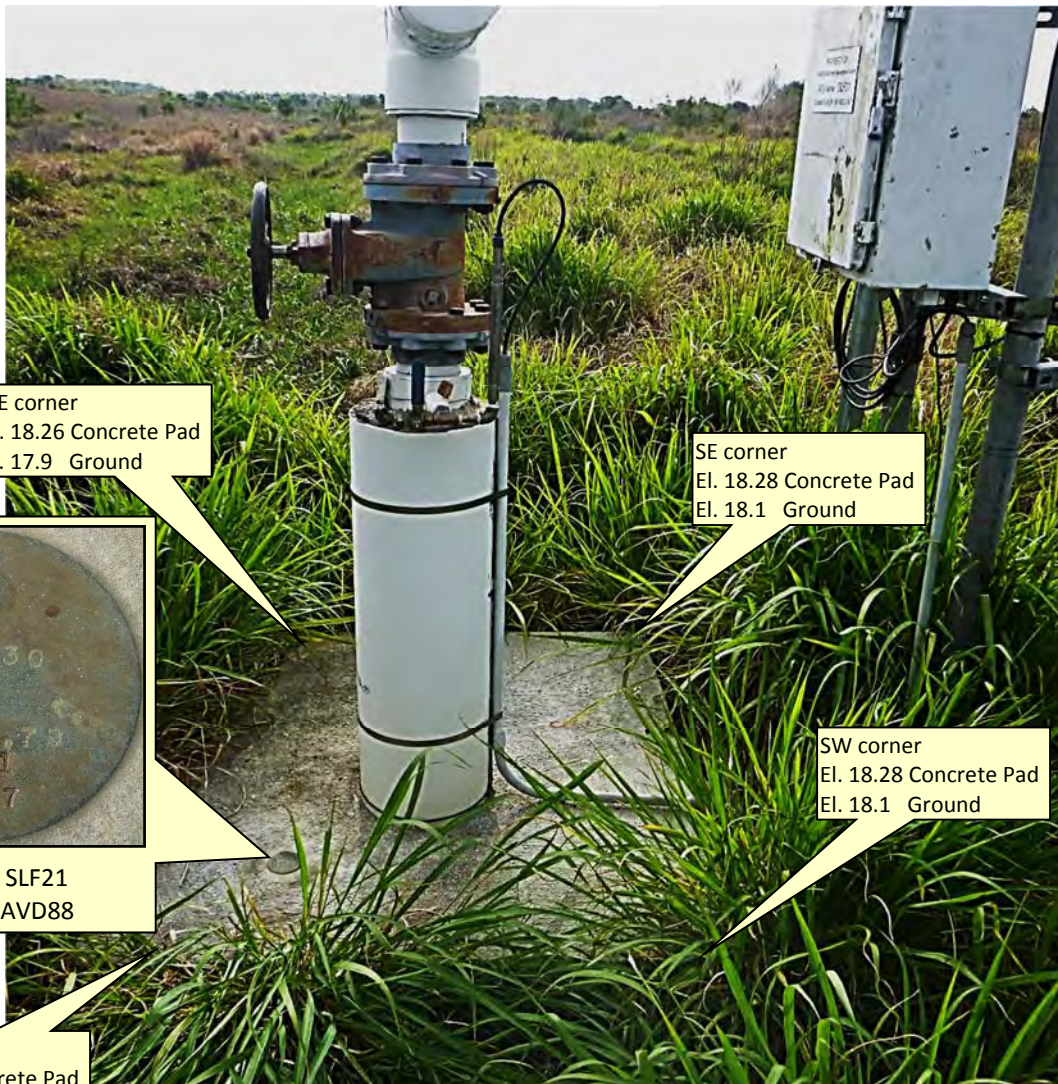

NE corner
El. 18.26 Concrete Pad
El. 17.9 Ground

SE corner
El. 18.28 Concrete Pad
El. 18.1 Ground

SW corner
El. 18.28 Concrete Pad
El. 18.1 Ground



Benchmark SLF21
El. 18.289 NAVD88

NW corner
El. 18.27 Concrete Pad
El. 17.9 Ground

Looking East (Not to scale) (24-apr-17)



SOUTH FLORIDA WATER MANAGEMENT DISTRICT

Rev. 1/16

Reference Points

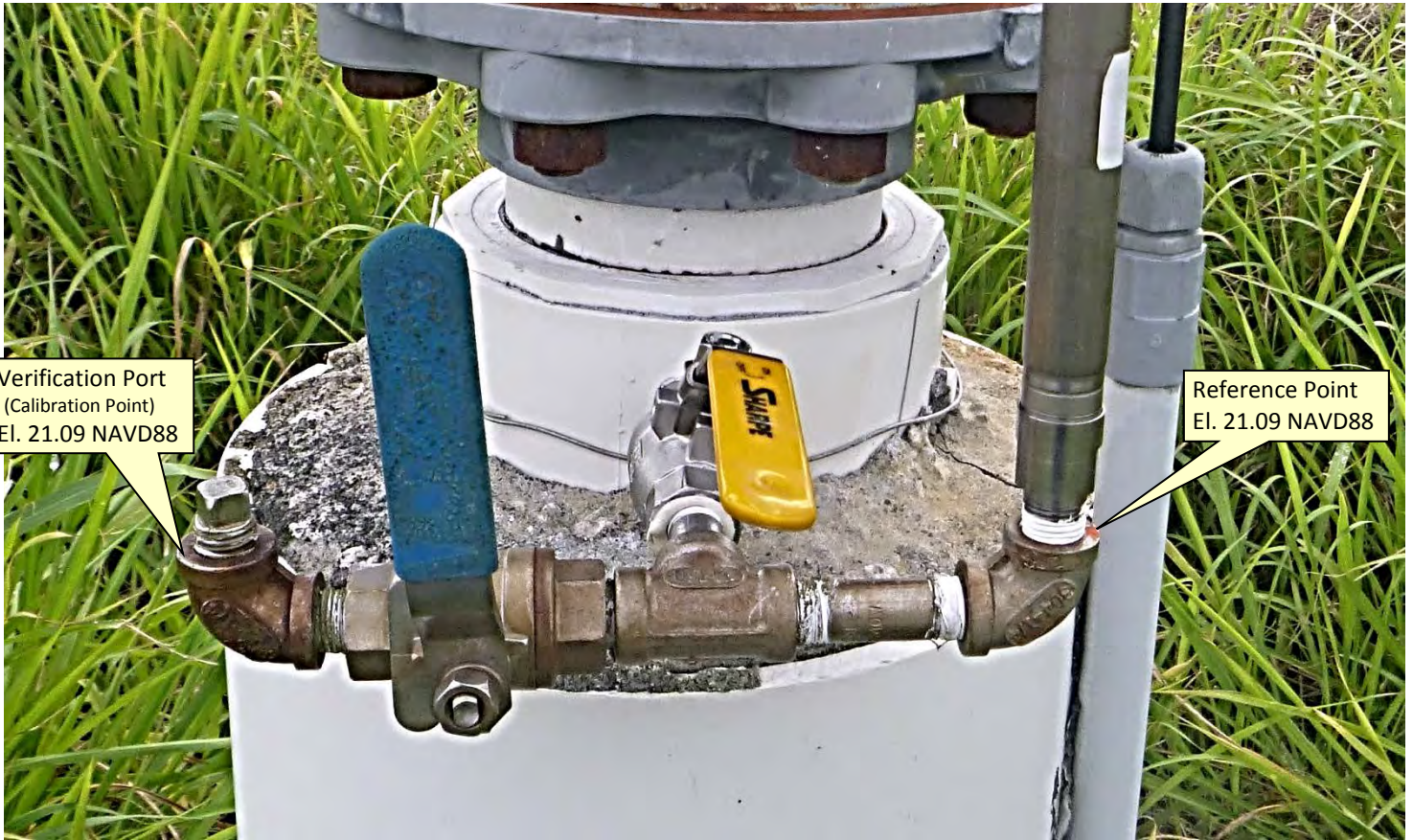

Looking East (Not to scale) (24-apr-17)

SFWMD Reference Point Brass Tag Close Up





SOUTH FLORIDA WATER MANAGEMENT DISTRICT

Rev. 1/16

Florida Department of Environmental Protection (FLDEP) Tag





SOUTH FLORIDA WATER MANAGEMENT DISTRICT

Rev. 1/16

| | |
|--|---------------------------------|
| DESIGNATION: SLF 21 | PROJECT: SLF21 Well Site |
| ESTABLISHED BY: UNKNOWN | SURVEYOR: Strickland |
| RECOVERED BY: SOUTH FLORIDA WATER MANAGEMENT DISTRICT | DATE: 24-apr-17 |

GEOGRAPHIC POSITION

| | | |
|--|---|---|
| SECTION 14 | TOWNSHIP 35 SOUTH | RANGE 39 EAST |
| COUNTY: ST LUCIE | NAME OF QUADRANGLE: FT. PIERCE NW GEOGRAPHIC INDEX OF QUAD: 2804 | |
| HORIZONTAL DATUM: 1927 <u>(1983)</u> Other ___ (circle one) ZONE (E) or W | | |
| VERTICAL DATUM: MSL 1929 <u>(1988)</u> Other ___ (circle one) | | |
| VERTICAL ACCURACY: 1 2 3 | | |
| STATE PLANE COORDINATE | X= 850120.114 | Y= 1125330.915 |
| | | NAVD 88 EL. 18.289 NGVD 29 EL. 19.775 |
| CORPSCON 6.0.1 CONVERSION FACTOR (NAVD88 TO NGVD29): +1.486 | | |
| LATITUDE: 27°25'41.867" | | LONGITUDE: 80°27'07.4883" |

RECOVERY DESCRIPTION

Stamping: **NAVD88 ELEV 18.30 NGVD ELEV 19.79 SLF 2017**

To Reach: from the intersection of State Road 70 (Okeechobee Road) and Kings Highway (State Road 713) in Ft. Pierce Florida, proceed north on Kings Highway 0.9 of a mile to Pruitt Research Center Road on the left; turn left (west) and proceed 0.12 of a mile to unnamed paved road on the right; turn right and proceed north 0.2 of a mile along the west side of a pond into the old grove area of property and grove row on the north side of well SLF 21; turn left (west) and proceed plus or minus 160 feet west to well site SLF 21 and station location on the left.

Station is located on the 4' x 4' concrete well pad, 0.8 foot east of the west edge of concrete well pad and 1 foot south of the north edge of well pad.

The station is a found 2.5-inch diameter brass disk stamped "**NAVD 88 ELEV 18.30 NGVD ELEV 19.79**" and now by sfwmd "**SLF 21 2017.**"

NOTABLE LAND MARKS: **WELL SITE SLF 21**

NGS SOURCE BENCHMARK: **ST LUCIE COUNTY Benchmarks's "BOX CUT ROCK RD" and "IFAS 2003"**

FIELD BOOK **MISC 7B PAGES 45 &46**

PICTURES

Overall Site (Looking Southerly) (27-apr-17)





SOUTH FLORIDA WATER MANAGEMENT DISTRICT

Rev. 1/16

Field Notes

MISC 7B page 46

46

MISC FB# 7B 4-24-17

| SEC | 14 | TMP | 35 | ZISE | 39 |
|----------------------------------|------|-------|------|-------|------------------|
| ESTABLISH NAVS 88. ELEV @ SLF 21 | | | | | |
| STA | + | HT | - | ELEV | B.M. ELEV |
| B.M. | 5.49 | 23.78 | | | 18.29 NAVS 88 |
| G.W. | | | 2.67 | 21.09 | |
| V-PORT | | | 2.67 | 21.09 | |
| GRASS | | | 5.9 | 17.88 | |
| CONC PAD | | | 5.52 | 18.26 | |
| CONC " | | | 5.50 | 18.28 | |
| GRASS | | | 5.7 | 18.08 | |
| GRASS | | | 5.7 | 18.08 | |
| CONC PAD | | | 5.50 | 18.28 | |
| CONC " | | | 5.51 | 18.27 | |
| GRASS | | | 5.9 | 17.88 | |
| B.M. | | | 5.49 | 18.29 | 18.29 |

46

MISC FB# 7B 4-24-17

KCI STEIGMANN
& HUSSON

COMMENTS

SLF 2017 SEE PG. 45

G.W. REF "X" ATOP of 1/4" 90° ELBOW S. SIDE

VERIFICATION PORT " " " " " " N. SIDE

GRASS NE CORNER

CONC " " "

" " SE "

GRASS SE

GRASS SW

CONC SW

CONC NW

GRASS NW

SLF 2017 AS ABOVE

"OLD ORANGE GROVE NO TREES"

N = 1125330.915
E = 850120.114

4'

4'

N

Strickland, James

From: opus <opus@ngs.noaa.gov>
Sent: Monday, April 24, 2017 6:46 AM
To: Strickland, James
Subject: OPUS solution : SLF21_2017.tps OP1493030699435

FILE: SLF21_2017.tps OP1493030699435

NGS OPUS SOLUTION REPORT

=====

All computed coordinate accuracies are listed as peak-to-peak values.
For additional information: <https://www.ngs.noaa.gov/OPUS/about.jsp#accuracy>

USER: jstrickl@sfwmd.gov DATE: April 24, 2017
RINEX FILE: slf2110p.17o TIME: 10:45:45 UTC

SOFTWARE: page5 1209.04 master56.pl 160321 START: 2017/04/20 15:18:00
EPHEMERIS: igr19454.eph [rapid] STOP: 2017/04/20 19:17:00
NAV FILE: brdc1100.17n OBS USED: 9972 / 10496 : 95%
ANT NAME: TPSHIPER_V NONE # FIXED AMB: 60 / 66 : 91%
ARP HEIGHT: 1.5 OVERALL RMS: 0.023(m)

REF FRAME: NAD_83(2011)(EPOCH:2010.0000) IGS08 (EPOCH:2017.3006)

X: 944569.428(m) 0.006(m) 944568.629(m) 0.006(m)
Y: -5585863.071(m) 0.009(m) -5585861.492(m) 0.009(m)
Z: 2920410.161(m) 0.017(m) 2920409.997(m) 0.017(m)

LAT: 27 25 41.86700 0.011(m) 27 25 41.88756 0.011(m)
E LON: 279 35 52.51166 0.004(m) 279 35 52.49256 0.004(m)
W LON: 80 24 7.48834 0.004(m) 80 24 7.50744 0.004(m)
EL HGT: -21.828(m) 0.017(m) -23.404(m) 0.017(m)
ORTHO HGT: 5.549(m) 0.031(m) [NAVD88 (Computed using GEOID12B)]

UTM COORDINATES STATE PLANE COORDINATES

UTM (Zone 17) SPC (0901 FL E)

| | | | |
|-----------------------|-------------|------------|----------------|
| Northing (Y) [meters] | 3034016.500 | 343001.549 | N =1125330.915 |
| Easting (X) [meters] | 559096.959 | 259117.129 | E =850120.114 |
| Convergence [degrees] | 0.27543275 | 0.27543275 | |
| Point Scale | 0.99964311 | 0.99998430 | |
| Combined Factor | 0.99964654 | 0.99998773 | |

US NATIONAL GRID DESIGNATOR: 17RNL5909634016(NAD 83)

BASE STATIONS USED

| PID | DESIGNATION | LATITUDE | LONGITUDE | DISTANCE(m) |
|--------|--------------------------|-------------|--------------|-------------|
| DE9138 | OKCB OKEECHOBEE CORS ARP | N271557.715 | W0805119.181 | 48317.9 |

DG9798 PBCH WEST PALM CORS ARP N265046.638 W0801309.299 66987.8
DF7046 BRTW BARTOW CORS ARP N275658.642 W0814658.200 147942.0

NEAREST NGS PUBLISHED CONTROL POINT

AF7268 I95 85 B01 RM 2 N272545.309 W0802317.146 1386.7

This position and the above vector components were computed without any knowledge by the National Geodetic Survey regarding the equipment or field operating procedures used.



Name: **BOX-CUT ROCK RD**

Description: BOX-CUT IN THE NORTHEAST CORNER OF A CATCH BASIN @ THE NORTHEAST CORNER OF THE INTERSECTION OF ROCK AND PRUITT REASEARCH CENTER ROADS, 19 FEET PLUS OR MINUS SOUTHWEST OF THE CORNER POST OF A 4 FOOT BARB-WIRE/HOG FENCE, 44 FEET PLUS OR MINUS EAST OF THE CENTERLINE OF ROCK ROAD, 32 FEET PLUS OR MINUS NORTH OF THE CENTERLINE OF PRUITT RESEARCH CENTER ROAD, 71 FEET PLUS OR MINUS SOUTHEAST OF A WOOD UTILITY POLE.

AdjustedElevation: 6.6648

VerticalDatum: NAVD 88

MarkDate: Null

Name: **IFAS**

Description: SAINT LUCIE COUNTY 2003 VERTICAL CONTROL DISK IN CONCRETE 2 AND 1/2 TENTHS OF A MILE PLUS OR MINUS WEST OF KINGS HIGHWAY, 45 FEET PLUS OR MINUS EAST OF THE EAST EDGE OF A CONCRETE DRIVE TO HOUSE # 7715, 23 FEET PLUS OR MINUS SOUTH OF THE SOUTH EDGE OF PAVEMENT OF RESEARCH CENTER ROAD..

AdjustedElevation: 6.1482

VerticalDatum: NAVD 88

MarkDate: Null

From the "ngvd29.txt" file provided by NGS for the CERP Geodetic Vertical Control Project.
 Line/Part: L26215 SSN+: mark floated, SSN*: mark constrained, SSN#: mark floated & constrained
 Mark ID SSN PID Designation Geopotential Elevation Codes
 1004 0258 AF7699 DUCK 5.4215 5.5322
 1006 0260 AJ5654 B 528 6.4622 6.5941

The NGS Data Sheet

See file [dsdata.pdf](#) for more information about the datasheet.

```
PROGRAM = datasheet95, VERSION = 8.12.1
1      National Geodetic Survey,  Retrieval Date = MAY  3, 2017
AJ5654 *****
AJ5654 DESIGNATION - B 528
AJ5654 PID - AJ5654
AJ5654 STATE/COUNTY- FL/ST LUCIE
AJ5654 COUNTRY - US
AJ5654 USGS QUAD - FORT PIERCE NW (1983)
AJ5654
AJ5654 *CURRENT SURVEY CONTROL
AJ5654
AJ5654* NAD 83(2011) POSITION- 27 24 33.23683(N) 080 25 11.26165(W) ADJUSTED
AJ5654* NAD 83(2011) ELLIP HT- -21.190 (meters) (06/27/12) ADJUSTED
AJ5654* NAD 83(2011) EPOCH - 2010.00
AJ5654* NAVD 88 ORTHO HEIGHT - 6.138 (meters) 20.14 (feet) ADJUSTED
AJ5654
AJ5654 GEOID HEIGHT - -27.333 (meters) GEOID12B
AJ5654 NAD 83(2011) X - 943,004.327 (meters) COMP
AJ5654 NAD 83(2011) Y - -5,587,114.612 (meters) COMP
AJ5654 NAD 83(2011) Z - 2,918,535.290 (meters) COMP
AJ5654 LAPLACE CORR - -1.58 (seconds) DEFLEC12B
AJ5654 DYNAMIC HEIGHT - 6.128 (meters) 20.10 (feet) COMP
AJ5654 MODELED GRAVITY - 979,140.2 (mgal) NAVD 88
AJ5654
AJ5654 VERT ORDER - FIRST CLASS II
AJ5654
AJ5654 Network accuracy estimates per FGDC Geospatial Positioning Accuracy
AJ5654 Standards:
AJ5654 FGDC (95% conf, cm) Standard deviation (cm) CorrNE
AJ5654 Horiz Ellip SD_N SD_E SD_h (unitless)
AJ5654 -----
AJ5654 NETWORK 2.39 3.02 0.99 0.96 1.54 0.18250574
AJ5654 -----
AJ5654 Click here for local accuracies and other accuracy information.
AJ5654
AJ5654
AJ5654.The horizontal coordinates were established by GPS observations
AJ5654.and adjusted by the National Geodetic Survey in June 2012.
AJ5654
AJ5654.NAD 83(2011) refers to NAD 83 coordinates where the reference frame has
AJ5654.been affixed to the stable North American tectonic plate. See
AJ5654.NA2011 for more information.
AJ5654
AJ5654.The horizontal coordinates are valid at the epoch date displayed above
AJ5654.which is a decimal equivalence of Year/Month/Day.
AJ5654
AJ5654.The orthometric height was determined by differential leveling and
AJ5654.adjusted by the NATIONAL GEODETIC SURVEY
AJ5654.in November 2001.
AJ5654
AJ5654.Significant digits in the geoid height do not necessarily reflect accuracy.
```

AJ5654.GEOID12B height accuracy estimate available [here](#).

AJ5654

AJ5654.[Photographs](#) are available for this station.

AJ5654

AJ5654.The X, Y, and Z were computed from the position and the ellipsoidal ht.

AJ5654

AJ5654.The Laplace correction was computed from DEFLEC12B derived deflections.

AJ5654

AJ5654.The ellipsoidal height was determined by GPS observations

AJ5654.and is referenced to NAD 83.

AJ5654

AJ5654.The dynamic height is computed by dividing the NAVD 88

AJ5654.geopotential number by the normal gravity value computed on the

AJ5654.Geodetic Reference System of 1980 (GRS 80) ellipsoid at 45

AJ5654.degrees latitude (g = 980.6199 gals.).

AJ5654

AJ5654.The modeled gravity was interpolated from observed gravity values.

AJ5654

AJ5654. The following values were computed from the NAD 83(2011) position.

AJ5654

| AJ5654; | | North | East | Units | Scale Factor | Converg. |
|-----------------|---|---------------|-------------|-------|--------------|------------|
| AJ5654;SPC FL E | - | 340,880.838 | 257,375.459 | MT | 0.99998180 | +0 16 01.6 |
| AJ5654;SPC FL E | - | 1,118,373.22 | 844,405.99 | sFT | 0.99998180 | +0 16 01.6 |
| AJ5654;UTM 17 | - | 3,031,896.512 | 557,355.882 | MT | 0.99964061 | +0 16 01.6 |

AJ5654

AJ5654!
- Elev Factor x Scale Factor = Combined Factor

AJ5654!SPC FL E - 1.00000333 x 0.99998180 = 0.99998513

AJ5654!UTM 17 - 1.00000333 x 0.99964061 = 0.99964394

AJ5654

AJ5654_U.S. NATIONAL GRID SPATIAL ADDRESS: 17RNL5735531896(NAD 83)

AJ5654

AJ5654 SUPERSEDED SURVEY CONTROL

AJ5654

| | | | | | |
|--------|--------------------|-------------------|--------------------|-------------|-----|
| AJ5654 | NAD 83(2007)- | 27 24 33.23679(N) | 080 25 11.26244(W) | AD(2002.00) | 0 |
| AJ5654 | ELLIP H (02/10/07) | -21.173 (m) | | GP(2002.00) | |
| AJ5654 | NAD 83(1999)- | 27 24 33.23699(N) | 080 25 11.26286(W) | AD() | 1 |
| AJ5654 | ELLIP H (12/12/02) | -21.145 (m) | | GP() | 2 2 |
| AJ5654 | NAVD 88 | 6.14 (m) | 20.1 (f) | LEVELING | 3 |

AJ5654

AJ5654.Superseded values are not recommended for survey control.

AJ5654

AJ5654.NGS no longer adjusts projects to the NAD 27 or NGVD 29 datums.

AJ5654.See file [dsdata.pdf](#) to determine how the superseded data were derived.

AJ5654

AJ5654_MARKER: DD = SURVEY DISK

AJ5654_SETTING: 7 = SET IN TOP OF CONCRETE MONUMENT

AJ5654_STAMPING: B 528 2001 CERP

AJ5654_MARK LOGO: USACE

AJ5654_PROJECTION: RECESSED 5 CENTIMETERS

AJ5654_MAGNETIC: N = NO MAGNETIC MATERIAL

AJ5654_STABILITY: C = MAY HOLD, BUT OF TYPE COMMONLY SUBJECT TO

AJ5654+STABILITY: SURFACE MOTION

AJ5654_SATELLITE: THE SITE LOCATION WAS REPORTED AS SUITABLE FOR

AJ5654+SATELLITE: SATELLITE OBSERVATIONS - April 11, 2015

AJ5654

| AJ5654 | HISTORY | - Date | Condition | Report By |
|--------|---------|------------|------------|-----------|
| AJ5654 | HISTORY | - 20010521 | MONUMENTED | EMCINC |
| AJ5654 | HISTORY | - 20020415 | GOOD | MAPTEC |
| AJ5654 | HISTORY | - 20150411 | GOOD | GEOCAC |

AJ5654

From the "ngvd29.txt" file provided by NGS for the CERP Geodetic Vertical Control Project.
 Line/Part: L26215 SSN+: mark floated, SSN*: mark constrained, SSN#: mark floated & constrained

| Mark ID | SSN | PID | Designation | Geopotential | Elevation | Codes |
|---------|------|--------|-------------|--------------|-----------|-------|
| 1004 | 0258 | AF7699 | DUCK | 5.4215 | 5.5322 | |
| 1006 | 0260 | AJ5654 | B 528 | 6.4622 | 6.5941 | |

The NGS Data Sheet

See file [dsdata.pdf](#) for more information about the datasheet.

```

PROGRAM = datasheet95, VERSION = 8.12.1
1      National Geodetic Survey,  Retrieval Date = MAY  3, 2017
AF7699 *****
AF7699 DESIGNATION -   DUCK
AF7699 PID          -   AF7699
AF7699 STATE/COUNTY-  FL/ST LUCIE
AF7699 COUNTRY      -   US
AF7699 USGS QUAD    -   FORT PIERCE NW (1983)
AF7699
AF7699                      *CURRENT SURVEY CONTROL
AF7699
AF7699* NAD 83(2011) POSITION- 27 24 39.57094(N) 080 24 13.83196(W) ADJUSTED
AF7699* NAD 83(2011) ELLIP HT-  -22.284 (meters) (06/27/12) ADJUSTED
AF7699* NAD 83(2011) EPOCH   - 2010.00
AF7699* NAVD 88 ORTHO HEIGHT - 5.074 (meters) 16.65 (feet) ADJUSTED
AF7699
AF7699 GEOID HEIGHT   -  -27.358 (meters) GEOID12B
AF7699 NAD 83(2011) X   -  944,544.770 (meters) COMP
AF7699 NAD 83(2011) Y   - -5,586,762.382 (meters) COMP
AF7699 NAD 83(2011) Z   -  2,918,707.865 (meters) COMP
AF7699 LAPLACE CORR    -  -1.67 (seconds) DEFLEC12B
AF7699 DYNAMIC HEIGHT - 5.066 (meters) 16.62 (feet) COMP
AF7699 MODELED GRAVITY -  979,141.0 (mgal) NAVD 88
AF7699
AF7699 VERT ORDER      -   FIRST      CLASS II
AF7699
AF7699 Network accuracy estimates per FGDC Geospatial Positioning Accuracy
AF7699 Standards:
AF7699      FGDC (95% conf, cm)      Standard deviation (cm)      CorrNE
AF7699      Horiz Ellip              SD_N   SD_E   SD_h      (unitless)
AF7699 -----
AF7699 NETWORK      0.65   1.08              0.27   0.26   0.55      -0.00919398
AF7699 -----
AF7699 Click here for local accuracies and other accuracy information.
AF7699
AF7699
AF7699.The horizontal coordinates were established by GPS observations
AF7699.and adjusted by the National Geodetic Survey in June 2012.
AF7699
AF7699.NAD 83(2011) refers to NAD 83 coordinates where the reference frame has
AF7699.been affixed to the stable North American tectonic plate. See
AF7699.NA2011 for more information.
AF7699
AF7699.The horizontal coordinates are valid at the epoch date displayed above
AF7699.which is a decimal equivalence of Year/Month/Day.
AF7699
AF7699.The orthometric height was determined by differential leveling and
AF7699.adjusted by the NATIONAL GEODETIC SURVEY
AF7699.in November 2001.
AF7699
AF7699.Significant digits in the geoid height do not necessarily reflect accuracy.

```

AF7699.GEOID12B height accuracy estimate available [here](#).

AF7699

AF7699.[Photographs](#) are available for this station.

AF7699

AF7699.The X, Y, and Z were computed from the position and the ellipsoidal ht.

AF7699

AF7699.The Laplace correction was computed from DEFLEC12B derived deflections.

AF7699

AF7699.The ellipsoidal height was determined by GPS observations

AF7699.and is referenced to NAD 83.

AF7699

AF7699.The dynamic height is computed by dividing the NAVD 88

AF7699.geopotential number by the normal gravity value computed on the

AF7699.Geodetic Reference System of 1980 (GRS 80) ellipsoid at 45

AF7699.degrees latitude (g = 980.6199 gals.).

AF7699

AF7699.The modeled gravity was interpolated from observed gravity values.

AF7699

AF7699. The following values were computed from the NAD 83(2011) position.

AF7699

| AF7699; | | North | East | Units | Scale Factor | Converg. |
|-----------------|---|---------------|-------------|-------|--------------|------------|
| AF7699;SPC FL E | - | 341,083.255 | 258,952.091 | MT | 0.99998406 | +0 16 28.1 |
| AF7699;SPC FL E | - | 1,119,037.31 | 849,578.65 | sFT | 0.99998406 | +0 16 28.1 |
| AF7699;UTM 17 | - | 3,032,098.861 | 558,931.977 | MT | 0.99964287 | +0 16 28.1 |

AF7699

AF7699! - Elev Factor x Scale Factor = Combined Factor

AF7699!SPC FL E - 1.00000350 x 0.99998406 = 0.99998756

AF7699!UTM 17 - 1.00000350 x 0.99964287 = 0.99964637

AF7699

AF7699_U.S. NATIONAL GRID SPATIAL ADDRESS: 17RNL5893132098(NAD 83)

AF7699

| AF7699 | ----- | | |
|--------|--------|------------------|----------------|
| AF7699 | PID | Reference Object | Distance |
| AF7699 | | | Geod. Az |
| AF7699 | | | dddmmss.s |
| AF7699 | AF6653 | BOUFFORD | 112.289 METERS |
| AF7699 | ----- | | |

AF7699

AF7699

SUPERSEDED SURVEY CONTROL

AF7699

AF7699 NAD 83(2007)- 27 24 39.57093(N) 080 24 13.83274(W) AD(2002.00) 0

AF7699 ELLIP H (02/10/07) -22.267 (m) GP(2002.00)

AF7699 NAD 83(1999)- 27 24 39.57117(N) 080 24 13.83319(W) AD() A

AF7699 ELLIP H (12/09/02) -22.235 (m) GP() 4 1

AF7699 NAD 83(1999)- 27 24 39.57117(N) 080 24 13.83319(W) AD() B

AF7699 ELLIP H (05/31/01) -22.235 (m) GP() 5 1

AF7699 NAD 83(1990)- 27 24 39.56989(N) 080 24 13.83211(W) AD() B

AF7699 ELLIP H (06/02/94) -22.249 (m) GP() 3 1

AF7699 NAVD 88 5.07 (m) 16.6 (f) LEVELING 3

AF7699 NAVD 88 (06/02/94) 5.1 (m) GEOID93 model used GPS OBS

AF7699

AF7699.Superseded values are not recommended for survey control.

AF7699

AF7699.NGS no longer adjusts projects to the NAD 27 or NGVD 29 datums.

AF7699.See file [dsdata.pdf](#) to determine how the superseded data were derived.

AF7699

AF7699_MARKER: F = FLANGE-ENCASED ROD

AF7699_SETTING: 59 = STAINLESS STEEL ROD IN SLEEVE (10 FT.+)

AF7699_STAMPING: DUCK 1993

AF7699_MARK LOGO: NGS

AF7699_PROJECTION: RECESSED 3 CENTIMETERS

AF7699_MAGNETIC: M = MARKER EQUIPPED WITH BAR MAGNET
 AF7699_STABILITY: B = PROBABLY HOLD POSITION/ELEVATION WELL
 AF7699_SATELLITE: THE SITE LOCATION WAS REPORTED AS SUITABLE FOR
 AF7699+SATELLITE: SATELLITE OBSERVATIONS - April 11, 2015
 AF7699_ROD/PIPE-DEPTH: 14 meters
 AF7699_SLEEVE-DEPTH : 1 meters

| AF7699 | HISTORY | - Date | Condition | Report By |
|--------|---------|------------|------------|-----------|
| AF7699 | HISTORY | - 1993 | MONUMENTED | NGS |
| AF7699 | HISTORY | - 19950214 | GOOD | SFLWMD |
| AF7699 | HISTORY | - 20010524 | GOOD | EMCINC |
| AF7699 | HISTORY | - 20020226 | GOOD | MAPTEC |
| AF7699 | HISTORY | - 20020415 | GOOD | MAPTEC |
| AF7699 | HISTORY | - 20150411 | GOOD | GEOCAC |

AF7699

STATION DESCRIPTION

AF7699

AF7699'DESCRIBED BY NATIONAL GEODETIC SURVEY 1993
 AF7699'THE STATION IS LOCATED ABOUT 19.3 KM (12.00 MI) NORTHWEST OF PORT ST
 AF7699'LUCIE, 8.05 KM (5.00 MI) SOUTHWEST OF FORT PIERCE, 0.16 KM (0.10 MI)
 AF7699'WEST OF THE FLORIDA TURNPIKE 0.16 KM (0.10 MI) SOUTH OF STATE ROAD 70
 AF7699'IN THE NORTHEAST CORNER OF LUCIE COUNTY AND ALONG THE WEST SIDE OF
 AF7699'GORDY ROAD. OWNERSHIP--HIGHWAY RIGHT OF WAY.
 AF7699'TO REACH THE STATION FROM THE JUNCTION OF STATE ROAD 70 AND THE
 AF7699'FLORIDA TURNPIKE, GO WEST ON STATE ROAD 70 FOR 0.16 KM (0.10 MI) TO A
 AF7699'SIDE ROAD LEFT. TURN LEFT AND GO SOUTH ON GORDY ROAD 0.16 KM
 AF7699'(0.10 MI) TO THE STATION ON THE RIGHT.
 AF7699'LOCATED 92.7 M (304.1 FT) NORTH OF A PRIVATE DRIVEWAY (ADDRESS 3075
 AF7699'GORDY ROAD), 9.7 M (31.8 FT) EAST OF A POWER POLE WITH WITNESS POST,
 AF7699'6.8 M (22.3 FT) SOUTH OF A 35 MPH SIGN AND 5.2 M (17.1 FT) WEST OF
 AF7699'THE CENTERLINE OF GORDY ROAD.

AF7699

STATION RECOVERY (1995)

AF7699

AF7699

AF7699'RECOVERY NOTE BY S FL WATER MGMT DIST 1995 (MEH)
 AF7699'THE STATION IS LOCATED IN FORT PIERCE ON STATE ROAD 70 NEAR THE
 AF7699'FLORIDA TURNPIKE IN SECTION 26, TOWNSHIP 35 SOUTH, RANGE 39 EAST. TO
 AF7699'REACH THE STATION FROM THE INTERSECTION OF STATE ROAD 70 (OKEECHOBEE
 AF7699'ROAD) AND STATE ROAD 713 (KINGS HIGHWAY) IN FORT PIERCE, GO SOUTHWEST
 AF7699'ON STATE ROAD 70 (OKEECHOBEE ROAD) FOR 0.3 MI (0.5 KM) TO THE JUNCTION
 AF7699'OF GORDY ROAD ON THE LEFT, TURN LEFT ON GORDY ROAD AND GO SOUTH FOR
 AF7699'0.05 MI (0.08 KM) TO THE STATION ON THE RIGHT. LOCATED 39.4 FT (12.0
 AF7699'M) SOUTH OF A METAL POST FOR A SPEED LIMIT SIGN, 31.6 FT (9.6 M) EAST
 AF7699'OF A CARSONITE WITNESS POST, 31.6 FT (9.6 M) EAST OF A POWER POLE,
 AF7699'17.1 FT (5.2 M) WEST OF THE APPROXIMATE CENTERLINE OF GORDY ROAD AND
 AF7699'9.6 FT (2.9 M) WEST OF THE WEST EDGE OF THE PAVEMENT. NOTE ACCESS TO
 AF7699'DATUM POINT IS HAD THROUGH A 5-INCH LOGO CAP.

AF7699

STATION RECOVERY (2001)

AF7699

AF7699

AF7699'RECOVERY NOTE BY EMC INCORPORATED 2001 (WJB)
 AF7699'RECOVERED IN GOOD CONDITION. NOTE--DESCRIBED IN SEC 26, T-35
 AF7699'SOUTH, R-39-E.

AF7699

STATION RECOVERY (2002)

AF7699

AF7699

AF7699'RECOVERY NOTE BY MAPTECH INCORPORATED 2002 (RLT)
 AF7699'RECOVERED AS DESCRIBED

AF7699

AF7699

STATION RECOVERY (2002)

AF7699
AF7699'RECOVERY NOTE BY MAPTECH INCORPORATED 2002 (CDP)
AF7699'RECOVERED AS DESCRIBED
AF7699
AF7699 STATION RECOVERY (2015)
AF7699
AF7699'RECOVERY NOTE BY GEOCACHING 2015 (KEN)
AF7699'THE CAP IS MISSING.

*** retrieval complete.
Elapsed Time = 00:00:02

| Project Information | | Coordinate System | |
|---------------------|-------------------------------|-------------------|----------|
| Name: | | Name: | Default |
| Size: | | Datum: | WGS 1984 |
| Modified: | 2/15/2012 8:48:57 AM (UTC:-7) | Zone: | Default |
| Time zone: | Mountain Standard Time | Geoid: | |
| Reference number: | | Vertical datum: | |
| Description: | | | |

Level Report

Imported file: [SLF21.DAT](#)
Instrument: DiNi
Standard error per kilometer of double leveling: 0.00230 ft
Standard error per turn/station setup: 0.00000 ft
Creation option: Delta elevations
Description usage: Feature codes

Run - 1 Raw Observations

Raw Misclosure: -0.00120 ft
Σ BS Distances: 642.750 ft
Σ FS Distances: 663.840 ft
Run Length: 1306.590 ft
Reduction: Adjusted Values



| Create | Point ID | BS | IS | FS | Δ Elevation | Raw Elevation | Correction | Adj. Elevation | Type | Distance | Description |
|-------------------------------------|----------|--|----|--|-------------|---------------|------------|----------------|-----------|------------|-------------|
| <input checked="" type="checkbox"/> | 1 | <input checked="" type="checkbox"/> 4.56300 ft | | | 0.00000 ft | 21.866 ft | 0.00000 ft | 21.866 ft ▲ | Benchmark | 243.900 ft | BOXCU 3 |
| <input type="checkbox"/> | 2 | | | <input checked="" type="checkbox"/> 5.52200 ft | -0.95900 ft | 20.907 ft | 0.00049 ft | 20.907 ft | Computed | 251.740 ft | 3 |
| | 2 | <input checked="" type="checkbox"/> 4.51200 ft | | | | | | | | 256.530 ft | 3 |
| <input type="checkbox"/> | 3 | | | <input checked="" type="checkbox"/> 3.97600 ft | 0.53600 ft | 21.443 ft | 0.00102 ft | 21.444 ft | Computed | 257.510 ft | 3 |
| | 3 | <input checked="" type="checkbox"/> 4.09800 ft | | | | | | | | 142.320 ft | 3 |
| <input checked="" type="checkbox"/> | 4 | | | <input checked="" type="checkbox"/> 5.37100 ft | -1.27300 ft | 20.170 ft | 0.00120 ft | 20.171 ft ? | Benchmark | 154.590 ft | IFAS 3 |

Run - 1 (N1) Reduced Observations

| Observation | Status | Raw Δ Elevation | Correction | Final Δ Elevation | Setups | Length | Σ BS Readings | Σ FS Readings | Std. Error |
|--------------------------|---------|-----------------|------------|-------------------|--------|-------------|---------------|---------------|------------|
| 1-4 (E1) | Enabled | -1.69600 ft | 0.00120 ft | -1.69480 ft | 3 | 1306.590 ft | 13.17300 ft | 14.86900 ft | 0.02017 ft |

Run - 1 (N1) Reduced Coordinates

| Point ID | Status | Elevation |
|----------|--------|-----------|
|----------|--------|-----------|

| | | |
|---|---------|-------------|
|  1 | Enabled | 21.86600 ft |
|  4 | Enabled | 20.17120 ft |

Run - 2 Raw Observations

Raw Misclosure: ?

Σ BS Distances: 693.210 ft

Σ FS Distances: 650.590 ft

Run Length: 1343.800 ft

Reduction: Adjusted Values

| Create | Point ID | BS | IS | FS | Δ Elevation | Raw Elevation | Correction | Adj. Elevation | Type | Distance | Description |
|-------------------------------------|----------|--|----|--|--------------------|---------------|-------------|---|-----------|------------|-------------|
| <input checked="" type="checkbox"/> | 10 | <input checked="" type="checkbox"/> 3.73100 ft | | | 0.00000 ft | 20.170 ft | 0.00000 ft | 20.170 ft  | Benchmark | 201.440 ft | IFAS 3 |
| <input type="checkbox"/> | 11 | | | <input checked="" type="checkbox"/> 5.05200 ft | -1.32100 ft | 18.849 ft | -0.00016 ft | 18.849 ft | Computed | 187.890 ft | 3 |
| | 11 | <input checked="" type="checkbox"/> 5.18100 ft | | | | | | | | 250.330 ft | 3 |
| <input type="checkbox"/> | 12 | | | <input checked="" type="checkbox"/> 4.21600 ft | 0.96500 ft | 19.814 ft | -0.00044 ft | 19.814 ft | Computed | 258.140 ft | 3 |
| | 12 | <input checked="" type="checkbox"/> 3.76400 ft | | | | | | | | 139.240 ft | 3 |
| <input checked="" type="checkbox"/> | 13 | | | <input checked="" type="checkbox"/> 5.28900 ft | -1.52500 ft | 18.289 ft | -0.00050 ft | 18.289 ft | Computed | 102.200 ft | SLF21 3 |
| | 13 | <input checked="" type="checkbox"/> 5.28900 ft | | | | | | | | 102.200 ft | 3 |
| <input type="checkbox"/> | 14 | | | <input checked="" type="checkbox"/> 5.37600 ft | -0.08700 ft | 18.202 ft | -0.00050 ft | 18.202 ft | Computed | 102.360 ft | 3 |

Run - 2 (N2) Reduced Observations

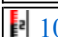
| Observation | Status | Raw Δ Elevation | Correction | Final Δ Elevation | Setups | Length | Σ BS Readings | Σ FS Readings | Std. Error |
|---|---------|------------------------|-------------|--------------------------|--------|-------------|----------------------|----------------------|------------|
|  10-13 (E2) | Enabled | -1.88100 ft | -0.00050 ft | -1.88150 ft | 3 | 1139.240 ft | 12.67600 ft | 14.55700 ft | 0.01785 ft |

Run - 2 (N2) Reduced Coordinates

| Point ID | Status | Elevation |
|--|---------|-------------|
|  10 | Enabled | 20.17000 ft |

Run - 3 Raw Observations

Raw Misclosure: ?

Σ BS Distances: 548.850 ft

Σ FS Distances: 592.850 ft

Run Length: 1141.700 ft

Reduction: Adjusted Values

| Create | Point ID | BS | IS | FS | Δ Elevation | Raw Elevation | Correction | Adj. Elevation | Type | Distance | Description |
|-------------------------------------|----------|--|----|--|-------------|---------------|-------------|----------------|-----------|------------|-------------|
| <input checked="" type="checkbox"/> | 13 | <input checked="" type="checkbox"/> 5.37700 ft | | | 0.00000 ft | 18.289 ft | -0.00050 ft | 18.289 ft | Computed | 102.260 ft | SLF21 3 |
| <input type="checkbox"/> | 15 | | | <input checked="" type="checkbox"/> 3.85000 ft | 1.52700 ft | 19.816 ft | -0.00056 ft | 19.815 ft | Computed | 138.980 ft | 3 |
| | 15 | <input checked="" type="checkbox"/> 4.13300 ft | | | | | | | | 259.940 ft | 3 |
| <input type="checkbox"/> | 16 | | | <input checked="" type="checkbox"/> 5.05800 ft | -0.92500 ft | 18.891 ft | -0.00084 ft | 18.890 ft | Computed | 251.540 ft | 3 |
| | 16 | <input checked="" type="checkbox"/> 4.88800 ft | | | | | | | | 186.650 ft | 3 |
| <input checked="" type="checkbox"/> | 17 | | | <input checked="" type="checkbox"/> 3.60800 ft | 1.28000 ft | 20.171 ft | -0.00100 ft | 20.170 ft ▲ | Benchmark | 202.330 ft | IFAS 3 |

Run - 3 (N3) Reduced Observations

| Observation | Status | Raw Δ Elevation | Correction | Final Δ Elevation | Setups | Length | Σ BS Readings | Σ FS Readings | Std. Error |
|----------------------------|---------|-----------------|-------------|-------------------|--------|-------------|---------------|---------------|------------|
| 13-17 (E3) | Enabled | 1.88200 ft | -0.00050 ft | 1.88150 ft | 3 | 1141.700 ft | 14.39800 ft | 12.51600 ft | 0.01791 ft |

Run - 3 (N3) Reduced Coordinates

| Point ID | Status | Elevation |
|--------------------|---------|-------------|
| 17 | Enabled | 20.17000 ft |

| | | |
|----------------------------|----------|-------------------------|
| Date: 4/25/2017 7:51:07 AM | Project: | Trimble Business Center |
|----------------------------|----------|-------------------------|

| Project Information | | Coordinate System | |
|---------------------|-------------------------------|-------------------|----------|
| Name: | | Name: | Default |
| Size: | | Datum: | WGS 1984 |
| Modified: | 2/15/2012 8:48:57 AM (UTC:-7) | Zone: | Default |
| Time zone: | Mountain Standard Time | Geoid: | |
| Reference number: | | Vertical datum: | |
| Description: | | | |

Level Report

Imported file: [SLF21C.DAT](#)
Instrument: DiNi
Standard error per kilometer of double leveling: 0.00230 ft
Standard error per turn/station setup: 0.00000 ft
Creation option: Delta elevations
Description usage: Feature codes

Run - 2 (1) Raw Observations

Raw Misclosure: 0.03400 ft
 Σ BS Distances: 3066.790 ft
 Σ FS Distances: 2532.270 ft
Run Length: 5599.060 ft
Reduction: Adjusted Values

| Create | Point ID | BS | IS | FS | Δ Elevation | Raw Elevation | Correction | Adj. Elevation | Type | Distance | Description |
|-------------------------------------|----------|---|----|---|--------------------|---------------|-------------|----------------|-----------|---------------|-------------|
| <input checked="" type="checkbox"/> | 1 | <input checked="" type="checkbox"/> 5.59900 ft | | | 0.00000 ft | 20.140 ft | 0.00000 ft | 20.140 ft ▲ | Benchmark | 253.810 ft | B528 3 |
| <input type="checkbox"/> | 2 | | | <input checked="" type="checkbox"/> 4.45400 ft | 1.14500 ft | 21.285 ft | -0.00310 ft | 21.282 ft | Computed | 247.150 ft | 3 |
| | 2 | <input checked="" type="checkbox"/> 2.99700 ft | | | | | | | | 258.170 ft | 3 |
| <input type="checkbox"/> | 3 | | | <input checked="" type="checkbox"/> 4.74000 ft | -1.74300 ft | 19.542 ft | -0.00616 ft | 19.536 ft | Computed | 240.220 ft | 3 |
| | 3 | <input checked="" type="checkbox"/> 4.32100 ft | | | | | | | | 263.290 ft | 3 |
| <input type="checkbox"/> | 4 | | | <input checked="" type="checkbox"/> 4.93500 ft | -0.61400 ft | 18.928 ft | -0.00924 ft | 18.919 ft | Computed | 236.020 ft | 3 |
| | 4 | <input checked="" type="checkbox"/> 4.06600 ft | | | | | | | | 265.220 ft | 3 |
| <input type="checkbox"/> | 5 | | | <input checked="" type="checkbox"/> 4.49800 ft | -0.43200 ft | 18.496 ft | -0.01232 ft | 18.484 ft | Computed | 234.120 ft | 3 |
| | 5 | <input checked="" type="checkbox"/> 4.80100 ft | | | | | | | | 269.550 ft | 3 |
| <input type="checkbox"/> | 6 | | | <input checked="" type="checkbox"/> 4.70400 ft | 0.09700 ft | 18.593 ft | -0.01545 ft | 18.578 ft | Computed | 234.280 ft | 3 |
| | | <input checked="" type="checkbox"/> 5.63700 | | | | | | | | 290.880 | |

| | | | | | | | | | | | |
|-------------------------------------|----|---|---|----------------|-----------|-------------|--------------|-----------|---------------|--------|---|
| | 6 | ft | | | | | | | | ft | 3 |
| <input type="checkbox"/> | 7 | | <input checked="" type="checkbox"/> 4.11100 ft | 1.52600 ft | 20.119 ft | -0.01865 ft | 20.100 ft | Computed | 218.010 ft | 3 | |
| | 7 | <input checked="" type="checkbox"/> 4.84500 ft | | | | | | | 276.310 ft | 3 | |
| <input type="checkbox"/> | 8 | | <input checked="" type="checkbox"/> 4.74700 ft | 0.09800 ft | 20.217 ft | -0.02173 ft | 20.195 ft | Computed | 223.520 ft | 3 | |
| | 8 | <input checked="" type="checkbox"/> 4.44800 ft | | | | | | | 271.190 ft | 3 | |
| <input type="checkbox"/> | 9 | | <input checked="" type="checkbox"/> 5.53900 ft | -1.09100 ft | 19.126 ft | -0.02480 ft | 19.101 ft | Computed | 227.160 ft | 3 | |
| | 9 | <input checked="" type="checkbox"/> 3.42200 ft | | | | | | | 281.590 ft | 3 | |
| <input type="checkbox"/> | 10 | | <input checked="" type="checkbox"/> 4.29300 ft | -0.87100 ft | 18.255 ft | -0.02784 ft | 18.227 ft | Computed | 215.260 ft | 3 | |
| | 10 | <input checked="" type="checkbox"/> 4.80300 ft | | | | | | | 290.850 ft | 3 | |
| <input type="checkbox"/> | 11 | | <input checked="" type="checkbox"/> 4.97400 ft | -0.17100 ft | 18.084 ft | -0.03088 ft | 18.053 ft | Computed | 204.760 ft | 3 | |
| | 11 | <input checked="" type="checkbox"/> 4.82100 ft | | | | | | | 290.480 ft | 3 | |
| <input type="checkbox"/> | 12 | | <input checked="" type="checkbox"/> 5.97500 ft | -1.15400 ft | 16.930 ft | -0.03386 ft | 16.896 ft | Computed | 201.440 ft | 3 | |
| | 12 | <input checked="" type="checkbox"/> 5.06900 ft | | | | | | | 55.450 ft | 3 | |
| <input checked="" type="checkbox"/> | 13 | | <input checked="" type="checkbox"/> 5.31500 ft | -0.24600 ft | 16.684 ft | -0.03400 ft | 16.650 ft | Benchmark | 50.330 ft | DUCK 3 | |

Run - 2 (1) (N1) Reduced Observations

| Observation | Status | Raw Δ Elevation | Correction | Final Δ Elevation | Setups | Length | Σ BS Readings | Σ FS Readings | Std. Error |
|---------------------------|---------|-----------------|-------------|-------------------|--------|----------------|---------------|---------------|---------------|
| 1-13 (E1) | Enabled | -3.45600 ft | -0.03400 ft | -3.49000 ft | 12 | 5599.060 ft | 54.82900 ft | 58.28500 ft | 0.04330 ft |

Run - 2 (1) (N1) Reduced Coordinates

| Point ID | Status | Elevation |
|--------------------|---------|-------------|
| 1 | Enabled | 20.14000 ft |
| 13 | Enabled | 16.65000 ft |

Run - 2 Raw Observations

Raw Misclosure: -0.00800 ft
 Σ BS Distances: 6686.590 ft
 Σ FS Distances: 6591.540 ft
 Run Length: 13278.130 ft
 Reduction: Adjusted Values

| Create | Point | BS | IS | FS | Δ | Raw | Correction | Adj. | Type | Distance | Description |
|--------|-------|----|----|----|---|-----|------------|------|------|----------|-------------|
|--------|-------|----|----|----|---|-----|------------|------|------|----------|-------------|

| | ID | | | Elevation | Elevation | | Elevation | | | |
|-------------------------------------|----|---|---|----------------|-----------|------------|----------------|-----------|---------------|--------|
| <input checked="" type="checkbox"/> | 20 | <input checked="" type="checkbox"/> 5.63900 ft | | 0.00000 ft | 16.650 ft | 0.00000 ft | 16.650 ft ▲ | Benchmark | 50.520 ft | DUCK 3 |
| <input type="checkbox"/> | 21 | | <input checked="" type="checkbox"/> 5.39400 ft | 0.24500 ft | 16.895 ft | 0.00001 ft | 16.895 ft | Computed | 54.490 ft | 3 |
| | 21 | <input checked="" type="checkbox"/> 5.65300 ft | | | | | | | 149.840 ft | 3 |
| <input type="checkbox"/> | 22 | | <input checked="" type="checkbox"/> 3.28300 ft | 2.37000 ft | 19.265 ft | 0.00013 ft | 19.265 ft | Computed | 149.800 ft | 3 |
| | 22 | <input checked="" type="checkbox"/> 3.63100 ft | | | | | | | 263.120 ft | 3 |
| <input type="checkbox"/> | 23 | | <input checked="" type="checkbox"/> 4.48500 ft | -0.85400 ft | 18.411 ft | 0.00046 ft | 18.411 ft | Computed | 251.770 ft | 3 |
| | 23 | <input checked="" type="checkbox"/> 5.04900 ft | | | | | | | 253.150 ft | 3 |
| <input type="checkbox"/> | 24 | | <input checked="" type="checkbox"/> 6.79000 ft | -1.74100 ft | 16.670 ft | 0.00078 ft | 16.671 ft | Computed | 253.440 ft | 3 |
| | 24 | <input checked="" type="checkbox"/> 6.41500 ft | | | | | | | 254.760 ft | 3 |
| <input type="checkbox"/> | 25 | | <input checked="" type="checkbox"/> 4.70200 ft | 1.71300 ft | 18.383 ft | 0.00110 ft | 18.384 ft | Computed | 256.560 ft | 3 |
| | 25 | <input checked="" type="checkbox"/> 4.50600 ft | | | | | | | 254.890 ft | 3 |
| <input type="checkbox"/> | 26 | | <input checked="" type="checkbox"/> 4.64100 ft | -0.13500 ft | 18.248 ft | 0.00143 ft | 18.249 ft | Computed | 254.950 ft | 3 |
| | 26 | <input checked="" type="checkbox"/> 4.08300 ft | | | | | | | 254.030 ft | 3 |
| <input type="checkbox"/> | 27 | | <input checked="" type="checkbox"/> 5.18900 ft | -1.10600 ft | 17.142 ft | 0.00175 ft | 17.144 ft | Computed | 253.840 ft | 3 |
| | 27 | <input checked="" type="checkbox"/> 4.55100 ft | | | | | | | 256.130 ft | 3 |
| <input type="checkbox"/> | 28 | | <input checked="" type="checkbox"/> 4.13200 ft | 0.41900 ft | 17.561 ft | 0.00207 ft | 17.563 ft | Computed | 252.690 ft | 3 |
| | 28 | <input checked="" type="checkbox"/> 5.45200 ft | | | | | | | 253.870 ft | 3 |
| <input type="checkbox"/> | 29 | | <input checked="" type="checkbox"/> 4.75100 ft | 0.70100 ft | 18.262 ft | 0.00240 ft | 18.264 ft | Computed | 255.220 ft | 3 |
| | 29 | <input checked="" type="checkbox"/> 4.64700 ft | | | | | | | 251.110 ft | 3 |
| <input type="checkbox"/> | 30 | | <input checked="" type="checkbox"/> 3.97300 ft | 0.67400 ft | 18.936 ft | 0.00271 ft | 18.939 ft | Computed | 252.720 ft | 3 |
| | 30 | <input checked="" type="checkbox"/> 5.10400 ft | | | | | | | 252.850 ft | 3 |
| <input type="checkbox"/> | 31 | | <input checked="" type="checkbox"/> 5.60000 ft | -0.49600 ft | 18.440 ft | 0.00302 ft | 18.443 ft | Computed | 243.240 ft | 3 |
| | 31 | <input checked="" type="checkbox"/> 6.33500 ft | | | | | | | 256.990 ft | 3 |
| <input type="checkbox"/> | 32 | | <input checked="" type="checkbox"/> 4.42600 ft | 1.90900 ft | 20.349 ft | 0.00335 ft | 20.352 ft | Computed | 254.330 ft | 3 |

| | | | | | | | | | | | |
|--------------------------|----|---|---|----------------|-----------|------------|-----------|----------|--|---------------|-------|
| | 32 | <input checked="" type="checkbox"/> 4.59600 ft | | | | | | | | 248.590 ft | 3 |
| <input type="checkbox"/> | 33 | | <input checked="" type="checkbox"/> 4.05600 ft | 0.54000 ft | 20.889 ft | 0.00366 ft | 20.893 ft | Computed | | 252.850 ft | 3 |
| | 33 | <input checked="" type="checkbox"/> 4.44100 ft | | | | | | | | 253.080 ft | 3 |
| <input type="checkbox"/> | 34 | | <input checked="" type="checkbox"/> 4.90900 ft | -0.46800 ft | 20.421 ft | 0.00388 ft | 20.425 ft | Computed | | 171.130 ft | 3 |
| | 34 | <input checked="" type="checkbox"/> 5.78800 ft | | | | | | | | 97.770 ft | 3 |
| <input type="checkbox"/> | 35 | | <input checked="" type="checkbox"/> 4.32600 ft | 1.46200 ft | 21.883 ft | 0.00394 ft | 21.887 ft | Computed | | 107.380 ft | BOX 3 |
| | 35 | <input checked="" type="checkbox"/> 4.47000 ft | | | | | | | | 111.220 ft | BOX 3 |
| <input type="checkbox"/> | 36 | | <input checked="" type="checkbox"/> 5.93200 ft | -1.46200 ft | 20.421 ft | 0.00399 ft | 20.425 ft | Computed | | 93.340 ft | 3 |
| | 36 | <input checked="" type="checkbox"/> 5.01400 ft | | | | | | | | 223.290 ft | 3 |
| <input type="checkbox"/> | 37 | | <input checked="" type="checkbox"/> 4.61000 ft | 0.40400 ft | 20.825 ft | 0.00421 ft | 20.829 ft | Computed | | 200.290 ft | 3 |
| | 37 | <input checked="" type="checkbox"/> 4.54900 ft | | | | | | | | 251.280 ft | 3 |
| <input type="checkbox"/> | 38 | | <input checked="" type="checkbox"/> 5.13400 ft | -0.58500 ft | 20.240 ft | 0.00452 ft | 20.245 ft | Computed | | 249.540 ft | 3 |
| | 38 | <input checked="" type="checkbox"/> 4.60300 ft | | | | | | | | 253.440 ft | 3 |
| <input type="checkbox"/> | 39 | | <input checked="" type="checkbox"/> 6.49200 ft | -1.88900 ft | 18.351 ft | 0.00485 ft | 18.356 ft | Computed | | 257.550 ft | 3 |
| | 39 | <input checked="" type="checkbox"/> 6.06300 ft | | | | | | | | 245.050 ft | 3 |
| <input type="checkbox"/> | 40 | | <input checked="" type="checkbox"/> 5.59400 ft | 0.46900 ft | 18.820 ft | 0.00516 ft | 18.825 ft | Computed | | 252.000 ft | 3 |
| | 40 | <input checked="" type="checkbox"/> 4.04700 ft | | | | | | | | 252.950 ft | 3 |
| <input type="checkbox"/> | 41 | | <input checked="" type="checkbox"/> 4.74100 ft | -0.69400 ft | 18.126 ft | 0.00548 ft | 18.131 ft | Computed | | 250.390 ft | 3 |
| | 41 | <input checked="" type="checkbox"/> 4.80900 ft | | | | | | | | 255.480 ft | 3 |
| <input type="checkbox"/> | 42 | | <input checked="" type="checkbox"/> 5.48300 ft | -0.67400 ft | 17.452 ft | 0.00580 ft | 17.458 ft | Computed | | 253.180 ft | 3 |
| | 42 | <input checked="" type="checkbox"/> 4.26300 ft | | | | | | | | 251.380 ft | 3 |
| <input type="checkbox"/> | 43 | | <input checked="" type="checkbox"/> 4.69100 ft | -0.42800 ft | 17.024 ft | 0.00612 ft | 17.030 ft | Computed | | 256.530 ft | 3 |
| | 43 | <input checked="" type="checkbox"/> 5.32200 ft | | | | | | | | 254.760 ft | 3 |
| <input type="checkbox"/> | 44 | | <input checked="" type="checkbox"/> 4.26200 ft | 1.06000 ft | 18.084 ft | 0.00644 ft | 18.090 ft | Computed | | 252.660 ft | 3 |
| | 44 | <input checked="" type="checkbox"/> 4.73800 ft | | | | | | | | 255.080 ft | 3 |

| | | | | | | | | | | |
|-------------------------------------|----|---|---|----------------|-----------|------------|--------------|-----------|---------------|--------|
| <input type="checkbox"/> | 45 | | <input checked="" type="checkbox"/> 4.55300 ft | 0.18500 ft | 18.269 ft | 0.00676 ft | 18.276 ft | Computed | 253.810 ft | 3 |
| | 45 | <input checked="" type="checkbox"/> 4.78100 ft | | | | | | | 256.270 ft | 3 |
| <input type="checkbox"/> | 46 | | <input checked="" type="checkbox"/> 6.42600 ft | -1.64500 ft | 16.624 ft | 0.00709 ft | 16.631 ft | Computed | 253.740 ft | 3 |
| | 46 | <input checked="" type="checkbox"/> 6.77600 ft | | | | | | | 255.410 ft | 3 |
| <input type="checkbox"/> | 47 | | <input checked="" type="checkbox"/> 4.99700 ft | 1.77900 ft | 18.403 ft | 0.00741 ft | 18.410 ft | Computed | 252.660 ft | 3 |
| | 47 | <input checked="" type="checkbox"/> 4.48200 ft | | | | | | | 252.100 ft | 3 |
| <input type="checkbox"/> | 48 | | <input checked="" type="checkbox"/> 5.85300 ft | -1.37100 ft | 17.032 ft | 0.00772 ft | 17.040 ft | Computed | 246.720 ft | 3 |
| | 48 | <input checked="" type="checkbox"/> 5.31200 ft | | | | | | | 218.180 ft | 3 |
| <input checked="" type="checkbox"/> | 49 | | <input checked="" type="checkbox"/> 5.70200 ft | -0.39000 ft | 16.642 ft | 0.00800 ft | 16.650 ft | Benchmark | 254.720 ft | DUCK 3 |

Run - 2 (N2) Reduced Observations

| Observation | Status | Raw Δ Elevation | Correction | Final Δ Elevation | Setups | Length | Σ BS Readings | Σ FS Readings | Std. Error |
|----------------------------|---------|-----------------|------------|-------------------|--------|-----------------|---------------|---------------|---------------|
| 20-49 (E2) | Enabled | -0.00800 ft | 0.00800 ft | 0.00000 ft | 29 | 13278.130 ft | 145.11900 ft | 145.12700 ft | 0.06606 ft |

Run - 2 (N2) Reduced Coordinates

| Point ID | Status | Elevation |
|--------------------|---------|-------------|
| 20 | Enabled | 16.65000 ft |
| 49 | Enabled | 16.65000 ft |

| | | |
|---------------------------|----------|-------------------------|
| Date: 5/9/2017 3:34:26 PM | Project: | Trimble Business Center |
|---------------------------|----------|-------------------------|

Office

Project

25 April 2017

INPUT

Geographic, flhp gn - Florida HPGN
Vertical - NAVD88, U.S. Feet

OUTPUT

State Plane, flhp gn - Florida HPGN
0901 - Florida East, U.S. Feet
Vertical - NGVD29 (Custom), U.S. Feet

SLF21

1/1

Latitude: 27 25 41.86700
Longitude: 80 24 07.48834
Elevation/Z: 0

Northing/Y: 1125330.916
Easting/X: 850120.115
Elevation/Z: 1.486
Convergence: 0 16 31.55788
Scale Factor: 0.999984301
Combined Factor: 0.999988522

Remark:

Corpscon v6.0.1, U.S. Army Corps of Engineers

DBHYDRO | by station

STATION INFORMATION

| | |
|------------------------|-----------------------------------|
| Station | SLF-21 |
| Site | SLF21 |
| Type | WELL |
| Latitude (ddmmss.sss) | 272542 |
| Longitude (ddmmss.sss) | 802407 |
| X Coord (ft) NAD83 | 850164.053 |
| Y Coord (ft) NAD83 | 1125344.558 |
| County | St. Lucie |
| Basin | TIDAL ST. LUCIE NORTH FORK |
| Section | 14 |
| Township | 35 |
| Range | 39 |
| Show Map | Google Map |
| Well Info | Info |
| Description | STL-224 FORT PIERCE AG EXP ST |
| Notes | MEASURING POINT ELEVATION = 3.144 |
| Nearby Stations | Nearby Stations |
| Attachments | Show Attachments |

Query returned 1 station record(s).

Get Sample Data

Get Time Series Data