



SOUTH FLORIDA WATER MANAGEMENT DISTRICT

Rev. 1/16

Site Name: TLWMA5 GW1		Date of Field Work: 21-jan-16
Party Chief: Clanton	Field Book: Misc 6X	Page 79
Site Benchmark: TLWMA5	Benchmark Elevation (NAVD88) 57.87	Corpscon 6.0.1 Conversion Factor (NAVD88 to NGVD29) +1.20
Reference Elevation(s) (NAVD88): 62.61		Existing Tag Elevation (Datum): 63.80 (NGVD 29)
Ground Elevation at well: 58.48		
Latitude: 27° 52' 00.527"		Longitude: 81° 10' 00.483"
Notes: Field offset +1.19		

PICTURES

Overall Site



Looking West

Benchmark Close Up



Brass Tag Close Up



Reference Mark without brass tag

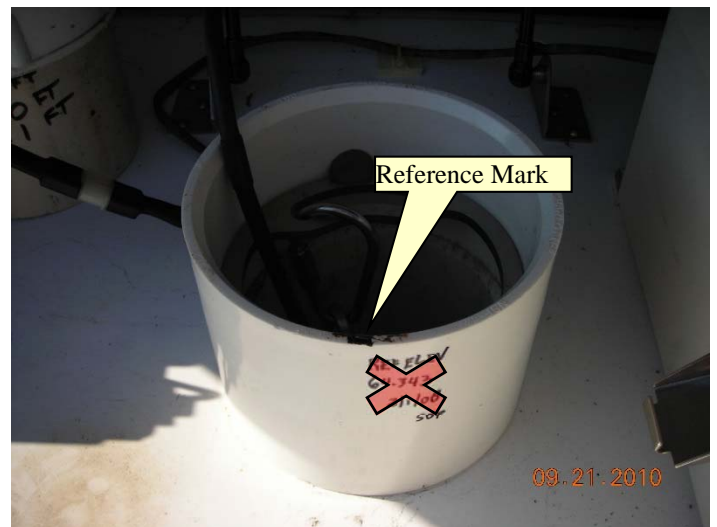

Photo taken 21-sep-10

SEC	13	TWP	30	RGE	31
ESTABLISH NAVD 88 ELEV. @ TLWMA 5 GW SITE					
STA	+	H1	-	ELEV.	BM ELEV.
BM	5.41	63.28			57.87 NAVD 88
GW			0.67	62.61	
GRND			4.8	58.48	
BM			5.41	57.87	57.87 NAVD 88

T CLANTON
 Ø STRICKLAND

COMMENTS

BM TLWMA 5 2007 SEWMD ALUM DISK GOOD COND.

GW 4" PVC PIPE REF MARK ON TOP OF PIPE

GROUND ELEV. @ WELL

BM TLWMA 5 2007



SOUTH FLORIDA WATER MANAGEMENT DISTRICT

Rev. 4/01

COUNTY OSCEOLA	PROJECT KISSIMMEE RIVER RESTORATION PROJECT	DESIGNATION TLWMA5
SECTION 13	TOWNSHIP 30 SOUTH	RANGE 31 EAST
GEOGRAPHIC INDEX OF QUAD		
Established by <u>Nick Miller Inc.</u> Recovered by	NAME OF QUADRANGLE LAKE MARIAN SW	
SURVEYOR <u>Stephen M. Gordon</u> DATE <u>7/03/2007</u>	FIELD BOOK _____ 18 _____ PAGE <u>70</u>	
HORIZONTAL DATUM: 1927 <u>1983</u> Other _____ (circle one) ZONE <u>E</u> or W		
STATE PLANE COORDINATES	E 602,261.3 ft	N 1,284,363.0 ft
LATITUDE: N 27.86693°	LONGITUDE: W 81.16684°	
VERTICAL DATUM: MSL 1929 <u>1988</u> Other _____ (circle one)	EL. 57.87 ft	
VERTICAL DATUM: MSL <u>1929</u> 1988 Other _____ (circle one)	EL. 59.07 ft	
CONTROL ACCURACY: HORIZONTAL 1 2 3 <u>SUB-METER</u> (circle one) VERTICAL 1 2 <u>3</u>		
DESCRIPTION		
<p>To Reach:</p> <p>FROM THE INTERSECTION OF US 441 AND CR 523. HEAD WEST NORTHWEST ON CR 523 FOR 9.7 MILES TO THREE LAKES WILDLIFE MANAGEMENT ENTRANCE. MAKE LEFT AND HEAD SOUTHWESTERLY ON MAIN GRADE ROAD FOR 4.6 MILES TO Y-JUNCTION OF MAIN GRADE ROAD, MAKE LEFT AND HEAD SOUTHERLY ON MAIN GRADE ROAD FOR 0.9 MILE TO SECOND Y-JUNCTION OF MAIN GRADE ROAD, MAKE LEFT AND HEAD SOUTHEASTERLY FOR 0.3 MILE TO GRASS TRAIL ON LEFT, MAKE LEFT AND HEAD EAST FOR +/- 250 FEET TO MARK ON LEFT, SET IN TOP OF A ROUND CONCRETE MONUMENT RECESSED 0.3 FOOT BELOW GROUND LEVEL. LOCATED 45.6 FEET NORTH OF TLWMA5 MONITORING WELL SITE, 45.5 FEET SOUTH OF PK NAIL AND DISK LB 4318 ON EAST SIDE OF 1.0 FOOT DIAMETER OAK TREE AND 2.0 FEET WEST OF A CARSONITE WITNESS POST. MAGNET SET 1 FOOT NORTH OF BENCHMARK.</p> <p>Benchmarks Used: OS/27 6 SFLWMD, KLS 30 E 12 B FLDNR</p> <p>Notable Land marks:</p>		



SOUTH FLORIDA WATER MANAGEMENT DISTRICT

Rev. 4/01

SKETCH

1078.028 TLWMA5 SEQUIMD E. DETASSEK
MONITORING WELL M. VALMER
A. APONTE

WED. JUNE 6, 2007

STAMPED 18,70

- SET Poured-IN-PLACE CONCRETE MONUMENT W/ ALUM. DISK STAMPED: TLWMA5 2007
- SET MAGNET 1' NORTH OF BENCHMARK
- SET CARBONITE WITNESS POST 2' EAST OF BM

COORDINATES ON WELL SITE

N. 27° 52' 00"

W. 81° 10' 01"

COORDINATES ON BENCHMARK

N. 27° 52' 00.95"

N. 1284362.953

W. 81° 10' 00.64"

E. 602261.332

WGS 84

STATE PLANE 83

TIES

- SET MONUMENT 45.6' NORTH OF WELL SITE
- " " 45.5' SOUTH OF TR NAIL & DISK
- LB 4318 ON EAST SIDE OF 10' DIA. OAK TREE.
- " " 2' WEST OF CARBONITE WITNESS POST.

DATA COLLECTOR #1

FILE: # 1078-0605 - ED STATIC SESSION

POINT NAME: TLWMA5 3:00 PM - 3:30 PM

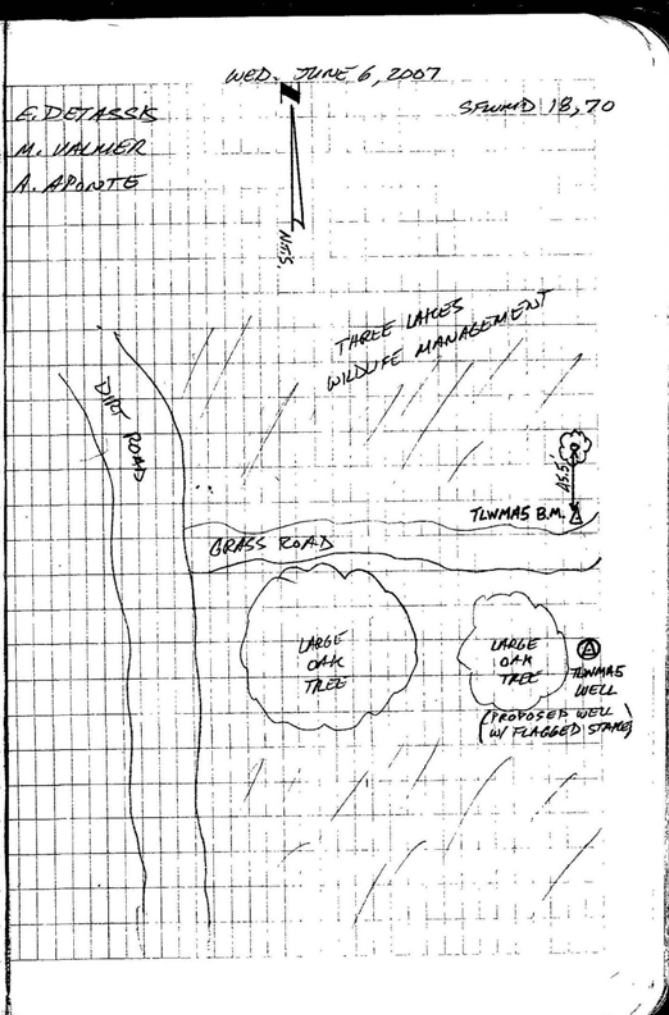

Proposed Well



REGISTRATION WORKSHEET - TLWMA5 Addendum

Site Name: **TLWMA5** Today's Date: **2/2/2016** Type Recorder: **CR10**
 Activity: **Addendum** Effective Date: Start Date of Data :
 Customer: **Garnett Ritchie** Bus. Area: **SCADA Maintenance** Agency: **SFWMD** Internal Order:
 Project Manager: **Amelia Rodriguez-Alers** Bus. Area: **Survey & Mapping** Agency: **SFWMD** Fund:
 Project Name: **VDUP** Legal Mandate: **UNKNOWN**

Short Common Name / Description: TLWMA5

Proj. Mgr. Notes: This addendum was performed to add NAVD 88 surveying data for the reference elevation. To convert to NGVD 29 add +1.20ft.

Site Directions: From the intersection of US-441 and CR523 (Canoe Creek Rd.), head west northwest on CR-523 for approximately 9.7 miles to the Three Lakes Wildlife Management area entrance. Turn left and head southwesterly on main grade road for approximately 4.5 miles to a "Y", and then bear left; you will have to pass through a gate. Once through the gate drive for an additional 1.3 miles, and then turn left into a treed area; the site is in the middle of the trees.

Site Address (if any):

Transportation: **4X4 Vehicle** Lock type or combination: **Abloy S** #

Recorder Location/Purpose: **Stand-Alone Recorder (Non-Flow Site)** Structure Type:

Array ID Configuration table attached **NO**

SURVEY INFORMATION

B.M. Elevation: **57.87'** Date: **7/6/2007** Stamp: **TLWMA5**
 Agency: **SFWMD** Type: **ALUM** Datum: **NAVD 88**

Benchmark Location/ Description: Approximately 45' @ 349° from gate entrance

COMMUNICATIONS INFORMATION

Communications System: **Loggernet** Loggernet Server: **STCLOG1** Loggernet IP Address: **141.232.83.94**

Tower: **S65-TW** Communication Type: **R.F. (V.H.F. Radio)** R.F. Code/Modem Address: **122** R.F. Access Point: **NO**

Phone Number:

RTU Address: Gateways:

WELL INFORMATION

Sensor	Customer Ref	Ref Elev	Elev Date	Top of Well	Bottom of Well	Ground Elev	Benchmark Elev	Benchmark Datum	Ref Elevation Location
GW1		62.61'	1/21/2016	62.61'		58.48'	57.87'	NAVD 88	Top of the well

Sensor	GW Sensor Location Offset	Meas Pt Elevation	GW Land Elevation	Depth of Well	Type of Well	Top of Monitored Interval	Base of Monitored Interval	Parameter Transmitted
GW1								

COORDINATE INFORMATION

Item/Param	Lat	Long	X-Coord	Y-Coord	Sec	Township	Range	Quad	Basin	County	Description
RTU	N27° 52' 00.52"	W81° 10' 00.4"	602274.827	1284318	13	30	31	3110	Lake Kissimmee	Osceola	
GW1	N27° 52' 00.52"	W81° 10' 00.4"	602274.827	1284318	13	30	31	3110	Lake Kissimmee	Osceola	